

NOTES

- 1. ALL DIMENSIONS IN METERS UNO.
- 2. APRON DESIGN IN ACCORDANCE WITH MOS 139 - AERODROMES.
- 3. DESIGN AIRCRAFT DETAILS:

LEGEND

- AREA OF EXISTING SEALED APRON/TAXIWAY
- SB# = STOPBAR AND NUMBER
- TDP = TUG DISCONNECT POINT
- LMT = TUG PUSHBACK LIMIT

APRON MANAGEMENT ARRANGEMENTS

- 1. SCA MANAGES OVERALL PARKING ARRANGEMENTS THROUGH THE AIRPORT SAFETY OFFICER.
- 2. MARSHALLER STOP BARS PROVIDED ON ALL BAYS, COMBINED WITH ADVANCED VISUAL DOCKING GUIDANCE SYSTEM (A-VDGS).
- 3. ALL POSITIONS ARE PUSH BACK WITH THE OPTION OF TAIL NORTH OR TAIL SOUTH.
- 4. SIMULTANEOUS PUSH BACKS AVAILABLE FOR EVERY SECOND BAY. MOST EASTERN/SOUTHERN BAY TO PUSHBACK IN FIRST INSTANCE.
- 5. NON STANDARD PUSH BACKS MAYBE UNDERTAKEN AT ATC DISCRETION.
- 6. REFER TO SCA SOPS REGARDING PROCEDURES FOR A321 PARKED ON BAYS 16 & 17 DUE TO TAIL INFRINGEMENT ON AIRSIDE ROAD.
- 7. CODE E AIRCRAFT DEPARTING RWY 31 FROM TWY F INTERSECTION, REQUIRED TO HOLD ON TWY B SHORT OF TWY B1 WHEN DIRECTED BY ATC PRIOR TO TAXIING TO TWY F HOLDING POINT.
- 8. CODE C AIRCRAFT DEPARTING RWY 31 FROM TWY F INTERSECTION (IF AIRCRAFT ON APPROACH TO RWY 31), ARE REQUIRED TO HOLD ON TWY B SHORT OF TWY B1 TWY F SHORT OF TWY B1 OR ON TWY B2 SHORT OF TWY A.
- 9. WHEN DIRECTED BY ATC PRIOR TO TAXIING TO TWY F HOLDING POINT.
- 9. PILOTS DEPARTING MUST GIVE WAY TO INCOMING TRAFFIC
- 10. PILOTS REQUIRE ENGINE START PERMISSION FROM AIR TRAFFIC CONTROL IN ACCORDANCE WITH ERS LOCAL PROCEDURES.
- 11. MARSHALLING SERVICE AVAILABLE FROM FBO
- 12. TANKER FUEL BAYS 15-18 & FUEL HYDRANT SYSTEM BAYS 10-14.
- 13. NO GROUND RUNNING ABOVE NORMAL SETTINGS.

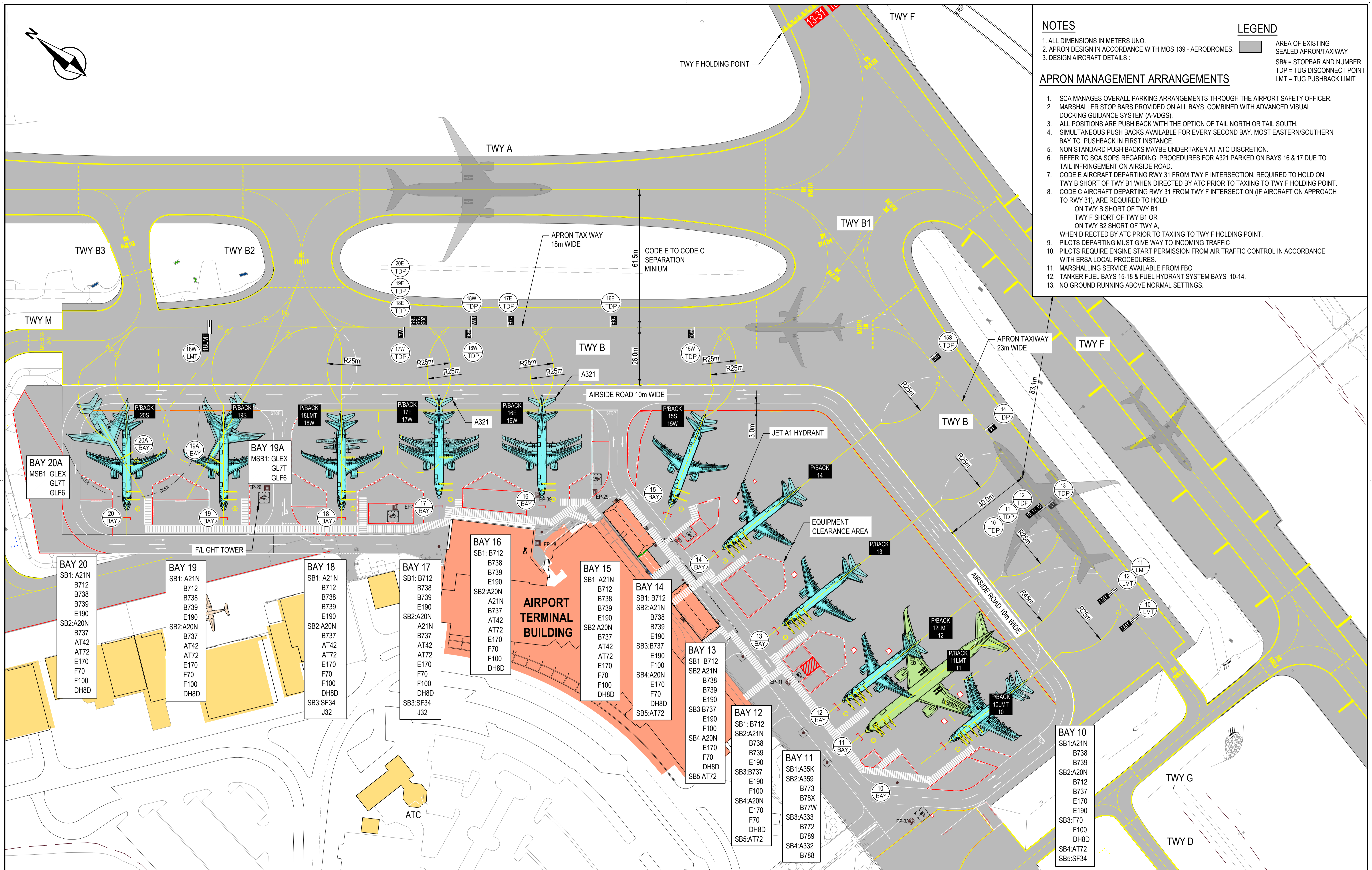

- BAY 20**
SB1: A21N
B712
B738
B739
E190
SB2:A20N
B737
AT42
AT72
E170
F70
F100
DH8D

- BAY 19**
SB1: A21N
B712
B738
B739
E190
SB2:A20N
B737
AT42
AT72
E170
F70
F100
DH8D

- BAY 18**
SB1: A21N
B712
B738
B739
E190
SB2:A20N
B737
AT42
AT72
E170
F70
F100
DH8D
SB3:SF34
J32

- BAY 17**
SB1: B712
B738
B739
E190
SB2:A20N
A21N
B737
AT42
AT72
E170
F70
F100
DH8D
SB3:SF34
J32

- BAY 16**
SB1: B712
B738
B739
E190
SB2:A20N
A21N
B737
AT42
AT72
E170
F70
F100
DH8D

- BAY 15**
SB1: A21N
B712
B738
B739
E190
SB2:A20N
B737
AT42
AT72
E170
F70
F100
DH8D

- BAY 14**
SB1: B712
B738
B739
E190
SB2:A21N
B738
B739
E190
SB3:B737
E190
F100
SB4:A20N
E170
F70
DH8D
SB5:AT72

- BAY 13**
SB1: B712
SB2:A21N
B738
B739
E190
SB3:B737
E190
F100
SB4:A20N
E170
F70
DH8D
SB5:AT72

- BAY 12**
SB1: B712
SB2:A21N
B738
B739
E190
SB3:B737
E190
F100
SB4:A20N
E170
F70
DH8D
SB5:AT72

- BAY 11**
SB1:A35K
SB2:A359
B773
B78X
B77W
SB3:A333
B772
B789
SB4:A332
B788

- BAY 10**
SB1:A21N
B738
B739
SB2:A20N
B712
B737
E170
E190
SB3:F70
F100
DH8D
SB4:AT72
SB5:SF34

REV	DATE	AMENDMENTS
F	30.08.23	UPDATED WITH APRON EXPANSION
E	23.04.22	UPDATED WITH SF34 ON BAY 10
D	16.09.21	PEDESTRIAN MARKS ADDED FROM TERMINAL TO BAY 13
C	09.07.21	BAY 17/18 SF34 J32 OPS ADDED
B	20.12.20	REVISED AFTER SCA & ATC REVIEW
A	10.12.20	FOR INFORMATION

XREF LIST

Includes: SCA_A1
Includes: SB1889-Q11X-BEC-Electrical
Includes: YBSU 20AP05 BASE
Includes: YBSU 20AP05 HATCH
Includes: 2002 RTA HATCH Short RWY
Includes: YBSU 20A10 RPT LMK
Includes: YBSU 20A11 RPT ACFT

Images: SCA LOGO.jpg

Note: This document carries Airworks Consulting Pty Ltd copyright and is reproduced here for information only. The information shown must be verified for accuracy and completeness by necessary investigation and site inspection and measurement. Users of this information hereby agree and indemnify the company against any claim from the use of the information contained herein and associated discussions.

Airworks
simon@airworksconsulting.com.au

CLIENT
Sunshine Coast Airport

DRAWN: AIRWORKS 10.12.20
DESIGNED: AIRWORKS 10.12.20
ORIGINATOR: A BANNISTER
POSITION: AIRFIELD MANAGER
APPROVED:

SUNSHINE COAST AIRPORT
AERODROME MANUAL
AIR TRANSPORT APRON (BAYS 18-10)
PARKING POSITIONS

TITLE

SCALE
7.5 0 7.5 15 22.5 30m
A1 SCALE 1:750

DRAWING No. YBSU-20AP05
REV F