

DETROIT SYMPHONY ORCHESTRA

RENTALS



RENTALS PACKAGES

RENTALS

DETROIT SYMPHONY ORCHESTRA

RATES	3
RENTALS	6
BAR PACKAGES	13
CATERERS	16
FAQS	18

EVENT RENTAL RATES

EVENT RENTAL RATES

VENUES

Orchestra Hall	\$10,000
The Peter D. & Julie F. Cummings Cube	\$6,500
Robert A. & Maggie Allesee Rehearsal Hall	\$3,000
The Herman & Sharon Frankel Donor Lounge	\$3,000
Paradise Lounge	\$3,000
Atrium, per floor	\$750
Sosnick Courtyard (15,000 sq ft outdoor green space)	\$3,000

EVENT STAFFING

Front-of-House Staff, Security Staff, and Stagehands are part of the DSO team for all event rentals at the Max M. & Marjorie S. Fisher Music Center. Labor costs are estimated individually according to each event’s unique needs. Please contact our Event Sales Representative at events@dso.org to receive a quote for your event. All venues include the use of in-house lighting and sound systems (where available) and the use of in-house tables and chairs.

ENHANCEMENTS

Projector & Screen	\$1,400
	<i>Screen is 10'x14'</i>
Piano Rental	
9' Steinway Grand	\$1,000
5' Steinway Grand	\$500
Steinway Upright	\$150
Piano Tuning	\$225 per
Box Office Service	\$1,200
Recording Fee	\$3,500
(Use of 4K Cameras Operated by DSO Stagecrew)	

Please note that all prices are subject to change and may vary with your unique event needs.

For more information or to schedule an appointment to view the venue,
please contact our event sales representative at events@dso.org

RENTALS

ORCHESTRA HALL

DIMENSIONS:**W: 32' L: 48' 1,536 Sq Ft****CAPACITY:****Theatre Style: 188****Reception/Strolling: 256****Banquet: 110****Audience: 2,000**

- Our largest, acoustically perfect concert hall space that can seat up to 2000 guests – featuring three levels of seating with VIP box seating options!
- Our stage space (1,536 square feet) provides a wide range of options for full concert layout options with musician backline needs, unique ceremony arrangements, and elegant drapery.
- This space also is equipped with in-house 4K cameras that can provide live feed to our other venue spaces, as well as digital livestreaming and recording options. We livestream our current DSO performances weekly and utilized this system for all of our DSO performances during the pandemic when we could not have audiences in our space!

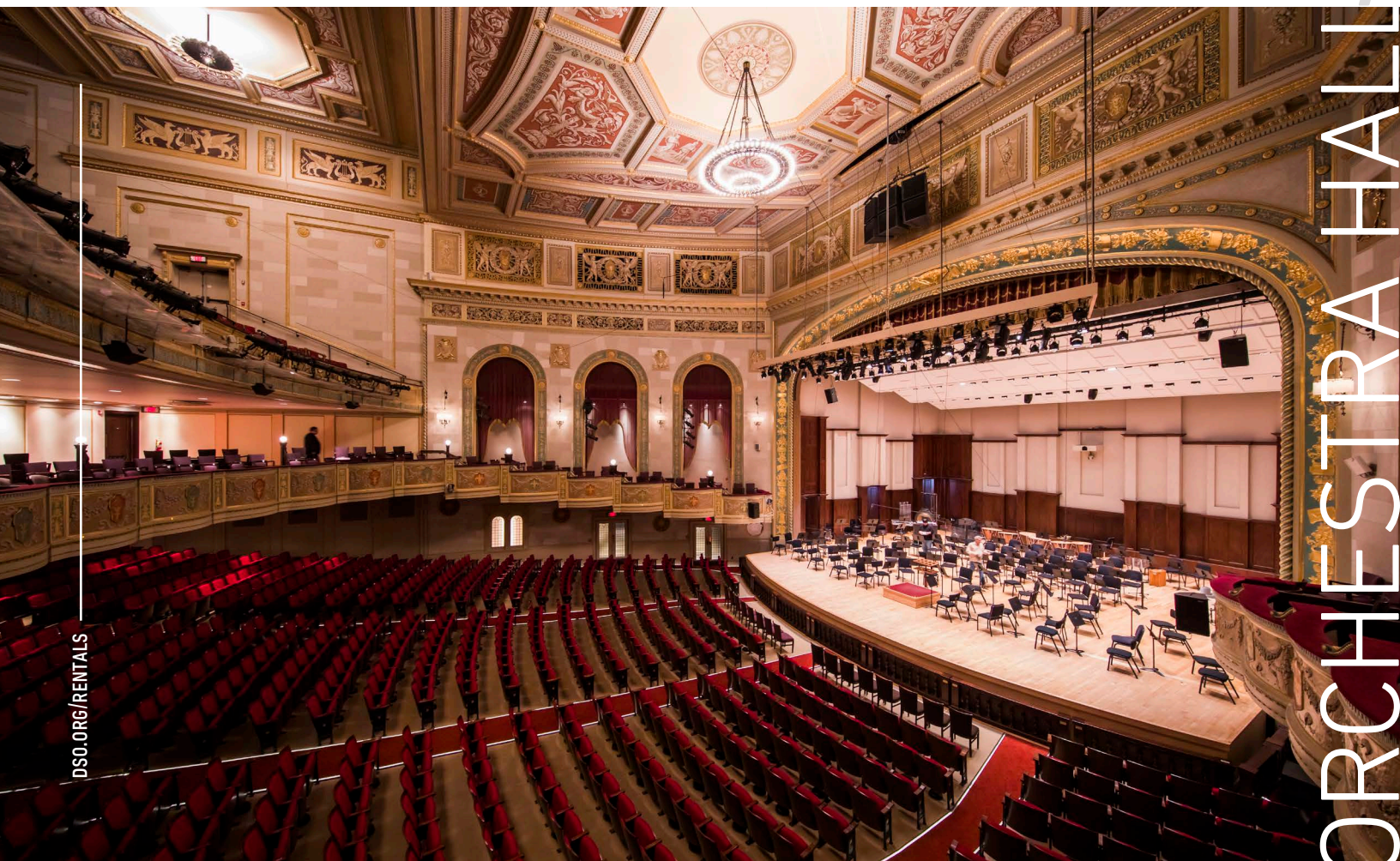

THE PETER D. & JULIE F. CUMMINGS CUBE

DIMENSIONS:**W: 68' L: 75' 4,500* Sq Ft****CAPACITY:**Theatre Style: **450**Reception/Strolling: **750**Banquet: **320**

- Our second largest space that can accommodate approximately 360 guests in our riser seating, 320 for banquet style seating, and up to ~500 for a strolling reception.
- Our Cube features state-of-the-art audio and video technology – but is truly perfect for large scale receptions!
- Additionally, the Cube features a large sliding wall that connects this space directly to our Atrium – creating a large strolling space for guests to move back and forth between the Cube and the Atrium.

*Less 600 square feet for wings and vestibule.



THE WILLIAM DAVIDSON ATRIUM

DIMENSIONS:

W: 32' L: 64' 2,048 Sq Ft

CAPACITY:

Theatre Style: **200**

Reception/Strolling: **300**

Banquet: **150**

- Our atrium serves entrance to patrons visiting The Max, offering an open, bright space for guests to mingle and make their way to our various venue spaces. The atrium can hold up to ~400 guests for a strolling reception, 125 guests for more of a banquet arrangement, on the first floor with an additional 200 (strolling) guests on our second level and 125 (strolling) guests on our third level.
- Serving as our centralized hub, it would be ideal for welcoming guests with beverage/catering service!
- The first floor of our atrium connects beautifully to our Cube space via our sliding wall, as well as Allesee Hall near our main entrance. The second floor connects to both our Donor Lounge and Paradise Lounge – ideal for small receptions and strolling options.

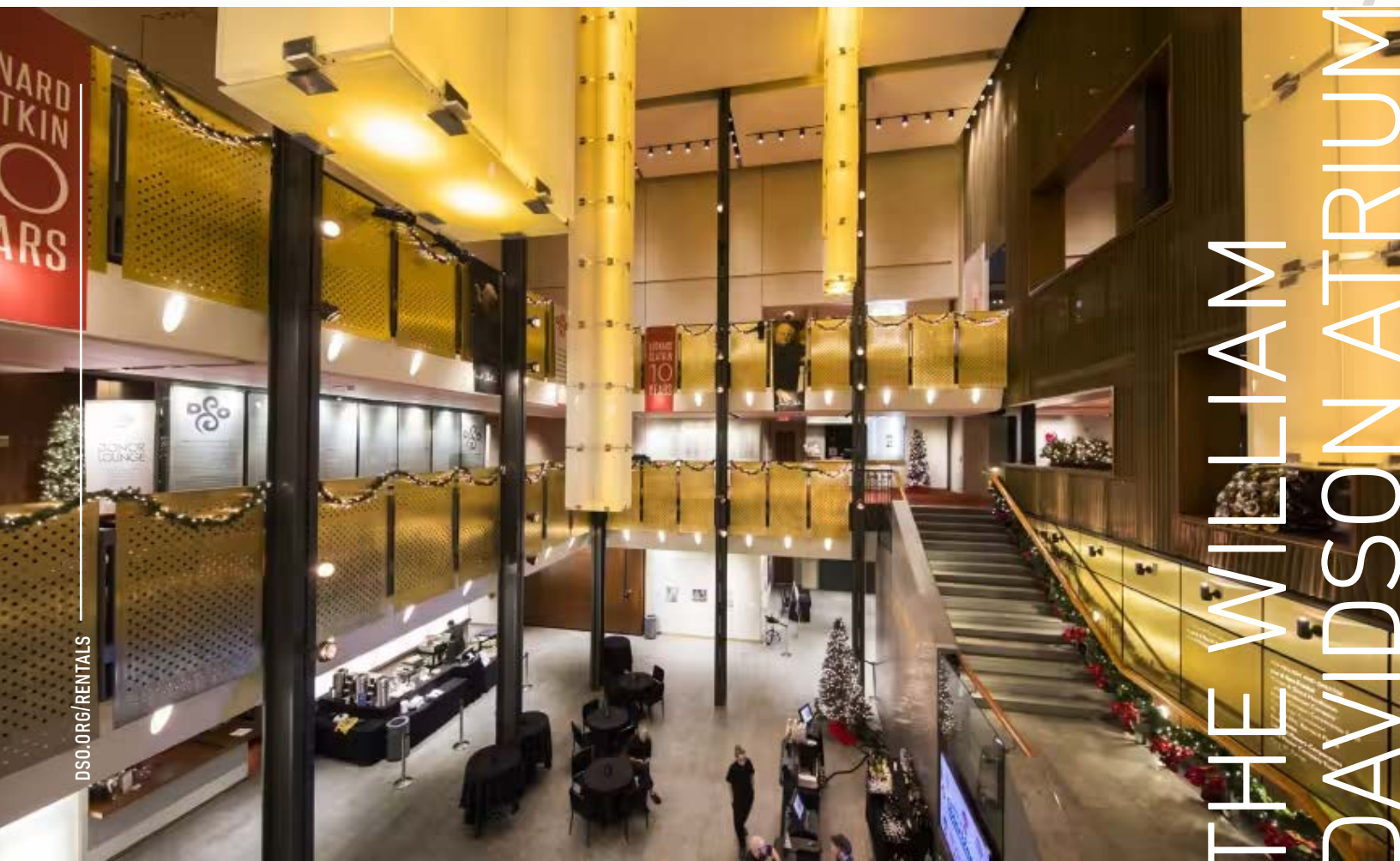

THE ROBERT A. & MAGGIE ALLESEE REHEARSAL HALL

DIMENSIONS:**W: 32' L: 64' 2,048 Sq Ft****CAPACITY:****Theatre Style: 200****Reception/Strolling: 300****Banquet: 150**

- Located directly next the Cube space on our first floor, Allesee Rehearsal Hall offers a large, warm space for a multitude of activities! As an easily transformable space, we can host banquet style for up to 150 guests or strolling receptions for up to ~300.
- Similarly to our Cube space, we can easily equip Allesee Hall for performances, lecture presentations, and a multitude of activations with its long rectangular layout (2,000 square feet total!). The space is fully wired and equipped for portable video equipment.
- We most often utilize this space for banquets, rehearsals for performances, and post-concert receptions. The space features four large doors that easily connect it to our atrium space to create an additional extension of the atrium space! Please see a few photos here!



HERMAN & SHARON FRANKEL DONOR LOUNGE

DONOR LOUNGE

DIMENSIONS:

W: 29' L: 63' 1,827 Sq Ft

CAPACITY:

Theatre Style: **75**

Reception/Strolling: **100**

Banquet: **50**

GREEN ROOM

DIMENSIONS:

W: 19' L: 24' 456 Sq Ft

CAPACITY:

Theatre Style: **25**

Reception/Strolling: **50**

Banquet: **20**

- Located on the second floor of our atrium, the Donor Lounge features an inviting, lush gathering space for up to 80-100 guests for a strolling reception, and up to 50 guests in theatre style seating. The space is home to our wonderful collection of glass sculptures, commissioned by Herman and Sharon Frankel, by Ginny Ruffner and Martin Blank, both of Seattle, and by Lucio Bubacco of Murano, Italy.
- This space is truly one of our favorites for intimate gatherings, post-concert receptions, and VIP experiences.



THE PARADISE LOUNGE

- In addition to Orchestra Hall, this space shared its centennial in 2019! Connected to our original theatre, Paradise Lounge looks over our main throughfare here in Detroit, Woodward Avenue, and features a colorful, classic vintage feel for receptions and dinner events. For a reception setting, we are able to welcome 75 –100 guests for strolling activities. We can also seat up to 75 in a dinner setting for any catering elements!
- We most often use this space for pre-concert and post-concert gatherings with beverage and catering services for our guests entering Orchestra Hall. Paradise Lounge is located on our second floor and connects to our historical entrance and the third floor of Orchestra Hall via wooden staircases.

PARADISE LOUNGE A – LANDING

DIMENSIONS:

W: 21' L: 30' 630 Sq Ft

CAPACITY:

Theatre Style: **25**

Reception/Strolling: **50**

Banquet: **25**

PARADISE LOUNGE B

DIMENSIONS:

W: 15' L: 40' 600 Sq Ft

CAPACITY:

Theatre Style: **50**

Reception/Strolling: **75**

Banquet: **25**

PARADISE LOUNGE C – CORNER

DIMENSIONS:

W: 22.3' L: 22.4' 500 Sq Ft

CAPACITY:

Theatre Style: **n/a**

Reception/Strolling: **25**

Banquet: **25**

12



SPECIALTY BEVERAGE & BAR PACKAGES

HOST-SPONSORED

SOFT DRINKS
 Pop/Soda \$4
 Juice \$4
 Sparkling & Still Water \$4
BEER
 House \$7
 Craft \$7

WINE
 Premium \$11
 Ultra Premium \$12
 Made in Michigan \$12
MIXED DRINKS
 Premium \$12
 Ultra Premium \$13

Made in Michigan \$12
DRINK TICKET
 Premium \$8
 Ultra Premium \$10
 Made in Michigan \$11

**HOST-SPONSORED
BAR PACKAGES**

Price is based on a per person rate for a sixty minute duration.
 Each additional sixty-minute duration will be priced per person
 according to your initial package chosen. Bartender fees are not
 included in package price.

	FIRST HOUR	EACH ADD'L. HOUR
Premium	\$18	\$9
Ultra Premium	\$20	\$10
Made in Michigan	\$18	\$9
Wine & Beer (House)	\$12	\$6
Wine & Beer (Craft)	\$15	\$7
Wine & Beer (Made in Michigan)	\$15	\$7

BAR ADDITIONS

DINNER WINE POUR \$9 per person
 Premium wine of your choice:
 Chardonnay, Pinot Grigio, Pinot Noir, Cabernet, Merlot

CHAMPAGNE TOAST \$7 per person
 Premium sparkling wine

BARTENDER FEE

\$150 for the first two hours and \$20 for each additional hour of service for each bartender.
 Service Charge (20%) and Michigan State Sales Tax (6%) will be added to above prices.
 Prices and items are subject to change without notice due to availability.

PREMIUM BAR**BEER**

Miller Genuine Draft
Miller Light
Corona
Heineken
Bell's Two Hearted IPA

LIQUOR

Tito's
Tanqueray
Canadian Club Whisky

Jack Daniel's Whiskey

Jim Beam Bourbon
Dewar's White Label Scotch
Captain Morgan Spiced Rum
Bacardi White Rum
Patrón

WINE

Chardonnay
White Zinfandel
Merlot

Pinot Grigio

Moscato

CORDIALS & LIQUEURS

Bailey's Irish Cream
Kahlua
Amaretto
Peachtree Schnapps
Triple Sec

ULTRA PREMIUM BAR**BEER**

Miller Lite
Corona
Heineken
Atwater Dirty Blonde Ale
Bell's Two Hearted IPA
Founder's Porter

LIQUOR

Grey Goose Vodka
Bombay Sapphire Gin
Crown Royal Whisky

Jack Daniels Whiskey

Marker's Mark Bourbon
Johnnie Walker Black Label
Scotch
Captain Morgan Spiced Rum
1800 Silver Tequila

WINE

Chardonnay
Pinot Grigio
Merlot
Cabernet Sauvignon

Pinot Noir

Moscato

CORDIALS & LIQUEURS

Bailey's Irish Cream
Kahlua
Grand Marnier
Chambord
Disaronna Amaretto
Drambuie

*Additional wine sections are available. Contact your catering manager for selection and pricing.
Prices and items are subject to change without notice due to availability.

PREFERRED CATERERS

PREFERRED CATERERS

FORTE BELANGER CATERING
248.602.4500
700 Stephenson Highway, Troy, MI 48083

www.fortebelanger.com

SKOSH CATERING
248.313.9245
126 Ferland St, Walled Lake, MI 48390

info@skoshcatering.com
www.skoshcatering.com/

CUTTING EDGE CUISINE
248.677.4380
3999 Walnut Lake Road, West Bloomfield, MI 48323

info@cuttingedgecuisine.com
www.cuttingedgecuisine.com

THIBAUT & MOORE CATERING
586.777.8545
24223 Jefferson Avenue, St. Clair Shores, MI 48080

geoff.cole@tandmcatering.com
www.tandmcatering.com

TWO UNIQUE CATERING
248.549.5242
4303 Delmere Ct, Royal Oak, MI 48073

www.twounique.com

HOLIDAY MARKET CATERING
248.543.4390
1203 S. Main Street, Royal Oak, MI 48067

eblokkamp@holiday-market.com
www.holiday-market.com

FAQ

FAQ

ARE THERE ADDITIONAL FEES?

In addition to the room rental fee, there are also additional charges for Security (\$1,100), cleaning (\$500+ dependent upon spaces), and union stagehand labor. Labor is difficult to quote without knowing in depth details about your event. Stagehand labor charges are always subject to change based on day of needs, equipment rentals, last minute changes etc. If changes to labor fees are needed, those changes will be reflected on a final invoice after your event.

WHAT DO UNION STAGEHANDS DO, AND WHAT DOES THAT COST ENTAIL?

Stagehands will handle setting up tables, chairs, providing lighting, sound, and video needs, and will take care of any equipment moves necessary. Please contact our event team for a more accurate labor quote.

- Since we are a Union House at the DSO, we have strict rules when it comes to professional photography and filming at our facility. Photography is typically acceptable but will need to be cleared by our event team, our stage manager, and possibly our PR team in advance. Film crews are NOT permitted unless they have been authorized by our event team and Stage Manager. Unauthorized film crews will not be granted access to the facility if they attempt to enter on the day of the event. *Additional labor fees may apply to outside film crews*

HOW DOES THE CONTRACT AND DEPOSIT PROCESS WORK?

Following the approval of a proposal, you will be sent a contract outlining all the DSO regulations. If we do not receive the signed contract by the date listed, it will become void and your event date will no longer be held.

- After a signed contract is returned, you will be sent a deposit invoice. The deposit is nonrefundable and will be the total amount of the room rental fee. The remaining balance will need to be paid 7 days before your event. If the remaining balance is not paid within that timeframe, your event will be canceled.
- We will need event insurance on file one week prior to your event date. The specifics of the insurance policy are outlined in the event contract.

DO YOU OFFER TAX EXEMPTION FOR NON-PROFIT ORGANIZATIONS?

Yes! If you are a tax-exempt organization, please send over your Michigan tax exemption form with the Detroit Symphony Orchestra listed as the "Vendor and Address". This form will need to be dated for prior to your event, and filled out correctly based on your tax exemption status.

DO YOU OFFER CATERING?

Catering is available! We do have an in-house caterer, as well as a list of preferred caterers with whom we have existing contracts. Catering is all handled and paid for separately from the rental.



RENTALS PACKAGES

ONLINE:

dso.org

BY PHONE:

313.576.5111

IN PERSON:

Max M. & Marjorie S. Fisher Music Center
Detroit Symphony Orchestra
3711 Woodward Ave
Detroit, MI 48201