



TUBE TRACK SYSTEM

INSTALLATION INSTRUCTIONS



TUBE TRACK SYSTEM Recommended Tools

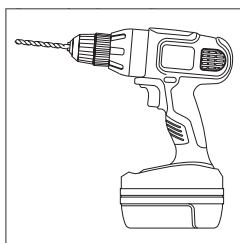

Drill with 1/8",
1/4", and 3/8"
Drill Bits, and
Phillips Bit

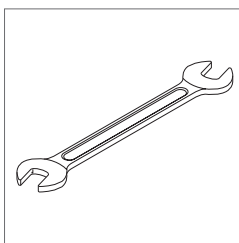

9/16" and 5/8"
Combination
Wrench

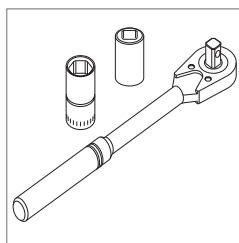

Socket Wrench
with 9/16" and
5/8" Sockets

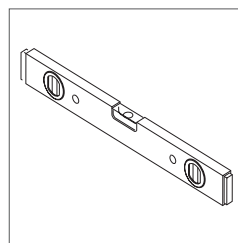

Level

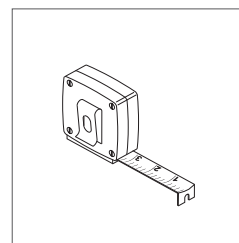

Tape Measure

TUBE TRACK SYSTEM Parts

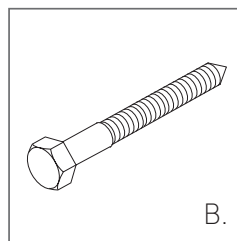
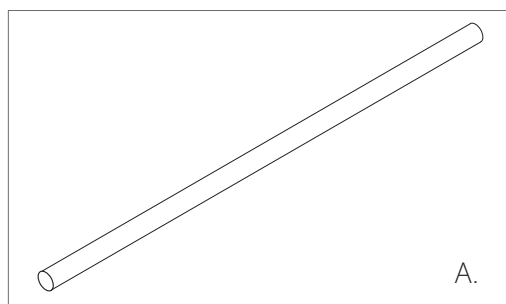

PARTS

- A. Tube Track
- B. Lag Screw
- C. Track Support
- D. Support w/ Stop Block
- E. Floor Mount Door Guide
- F. Phillips Screw
- G. Anti-jump Bracket

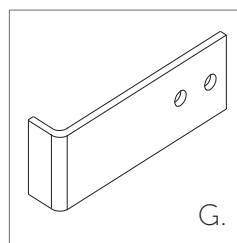
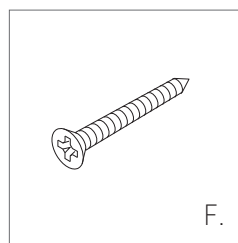
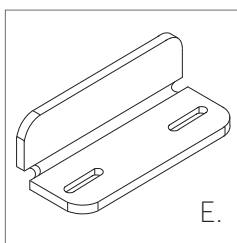
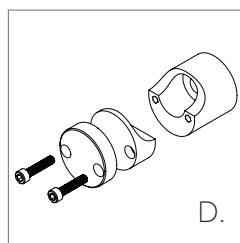
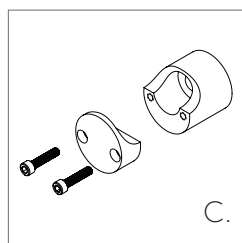

**USE TEAMWORK—WE RECOMMEND
TWO PEOPLE FOR THIS INSTALLATION.**



TUBE TRACK SYSTEM Installation Instructions

FOR TRACKS LONGER THAN 8 FEET:

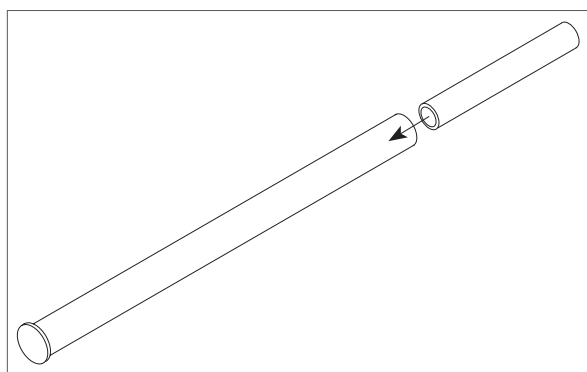
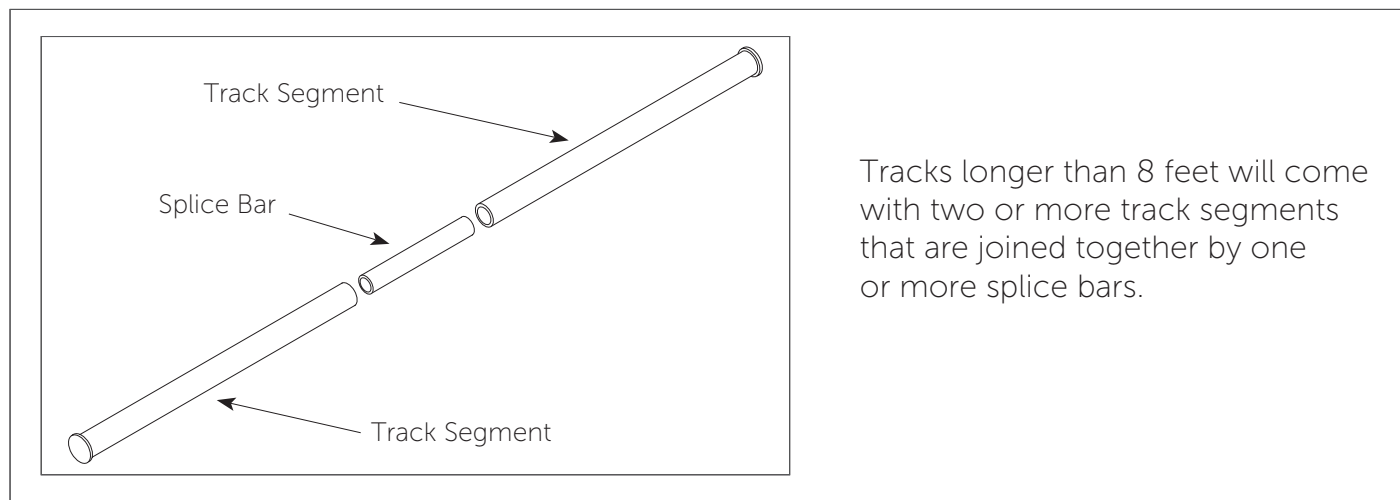

Figure 1

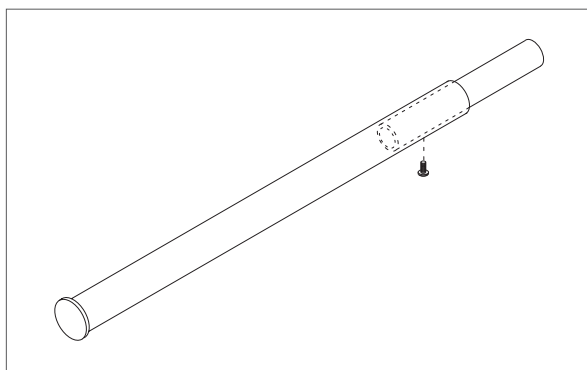

Figure 2

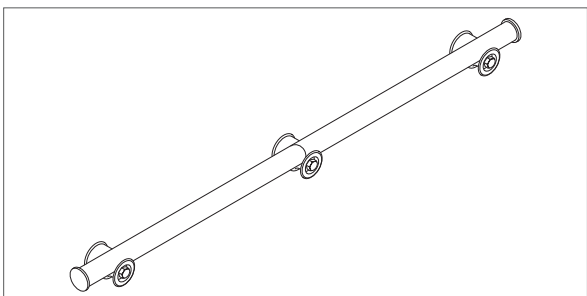

Figure 3

1. Slide the splice bar halfway into a track segment, aligning the hole in the splice bar with the hole in the track segment (Figure 1).
2. Insert the set screw (provided) into the hole in the track segment. Tighten the set screw (Figure 2). Repeat steps 1 and 2 for the other track segment.
3. When installing the tube track, rotate the track so the set screws are facing the wall. For maximum strength, ensure a track support is supporting spliced sections (Figure 3).



TUBE TRACK SYSTEM Installation Instructions

FIRST THINGS FIRST

Check to see if the floor below the track area is level. If the floor rises more than $\frac{1}{2}$ ", the door may rub or not slide open completely. If the floor is not level, measure from the highest point of the floor surface to the recommended track placement and adjust track placement accordingly.

Ensure the track will be installed onto wall studs. If wall studs are not lining up with the installation a header will be required to provide the necessary strength and stability for the track and door.

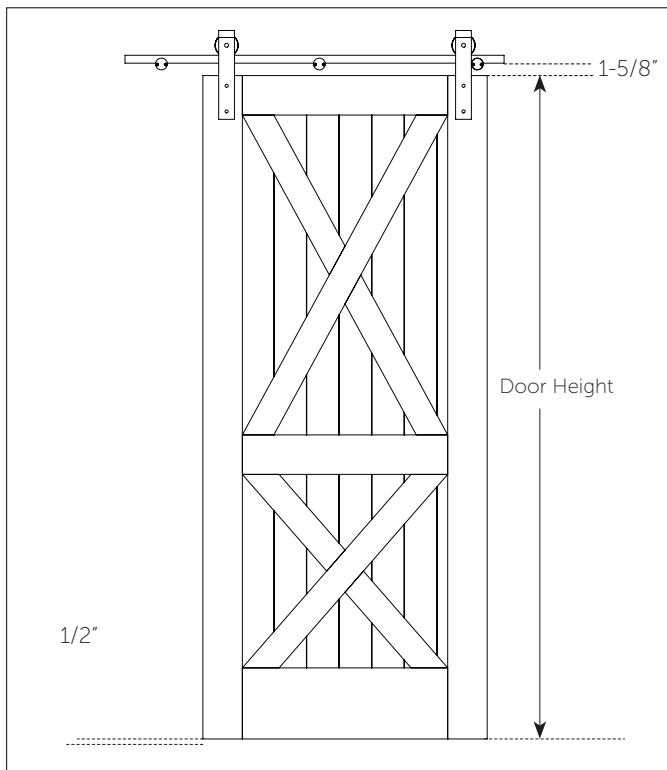

Figure 1

TRACK INSTALLATION

1. To determine where the track should be installed, first measure the height of the door, then add $2\frac{1}{4}$ " to the door length. $\frac{1}{2}$ " will be for the clearance between the bottom edge of the door and the floor. $1\frac{5}{8}$ " will be from the top edge of the door to the center of the support. (Figure 1).
2. Using a level and a pencil, make a line above the doorway the same length as the track.
3. Mark stud locations.
4. Predrill with $\frac{1}{4}$ " bit.



TUBE TRACK SYSTEM Installation Instructions

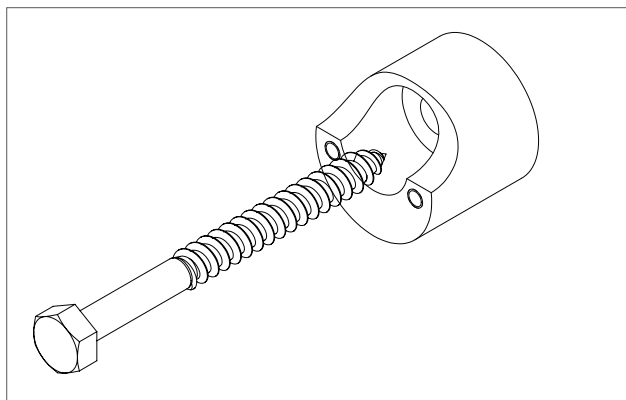

Figure 2

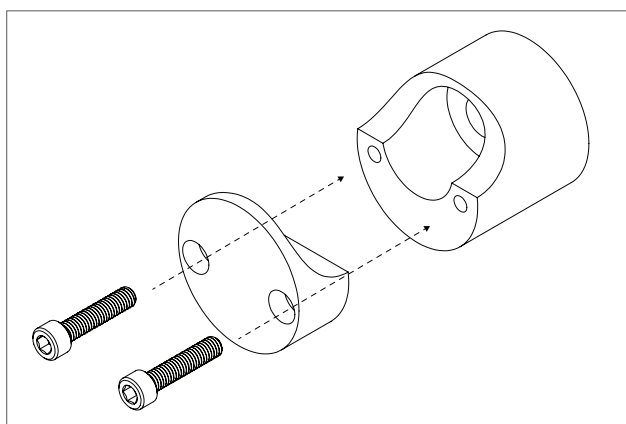

Figure 3

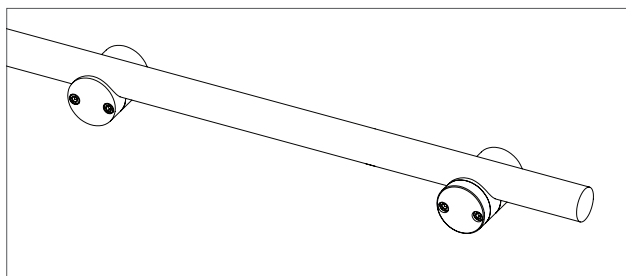

Figure 4

5. Mount back of tube spacer using lag screw (Figure 2).
6. Attach front of tube spacer, but do not tighten (Figure 3).
7. Lay tube track in groove of spacers and adjust side to side for final placement (Figure 4).
8. Tighten front spacers (Figure 5).
9. Mount door to track (Figure 6).
10. Clamp spacer with stop block to track in desired stopping location. If desired stop location is at a pre-existing spacer, remove screws, add stop block and re-insert screws (Figure 7).

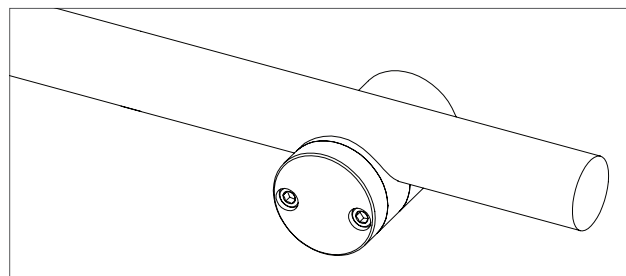

Figure 5

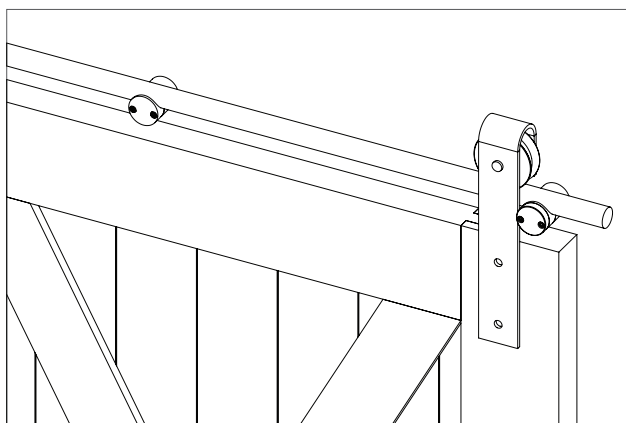

Figure 6

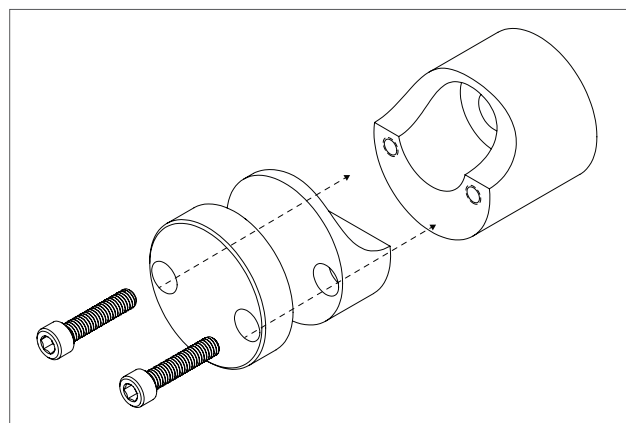

Figure 7

DOOR GUIDE INSTALLATION

NOTE:

Doors using Floor Mount Door Guides will have a groove on the bottom. Ensure this groove is on the opposite end of the Door Hanger Installation.

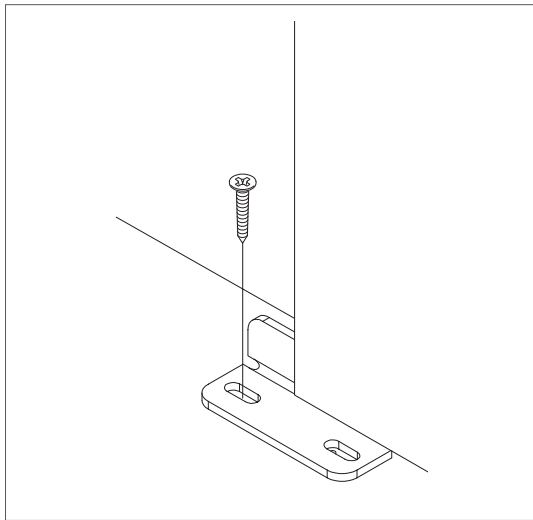
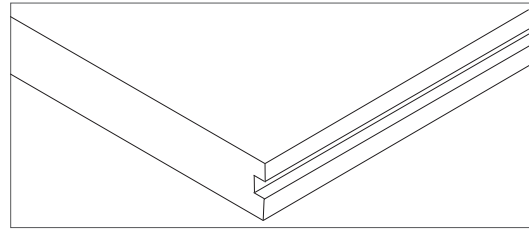

Figure 1

1. With the door in the closed position, ensure the door is hanging straight using a bubble level.
2. Position the door guide (E.) part way into the groove in the bottom of the door (Figure 1).

SUGGESTION:

Use double stick tape on the bottom of the door guide to hold the guide in place.

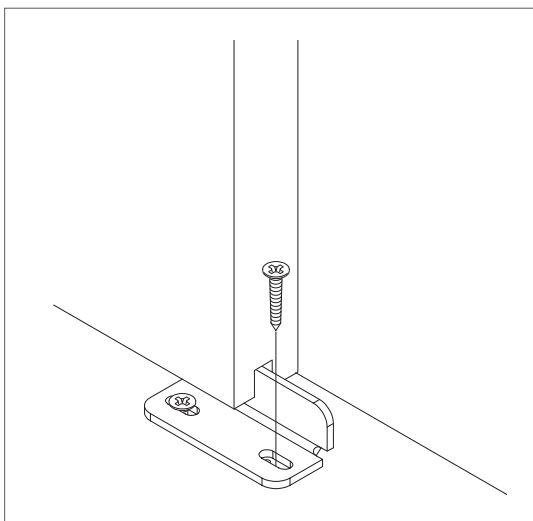

Figure 2

3. Install the Door Guide using a 1" phillips screw (F.) and a drill with a phillips bit.
4. Slide the door toward the open position until the other side of the Door Guide is exposed.
5. Install the second 1" phillips screw (F.) using a drill with a phillips bit (Figure 2).



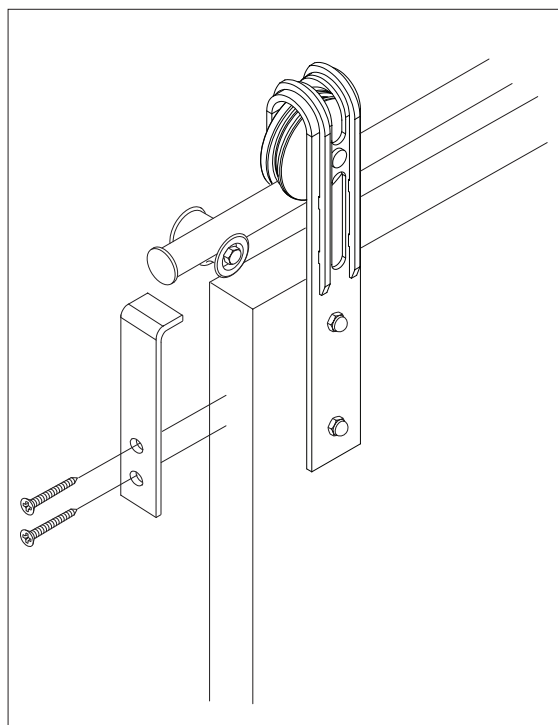

Figure 9

ANTI-JUMP GUIDE INSTALLATION

17. Place the Anti-Jump bracket on the door side, moving the bracket up until it is between 1/8" and 1/16" from the bottom edge of the rail. Mark the placement with a pencil.

SUGGESTION:

Use double stick tape on the back of the anti-jump bracket to hold it in place on the door.

18. Install the bracket to the door edge with 2 phillips screws (provided) using a drill with a phillips bit (Figure 9).
19. Repeat steps 17 and 18 for the opposite end of the door.

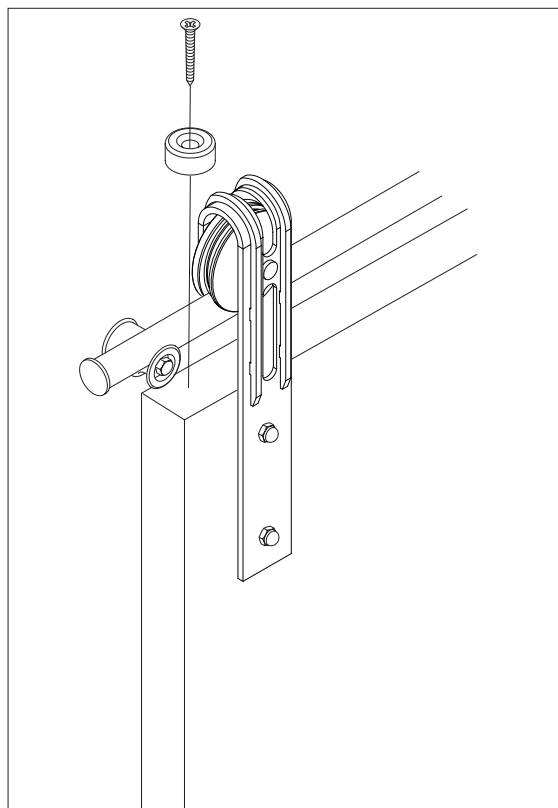

Figure 10

ANTI-JUMP BLOCK INSTALLATION FOR BI-PARTING DOORS

20. Place the Anti-Jump block on the top of the door (Figure 10). Using a drill with a phillips bit, install the the block with the 1" phillips screw (provided).
21. Repeat step 20 for the opposite end of the door.

SUGGESTION:

Use double stick tape on the back of the anti-jump block to hold it in place on the door.



WE LOVE WHAT YOU ARE DOING WITH THE PLACE

CONGRATULATIONS ON YOUR DECISION TO BRING HOME
AN AMERICAN MADE PRODUCT OF THE HIGHEST QUALITY.
WE HOPE YOUR TUBE TRACK SYSTEM BRINGS
ART AND FUNCTION INTO YOUR LIFE.

1-800-891-8312
support@rustica.com
www.Rustica.com

DESIGNED AND CRAFTED ENTIRELY IN THE
U.S.A.



DON'T BE A STRANGER.
FOLLOW US ON SOCIAL MEDIA.

