

Sound**bright**

User Guide



Mini



Contents

Contents -----	01
Features -----	03
Accessories -----	05
Turn ON/OFF -----	06
Charging -----	07
Replace ear tips -----	09
Wearing -----	10
Adjusting Volume/Switch Programs -----	11
Cleaning Your Hearing Device -----	13
Replacing the Wax Filters-----	14
Maintenance And Cleaning -----	15
Precautions for Your Hearing Device -----	16



Contents

Precautions for Your Charing case -----	18
Product Parameters -----	19
Hearing Device Safety Issues -----	20
Common Issues & Troubleshooting Guide -----	21
Warning -----	29

Features

Hearing device

- ① Microphone
- ② Charging contact
- ③ Ear tips
- ④ Pull string
- ⑤ Volume/Program button
- ⑥ Magnetic contact
- ⑦ Acoustic orifice

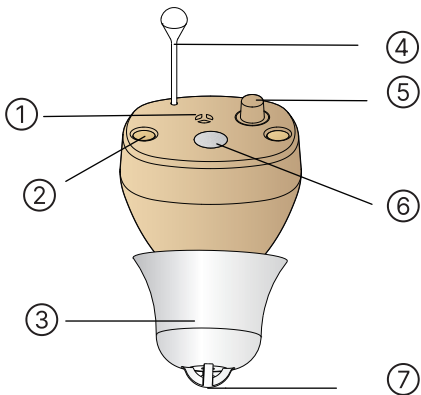

Features

Charging case

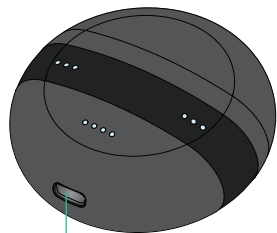

①

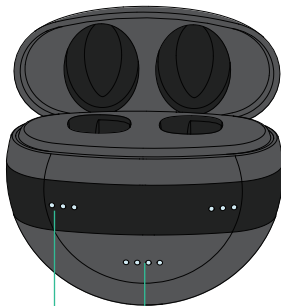

②

③

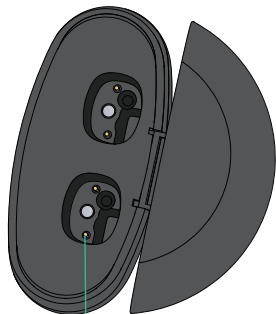

④

① Hearing device charging indicator light

③ Type-C charging port

② Charging case battery indicator light

④ Hearing device charging contacts

Accessories



① S/M/L Ear tips



② Wax Guard

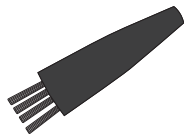

③ Cleaning Brush



④ Adapter

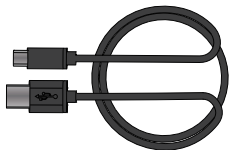

⑤ Charging cable

Turn ON/OFF

Please remove the protective label from the hearing instruments before use.

Turn ON :

Take the device out of the charging case.

Turn OFF :

Put the device back the charging case.

NOTES:



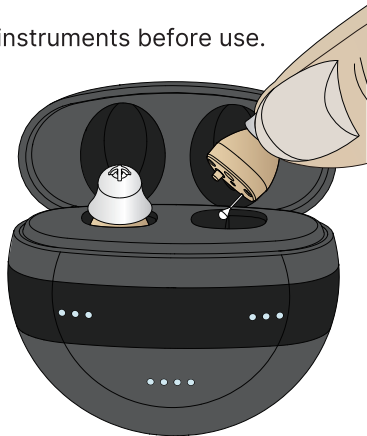

When placing the hearing devices back into the charger case, make sure the hearing devices and charger case are magnetically attached correctly to turn off.



Charging

Charging case Charging

When the battery level in the charger is low, the charger battery indicator will blink and it should be charged soon; when charging, the charger battery indicator will blink and when fully charged, all the charger battery indicators will light.

Indicator status	Battery level in the charger case
	0-25%
	26-50%
	51-75%
	76-100%

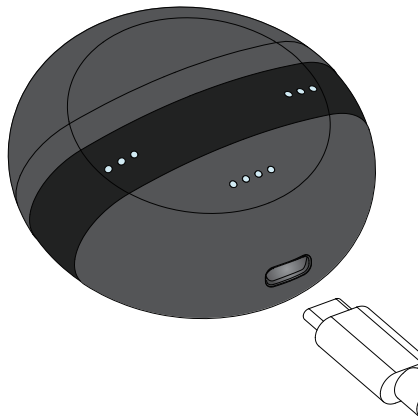

Charging

Hearing devices Charging

Simply place the hearing devices in the charging case to charge. The charging indicator light on the hearing devices will always be on while charging, but will turn off when fully charged.

	Charging	Working
Device	1.5-2 hours	25-30 hours
Case	2-3 hours	Charging devices 4-5 times

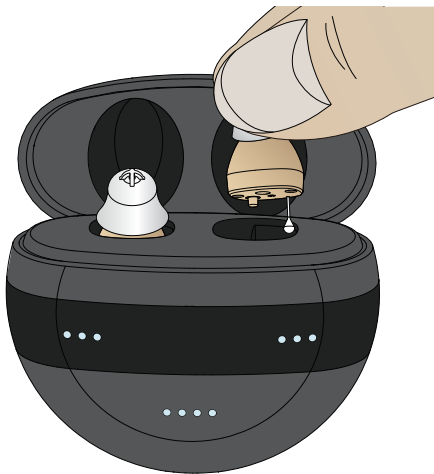

Replace earplugs

In order to provide users with a better wearing experience, we will offer different sizes of ear tips as gifts. If you experience problems such as ear canal swelling and loud hearing devices noises, you can try replacing the ear tips.

- Flip the ear tips along the edge.
- Pinch the hearing devices body and ear tips separately and remove the ear tips.
- During installation, align the ear tips with the sound holes on the hearing devices and push them into the slots on the hearing devices.

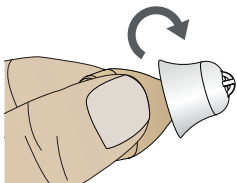

a

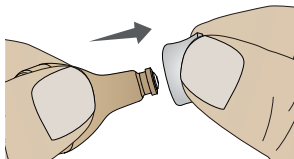

b

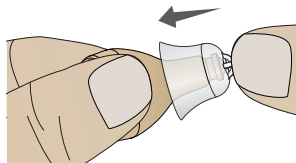

c

Wearing

- Distinguish the hearing devices by the left and right markings, pinch the hearing device and prepare to wear it by pushing the button up.
- Slowly insert the hearing device into the ear canal.
- Fine-tune the hearing device so that it fits comfortably in your ear.

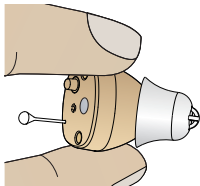

a

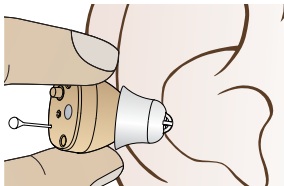

b

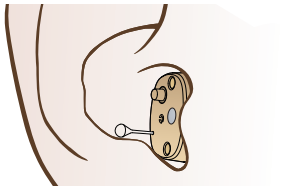

c

NOTES:

- To make it easier to wear, you can pull the outer ear back and up with the opposite hand.
- The device will whistle for a while until the eartip feels secure and tight.

Adjusting Volume/Switch Programs

Adjusting Volume

Hearing instruments have 8 volume levels. When the button is pressed briefly, "beep" is heard for each volume level changed. When the volume reaches its maximum, "beep" "beep" is heard. Pressing the button again will change the volume to the lowest level and the volume will change in a circle: 1,2,3... 8,1, 2, 3... 8,1...

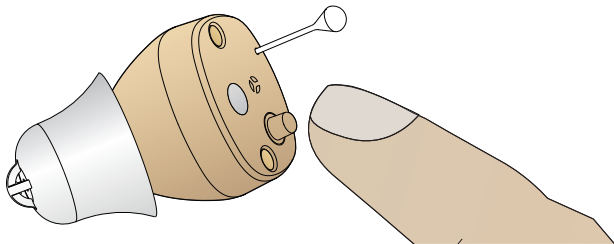

Adjusting Volume/Switch Programs

Switch Programs

Your hearing devices have three different built-in programs. Press and hold the button for 3 seconds. When you hear the beep, the program change is complete.

MODE	Alert Sound	Hearing Mode
1	1 beep("beep")	Quiet environment
2	2 beeps("beep beep")	Noise Reduction Hearing Mode
3	3 beeps("beep beep beep")	Outdoor Hearing Mode

NOTES:

Your hearing device has a volume and program memory function. Each time you turn it on, your hearing device will automatically synchronize the volume and program set when it was last turned off.

Cleaning Your Hearing Device

Daily maintenance

After removing the devices, use the supplied cleaning brush to clean earwax and debris from the device ear tips, sound outlet, and microphone.

Weekly maintenance

Wipe charging case and hearing devices body (such as charging contact etc.) with a soft, lint-free cloth.

Quarterly maintenance

Replace the device domes and the wax tips every 2-3 months.

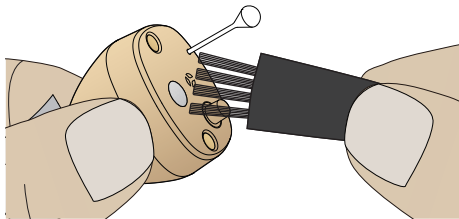

Replacing the Wax Filters

- Remove the ear tips and insert the disassembly end of the tool into the sound outlet hole.
- Pull out the tool and remove the old wax filter.
- Align the installation end of the tool with a new wax filter and insert into the sound outlet hole of the device.
- Make sure the wax filter is securely in place and gently pull the tool out.

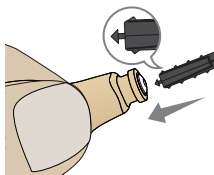

a

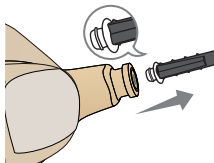

b

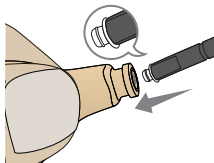

c

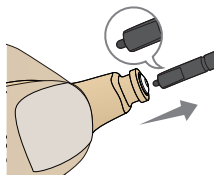

d

Maintenance And Cleaning

Care And Maintenance

- When not in use, store in a safe area away from small children and pets.
- Do not place the hearing devices or charging base near high temperature areas such as stoves or direct sunlight.
- Do not leave the hearing devices in a humid place, such as a bathroom, for extended periods of time.
- Do not pierce the microphone openings with sharp objects to avoid damage. to avoid damage.
- Do not disassemble or attempt to repair the unit yourself. Doing so will void your warranty.

Cleaning Your Equipment

It is important to keep your devices clean and dry. On a daily basis, wipe them clean. It is important to keep your hearing devices clean and dry. Wipe them daily with with a soft cloth or tissue. To prevent potential damage from excessive moisture or perspiration, the use of a drying kit is also recommended.



Precautions for Your Hearing Device

- Keep your hearing devices clean. Extreme temperatures (heat or cold), moisture, and foreign substances can result in poor performance.
- Use the cleaning brush tool or soft cloth to clean debris from around the buttons, microphones, and charging contacts; inspect the receiver, ear dome, and charging case regularly.
- Never use water, solvents, cleaning fluids or oils to clean your hearing devices.
- Charging contacts should always be kept clean and dry.
- Always store your hearing devices in the charging case when not in use or cleaning.
- The device's maximum output sound pressure level is under the product software control, which ensures the end user cannot be exposed to sound pressure levels higher than 117 dB, even in the event of device failure.



Precautions for Your Hearing Device

- Do not wear your hearing device during X-ray, MR scans, CT scans, short wave diathermy, or similar radiation treatments.
- Please take off your hearing device before you go into high electrical fields or strong magnetic fields (such as transformer substations or power stations), and leave your hearing device outside.



Precautions for Your Charging case

- Keep your charger clean. Heat, moisture and other materials can result in poor performance.
- Using the provided cleaning brush keep the charging ports clear of debris.
- Do not use water, solvents or cleaning fluids to clean the charging ports.
- Store your charger in a clean and dry location, i.e. a dresser or shelf rather than the bathroom or kitchen.

Product Parameters

Parameters	
Max OSPL90	<117dB
FHA OSPL90	101±4dB
FOG50	≤41dB
FHA Avg	30±4dB
Frequency Range	F1<250Hz F2>5000Hz
Eq.Input Noise	≤32dB
THD at (500/800/1600Hz)	≤3%



Hearing Device Safety Issues

Operating Conditions

- Temperature: 0-40 °C
- Humidity: <80%
- Voltage DC: 1.4V
- Input power: 3.5mW
- Atmospheric pressure: 86kPa~106kPa

Transportation And Storage Conditions

- Temperature: 0°C-50 °C (32°F-122°F)
- Humidity: 30%-93%

NOTES:

The hearing device must only be used by the intended person.

Common Issues & Troubleshooting Guide

No sound or not working

There can be a few reasons why your hearing device may appear to be not working. The most common reasons are:

The volume is too low

- To increase the volume use the provided tool to turn the dial clockwise.

Blockage

- Clear any debris or wax buildup from the eartips and microphones.



Common Issues & Troubleshooting Guide

Help with whistling feedback noise

The most common reason for hearing a whistling feedback noise is that the hearing device is not properly seated in your ear.

Wearing your hearing device too loosely can cause whistling. Furthermore, if you have a build up of earwax, it can cause a blockage in your canal. This can interfere with your hearing device.

Hearing device works by transmitting sound into your ear canal. If this sound has nowhere to go, it will bounce back into your hearing device, causing a whistling feedback noise.



Common Issues & Troubleshooting Guide

Tips to help alleviate whistling

1. Ensure the hearing device is properly secured and fitted snugly.
2. Choose a slightly larger ear dome that fits your entire ear.
3. Try reducing the volume to start, and then slowly increasing the volume as needed.
4. Make sure to get your ears professionally cleaned and check your hearing device for any clogged vents.

Common Issues & Troubleshooting Guide

SYMPTOM	POSSIBLE CAUSES	SOLUTIONS
No Sound	Volume too low	Increase volume if volume control available
	Device is not charged	Place charging the hearing device until the indicator is lighted in blue color
	Microphones are clogged	Clean out any debris from the mic holes
	Ear Domes clogged	Clean out any debris from the ear domes
Voices are low, very weak, or unclear	Low battery	Place the devices into the charging case to charge
	Ear Domes are too loose	Choose a suitable size ear dome, wear it correctly
	Earwax in ear dome	Clean out any debris from the ear domes and receiver area with the cleaning brush
	Hearing has changed	Contact your physician to report any sudden drop in hearing

Common Issues & Troubleshooting Guide

SYMPTOM	POSSIBLE CAUSES	SOLUTIONS
No SoundHearing devices whistling in the charging case	Incorrect orientation	Ensure the USB cable is connected to the Charging base plugged into power. The base power status lights will blue to indicate charging
	Charger battery depleted	Reposition your hearing devices in their slots, ensuring the contact points are touching the charge points in the case
After the hearing device is connected, the hearing device indicator is not lit	Poor contact between hearing device and charging case	Reinsert the hearing device into the charging base
	Hearing device reverse	Check to see if the hearing device is reversed

Common Issues & Troubleshooting Guide

SYMPTOM	POSSIBLE CAUSES	SOLUTIONS
Hearing device has no sound	Battery fully discharged	Connect the hearing device to the charging base for charging
The voice is very weak and unclear	Low battery	Connect the hearing device to the charging base for charging
	Volume is set too low	Increase volume if volume control available
	Ear Domes are too loose	Hearing device not inserted correctly into ear, wear it correctly
Hearing device plays notification sound	Indication for low battery	Charge hearing device

Common Issues & Troubleshooting Guide

SYMPTOM	POSSIBLE CAUSES	SOLUTIONS
Hearing device plays notification sound	Indication for low battery	Charge hearing device
Indicator light on hearing device does not light up when hearing device placed in charging case	Hearing device not inserted correctly into charging case	Insert hearing device correctly into charging case
	Charger not connected to power source	Connect charger to external power supply
	Battery fully discharged	Wait three hours after placing hearing device in charging case, regardless of LED behavior

Common Issues & Troubleshooting Guide

SYMPTOM	POSSIBLE CAUSES	SOLUTIONS
After the hearing device is connected, the hearing device charging indicator is not lit	Poor contact between hearing device and charging case	Reinsert the hearing device into the charging case
	Hearing device reverse	Check to see if the hearing device is reversed
Hearing device indicator lights are dark or dim	Dirty charging contacts	Clean the contacts of the hearing device and the charging case
Charging does not start	Hearing device not inserted correctly into charging case	Insert hearing device correctly into charging case

Warning

WARNING: If you are younger than 18, do not use this.

You should go to a doctor, preferably an ear-nose-throat doctor (an ENT), because your condition needs specialized care. Over-the-counter hearing aids are only for users who are age 18 or older.

WARNING: When to See a Doctor.

- Your ear has a birth defect or an unusual shape. Your ear was injured or deformed in an accident.
- You saw blood, pus, or fluid coming out of your ear in the past 6 months.
- Your ear feels painful or uncomfortable.
- You have a lot of ear wax, or you think something could be in your ear.
- You get really dizzy or have a feeling of spinning or swaying (called vertigo).
- Your hearing changed suddenly in the past 6 months.
- Your hearing changes: it gets worse then gets better again.
- You have worse hearing in one ear.
- You hear ringing or buzzing in only one ear.

Warning

WARNING: This hearing aid should not cause pain when inserting it.

Remove this device from your ear if it causes pain or discomfort when you insert or place it. To try again, make sure to follow the instructions. If you feel pain or place it. To try again, make sure to follow the instructions. If you feel pain or discomfort again, contact the manufacturer. If you pain or discomfort doesn't go away, contact your hearing healthcare professional. You can also report this to FDA as an adverse event according to the instructions that appear later.

Caution: This is not hearing protection.

You should remove this device if you experience overly loud sounds, whether short or long-lasting. If you're in a loud place, you should use the right kind of hearing protection instead of wearing this device. In general, if you would use ear plugs in a loud place, you should remove this device and use ear plugs.



Warning

Caution: The sound output should not be uncomfortable or painful.

You should turn down the volume or remove the device if the sound output is uncomfortably loud or painful. If you consistently need to turn the volume down, you may need to further adjust your device.

Caution: You might need medical help if a piece gets stuck in your ear.

If any part of your hearing aids, like the eartip, gets stuck in your ear, and you can't easily remove it with your fingers, get medical help as soon as you can. You should not try to use tweezers or cotton swabs because they can push the part farther into your ear, injuring your eardrum or ear canal, possibly seriously.

Warning

Note:What you might expect when you start using a hearing aid.

A hearing aid can benefit many people with hearing loss.However,you should know it will not restore normal hearing,and you may still have some difficulty hearing over noise.Further,a hearing aid will not prevent or improve a medical condition that causes hearing loss.

People who start using hearing aids sometimes need a few weeks to get used to them.Similarly,many people find that training or counseling can help them get more out of their devices.

If you have hearing loss in both ears,you might get more out of using hearing aids in both,especially in situations that make you tired from listening-for example,noisy environments.

HEARING BETTER ENJOY LIFE