

# MODULAR ROLLER BRUSHES

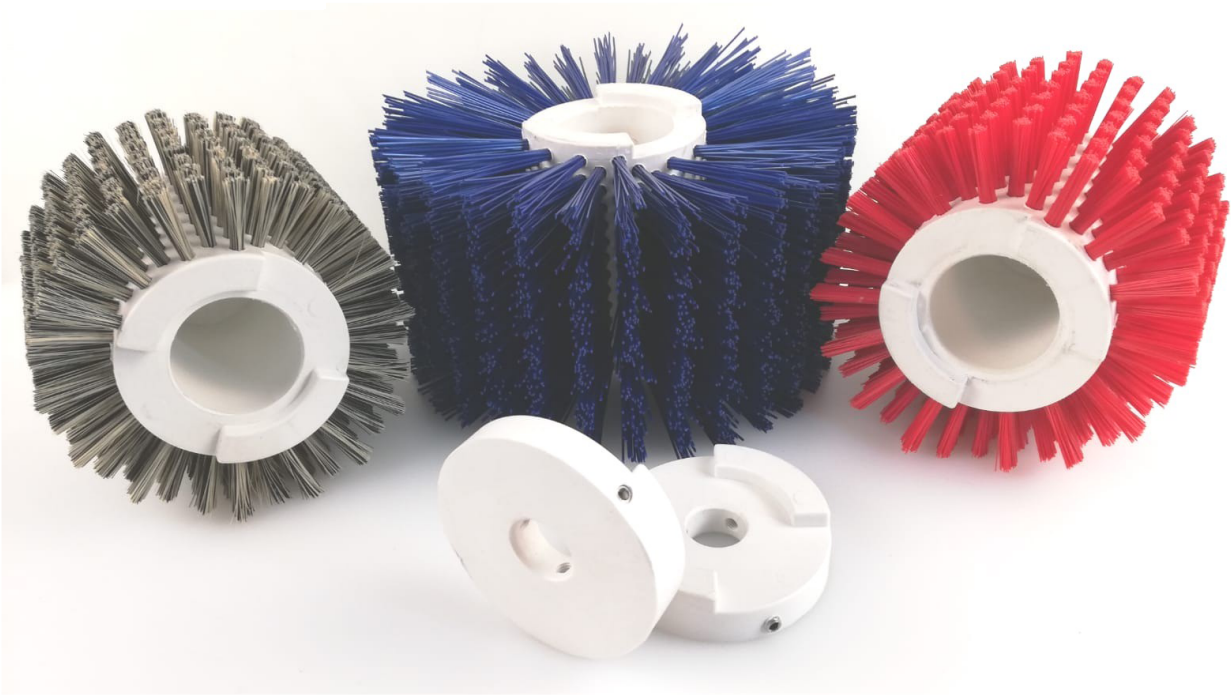

- Meets food industry and hygienic requirements
- Economic product
- Quick manufacturing
- A wide range of filling ( fibre and implementation)
- Suitable for many manufacturing processes



## Module 60

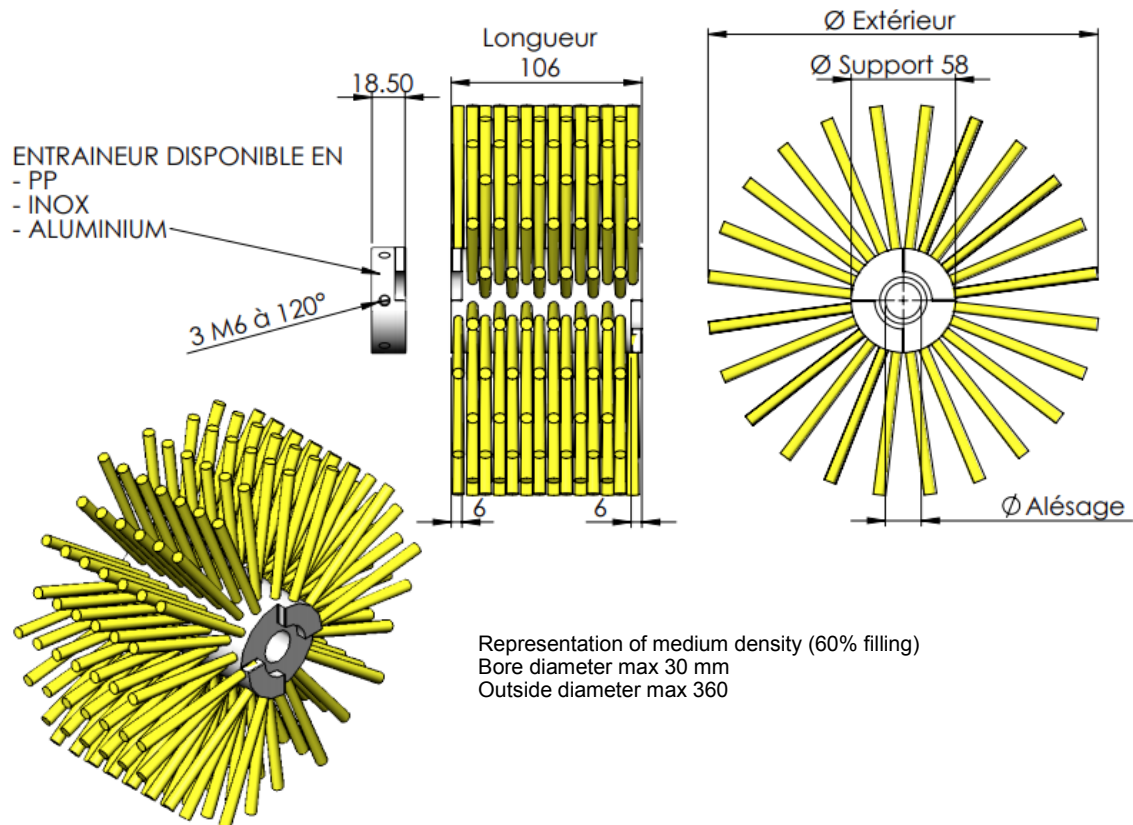

## Module 80

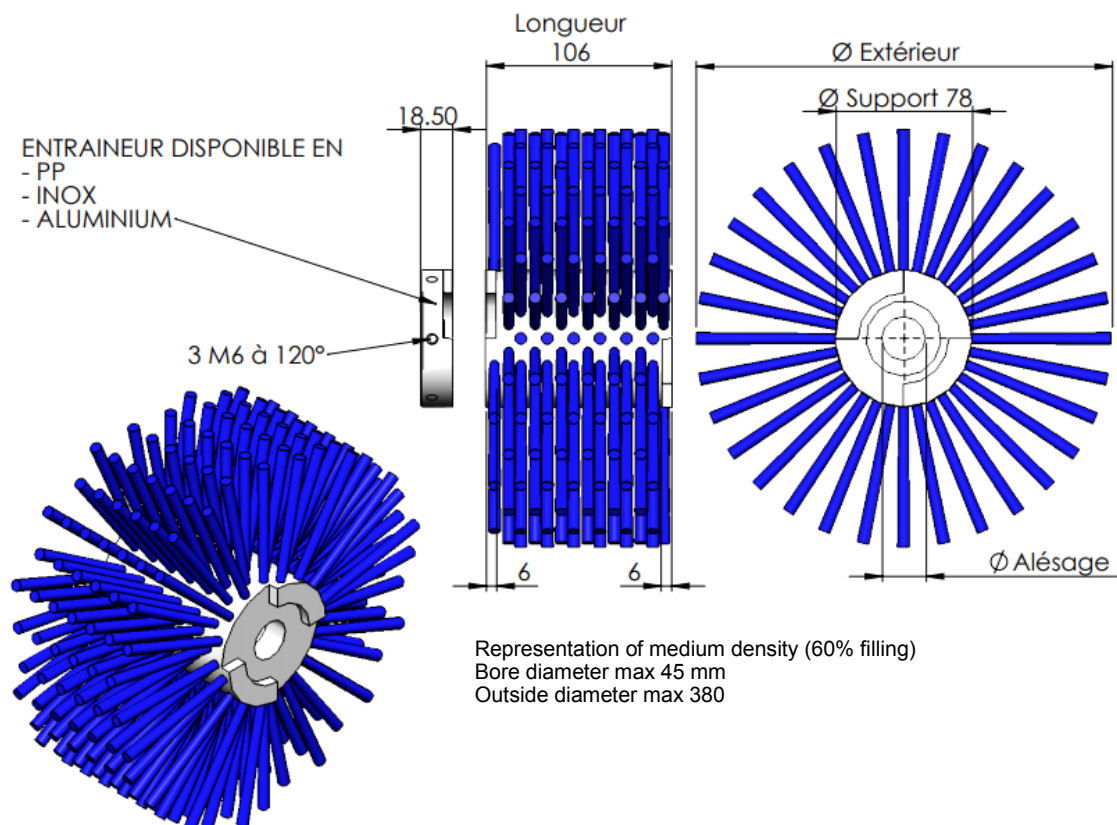

## Module 110

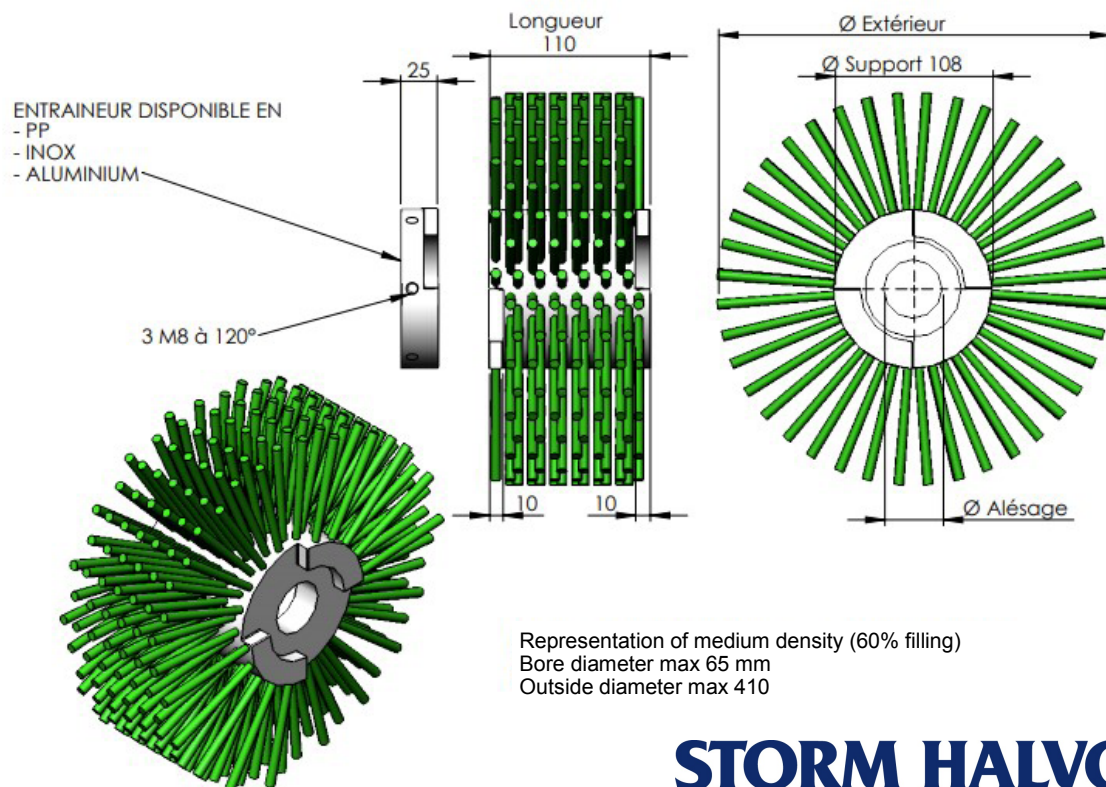

**STORM HALVORSEN**  
KOMPONENTER TIL INDUSTRIEN

## Module 130

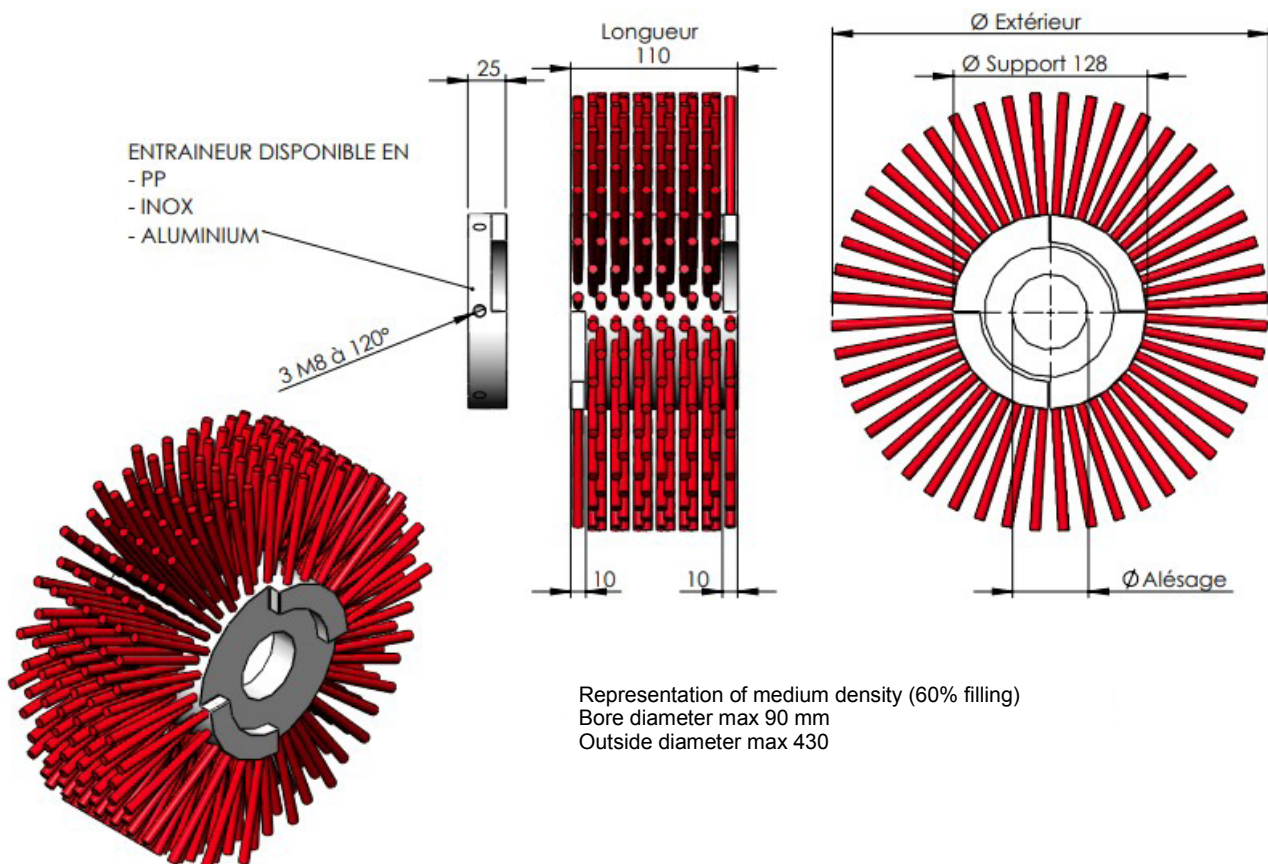

**STORM HALVORSEN**  
KOMPONENTER TIL INDUSTRIEN



# Technical information

## Fillings

### Densities

#### LOW ( 40%)

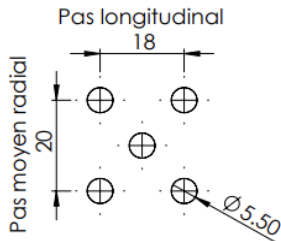

#### MEDIUM (60%)

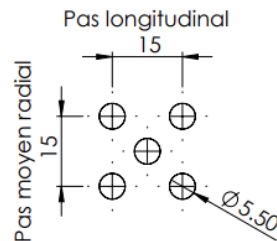

#### HIGH (80%)

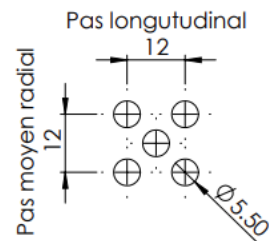

### HELICALS AND V-SHAPE

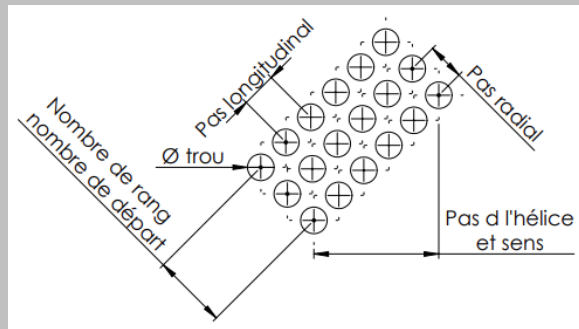

## Fibres

### Synthetic

- Nylon 66
- Nylon 6.12
- Nylon 6.11
- PBT
- PE
- PP
- Pekalon
- Silicium carbide

### Vegetal

- Tampico

### Metal

- Black steel
- Brass coated steel
- Stainless steel
- Brass
- Bronze

### Animal

- Pig bristle
- Goat Hair
- Horse hair