



CONTACT US @ 855-355-2724

E-Mail: [Sales@brahelectric.com](mailto:Sales@brahelectric.com)

[www.Brahelectric.com](http://www.Brahelectric.com)

## PRODUCT DATA SHEET



Contactors

Picture is for reference only,  
Actual Kit may vary slightly

### Coil Voltage Selection Chart BLC2D50XXX

BLC2D50	110/120VAC
BLC2D5010	110/120VAC
BLC2D5010-B6	24VAC
BLC2D5010-B7	24VAC
BLC2D5010-G6	110/120VAC
BLC2D5010-G7	110/120VAC
BLC2D5010-M6	220VAC
BLC2D5010-M7	220VAC
BLC2D5010-Q6	380VAC
BLC2D5010-R7	440VAC
BLC2D5010-T6	480VAC
BLC2D5010-U6	240VAC
BLC2D5010-U7	240VAC

### **PART NUMBER- BLC2D5010-U6:**

BRAH Electric, Tesys D, LC2D5010-U6, 80 amp, 600 volt, 3 pole, reversing contactor, complete with 240VAC control coil, 1 normally open auxiliary contact, suitable for use with Telemecanique TeSys D type LC2D, direct substitute contactor for Telemecanique OEM LC2D5010-U6

### **PRODUCT SPECIFICATIONS**

Manufacturer	BRAH Electric
Sub-Category	Telemecanique
Family	Tesys D
Type	LC2D, BLC2D
Coil Voltage Min	240
Coil Voltage Max	240
Voltage	600
Amperage	80
Poles	3
Phase	3

**Warranty:** All Products sold by BRAH Electric are guaranteed to be free of defect for a period of two years, under the condition that the product has been installed and operated properly. All items proven defective within the one year period will be replaced by BRAH Electric. In the event that we cannot provide a direct replacement, your monies will be refunded in full. We are not responsible for any consequential losses or damages outside of the defective product as well as any replacements or repairs performed by another party without our written authorization from BRAH Electric.

REVISIONS				
ZONE	REV.	DESCRIPTION	DATE	APPROVED

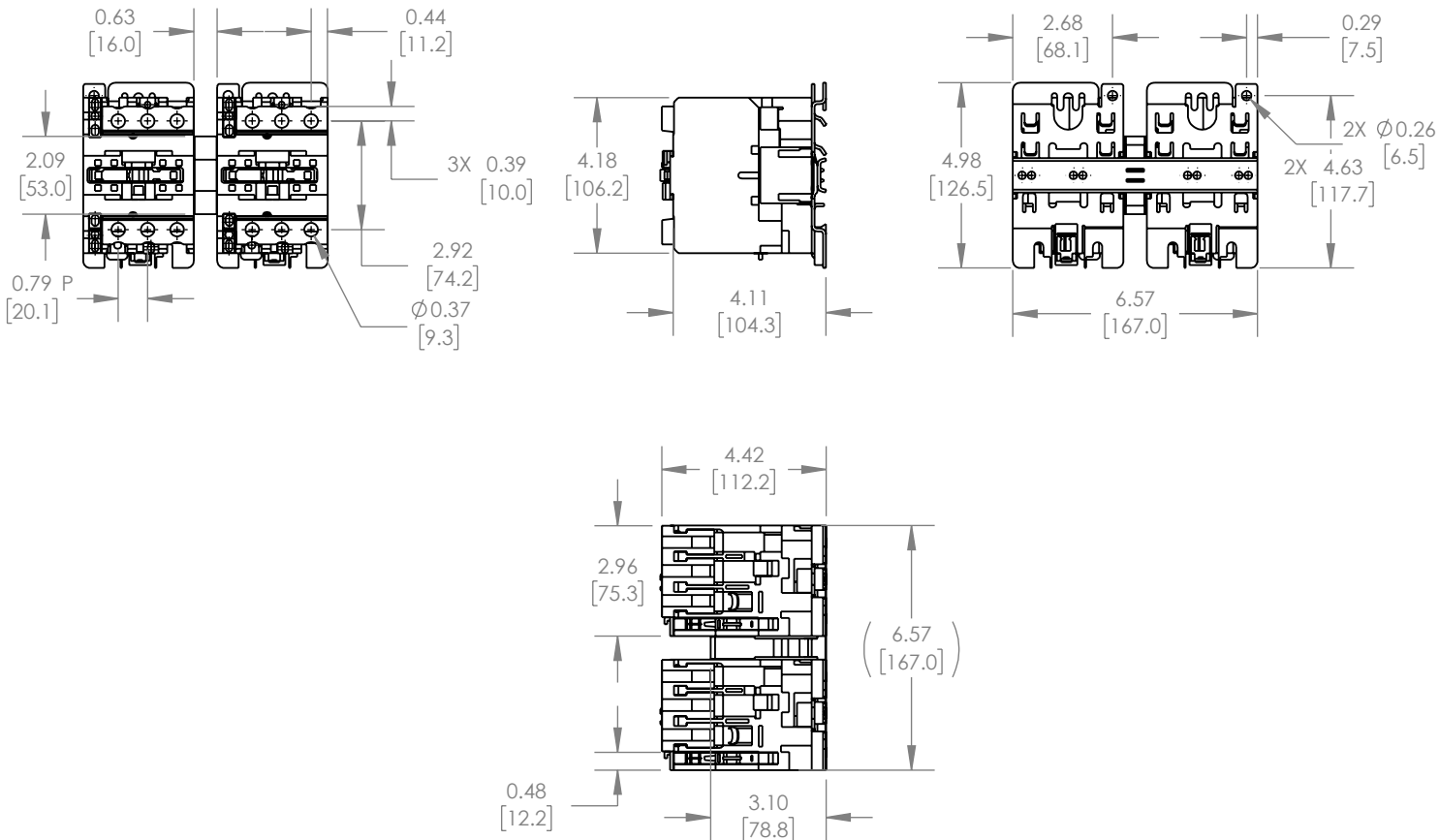
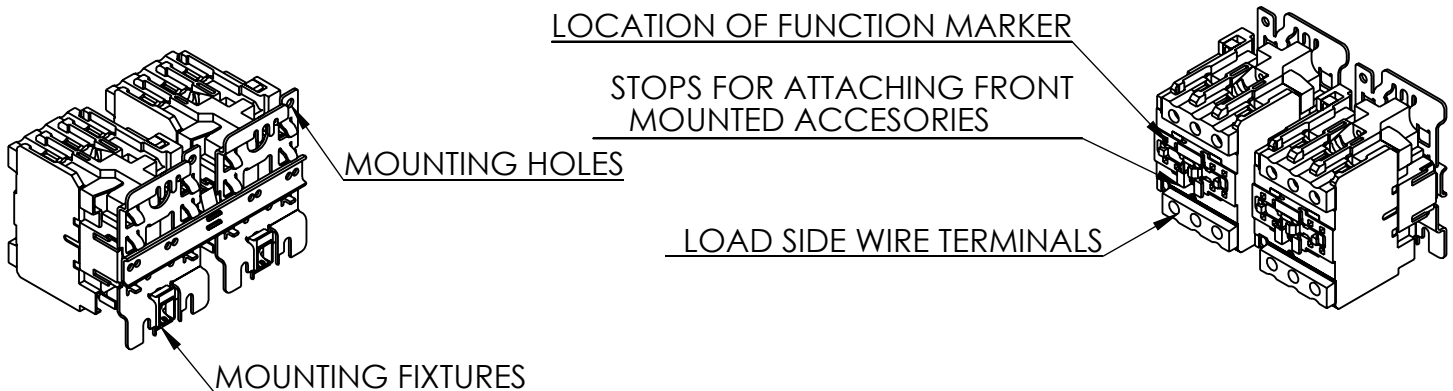

\*NOTE: BRAH ELECTRIC CONTACTOR BLC2D5010-U6 IS AN AFTERMARKET DIRECT REPLACEMENT FOR LC2D5010-U6, SERIES. SUITABLE FOR USE WITH LC2-D SERIES MOTOR CONTROL SYSTEMS

THIRD ANGLE PROJECTION

**PROPRIETARY AND CONFIDENTIAL**

THE INFORMATION CONTAINED IN THIS DRAWING IS THE SOLE PROPERTY OF BRAH ELECTRIC. ANY REPRODUCTION IN PART OR AS A WHOLE WITHOUT THE WRITTEN PERMISSION OF BRAH ELECTRIC IS PROHIBITED.

UNLESS OTHERWISE NOTED  
ALL DIMENSIONS ARE IN INCHES  
METRIC UNITS ARE DISPLAYED  
BENEATH IN [ MM. ]

MATERIAL  
MOLDED PLASTIC CASE  
FINISH  
N/A

DO NOT SCALE DRAWING

**MAGNETIC CONTACTOR**

SIZE <b>A</b>	DWG. NO. <b>BLC2D5010-U6</b>	REV. <b>A</b>
SCALE: 1:5	WEIGHT: 3.2 LBS	SHEET 1 OF 1