



CONTACT US @ 855-355-2724

E-Mail: Sales@brahelectric.com

www.Brahelectric.com

PRODUCT DATA SHEET

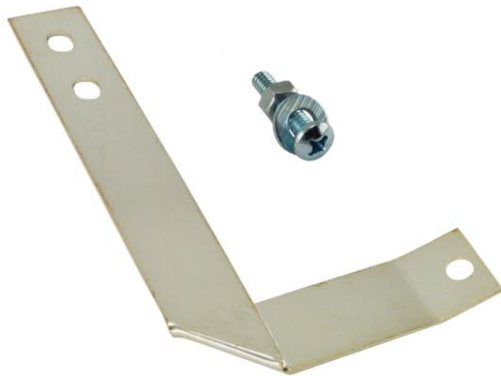

PART NUMBER – GE400G: BRAH Electric aftermarket direct replacement for General Electric, Spectra Series, ground kits, ground kit assemblies, 400-600A, to be used with type AC, SB, SL bus plugs

Bus Plug Accessories
PART NO. GE400G

PRODUCT SPECIFICATIONS

Manufacturer	BRAH Electric
Sub-Category	Ground Kits
Family	Spectra Series
Type	GE
BUS Plug For	AC,SB,SL
Voltage	600
Amperage Min	400
Amperage Max	600

Warranty: All Products sold by BRAH Electric are guaranteed to be free of defect for a period of one year, under the condition that the product has been installed and operated properly. All items proven defective within the one year period will be replaced by BRAH Electric. In the event that we cannot provide a direct replacement, your monies will be refunded in full. We are not responsible for any consequential losses or damages outside of the defective product as well as any replacements or repairs performed by another party without our written authorization from BRAH Electric.

REVISIONS				
ZONE	REV.	DESCRIPTION	DATE	APPROVED

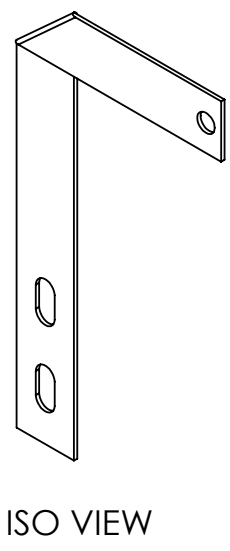
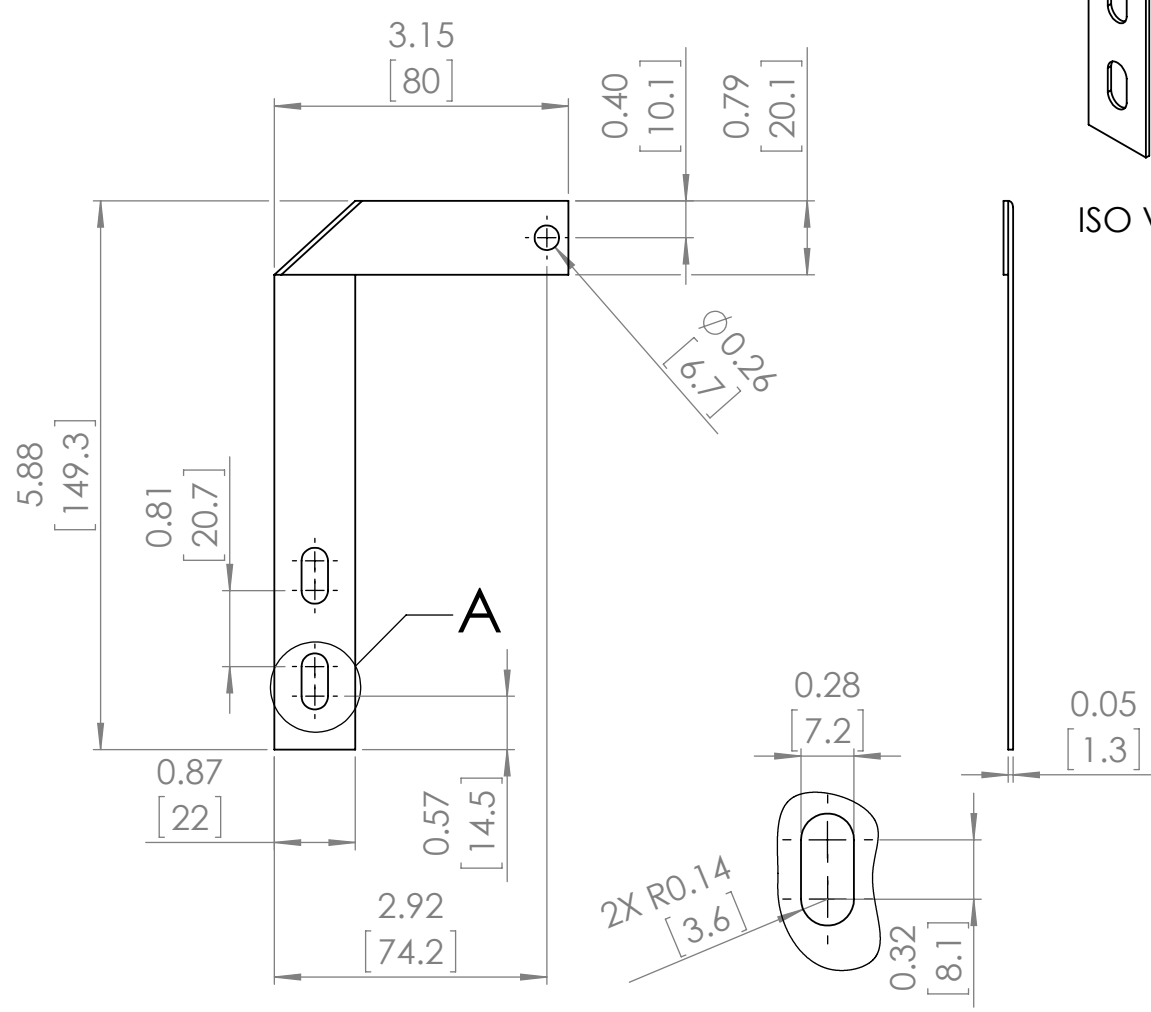

DETAIL A

WWW.BRAHELECTRIC.COM, 855-355-2724

*NOTE: BRAH ELECTRIC BUS PLUG ACCESSORIES GE400G IS AN AFTERMARKET DIRECT REPLACEMENT FOR GENERAL ELECTRIC, SPECTRA SERIES, GROUND KITS, GROUND KIT ASSEMBLIES, 400-600A, TO BE USED WITH TYPE AC, SB, SL BUS PLUGS

<p>THIRD ANGLE PROJECTION</p>	<p>UNLESS OTHERWISE NOTED ALL DIMENSIONS ARE IN INCHES METRIC UNITS ARE DISPLAYED BENEATH IN [MM.]</p>				
	<p>PROPRIETARY AND CONFIDENTIAL THE INFORMATION CONTAINED IN THIS DRAWING IS THE SOLE PROPERTY OF BRAH ELECTRIC. ANY REPRODUCTION IN PART OR AS A WHOLE WITHOUT THE WRITTEN PERMISSION OF BRAH ELECTRIC IS PROHIBITED.</p>				<p>BUS PLUG ACCESSORIES</p>
<p>MATERIAL -</p>		<p>FINISH N/A</p>		<p>SIZE DWG. NO. A GE400G</p>	<p>REV. A</p>
<p>DO NOT SCALE DRAWING</p>		<p>SCALE: 1:1</p>	<p>WEIGHT: 3.2 LBS</p>	<p>SHEET 1 OF 1</p>	