

PART NUMBER  
**SSA36**



**BEFORE YOU BEGIN**

**PRIMARY APPLICATIONS**

- › Toyota Tacoma 4 X 2 (2014 - 2015)
- › Toyota Tacoma 4 X 4 (2014 - 2015)

**TOOLS REQUIRED**

- › Floor Jack
- › Safety Jack Stands
- › Wheel Chocks
- › 1-1/16" Wrench/Socket
- › 1-1/8" Wrench/Socket
- › 9/16" Wrench/Socket
- › Heavy Duty Clamps or SuperSprings Installation Tool

**PARTS LIST**

Item	Part #	Description	QTY
A	102002	SSA36 Leaf Spring	2
B	112129	Steel Sleeve	4
C	112189	HDPE Roller	4
D	122400	Shackle Leg	8
E	112124	1/2-13 x 2 3/4" Hex Bolt	2
F	112125	1/2-13 x 4 1/2" Hex Bolt	4
G	112126	1/2-13 Nylock Nut	8
H	112127	1/2" Nylon Flat Washer	8
I	112197	Button Head Hex Drive Screw	2
J	112140	Polyurethane Bushing	8
K	112213	Polyurethane Bump Stop	2
L	112221	Clamp Plate	4
M	111023	Mounting Block	2
N	112205	5/16-18 x 1 1/2" Hex Bolt	4
O	112209	5/16 Flat Washer	8
P	112208	5/16-18 Nylock Nut	4

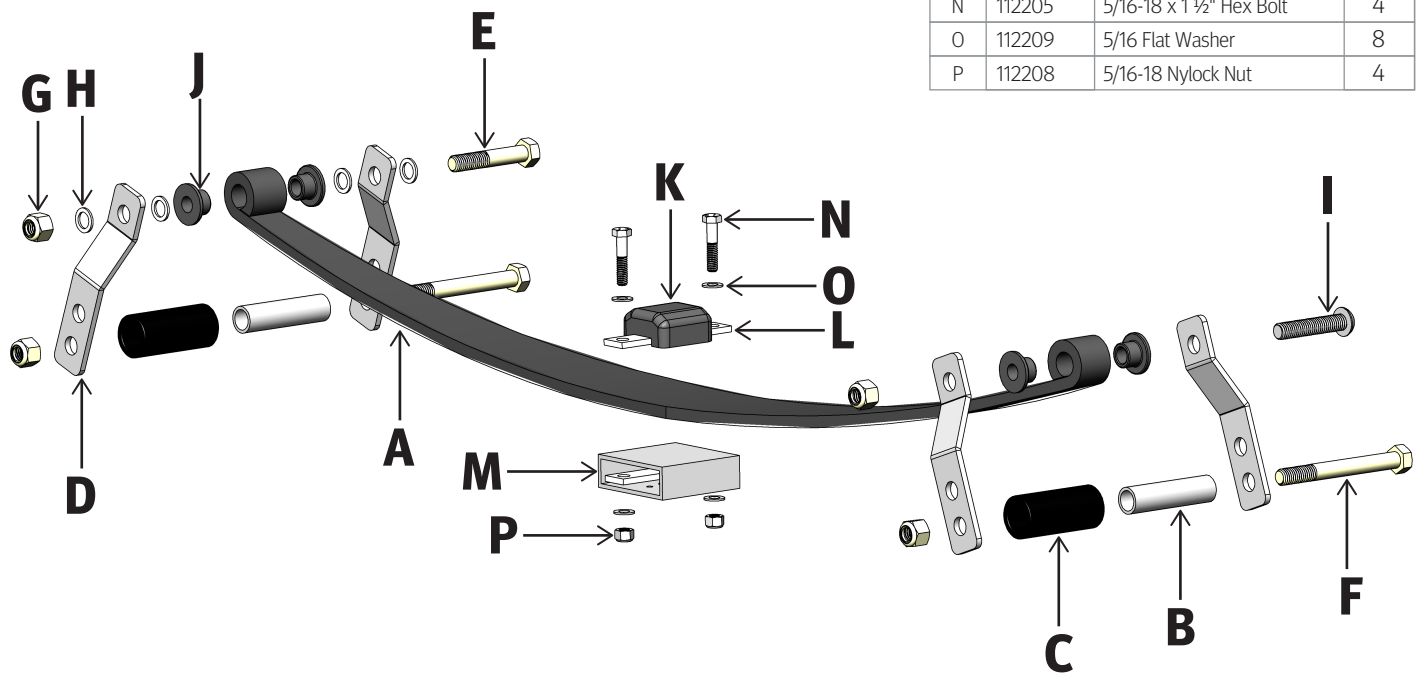

**Part Number: SSA36**

**Product Line: SUPERSPRINGS**

**Page 1**

Questions or Concerns?

Scan here:



or visit:  
[superspringsinternational.com](http://superspringsinternational.com)

**SAFETY NOTICE:** We recommend installation be done by a professional or persons with sound mechanical knowledge.

**WARNING:** These instructions are a general guide for installation. SuperSprings International (SSI) assumes no liability for the actual installation process. Consumers and installers should apply common automotive safety practices when raising and working on any vehicle. **Do not put yourself in a position where, if the vehicle were to move unexpectedly, you may be injured.** SSI's products are designed to improve vehicle ride quality. Do not load any vehicle beyond the manufacturer's specifications.

**Never exceed the manufacturer's Gross Vehicle Rating (GVWR) located on your vehicles identification tag.**

**BEFORE INSTALLATION:** Ensure the vehicle is on a hard level surface, the parking brake is ON, with the ignition OFF, and place chocks in front of and behind the tires to prevent the vehicle from moving.

**DURING AND/OR AFTER INSTALLATION:** Ensure emergency brake cables are not touching the SSI products. Secure any cables out of the way with zip ties or by re-routing. Ensure all A/C lines, brake cables, and frame are clear of contact or interference.

REV. 2.01 | OCT 2023

PART NUMBER  
**SSA36**



## INSTALLATION

1. Positioning the vehicle – Vehicle must be on level solid surface. Ensure emergency brake is ON and Ignition is OFF. Chock both front and rear of the front tires to prevent the vehicle from moving.
2. Starting on the driver side, with the vehicle still on the ground (one side at a time), loosen axle u-bolts to allow removal of the factory bump stop. After removal retighten the u-bolts and torque to factory specifications. After removing both bump stops raise the vehicle by the frame so that the rear wheels are slightly off the ground. Support the vehicle with jack stands.
3. Place Mounting Block [ITEM M] between the factory U-bolts with the open ends perpendicular to the vehicle frame. Ensure circular hole is located over the center bolt through the factory spring pack. Tap mounting block into position. Place SuperSprings [ITEM A] labeled “Driver Side Front” on top of mounting block with the label toward the front of the truck. Attach the Clamp Plate [ITEM L] and Polyurethane Bump Stop [ITEM K] as seen below. Leave clamp hardware [ITEM N, O, P] loose for now.



4. Before installing the front shackle, the plastic nub that protrudes through the bottom of the third leaf Figure 3 must be removed so that it will not interfere with the roller of the front shackle. It should be removed flush with the leaf spring with a chisel or sanding disc as seen below.



Part Number: SSA36

Product Line: SUPERSPRINGS

Page 2

Questions or Concerns?

Scan here:



or visit:  
[superspringsinternational.com](http://superspringsinternational.com)

**SAFETY NOTICE:** We recommend installation be done by a professional or persons with sound mechanical knowledge.

**WARNING:** These instructions are a general guide for installation. SuperSprings International (SSI) assumes no liability for the actual installation process. Consumers and installers should apply common automotive safety practices when raising and working on any vehicle. **Do not put yourself in a position where, if the vehicle were to move unexpectedly, you may be injured.** SSI's products are designed to improve vehicle ride quality. Do not load any vehicle beyond the manufacturer's specifications.

**Never exceed the manufacturer's Gross Vehicle Rating (GVWR) located on your vehicles identification tag.**

**BEFORE INSTALLATION:** Ensure the vehicle is on a hard level surface, the parking brake is ON, with the ignition OFF, and place chocks in front of and behind the tires to prevent the vehicle from moving.

**DURING AND/OR AFTER INSTALLATION:** Ensure emergency brake cables are not touching the SSI products. Secure any cables out of the way with zip ties or by re-routing. Ensure all A/C lines, brake cables, and frame are clear of contact or interference.

REV. 2.01 | OCT 2023

PART NUMBER  
**SSA36**



**INSTALLATION**

**5. Shackle Attachment Front** – Position the shackle between the two front spring clips so that the roller will ride under the end of the third leaf directly over where the plastic nub was removed. To ensure clearance under the frame, the UPPER bolt-hole position must be used on the front shackle. Both bolts on front shackle must have the threads facing OUT as seen below. Ensure all brake cables are routed clear out of the way of the SuperSprings blades; Bend front emergency brake cable bracket to provide clearance around front shackle.

**6. Shackle Attachment Rear** – Use C-Clamp and pull down rear shackle, position the spring shackle between the two rear spring clips so that the roller will ride under the second leaf and about 3/4" – 1" behind the end of the third leaf as seen below. Ensure that the threads of the upper and lower bolts are both facing out away from the frame.

**NOTE:** For the rear shackle, SuperSprings recommends setting the lower hole position for the roller as this will induce less preload and provide a better ride when the truck is unloaded. When more preload is required the roller can be installed in the upper hole position.

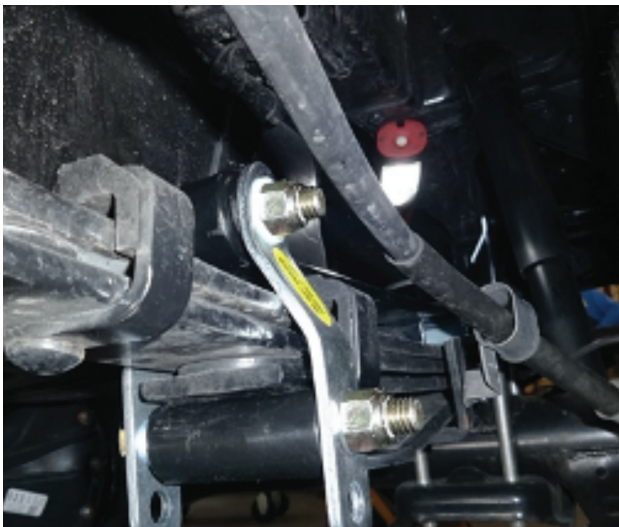

**Part Number: SSA36**

**Product Line: SUPERSPRINGS**

**Page 3**

Questions or Concerns?

Scan here:



or visit:  
[superspringsinternational.com](http://superspringsinternational.com)

**SAFETY NOTICE:** We recommend installation be done by a professional or persons with sound mechanical knowledge.

**WARNING:** These instructions are a general guide for installation. SuperSprings International (SSI) assumes no liability for the actual installation process. Consumers and installers should apply common automotive safety practices when raising and working on any vehicle. **Do not put yourself in a position where, if the vehicle were to move unexpectedly, you may be injured.** SSI's products are designed to improve vehicle ride quality. Do not load any vehicle beyond the manufacturer's specifications.

**Never exceed the manufacturer's Gross Vehicle Rating (GVWR) located on your vehicles identification tag.**

**BEFORE INSTALLATION:** Ensure the vehicle is on a hard level surface, the parking brake is ON, with the ignition OFF, and place chocks in front of and behind the tires to prevent the vehicle from moving.

**DURING AND/OR AFTER INSTALLATION:** Ensure emergency brake cables are not touching the SSI products. Secure any cables out of the way with zip ties or by re-routing. Ensure all A/C lines, brake cables, and frame are clear of contact or interference.

REV. 2.01 | OCT 2023

PART NUMBER  
**SSA36**



**INSTALLATION**

7. Ensure front and rear shackles are in the correct positions per the previous steps. In order to provide enough clearance to the frame, pull the assembly outboard (away from the frame) so that it slides as far toward the wheel on the mounting block as it will move. Once it is adjusted to this position, tighten the hardware [ITEM N, O, P] for the cross bar clamps starting with the bolt/nut on the inboard side. Confirm that the rear upper shackle bolt is clear of frame as seen below.

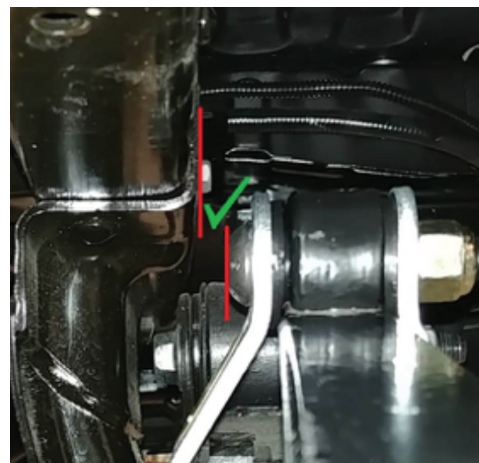
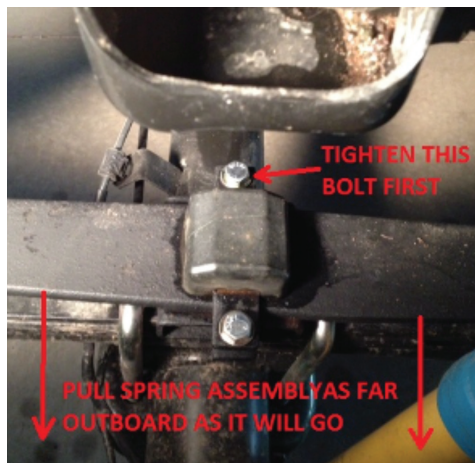

8. Repeat steps 2 through 7 on the passenger side.

9. Lower the vehicle – elevate chassis, remove the jack stands, lower to the ground. Remove wheel chocks from front wheels.

10. Final Check – Check the position of the SuperSprings ensuring for correct hardware application and orientation. Observe all hardware ensuring for static and dynamic interference clearances. Recheck all hardware to ensure it is securely tightened.

**NOTE:** After 200-500 miles of driving, recheck all hardware again for tightness.

11. Register the warranty for your SuperSprings International part. A warranty card can be found in the box your part came in.

**Part Number: SSA36**

**Product Line: SUPERSPRINGS**

**Page 4**

Questions or Concerns?

Scan here:



or visit:  
[superspringsinternational.com](http://superspringsinternational.com)

**SAFETY NOTICE:** We recommend installation be done by a professional or persons with sound mechanical knowledge.

**WARNING:** These instructions are a general guide for installation. SuperSprings International (SSI) assumes no liability for the actual installation process. Consumers and installers should apply common automotive safety practices when raising and working on any vehicle. **Do not put yourself in a position where, if the vehicle were to move unexpectedly, you may be injured.** SSI's products are designed to improve vehicle ride quality. Do not load any vehicle beyond the manufacturer's specifications.

**Never exceed the manufacturer's Gross Vehicle Rating (GVWR) located on your vehicles identification tag.**

**BEFORE INSTALLATION:** Ensure the vehicle is on a hard level surface, the parking brake is ON, with the ignition OFF, and place chocks in front of and behind the tires to prevent the vehicle from moving.

**DURING AND/OR AFTER INSTALLATION:** Ensure emergency brake cables are not touching the SSI products. Secure any cables out of the way with zip ties or by re-routing. Ensure all A/C lines, brake cables, and frame are clear of contact or interference.

REV. 2.01 | OCT 2023