

Crossrail

Tools Required

- Cordless driver with magnetic post and following tips
 - M5 Hex Drive

Hardware Required (Included)

- 4- 1/4-20 X 27MM (1 1/16") Connector Bolts
- 4- 1/4-20 X 12mm (1/2") Connector Nuts
- 2- Grey Rubber Bumpers

Figure A

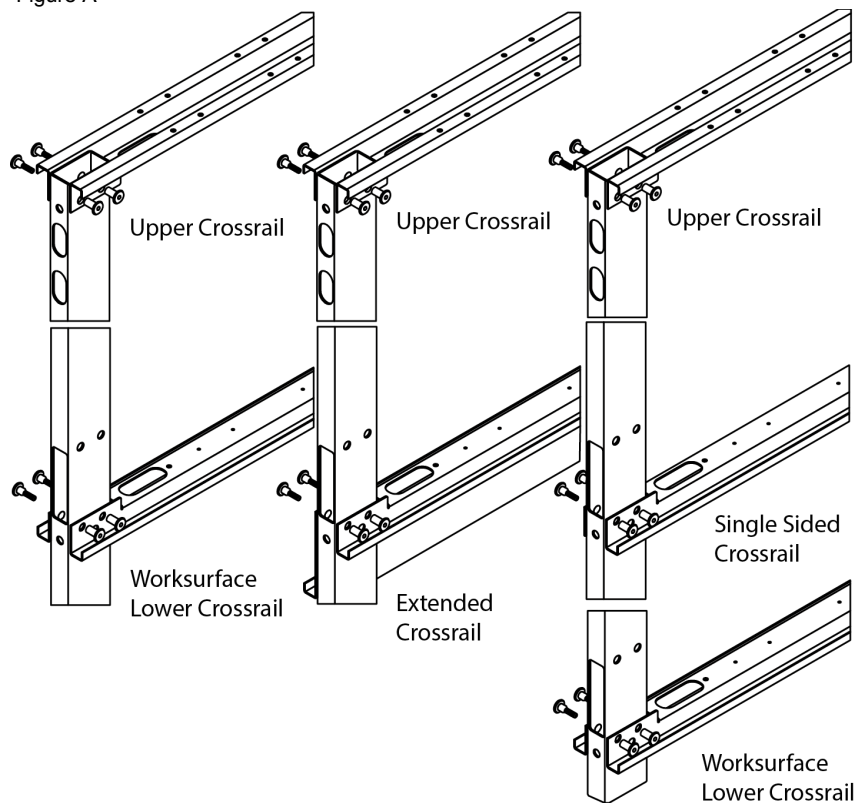
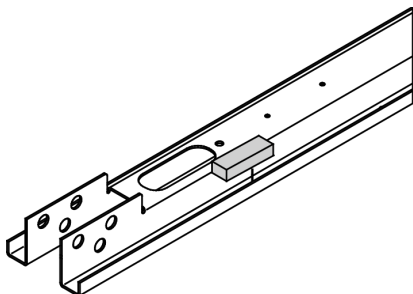

Figure D



Installation

1. Unpack Crossrail and Hardware.
2. Upper Crossrails are oriented with the flanges on the top where Worksurface / Lower Crossrails, Extended Crossrails and Open Base Crossrails are installed with the flanges pointed down as seen in Figure A.
3. Slide the Crossrail on to the tube leg taking care not to scratch any exposed portion of the leg as seen in Figure B.
4. Attach the Crossrail to the leg using 2 Connector Bolts and 2 Connector Nuts. In instances where the leg is shared between two Crossrails, one bolt goes through the leg and the other traps the outside of the rail, as shown in Figure C.
5. On Worksurface / Lower Crossrails insert 2 Grey Rubber Bumpers into the Worksurface Mounting holes, one per end. See Figure D. The bumpers help suspend the tiles and without the bumpers or cap screws for worksurface brackets in place, the tile will fall out of the upper rail when installed.
6. Crossrail attach to Connectors and End Panels in the same way as leg attachment. Connectors utilize different bolt configuration due to space constraints as seen in figure E.

Figure B

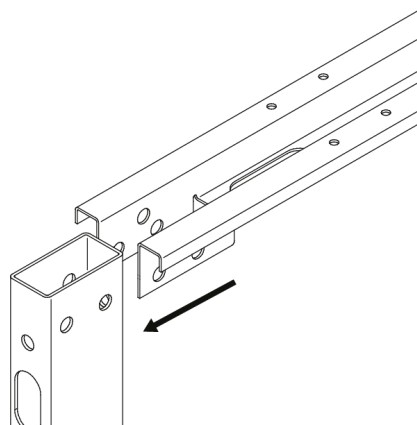

Figure C

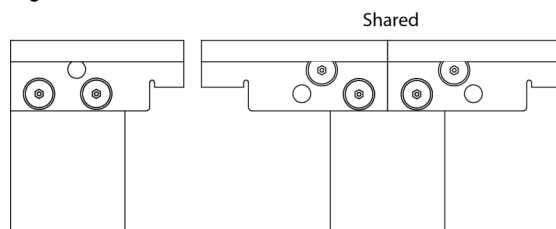
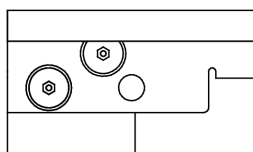

Figure E

X Connector
L Connector Leg 1
T Connector Legs 1, 3



Y Connector
L Connector Leg 2
T Connector Leg 2

