

## Locker storage, ganging units

### Tools Required

- Cordless Drill w/#2 Phillips head bit drive
- 3mm diameter drill bit
- Level
- Cabinet clamp

### Hardware Required

Multiple locker storage units  
#8 x 1 1/4" pan head screws - (6) included in hardware kit of each locker unit

### Installation

1. Stand locker units side by side in final installation location, level the units. Flush all end panels making sure all surfaces are aligned. When properly aligned it is recommended to use a clamp of some sort to secure one locker to the next before drilling the ganging holes. **Figure A.**
2. In the approximate area, indicated by arrows in **Figure B**, drill (6) 3mm diameter holes from the interior of one locker unit into the side of the unit to join. (**DO NOT DRILL DEEPER THAN 1 1/4"**) With all holes drilled insert the #8 x 1 1/4" screws and tighten to gang the units together. Repeat steps 1 & 2 for as many of the locker units required for your installation.
3. Floor standing lockers are shown in this instruction. For leg mounted locker option follow the same procedure except lay the leg mounted version on their backs. Once units are ganged refer to **Metal storage base to cabinet** for attachment of base. Once base is attached stand the assembly up and move into desired location, then level.

Figure A

Align and clamp units

Doors removed for clarity

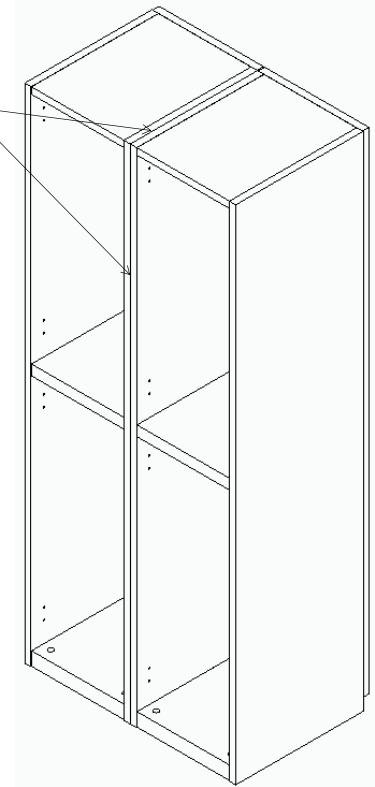

Figure B

