

Locker upper open storage

Tools Required

- Cordless Drill w/#2 Phillips head bit drive
- 3mm diameter drill bit
- Cabinet clamp

Hardware Required

1 - Upper open storage unit 36", 48", 60" or 72" unit
 6 - #8 x 1 1/4" pan head screws - (6) included in hardware kit of each storage unit

Installation

1. Unbox open storage unit. **Figure A.**
2. Sit the open storage unit on top of the ganged lockers with the cam fasteners down against the top of the lockers, align the end panels. When properly aligned it is recommended to use a clamp of some sort to secure the open storage unit to the lockers below before drilling the attachment holes. Drill (6) 3mm diameter holes from the interior of the locker units into the bottom of the storage unit above in the approximate area indicated by arrows. **Figure B. (DO NOT DRILL DEEPER THAN 1 1/4")** With all holes drilled insert the #8 x 1 1/4" screws and tighten to gang the units together. Repeat steps 1 & 2 for as many of the storage units required for your installation.

Figure A

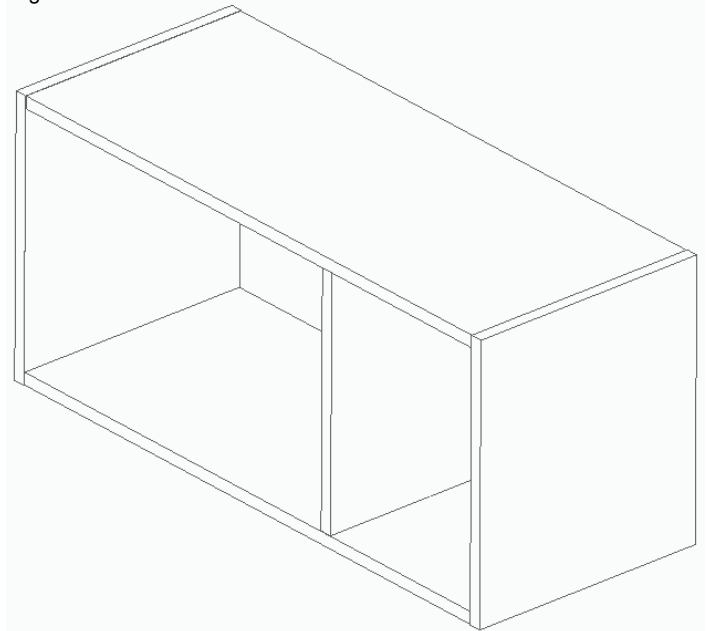

Figure B

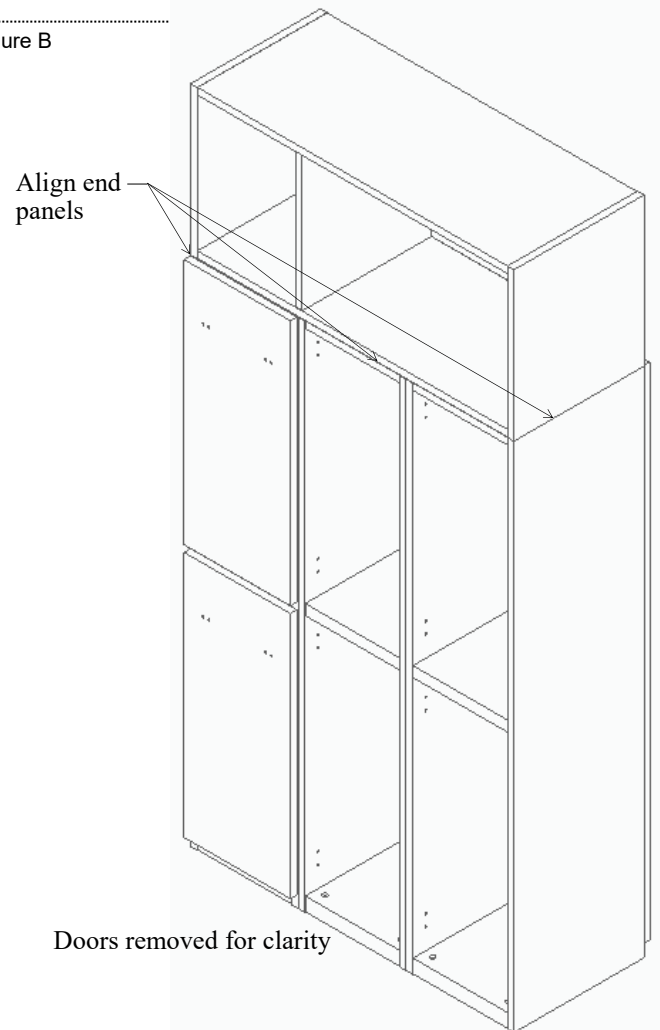

Figure B

