

interwoven[®]



ALTERNA[®]
Workplace



SMART DESIGN FOR PROFESSIONAL SPACES

In today's corporate environments, where flexibility, durability, and consistency are essential, Alterna's modular design allows for easy reconfiguration as needs evolve. With coordinated finishes and thoughtful details, Alterna makes it easy to maintain a cohesive look across departments, floors, or throughout an entire facility. From team hubs and training or meeting spaces to breakrooms, cafés, mailrooms, and wellness areas, Alterna supports a wide range of workstyles and settings. Its modular design, broad palette, and professional-grade performance help designers and facility teams create smarter spaces that support employee comfort and operational needs.

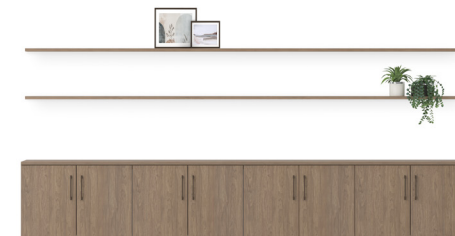

Statement of Line Overview

Base Cabinets



Door with Waste Access



Drawer & Door



Sink Cabinet



Wall Hanging, Drawer & Doors



Wall Hanging, Accessible Sink Cabinet



Toe Kick

Upper Cabinets



Open



Door



Double Doors, Microwave Shelf



Double Doors



Corner



Filler Panel

Surfaces



Integrated Backsplash with Sidesplash



Corner with Integrated Backsplash



Integrated Solid Surface Sink



Undermount Stainless Steel Sink



Drop-in Stainless Steel Sink

Benches, Lockers, & Storage Cabinets



Open, Plinth Base



Closed, Casters



4 Doors



2 Doors



Z Doors



Media Cabinet

Nurse Servers & Carts



Drawers & Waste Bin



Nurse Cart



Mobile Cart, Dual Receptacles



Mobile Cart, Serving

Features & Options

- Robust offering of components that can be removed, reconfigured, and repurposed as needs change, throughout an entire facility
- Cabinets designed to disassemble and reattach to prevent damage when moved
- Storage available in multiple width, depth, and height options to accommodate standard and accessibility requirements
- Storage components deliver fully assembled for quick and easy installation
- Cabinets and lockers available with a flat-top or sloped-top
- Surfaces, cabinets, and storage can be specified within 1/16" increments
- Doors and drawers feature soft-close hinges and slides
- Upper and wall-mount cabinets engineered to hang from Z-brackets, eliminating the need for wall blocking
- All base and storage cabinets include adjustable glides to quickly level on uneven floors
- Filler panels, soffits, and toe kicks available to create a built-in aesthetic
- Lockers are non-locking as standard; keyed, electronic keyless, mechanical keyless, or Hasp locks available
- Modular casework can be registered as a capital asset versus a fixed asset

