



**Fisher Engineering**

P.O. Box 529, Rockland, ME 04841

# "L" Series Blade Components

April 18, 2001  
Lit. No. 21987



## SERVICE PARTS LIST AND DIAGRAM

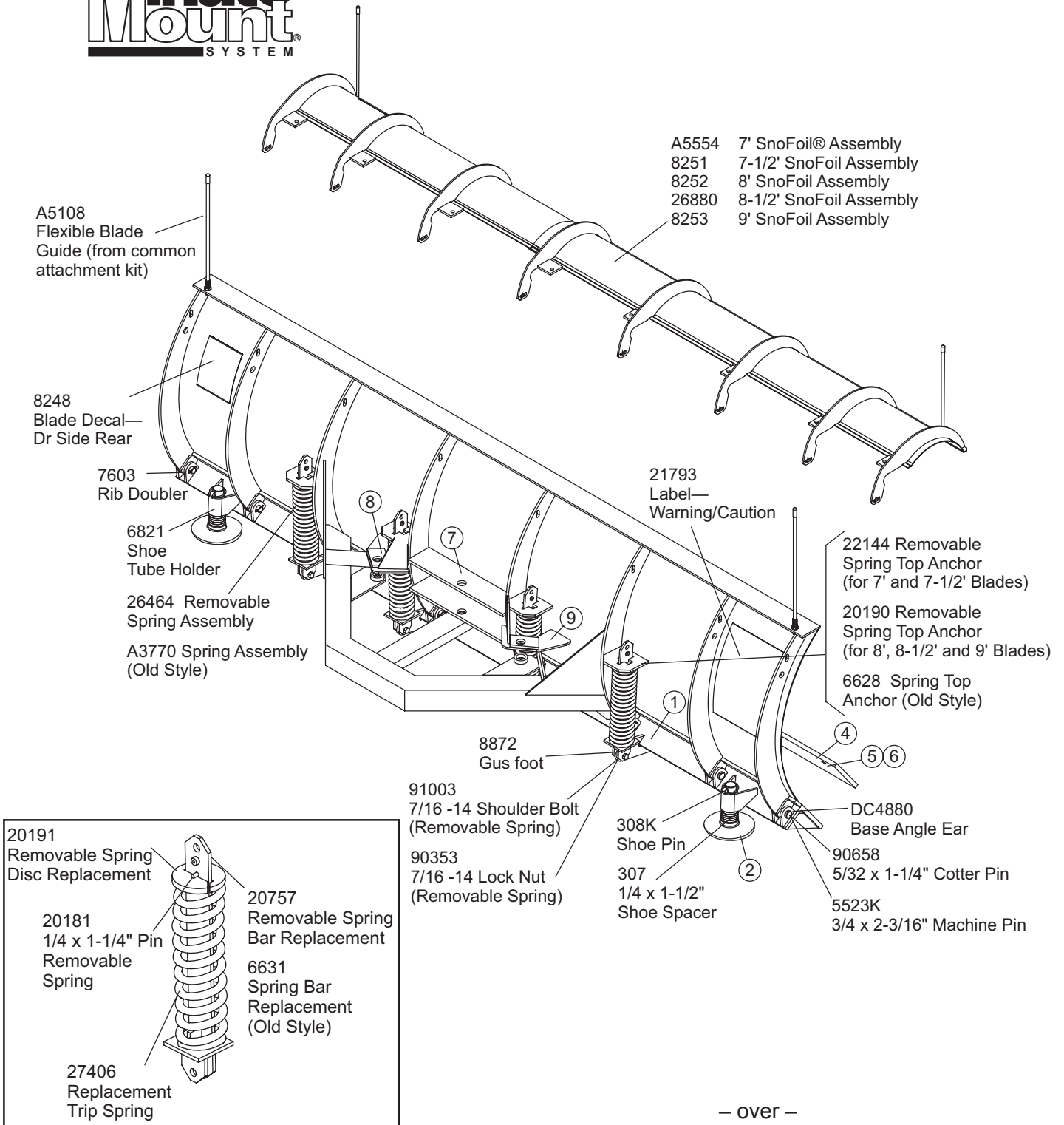

## "L" Series Blade Components

<b>"L" Blade Assembly Parts List</b>							
<b>Ref #</b>	<b>Part #</b>	<b>Description</b>	<b>7761 7' "L"</b>	<b>7657 7-1/2' "L"</b>	<b>7658 8' "L"</b>	<b>28850 8-1/2' "L"</b>	<b>7659 9' "L"</b>
1	7869	Base Angle – 7' Replacement	x				
	7667	Base Angle – 7 1/2' Replacement		x			
	7668	Base Angle – 8' Replacement			x		
	26885	Base Angle – 8-1/2' Replacement				x	
	7669	Base Angle – 9' Replacement					x
2	*26523	Shoe Assembly – 6" Solid Cast	x	x	x	x	x
4	5532	Cutting Edge – 7 1/2'		x			
	5533	Cutting Edge – 8'			x		
	26460	Cutting Edge – 8-1/2'				x	
	5534	Cutting Edge – 9'					x
5	5551	1/2 x 2" (NC) Gr. 5 Carriage Bolt	x	x	x		
	5572	5/8 x 2" (NC) Gr. 5 Carriage Bolts				x	x
6	90355	1/2" (NC) Locknut	x	x	x		
	5573	5/8" (NC) Locknut				x	x
7	7650	Upper Gusset	x	x			
	7675	Upper Bar			x	x	x
8	7651	Anchor – Upper Cyl. w/Doubler – Driver Side	x	x			
	8529	Top Anchor – Driver Side			x	x	x
9	7652	Anchor – Upper Cyl. w/Doubler – Passenger Side	x	x			
	8530	Top Anchor – Passenger Side			x	x	x
ns	DC3912	Gusset Channel	x	x			
ns	4273	Gusset – Lower Anchor			x	x	x
<b>ns = not shown</b>							
<b>* Consists of (1) shoe, (1) 308K shoe pin, and (5) 307 shoe spacers</b>							

Copyright © 2001 Douglas Dynamics. L.L.C. All rights reserved. This material may not be reproduced or copied, in whole or in part, in any printed, mechanical, electronic, film or other distribution and storage media, without the written consent of Fisher Engineering. Authorization to photocopy items for internal or personal use by Fisher Engineering outlets is granted.

Fisher Engineering reserves the right under its product improvement policy to change construction or design details and furnish equipment when so altered without reference to illustrations or specifications used herein. Fisher Engineering and the vehicle manufacturer may require and/or recommend optional equipment for snow removal. Fisher Engineering offers a limited warranty for all snowplows and accessories. See separately printed page for this important information. The following are registered (®) and unregistered (™) trademarks of Douglas Dynamics, L.L.C.: FISHER®, Minute Mount®, SnoFoil®.

Printed in USA