



Western Products  
PO Box 245038  
Milwaukee, WI 53224-9538  
www.westernplows.com



A DIVISION OF DOUGLAS DYNAMICS, LLC

## 56369 – SOLENOID CONTROL

### Installation Instructions

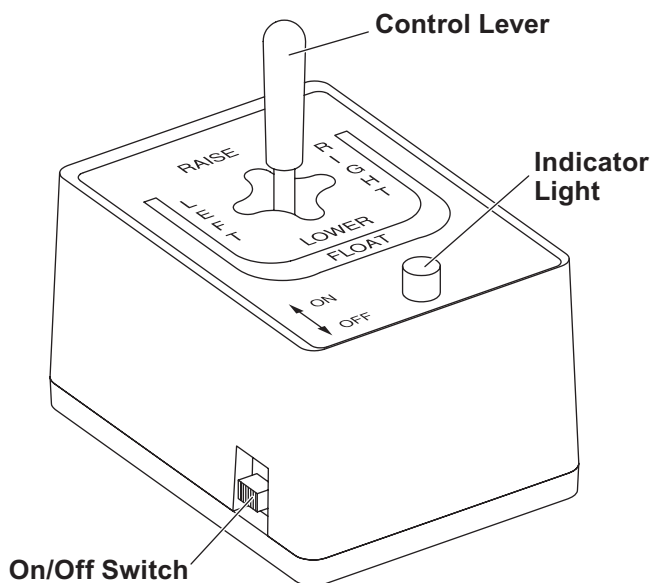

#### **⚠ CAUTION**

Read this document before installing the control.

#### **⚠ CAUTION**

Use standard methods and practices when attaching snowplow and installing accessories, including proper personal protective safety equipment.

#### **⚠ CAUTION**

See your WESTERN® outlet/website for specific vehicle application recommendations before installation. The Quick Match selection system has specific vehicle and snowplow requirements.

### SAFETY DEFINITIONS

#### **⚠ WARNING**

Indicates a potentially hazardous situation that, if not avoided, could result in death or serious personal injury.

#### **⚠ CAUTION**

Indicates a potentially hazardous situation that, if not avoided, may result in minor or moderate injury. It may also be used to alert against unsafe practices.

**NOTE:** Indicates a situation or action that can lead to damage to your snowplow and vehicle or other property. Other useful information can also be described.

## FUSES

The WESTERN® electrical and hydraulic systems contain several automotive-style fuses. If a problem should occur and fuse replacement is necessary, the replacement fuse must be of the same type and amperage rating as the original. Installing a fuse with a higher rating can damage the system and could start a fire. Fuse replacement information, including fuse ratings and locations, is found in the Maintenance section of the Owner's Manual.

---

**NOTE: The controls do not contain onboard fuses. Consult your snowplow Owner's Manual for fuse replacement. Fuses are located both under the hood and on the hydraulic unit.**

---

---

**NOTE: Circuit board may be damaged by static electricity. Always touch ground before handling PC board.**

---

## CONTROL BRACKET PLACEMENT

### **⚠ CAUTION**

**Do not alter, modify, or install additional components in shaded areas of the illustration below. Failure to comply may interfere with air bag deployment or cause injury to operator in an accident.**

When mounting the control bracket, choose a location that is within easy reach of the vehicle operator and does not restrict access to vehicle controls or vehicle instrumentation. Do not mount the control in areas prohibited by the vehicle manufacturer for crashworthiness. See the vehicle's body builder's book, owner's manual, or service manual for details. The shaded areas in the illustration below show the most commonly restricted areas.

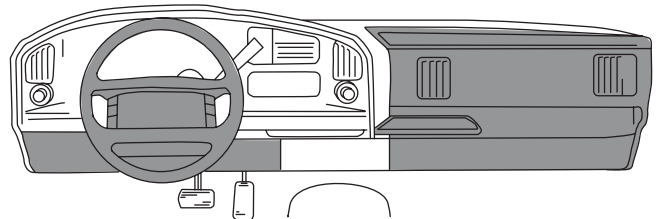

## INSTALLING CONTROL BRACKET

### **⚠ CAUTION**

Before drilling holes, check to be sure that no vehicle wiring or other components could be damaged.

1. Align the lower dash bracket hole shown in diagram to the end hole of the control bracket.

**NOTE: Top flange of control bracket may be reversed in dash bracket from position shown in diagram.**

Attach with one #8 x 3/8" hex head thread cutting screw and lock washer on each side.

2. If each flange of the control bracket has 4 holes, secure the dash bracket to the control bracket with a second screw and lock washer in each side.

If each flange of the control bracket has 3 holes in the flange, use the top holes in the dash bracket as a template to drill a 9/64" diameter hole into each flange of the control bracket. Secure the dash bracket to the control bracket with a second screw and lock washer in each side.

3. Secure the solenoid control to the control bracket with two #8 x 5/8" hex head tapping screws.
4. Move the seat forward. Locate the control and bracket assembly on the floor tunnel so that it does not interfere with the operation of vehicle controls. Mark this location.
5. Remove the control bracket from the dash bracket.
6. Place the dash bracket in the marked location. Use the dash bracket as a template to drill four 1/8" holes in the tunnel.
7. Secure the dash bracket to the tunnel with four #10 x 1" sheet metal screws and lock washers.
8. Reassemble the control bracket to the dash bracket. Bend the top flange of control bracket to the desired position.
9. Secure the harness to the control bracket with the cable clamp and one #8 x 3/8" hex head thread cutting screw.

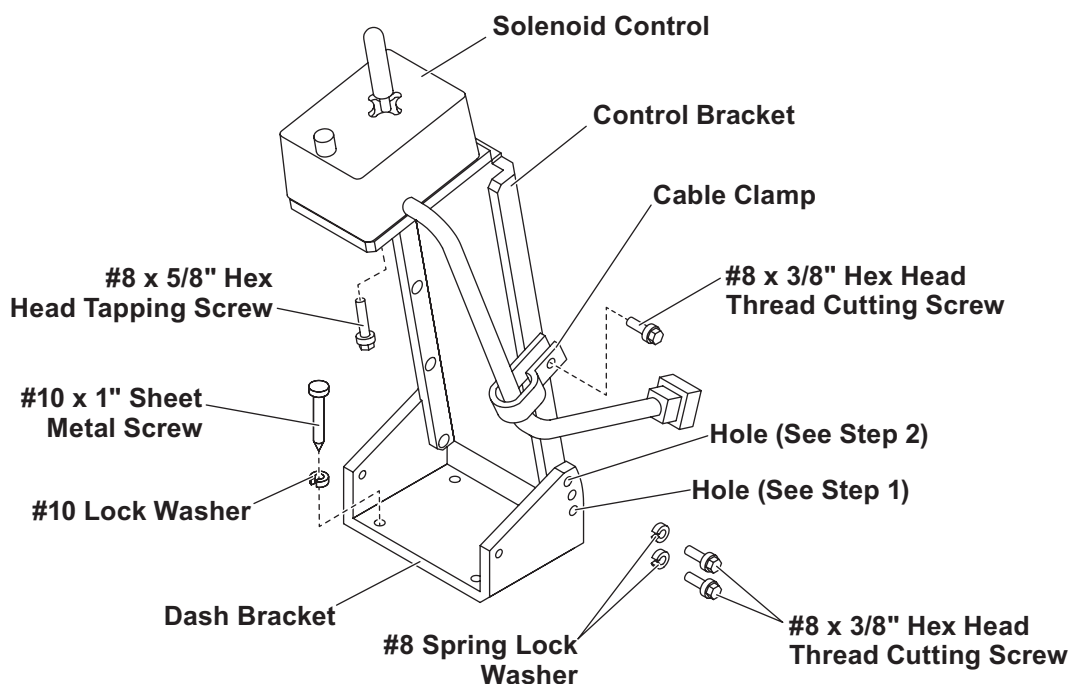

Western Products reserves the right under its product improvement policy to change construction or design details and furnish equipment when so altered without reference to illustrations or specifications used. Western Products or the vehicle manufacturer may require or recommend optional equipment for snow removal. Do not exceed vehicle ratings with a snowplow. Western Products offers a limited warranty for all snowplows and accessories. See separately printed page for this important information. The following are registered (®) or unregistered (™) trademarks of Douglas Dynamics, LLC: WESTERN®.

**Printed in U.S.A.**

---