



Western Products
PO Box 245038
Milwaukee, WI 53224-9538
www.westernplows.com

A DIVISION OF DOUGLAS DYNAMICS, LLC

**57409-1 & 57425-1 – PRO PLUS®
HD 9' & 10' BLADE**

**RUBBER DEFLECTOR KIT –
10" & 18"**

Parts List & Installation Instructions

PARTS LIST

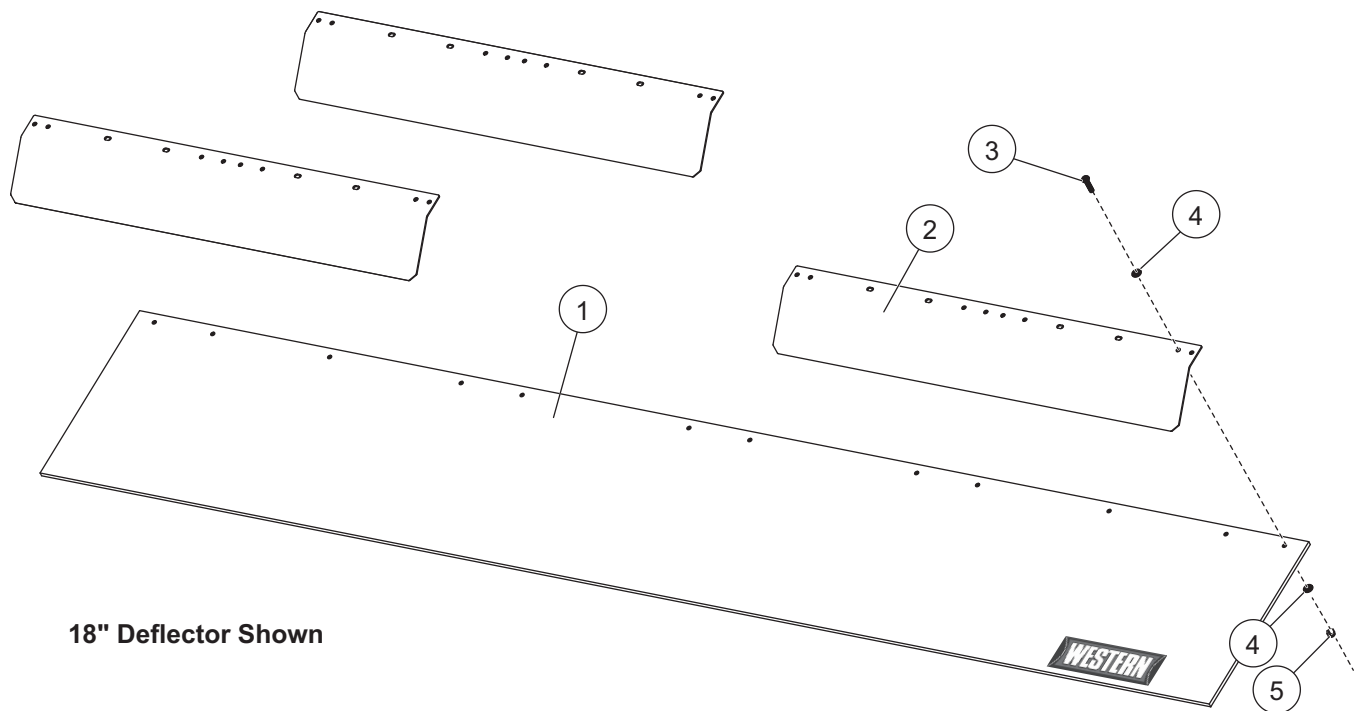

18" Deflector Shown

57409-1 Rubber Deflector Kit – 18"							
Item	Part	Qty	Description	Item	Part	Qty	Description
1	57383	1	Rubber Deflector, 3/8 x 18 x 120	ns	52540	1	Bolt Bag
2	57408	3	Deflector Bracket (18" only)				
57425-1 Rubber Deflector Kit – 10"							
ns	57416	1	Rubber Deflector, 3/8 x 10 x 120	ns	52540	1	Bolt Bag
ns	57410	3	Deflector Bracket (10" only)				
52540 Bolt Bag							
3		12	5/16-18 x 1-1/4 Hex Cap Screw G5	5		12	5/16 Hex Locknut GB
4		24	5/16 Flat Washer				
ns = not shown				G = Grade			

57409-1 & 57425-1 RUBBER DEFLECTOR KIT

INSTALLATION INSTRUCTIONS

⚠ WARNING

Do not exceed GVWR or GAWR, including blade and ballast. The rating label is found on the driver-side vehicle door cornerpost.

⚠ CAUTION

Read this document before installing the rubber deflector kit.

⚠ CAUTION

Use standard methods and practices when attaching snowplow and installing accessories, including proper personal protective safety equipment.

⚠ CAUTION

See your WESTERN® outlet/website for specific vehicle application recommendations before installation. The Quick Match selection system has specific vehicle and snowplow requirements.

These deflector kits are applicable for the 9' and 10' sizes of the PRO PLUS® HD blades.

NOTE: Due to the weight and size of this deflector, two people are recommended for installation.

1. Park the vehicle on a smooth, level, hard surface, such as concrete. Lower the blade to the ground, and turn the control OFF. Disconnect the snowplow from the vehicle, or turn the vehicle ignition to the "OFF" position and remove the key.
2. Position and center the Rubber Deflector onto the blade. Then, start with the outside deflector brackets and mounting holes and work towards the center.

9': Install the deflector using ten 5/16" x 1-1/4" cap screws, twenty 5/16" flat washers, and ten 5/16" locknuts. Trim excess length from both ends of the rubber deflector. Refer to the 9' illustration below for fastener placement.

10': Install the deflector using twelve 5/16" x 1-1/4" cap screws, twenty-four 5/16" flat washers, and twelve 5/16" locknuts. Do not trim rubber deflector. Refer to the 10' illustration below for fastener placement.

NOTE: The deflector brackets will overlap. Do not shorten.

3. Tighten all fasteners to 17 ft-lb.

Deflector Bracket Bolt Pattern

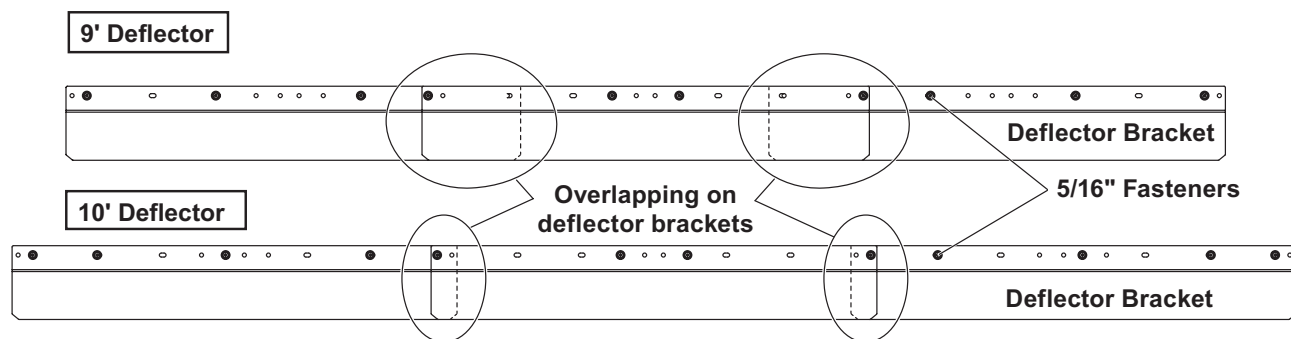

Copyright © 2024 Douglas Dynamics, LLC. All rights reserved. This material may not be reproduced or copied, in whole or in part, in any printed, mechanical, electronic, film, or other distribution and storage media, without the written consent of Western Products. Authorization to photocopy items for internal or personal use by Western Products outlets or snowplow owner is granted.

Western Products reserves the right under its product improvement policy to change construction or design details and furnish equipment when so altered without reference to illustrations or specifications used. Western Products or the vehicle manufacturer may require or recommend optional equipment for snow removal. Do not exceed vehicle ratings with a snowplow. Western Products offers a limited warranty for all snowplows and accessories. See separately printed page for this important information. The following are registered (®) or unregistered (™) trademarks of Douglas Dynamics, LLC: PRO PLUS®, UltraMount® 2, WESTERN®.

Printed in U.S.A.