

Feed Gate Kit

Stainless Steel Hopper Spreaders with Serial Numbers Beginning with 230301–Higher*

PARTS LIST

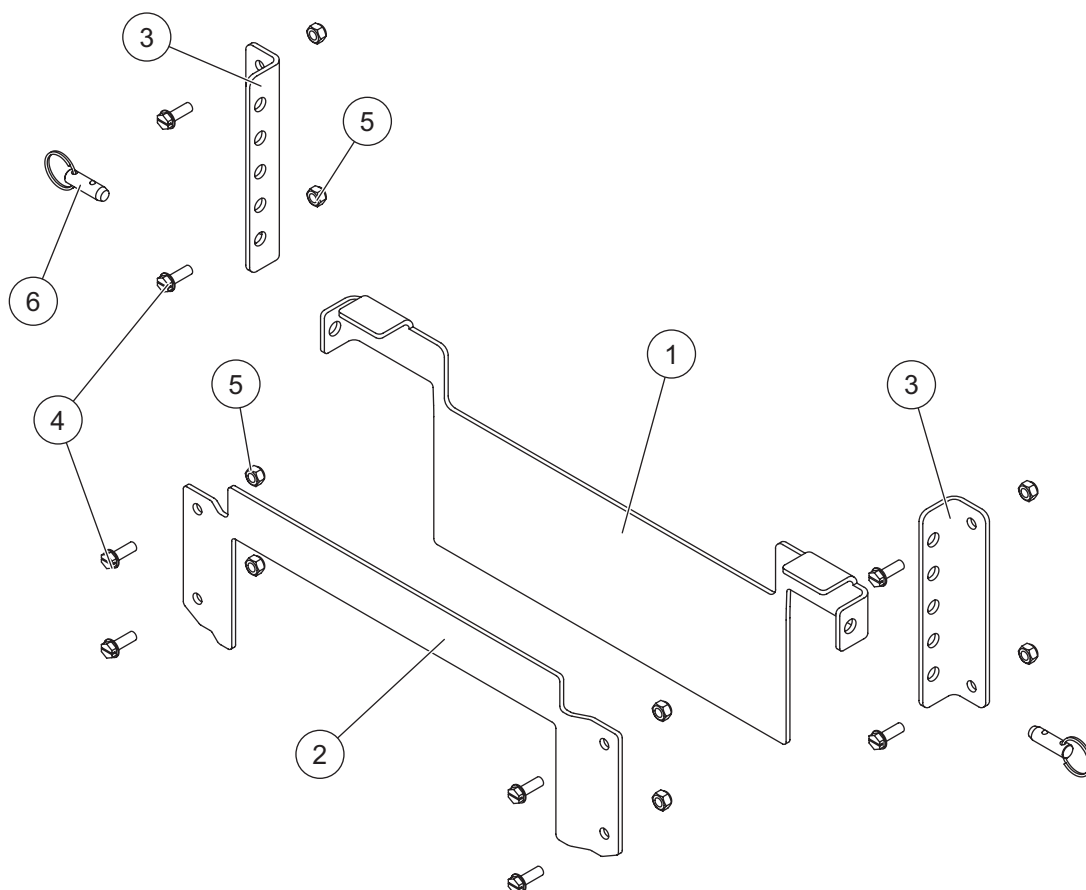

89825 Feed Gate Kit							
Item	Part	Qty	Description	Item	Part	Qty	Description
1		1	Adjustable Feed Gate	5		8	1/4-20 Hex Locknut GB SS
2		1	Feed Gate Support	6		2	Quick Release 3/8 Pin
3		2	Pin Locator				
4		8	1/4-20 x 3/4 Hex Washer Head Machine Screw SS				
G = Grade				SS = Stainless Steel			

* Stainless steel hopper spreaders with serial numbers beginning with 230301–240515 require Feed Gate Retrofit Kit #89830 be installed in addition to this kit. Newer models (serial numbers beginning with 240516–higher) include knockouts, eliminating the need to drill holes.

⚠ WARNING

Do not exceed GVWR or GAWR ratings as found on the driver-side vehicle door cornerpost.

⚠ CAUTION

Read this document before installing the Feed Gate Kit.

⚠ CAUTION

Use standard methods and practices when attaching spreader and installing accessories, including proper personal protective safety equipment.

INSTALLATION INSTRUCTIONS

1. Park the vehicle on a smooth, level, hard surface, such as concrete. Turn the vehicle ignition to the "OFF" position and remove the key. Ensure that the hopper is empty of material.
2. Remove the chain cover and fasteners. Set aside for reinstallation.

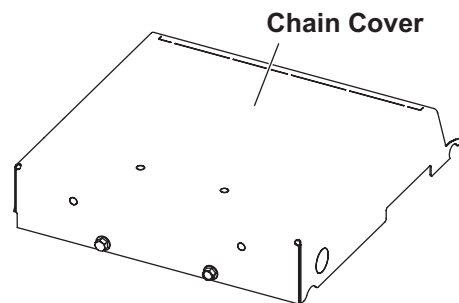

3. Install the adjustable feed gate and feed gate support, using four 1/4" x 3/4" washer head machine screws and four 1/4" locknuts as shown. Ensure that the feed gate operates smoothly (using two hands to pick up on the feed gate tabs and sliding it up and down), then tighten fasteners.

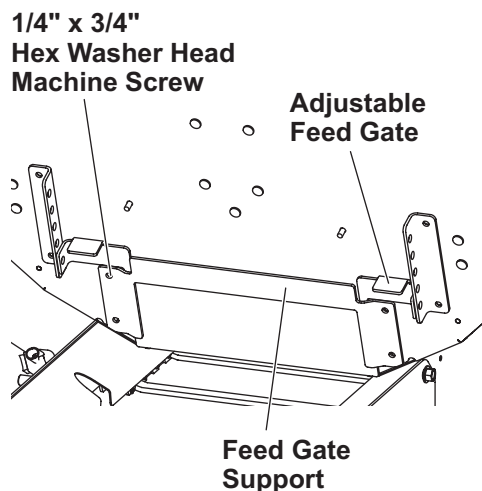

4. Install the pin locators using four 1/4" x 3/4" washer head machine screws and four 1/4" locknuts as shown.

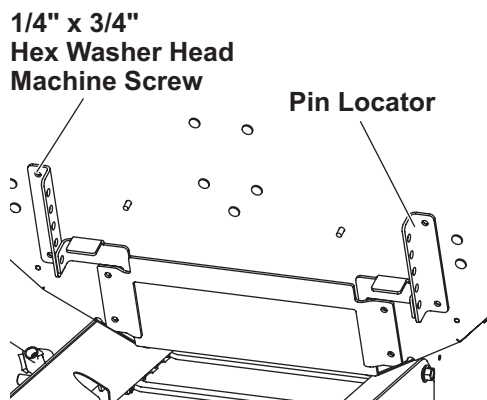

5. Adjust the feed gate to the desired location and use the quick-release 3/8" pins provided with the feed gate kit to lock the feed gate in position. Figure A shows the feed gate fully closed and Figure B shows the feed gate fully open. There is extra hardware in the kit.

Figure A – Feed Gate Fully Closed

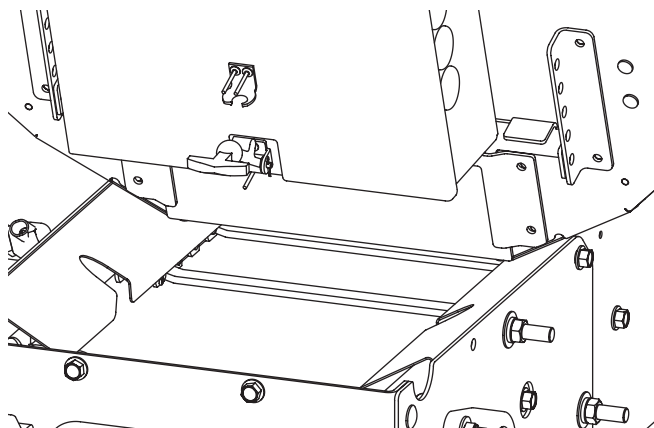
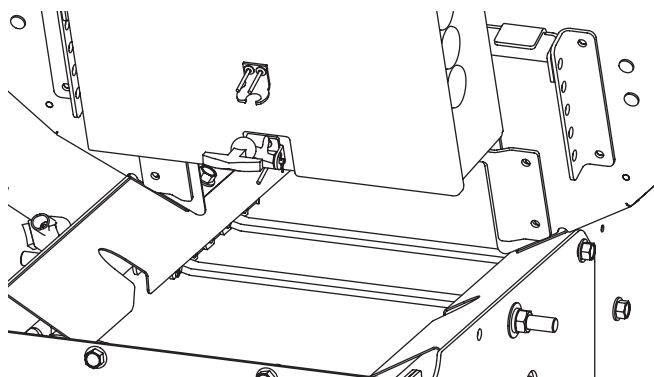
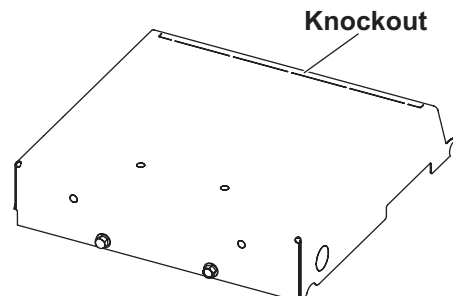

Figure B – Feed Gate Fully Open



6. Remove the rectangle knockout on the chain cover (removed in Step 2) to allow clearance for the feed gate. Reinstall the chain cover, reusing original fasteners.



⚠ CAUTION

Before drilling holes, check to be sure that no vehicle wiring or other components could be damaged.

7. Stand chute on the ground. Remove the plate indicated in the illustration below by drilling out two rivets (circled). This will allow for an even spread pattern in all feed gate positions.

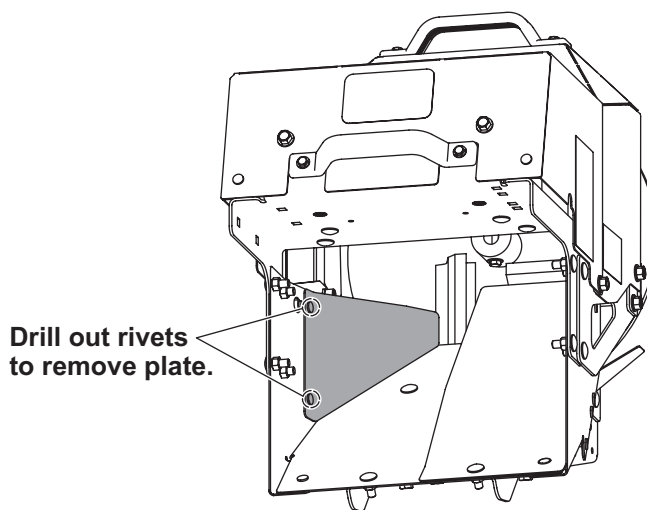

NOTE: Stainless steel is a durable material. For best results, use a sharp drill bit with proper lubrication.

Copyright © 2024 Douglas Dynamics, LLC. All rights reserved. This material may not be reproduced or copied, in whole or in part, in any printed, mechanical, electronic, film, or other distribution and storage media, without the written consent of the company. Authorization to photocopy items for internal or personal use by the company's outlets or spreader owner is granted.

The company reserves the right under its product improvement policy to change construction or design details and furnish equipment when so altered without reference to illustrations or specifications used. This equipment manufacturer or the vehicle manufacturer may require or recommend optional equipment for spreaders. Do not exceed vehicle ratings with a spreader. The company offers a limited warranty for all spreaders and accessories. See separately printed page for this important information.

Printed in U.S.A.
