

Rolled Tarp Cover – 70" Wide

Stainless Steel Hopper Spreaders

Auger & Chain S300, S400, S500

PARTS LIST

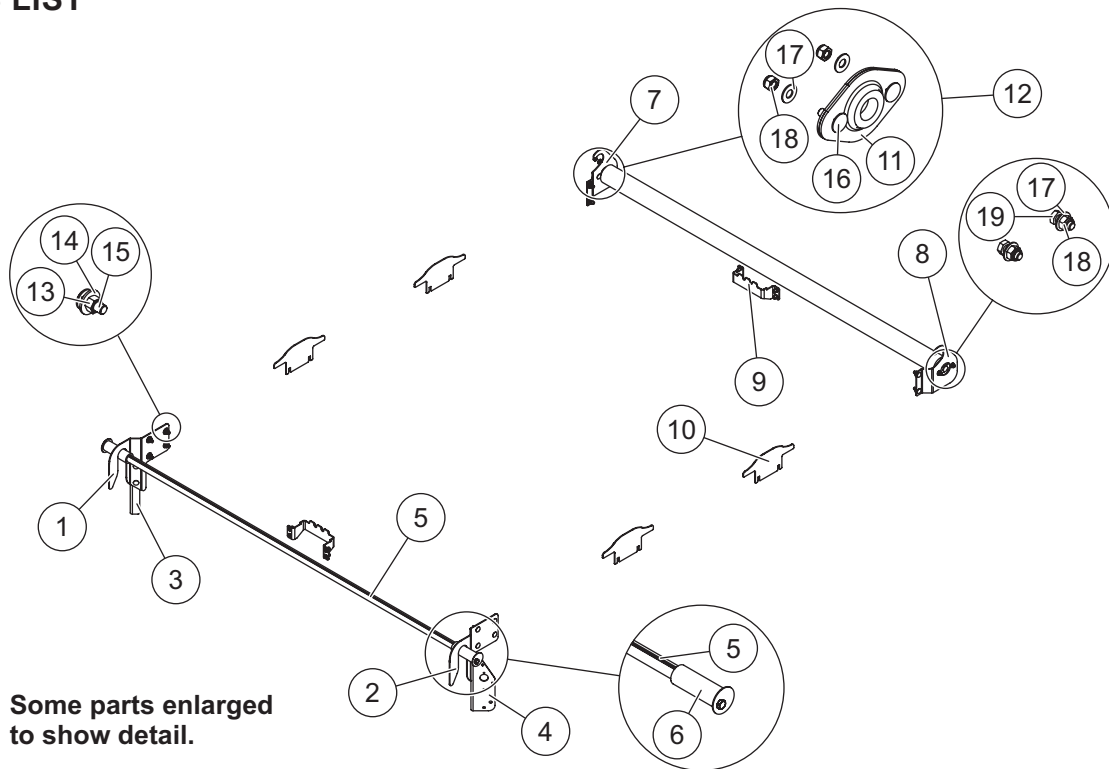

32765 Rolled Tarp Cover – 70" Wide							
Item	Part	Qty	Description	Item	Part	Qty	Description
1		1	Hook Bracket – DS	11		1	Roller Bearing
2		1	Hook Bracket – PS	12	32331	1	Roller Bearing Service Kit (incl. items 11, 16, 17, 18)
3		1	Modified Acc Light Bracket – DS	ns	32332	1	Roller Service Kit (incl. items 17, 18, 19 and roller)
4		1	Modified Acc Light Bracket – PS	ns	32279	1	Edge Trim – 48"
5	32326	1	Tarp Shaft	ns	32328	1	Black Vinyl Tarp
6	32327	1	Shaft End Plate & PVC Tubing	ns	32329	1	Tarp Rope – 20'
7		1	Roller Bracket – DS	ns	32324	1	Tie Down Strap
8		1	Roller Bracket – PS	ns	32322	1	Bolt Bag – Rolled Tarp Cover
9		2	Modified Top Screen End Hinge				
10		4	Bump-up Plate				
32322 Bolt Bag – Rolled Tarp Cover							
13		16	3/8-16 x 1 Carriage Bolt SS	16		2	5/16-18 x 1 Carriage Bolt SS
14		17	3/8 Flat Washer Type A Wide SS	17		4	5/16 Flat Washer SS
15		17	3/8-16 Hex Locknut SS	18		4	5/16-18 Hex Locknut SS
ns		1	3/8-16 x 1 Serrated Flange Hex Cap Screw SS	19		2	5/16-18 x 3/4 Hex Cap Screw SS
ns = not shown				SS = Stainless Steel			

⚠ WARNING

Do not exceed GVWR or GAWR ratings as found on the driver-side vehicle door cornerpost.

⚠ CAUTION

Read this document before installing the rolled tarp cover.

⚠ CAUTION

Use standard methods and practices when attaching spreader and installing accessories, including proper personal protective safety equipment.

INSTALLATION INSTRUCTIONS

1. Park the vehicle on a smooth, level, hard surface, such as concrete. Turn the vehicle ignition to the "OFF" position and remove the key.
2. If previously installed, remove all strobe and work light brackets from the unit. Disassemble and set aside work and strobe lights for reinstallation.
3. Temporarily remove lynchpins and top screens from hopper and set aside for reinstallation.
4. Toward the chute end of the hopper, punch four side knockouts (two per side) located in the hopper side caps.

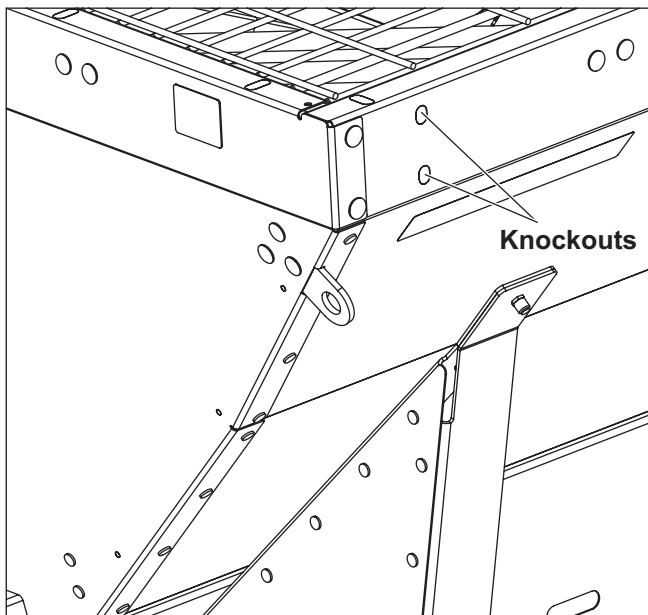

5. The existing top screen end hinge interferes with the rolled tarp cover, and could cause damage to the tarp. Therefore, remove the two existing top screen end hinges and replace them with the modified end hinges from the kit, reusing existing 3/8" hardware. In addition, install driver-side and passenger-side hook brackets to the rear knockouts using existing or supplied 3/8" x 1" carriage bolts, 3/8" washers, and 3/8" locknuts.

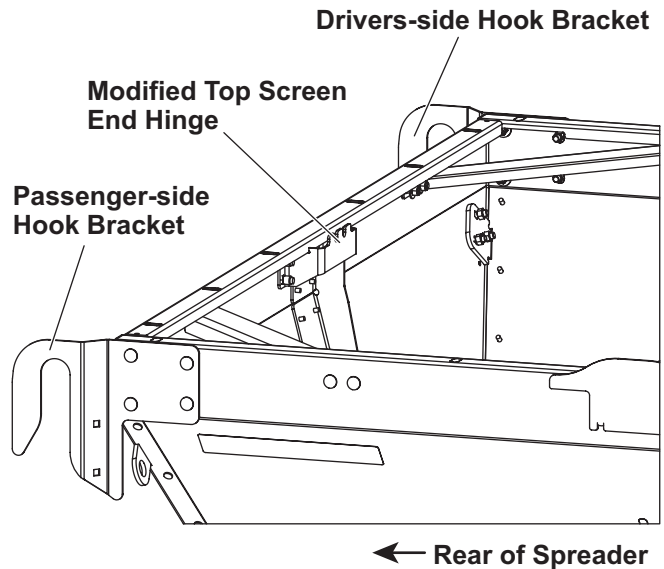

6. Loosen the fasteners holding the hopper cross braces in place, just enough to allow the bump-up plates to slide into place. Install the four bump-up plates with edge trim as shown, sliding them vertically from above onto the cross brace carriage bolts. Retighten cross brace fasteners.

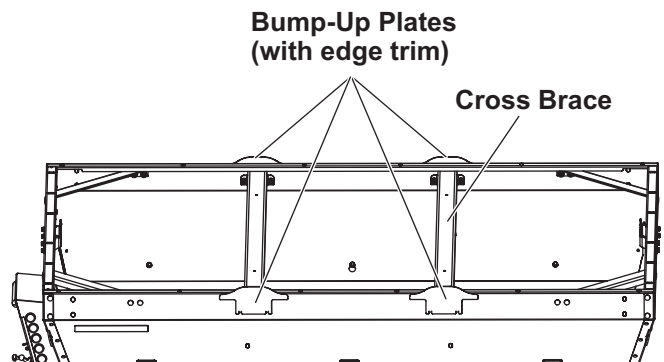

(Artwork not drawn to scale.)

7. Replace top screens and lynchpins.

NOTE: Prior to assembling the roller, identify driver-side and passenger-side roller brackets which will be installed on the cab end of the hopper. In addition, identify the white keder-sleeved edge of the black vinyl tarp which will be positioned at the chute end of the hopper.

8. Install the roller brackets to the cab end of the hopper using existing holes and supplied 3/8" x 1" carriage bolts, 3/8" washers, and 3/8" locknuts.

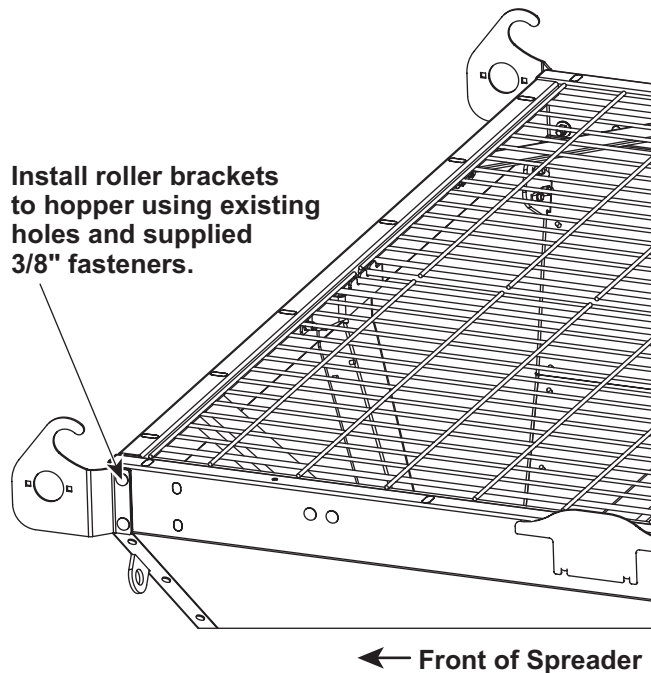

9. Slide the five sets of 1/4" fasteners along the length of the roller assembly, lining up each bolt with a grommet in the cab end of the tarp. Remove the locknuts and fender washers from the five carriage bolts and retain them for the next step.

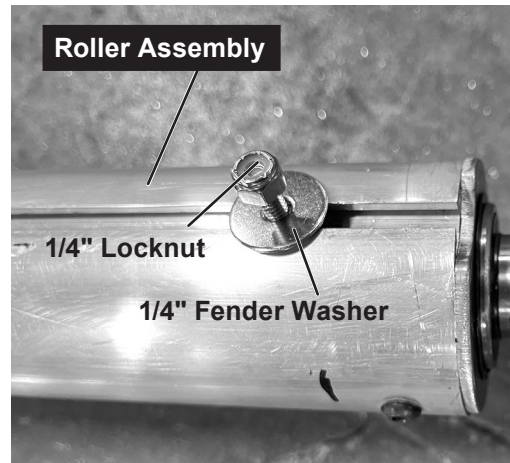

10. Relative to the tarp, ensure that the fixed plate end of the roller is on the passenger's side and the bare shaft end (for roller bearing) is on the driver's side.

Place the cab-end tarp grommets over the five 1/4" carriage bolts in the roller assembly, and secure the tarp to the roller using the fasteners removed in the previous step.

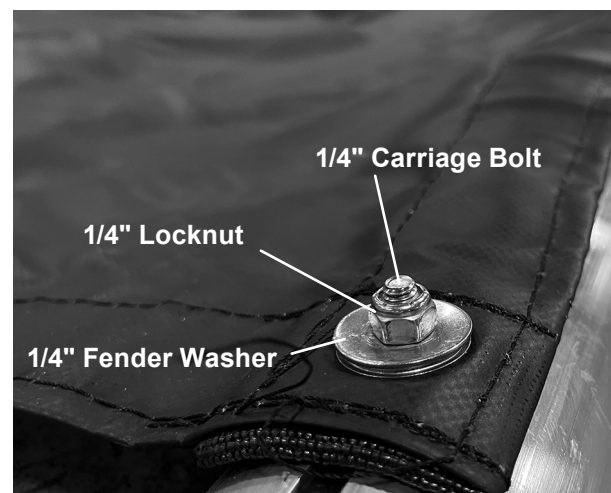

- Lay out the tarp along the length of the hopper with the roller assembly aligned to the cab end of the hopper. Assemble the roller bearing and roller bearing plates to the driver-side roller bracket and roller using 5/16" x 1" carriage bolts, 5/16" flat washers, and 5/16" locknuts as shown.

Driver's Side

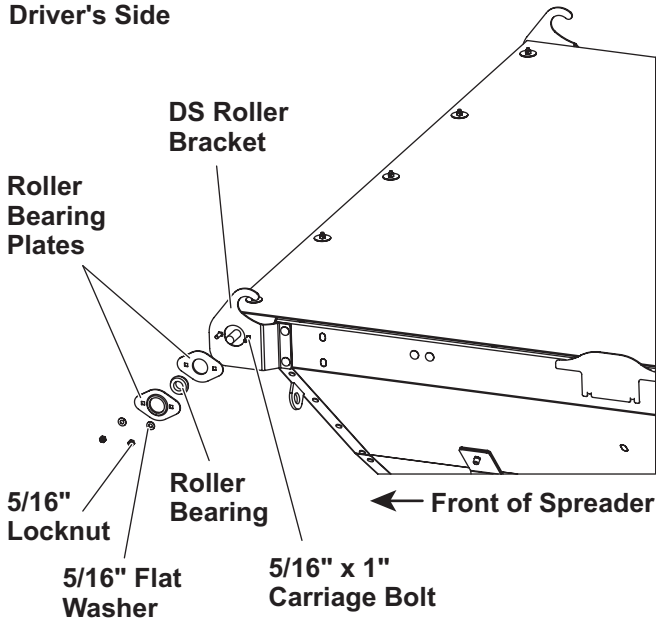

- On the passenger's side, secure the roller assembly to the roller bracket using 5/16" x 3/4" hex cap screws, 5/16" flat washers, and 5/16" locknuts as shown.

Passenger's Side

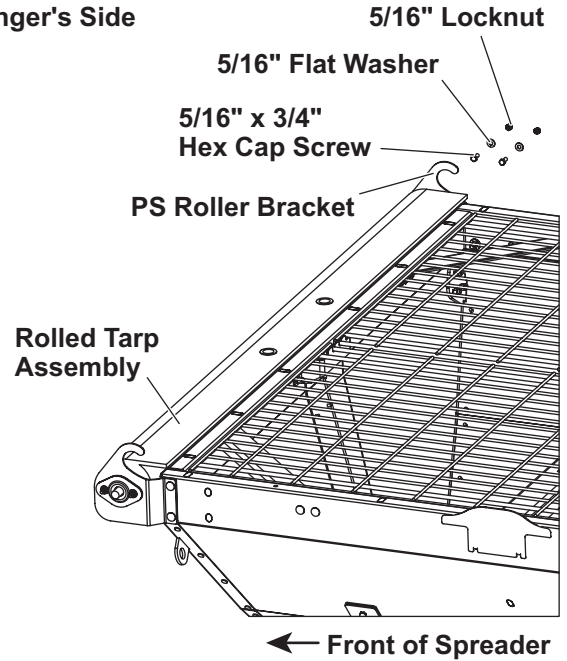

- Roll the tarp onto the roller by turning the roller counter-clockwise (when facing the driver-side end of the roller) until the tarp is fully wound around the roller. It can be helpful for an assistant to hold the passenger-side end of the roller in place during this step.

⚠ CAUTION

Stored tension in roller assembly might damage equipment or cause injury if released inadvertently during installation. Two people are required for installation.

14. This step requires two people.

- a. *Installer:* To load tension on the roller, twist the roller assembly 12 full rotations clockwise.
Assistant: During each rotation, feed the lead edge of the tarp into the gap between the hopper and the rolled tarp.

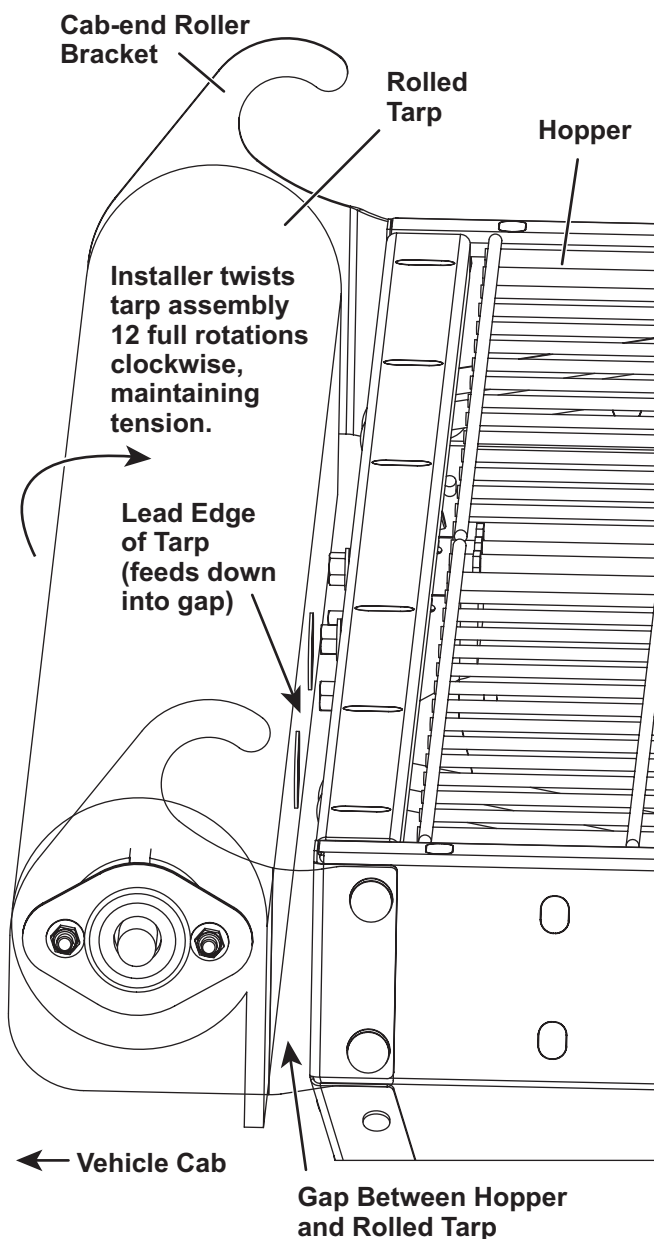

- b. *Installer:* **Hold the tensioned roller assembly firmly in position** while the assistant follows the next instructions.
- c. *Assistant:* Feed the white keder-sleeved edge of tarp into the slot in the tarp shaft, centering the tarp edge in the shaft. Assemble supplied PVC tubes and shaft end plates to both ends of the tarp shaft, securing the supplied M10 bolts with the internal lockwashers self-tapped in each end of the shaft. *These end plates are critical to assist with the alignment of the tarp to the hopper, ensuring that the tarp shaft does not reposition out of the tarp hooks when the vehicle is in motion.*

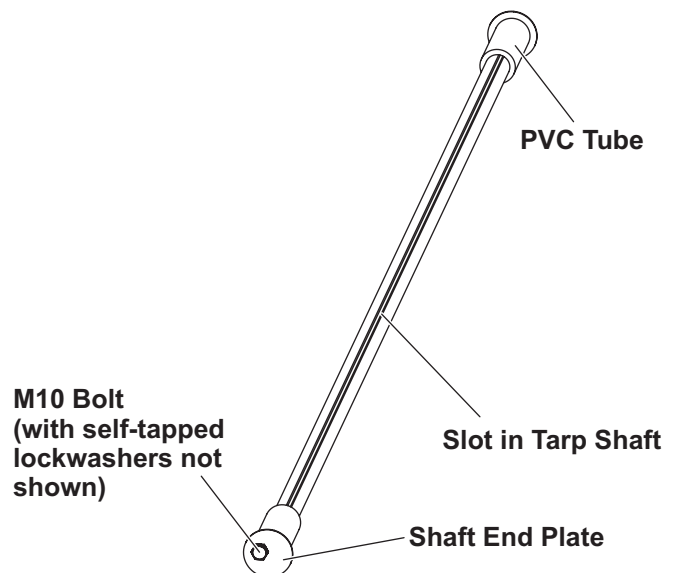

- d. *Assistant:* Stand clear of the hopper.
Installer: Release hold of the roller assembly, and quickly stand clear of the hopper as the tarp retracts under tension and the shaft catches in the cab-end roller brackets.

NOTE: Stand clear of the hopper whenever the rolled tarp cover is released.

15. Feed both ends of the tarp rope from below and through the two grommets in the tarp, as shown, creating a loop underneath. Tie a midshipmen's hitch knot with the two free ends of the rope, creating a single pull-point.

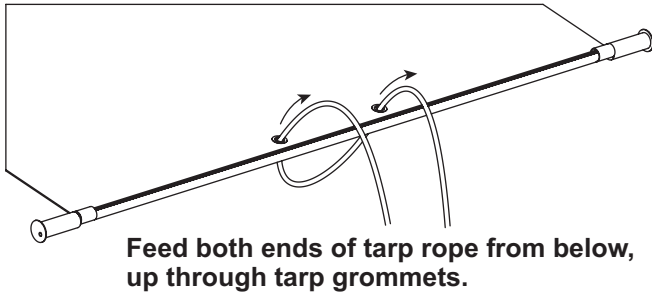

16. At the chute end of the hopper, use the rope to pull the rear end of the tarp (and shaft) into position, hooking the shaft securely into the two rear hook brackets.

NOTE: Ensure that the shaft releases smoothly and that the tarp bump-up plates guide the retracting tarp over the top screen pin points.

17. Remove the powergroup extension cover from the chute, retaining the four 3/8" x 1" serrated flange cap screws holding it in place. Knock out one of the two knockouts in the top of the extension cover. From above, insert supplied 3/8" x 1" serrated flanged cap screw, 3/8" washer, and tie down strap as shown, securing strap with a 3/8" locknut on the underside of the cover. Reinstall cover using original fasteners.

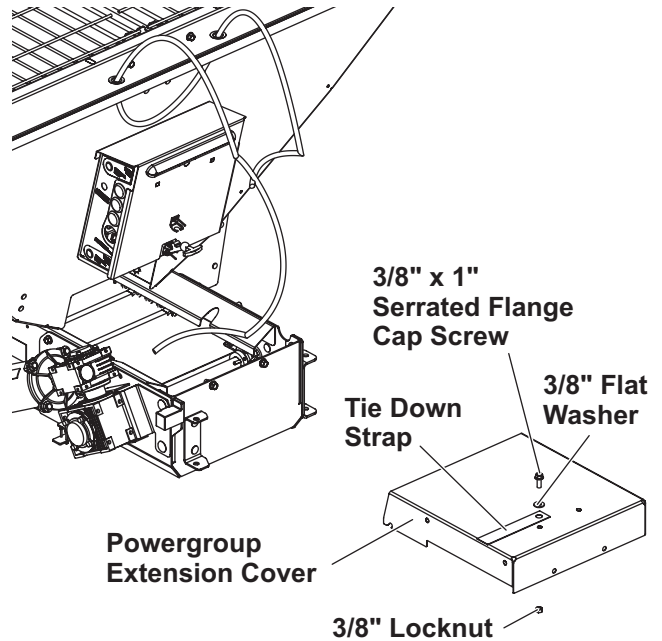

NOTE: Never leave rope dangling off the end of the hopper when spreader is in motion.

NOTE: Never run the auger/chain if rope has fallen into the hopper.

NOTE: Do not tie off rope near spinner disc.

NOTE: Whenever tarp is in use, securely tie off excess rope to the tie down strap on the powergroup extension cover.

NOTE: Ensure that the tarp surface is clear of all debris before untying rope, retracting tarp, or performing maintenance on the system.

18. The tarp rope must be accessible from the ground when the tarp is fully retracted at the cab end of the hopper. The rope length required will vary by vehicle and hopper model. It is recommended to cut and eliminate any extra length beyond that which is required.
19. If installing accessory light(s) with the rolled tarp cover, pre-assemble the strobe and work light(s) to the modified light brackets using hardware from the accessory light kit(s). Mount the modified drivers- and passenger-side light brackets to the respective hooked brackets at the rear of the hopper using 3/8" x 1" carriage bolts, 3/8" flat washers, and 3/8" locknuts. Ensure clearance between tarp shaft and work light(s).

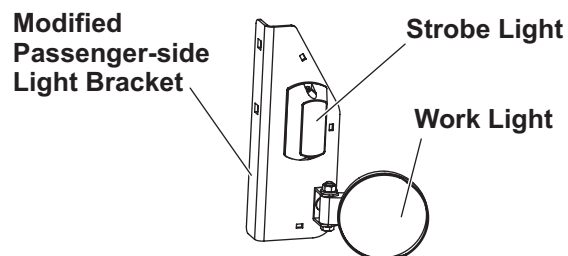

Modified passenger-side light bracket installation is shown.

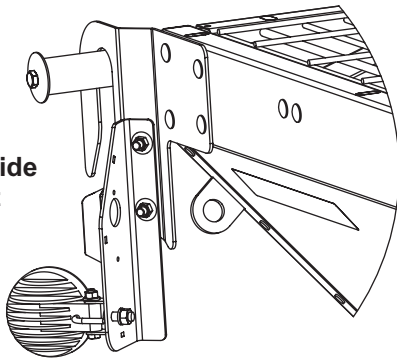

Copyright © 2025 Douglas Dynamics, LLC. All rights reserved. This material may not be reproduced or copied, in whole or in part, in any printed, mechanical, electronic, film, or other distribution and storage media, without the written consent of the company. Authorization to photocopy items for internal or personal use by the company's outlets or spreader owner is granted.

The company reserves the right under its product improvement policy to change construction or design details and furnish equipment when so altered without reference to illustrations or specifications used. This equipment manufacturer or the vehicle manufacturer may require or recommend optional equipment for spreaders. Do not exceed vehicle ratings with a spreader. The company offers a limited warranty for all spreaders and accessories. See separately printed page for this important information.

Printed in U.S.A.
