

CAPE REGIONAL... ADVANCING YOUR HOSPITAL, YOUR HEALTH.



“Cape Regional...Advancing Your Hospital, Your Health.”

Our Commitment To Our Community

Cape Regional Health System will celebrate the 75th anniversary of caring for our community in 2025. We are so proud to serve our community and the many visitors to Cape May County. These past two years have taught us a great deal about the delivery of healthcare, and nothing is more important to us, than providing the highest quality care to you and your family, when you need it, and where you need it.

On May 4, 2021, Cape Regional opened the Claire C. Brodesser Surgery Center, a 19,000 square foot, state-of-the-art surgery center offering our patients seamless and efficient surgical care utilizing advanced and specialized technology for today's most sophisticated surgeries. The patient feedback has been tremendous and exceeding all our expectations. With the support of the community, Cape Regional Foundation has raised \$8 million in philanthropic support to fund this much needed center.

As we continue to look at the healthcare needs of the future, Cape Regional is embarking on a major expansion of our Emergency Department and Radiology Department. With the opening of the Claire C. Brodesser Surgery Center, space previously utilized for surgical services at the Medical Center, will now allow for much needed expansion of these vital areas.

Despite delivering expert care in a timely fashion, the existing Emergency Department is in need of additional clinical space and dedicated radiology technology and equipment to provide a more efficient and comprehensive treatment area for a variety of conditions, ranging from life-threatening illness and injuries, to minor medical problems.

In conjunction with the expansion of the Emergency Department, our Radiology Department will also be relocated and expanded, into 15,000 square feet of space. This newly expanded space will include a new state-of-the-art Interventional Radiology Suite, a state-of-the-art 128-slice CT scan, new X-ray and Ultrasound Suites, Fluoroscopy Suite, and other radiology modalities to ensure the highest quality radiology services in the county. A dedicated entrance and waiting area have been incorporated into the master plan for patient and family ease of access and convenience.

This very exciting project will continue to enhance our mission to provide the highest quality healthcare to the residents and visitors of Cape May County. Cape Regional Foundation has committed to a major capital campaign to raise \$12 million to support this much needed endeavor. We hope that you will be as enthusiastic as we are to help bring our vision for the future to fruition with your philanthropic support. Every gift is important to our success, and we thank you in advance for your careful consideration.

Garry Gilbert
Chairman
Cape Regional Health System

Ellen Kravet Burke
Chairman
Cape Regional Foundation

Joanne Carrocino, FACHE
President & CEO
Cape Regional Health System

RADIOLOGY DEPARTMENT EXPANSION

New Technology to the Forefront of Care

With the opening of the Claire C. Brodessa Surgery Center, Cape Regional Medical Center now looks forward to expanding our radiology services into the vacated space with advanced radiology equipment and technology with a state-of-the-art Radiology Department. Cape Regional Medical Center is the only Diagnostic Imaging provider in Cape May County to provide 24/7 access to diagnostic imaging, CT scans and ultrasound services. With round-the-clock care, you can rest easy that you'll get results fast.

Rapidly evolving changes in the way that healthcare is managed, coupled with the amazing recent advances within Diagnostic Imaging, has necessitated a major investment and expansion of our Radiology Department. Radiology is a key diagnostic tool for many diseases and plays an important role in monitoring treatment and improving outcomes.

Radiology's role is central to disease management, with a wide choice of tools and techniques available for detection, staging and treatment. Early diagnosis saves lives. Without this critical diagnosis, there can be no treatment, and there can be no cure.

Radiology, also called Diagnostic Imaging, is a series of different tests that take pictures or images of various parts of the body which allow our radiologists to see inside the body. Several different imaging exams can be used to provide these images, including X-ray, MRI, ultrasound, CT scan, mammography, nuclear medicine, fluoroscopy, bone mineral densitometry and PET scan. Cape Regional is committed to keeping current with the most advanced state-of-the-art technology in our Radiology Department to provide our community with the highest quality radiology care in the region.



"Thank you is just not enough; the entire nursing staff, Radiology and the OR team all saved my life. I am eternally grateful to these smart, loving angels!"

"Every staff member treated me with kindness & respect. A special thanks to the Radiology physician, nurse, MRI tech and CT-scan tech. Your quick evaluation and diagnosis enabled me to start treatments immediately. Today, I am on the road to recovery, and I thank Cape Regional for that. Your professionalism and outstanding care were so much appreciated. I cannot thank you enough!"

EMERGENCY DEPARTMENT EXPANSION

Every Minute Counts During an Emergency

The Cape Regional Emergency Department is committed to providing the most advanced emergency medical care possible to every patient who comes through our doors. The Emergency Department at Cape Regional currently consists of 33 patient bays and treats over 36,000 patients a year. A five-bed Behavioral Health Unit is also located in the Emergency Department to tend to the needs of those individuals needing such care.

Our Emergency Department Team includes Board-Certified Emergency Medicine physicians, physician assistants, nurse practitioners and specially-trained Emergency Department nurses and technicians. Clinicians utilize the latest technology and equipment to provide comprehensive treatment for a variety of conditions ranging from life-threatening illness and injuries to minor medical conditions

Once complete, the new Emergency Department expansion will include nine additional patient bays with state-of-the-art technology, providing improved privacy and efficiency that will enhance the emergency experience of our patients. The Emergency Department will have dedicated radiology equipment within the department, including CT scan, X-ray, and ultrasound, reducing wait time for testing and diagnoses. These enhancements are designed to deliver efficient, personalized, high quality care, improve patient satisfaction, and accommodate the increased volume of acute patients, especially during our high-volume summer months.

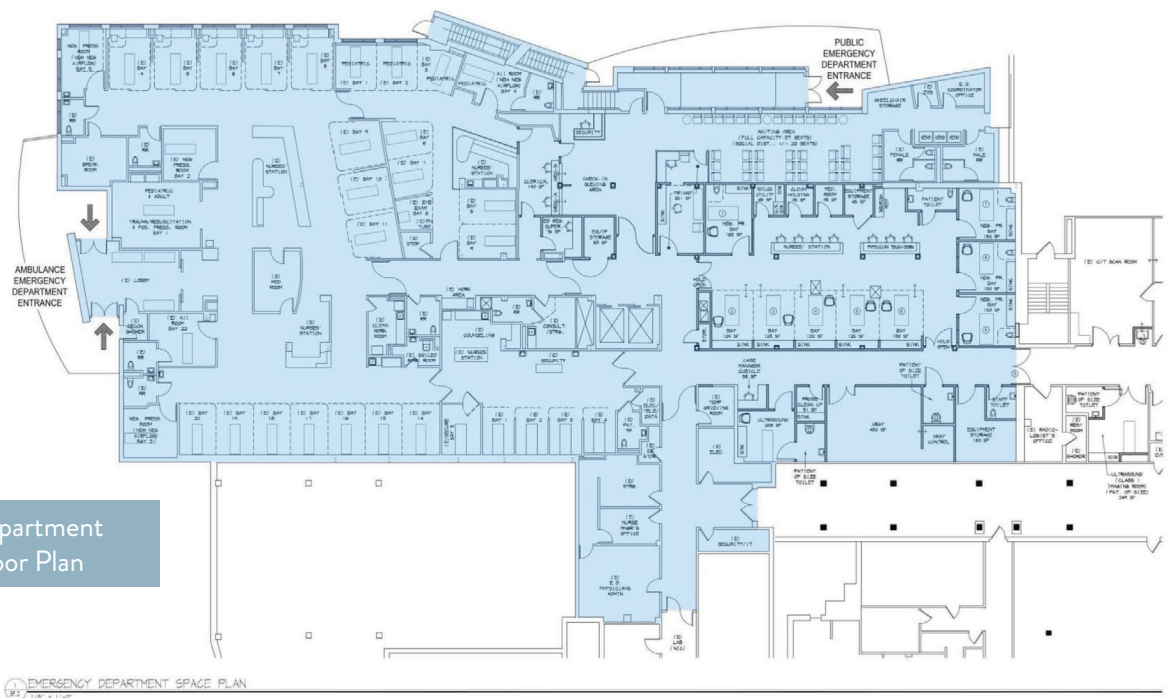

Emergency Department
Expansion Floor Plan

"I live in Pennsylvania and was brought to Cape's ER by ambulance following an accident. I needed multiple scans as well as stitches. I am thoroughly impressed with the efficiency and professionalism of your ER staff and especially impressed by your nurses and PA's. I wish we had an emergency room like yours in my town."

"Your emergency room saved my life. I knew I was having a heart attack. Both the nurse and the physician were engaging, informative and attentive. They were able to stabilize my condition before I was transferred by helicopter to U Penn for cardiac care. Outstanding care! Thank you very much!"

"I was impressed with the level of care & concern every member of your team extended to me in my time of need. I was very sick and the treatment I received in the ER saved my life. I am so grateful for the top-notch professional care and to know we have an outstanding emergency department in Cape May County. I spent six days in your hospital and continued to receive outstanding care. THANK YOU ALL!"

"I nearly cut off my thumb and was taken to Cape Regional's emergency department. The ER staff quickly began treating me. I was taken into surgery to re-attach my thumb and thankfully I have 80% function in my right thumb and still going to PT. Not the way I intended to spend my first Saturday on vacation at the Jersey Shore, but thankful for the great care at Cape Regional from start to finish!"

COMMUNITY INVESTMENT IN THE FUTURE OF HEALTHCARE IN CAPE MAY COUNTY

Larry L. Luong Emergency Department

Thanks to the strong leadership and dedication of our Board of Trustees, Medical Staff, Team Members, Auxiliaries and Volunteers, and through the generosity of thousands of donors who have made a personal investment in the growth at Cape Regional, we are able to continue to expand our services and better serve our community. Now more than ever, the importance of a strong, local medical center is critical.

Cape Regional Foundation is committed to undertaking a \$12 million major capital campaign to support the expansion of the Emergency Department and Radiology Department. This exciting capital campaign will help offset the \$19.9 million project investment. We are happy to announce that the Larry L. Luong Family Foundation has made a lead gift of \$3 million for the naming rights of the Emergency Department, in memory of their father, Larry L. Luong.

The success of this campaign will ultimately depend upon the enthusiasm and commitment of the friends of Cape Regional who see the extraordinary value of this project, how it supports our mission, how it will positively impact every member of our local community and our visitors, and how it will boost Cape Regional to the next level of advanced care.



"Through the Larry L. Luong Family Foundation, we look to honor our father and recognize his love for Cape May County with this gift to establish the Larry L. Luong Emergency Department at Cape Regional Medical Center (CRMC), stated Kevin Luong, Randy Luong, Tim Luong, and Brian Luong. "As we've seen through the decades, the Emergency Department serves not only the residents of the county but also the hundreds of thousands of visitors to the county during the summer. The recent spread of Covid-19 has highlighted the need for more space at CRMC. We applaud the CRMC Board of Trustees for their foresight in expanding and upgrading the Emergency Department as it is a critical resource for Cape May County. We are proud to associate our father's name with Cape Regional Medical Center and hope that our gift will inspire others to step forward."



\$12,000,000

Emergency Department and Radiology Department Expansion Capital Campaign

“Cape Regional...Advancing Your Hospital, Your Health.”

GIFT NAMING OPPORTUNITIES

RADIOLOGY DEPARTMENT

Radiology Pavilion Naming	\$ 5,000,000
New State-of-the-Art Interventional Radiology Suite	\$ 1,500,000
New 128-Slice CT Scan Suite	\$ 750,000
New Special Procedure Suite	\$ 750,000
New State-of-the-art Fluoroscopy Suite	\$ 500,000
New State-of-the-art X-Ray Suite	\$ 250,000
Radiology Reception Area	\$ 150,000
Radiology Physicians Reading Room	\$ 100,000
Radiology Registration Area	\$ 75,000
Radiology Patient Recovery/Holding Beds (5)	\$ 50,000
Radiology Director's Office	\$ 25,000
Radiology Manager's Office	\$ 25,000
Radiology Workstations (2)	\$ 25,000
Radiology Clerical Office	\$ 25,000

EMERGENCY DEPARTMENT

Emergency Department Naming	\$ 3,000,000
Emergency Department Dedicated CT-Scan Suite	\$ 750,000
Emergency Department Dedicated Dual X-Ray/Ultrasound Suite	\$ 250,000
Emergency Department Clinical Nurse's Station	\$ 250,000
Emergency Department Physician's Station	\$ 250,000
Emergency Department Triage Area	\$ 150,000
Emergency Department Family/Patient Waiting Area	\$ 100,000
Emergency Department Patient Bay (4) (Negative Pressure)	\$ 100,000
Emergency Department Patient Bay (5)	\$ 50,000
Emergency Department Patient Registration Area	\$ 50,000
Emergency Department Dedicated Medication Room	\$ 25,000
Emergency Department Nourishment Center	\$ 25,000
Emergency Department Equipment and Supply Room	\$ 25,000
Emergency Department Existing Patient Bays (33) Renovation of Existing Patient Bays	\$ 25,000



CAPE REGIONAL EMERGENCY DEPARTMENT AND RADIOLOGY DEPARTMENT EXPANSION CAPITAL CAMPAIGN

“Cape Regional...Advancing Your Hospital, Your Health.”

DONOR INFORMATION:

Name: _____

Address: _____

City: _____ State: _____ Zip Code: _____

Home Phone: _____ Cell Phone: _____

Email: _____

GIFT/PLEDGE INFORMATION:

I /We Pledge a total of \$_____ to be applied in its entirety to the Cape Regional Emergency Department and Radiology Department Capital Campaign.

My/Our gift balance will be paid over _____ years as follows:

☐ Weekly ☐ Monthly ☐ Quarterly ☐ Semi-Annually ☐ Annually

This pledge begins:

____/____/____ (DD/MM/YY) and ends ____/____/____ (DD/MM/YY)

☐ Please keep this gift/pledge anonymous. ☐ My company will match this gift/pledge.

A Single Gift. Payment information is below.

CHECK INFORMATION:

Enclosed is my check for a tax-deductible gift of \$_____ made payable to:
Cape Regional Foundation. Tax ID # 21-0662542

CREDIT CARD INFORMATION:

Please charge my tax-deductible gift of \$_____ to my credit card.

Credit Card #: _____

Exp. Date: _____ Security Code: _____ Billing Zip Code: _____

Cardholder's Signature: _____ Date: _____

Cape Regional Foundation
2 Stone Harbor Blvd. | Cape May Court House, NJ 08210
Attn: Tom Piratzky, CFRE, Executive Director
609-463-4042 | tpiratzky@caperegional.com



Cape Regional Foundation
2 Stone Harbor Blvd.
Cape May Court House, NJ 08210
Tom Piratzky, CFRE, Executive Director
609-463-4042
tpiratzky@caperegional.com