

## In This Issue

Commemorative Brick Plaza.....Page 1

Grin & Bear it 5K Run/Walk.....Page 2

Scholarship Awards...Page 3

Annual Plant Sale.....Page 4



## Board of Directors

Ethy Christman  
*President*

LeAnne Dickerson, RPh  
*Vice President*

Carole Arnold  
*Past President*

Tracy Sloan  
*Secretary*

Gina Smith  
*Treasurer*

Ivan E. Beeman, CPA

Janet Burlingame

T. R. Hoefle

Clayton Jones

Fred V. Kidd, Jr.

Cricket Kroenke

Chris Kurzweil

J. Christopher Lang, FACHE

Larry Pfautsch

Richard Price, MD

Linnette Pugh

Ed Roberts

Martha Howell Sims

Carol Welborn

Toni Wiseman

Sonya McLelland, CFRE  
*Administrative Director*

## The Floyd and Franceline Parris Community Trail Commemorative Brick Plaza



Honor a loved one, celebrate a special event, or simply secure your place in local history with a commemorative brick!

Made of durable gray granite, the bricks are available in two sizes: 4"x 8" and 8"x 8". See enclosed order form for additional details. Your message will be permanently displayed for years to come!

Proceeds from the commemorative bricks will be used for the construction and ongoing maintenance of The Floyd and Franceline Parris Community Trail on the Cass Regional Medical Center campus. The trail is named in honor of Floyd and Franceline Parris, who operated a large farm in the Pleasant Hill area for many years before moving to Harrisonville in the early 1990s. Through her trust, Franceline left a significant donation to Cass Regional Medical Center Foundation, a portion of which has been designated by the foundation board as the lead gift for the trail project.

The trail is made possible entirely through donations, including proceeds from commemorative brick purchases. The brick plaza will be located near the trailhead and provides a unique way to support a valuable community resource while remembering significant events and people in your life.

To purchase a brick online, please visit <https://www.cassregional.org/trailplaza/>.

To purchase by mail, please fill out the enclosed form and return it with your payment to Cass Regional Medical Center Foundation, 2800 E. Rock Haven Road, Harrisonville, MO 64701. For any questions, please contact Becky Welch at (816) 380-5888, ext. 4810, or via email at [rwelch@cassregional.org](mailto:rwelch@cassregional.org).

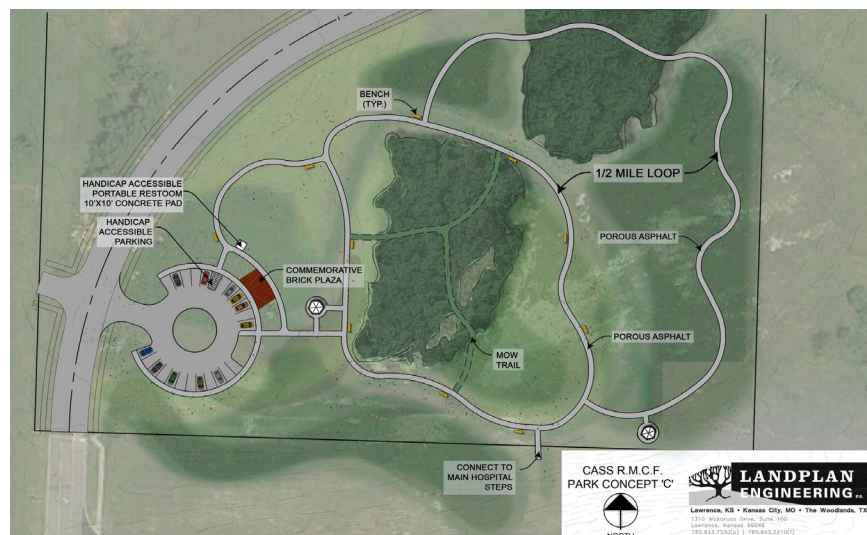





## Grin & Bear It 5K Run/Walk Raises Nearly \$6,900 for Cass Regional Patients

Cass Regional Medical Center Foundation hosted the tenth annual Grin & Bear It Run on Saturday, Sept. 28. The event grossed nearly \$6,900 for the Patient Assistance Fund, which is used to help Cass Regional patients in need with expenses such as transportation, medication, therapy and medical supplies.

Sponsors of the event included Country Club Bank; Foxwood Springs; Serenity Care Hospice; Sherwood Community Bank; CPSK Insurance Services; Robert Prettyman and Carl Percy;

Troutt, Beeman & Co.; A World of Smiles; Harrisonville Family Medicine; and Steve Croy – State Farm Insurance.

The Grin & Bear It Run is held each year in memory of Cara Roberts, and the event began with a moment of silence in her honor.

The overall male and female winners were Kevin Heinrich of Raymore and Esmeralda Chavez of Harrisonville, who finished with times of 21:14 and 25:47, respectively. Heinrich and Chavez, pictured below, each received a commemorative stuffed bear, and

medals were awarded to the top three finishers in each age group.

Following the 5K, participants were treated to breakfast catered by Chris Kurzweil of Kurzweils' Country Meats. Free health screenings were also offered.

Several area businesses also lent their support to the Grin & Bear It Run, including Harrisonville Community Center, Family Center Farm & Home, and Sonic Drive-In of Harrisonville. The Missouri State Highway Patrol provided traffic control for the event.







## Chavez, Johns Named Co-Recipients of Jan Perry Scholarship



**Briseida Chavez** and **Terry Johns, RN**, have been named co-recipients of the fall 2019 Jan Perry Scholarship for Cass Regional employees. Each will receive a \$1,000 award, which will be paid directly to their respective educational institutions.

Chavez, of Harrisonville, Missouri, works in the dietary department at Cass Regional, and is pursuing a nursing degree at Metropolitan Community College.

Johns, of Adrian, Missouri, is the manager of the cardiac rehab department at Cass Regional. She is pursuing a bachelor's degree in nursing at Chamberlain University.

The scholarship program was established in 2002 by the late Jan Perry of Harrisonville (pictured above). Jan, who was member of the Cass Regional Auxiliary, was motivated by the gratitude she felt for the nurses who cared for her throughout her battle with cancer. She initially funded the scholarship by putting back a little of her grocery money each week until she had saved \$1,000. After her death in 2007, her husband, Wirt, made a donation to expand Jan's scholarship program to two \$2,000 annual scholarships. Selection for the award is based on financial need and career goals.



**Briseida Chavez**



**Terry Johns, RN**

### *Scholarship Programs*

#### **Alma Brown Scholarship**

The Alma Brown Scholarship was established in 2013 with a bequest from Alma Brown of Harrisonville. This \$1,000 scholarship is offered once a year.

#### **Wanda Brown Scholarship**

The Wanda Brown Scholarship was established in 1999 with a gift from Wanda A. Brown. This \$1,000 scholarship is offered once a year.

#### **Elvin S. Douglas, Jr., Scholarship**

The Elvin S. Douglas, Jr., Scholarship was established by friends and colleagues to honor Mr. Douglas' 25 years of service on the hospital board. This variable scholarship is offered once a year.

#### **Geraldine Kidd Scholarship**

The Geraldine Kidd Scholarship was established by colleagues, family and friends in memory of "Gerri" Kidd, who was an LPN for over 20 years at Cass Regional. This variable scholarship is offered once a year.

#### **Dr. Harold E. Kirsch Memorial Scholarship**

The Dr. Harold E. Kirsch Memorial Scholarship was established in 2003 with a bequest from Dr. Kirsch's widow, Evelyn. This variable scholarship is offered twice a year.

#### **Dr. Gail G. Kroenke Memorial Scholarship**

The Dr. Gail G. Kroenke Memorial Scholarship was established with gifts given in memory of Gail G. Kroenke, DVM. This \$500 scholarship is offered once a year.

#### **Jan Perry Scholarship**

The Jan Perry Scholarship was established in 2002 by the late Jan Perry, who was a member of the Cass Regional Auxiliary, and her husband, Wirt. This \$2,000 scholarship is awarded twice a year.



## Success “Blooms” at the Annual Plant Sale

The ninth annual Plant Sale was held on Friday, September 27, and Saturday, September 28, in the Healing Garden at Cass Regional. Attendees shopped for their fall favorites, some of which were donated by community partners. Special thanks to Cass Regional’s VIGs (Very Important Gardeners), who staffed the sale and were on hand to answer plant-related questions. In addition to donating their time, the VIGs also divided and donated their own supply of perennials for the sale.



The event generated over \$3,000 for the Gardens Fund. The fund supports the ongoing maintenance of Cass Regional’s gardens.

To learn more about how you can support the Gardens Fund at Cass Regional, please contact **Becky Welch**, Foundation assistant, at (816) 380-5888, extension 4810, or via email at [rwelch@cassregional.org](mailto:rwelch@cassregional.org).

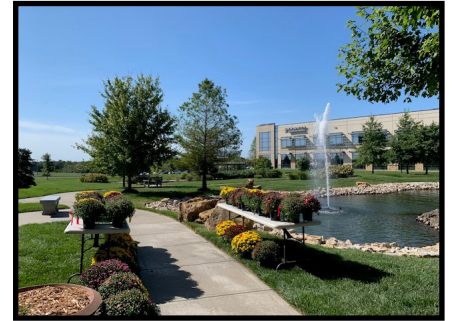

### *Upcoming Events*

**Pie-A-Thon - \$5 all you can eat pie**  
Friday, November 15, 11 a.m. to 2 p.m.  
Cass Regional Conference Rooms 1, 2, & 3  
To donate a pie, please contact **Patty Putnam** via email at [pputnam@cassregional.org](mailto:pputnam@cassregional.org). Proceeds benefits the Patient Assistance Fund.

### *Save the Date*

**Annual Foundation Dinner and Auction**  
Friday, April 3, 2020, 5:30 p.m.  
Beck Event Space, Harrisonville, MO

*“Like” Cass Regional Medical Center Foundation on Facebook to keep up with the latest information and upcoming events.*

### *Our Mission*

*The mission of Cass Regional Medical Center Foundation is to support the medical center in its quest to provide exceptional quality health care for the community. The Foundation encourages private philanthropy to further the vision, values, and goals of the medical center, especially in community outreach.*



*Cass Regional Medical Center Foundation is an IRS-designated 501(c)(3) charity (EIN 43-1501416).*



*Please remember Cass Regional Medical Center Foundation in your will.*



*We hope you have enjoyed this issue of “Making a Difference.” If you wish to be removed from our mailing list, please email [rwelch@cassregional.org](mailto:rwelch@cassregional.org) or call (816) 380-5888, extension 4810.*