

In This Issue

Update on the Community
Trail.....Page 2

Scholarship Awards...Page 3

Franceline Parris
Scholarship.....Page 4



Board of Directors

LeAnne Dickerson, RPh
President

Tracy Sloan
Vice President

Ethy Christman
Past President

Gina Smith
Secretary

Larry Pfautsch
Treasurer

Carole Arnold

Denise Ashby-Cohen

Ivan E. Beeman, CPA

Janet Burlingame

Stacey Dahlman

T.R. Hoefle

Clayton Jones

Fred V. Kidd, Jr.

Chris Kurzweil

J. Christopher Lang, FACHE

Richard Price, MD

Linnette Pugh

Ed Roberts

Carol Welborn

Toni Wiseman

Sonya McLelland, CFRE
Administrative Director



SAVE THE DATE!
Friday, April 3
Beck Event Space
Harrisonville, Missouri

Spring into Action for Patients

Cass Regional Medical Center Foundation will host its annual fundraising dinner and auction, Spring into Action for Patients, on Friday, April 3, at Beck Event Space in Harrisonville. The evening will start at 6 p.m. with a social hour and silent auction, followed by dinner and a live auction. Rich Linden, a nationally-known event host and DJ, will serve as emcee.

Proceeds from the event will benefit the Patient Assistance Fund. The fund is used to assist disadvantaged Cass Regional patients with urgently needed items such as transportation, medication, and home care supplies. The fund also provides assistance with certain therapies, such as physical and occupational therapy, speech therapy, cardiac rehabilitation, diabetes education and wound care. With the addition of therapy as one of the areas covered, the demand for assistance has increased over the last year. Your support will ensure that more patients will receive the therapy they need to recover successfully!

Online registration will be available later in February. For more information, contact **Becky Welch** at (816) 380-3474, extension 4810, or email rwelch@cassregional.org.

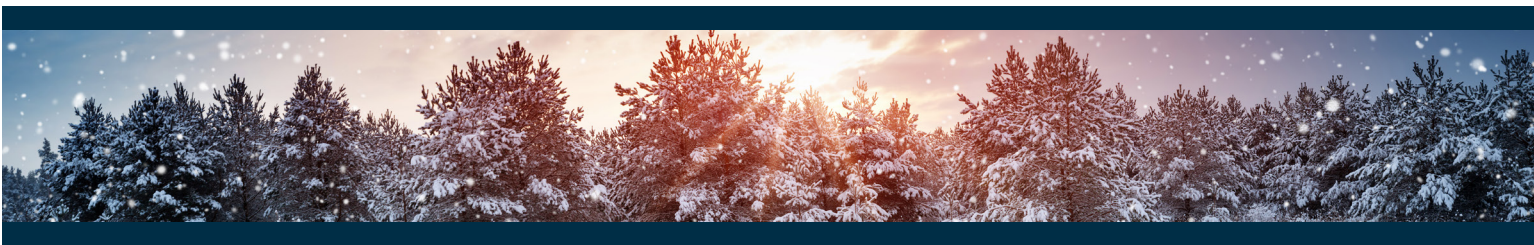

Construction to Begin on The Floyd and Franceline Parris Community Trail this Spring

Sunderland Foundation awards \$50,000 grant for project

The Sunderland Foundation has awarded a \$50,000 grant to Cass Regional Medical Center Foundation to support construction of The Floyd and Franceline Parris Community Trail on land behind the Cass Regional campus.

“We deeply appreciate the Sunderland Foundation’s significant investment in The Floyd and Franceline Parris Community Trail,” said Sonya McLelland, administrative director of Cass Regional Medical Center Foundation. “Thanks to their donation, we now have the funds needed to proceed with putting the project out to bid,” she said.

More than \$375,000 has been donated to build The Floyd and Franceline Parris Community Trail, including \$150,000 from the Franceline Parris Trust and \$100,000 from Cass Regional Medical Center. Proceeds from 2019’s Boots & Bar-B-Que fundraising dinner and auction, plus other special fundraising events, were directed to the trail construction fund. In addition, several donors have given to support the project, including sponsorship of benches and commemorative bricks.

When completed, the trail will consist of two quarter-mile loops that will wind through a natural setting. The path will be paved, allowing access for those who use assistive devices such as walkers and wheelchairs.

For more information, contact Cass Regional Medical Center Foundation at (816) 380-3474, extension 4810.

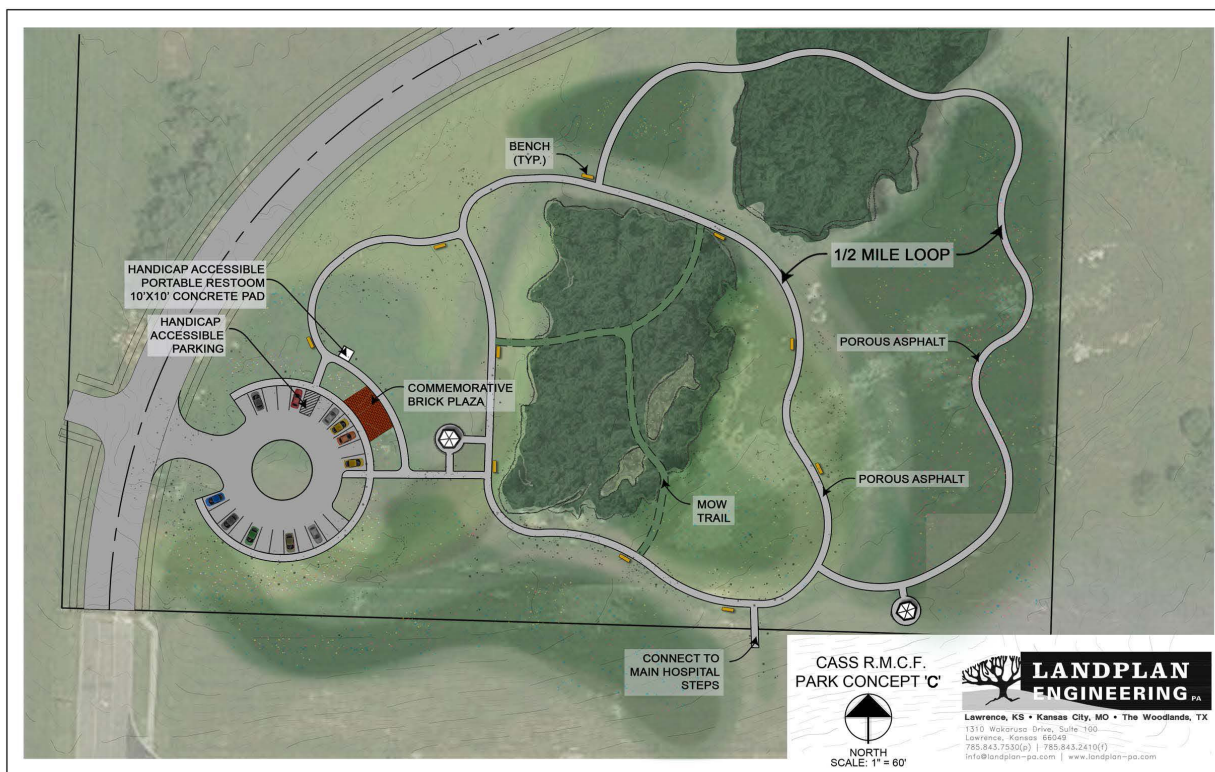

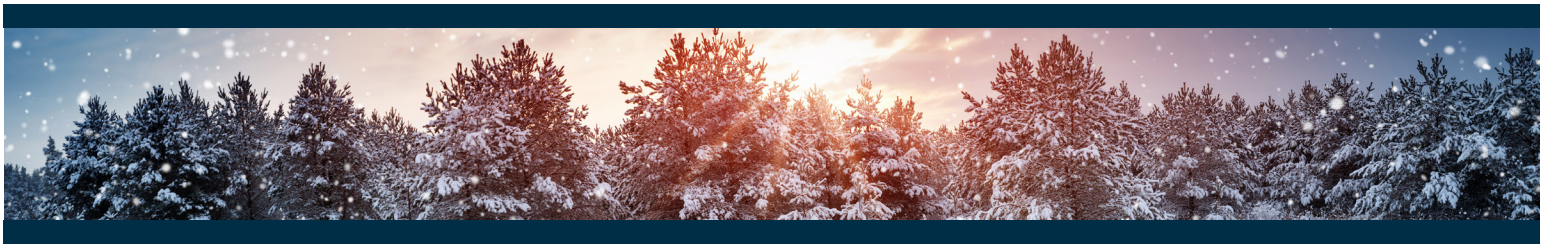

Kidd, Kirsch Scholarships Awarded

Tonya Myers of Garden City and Alexandra Campbell of Harrisonville have been selected to receive the Dr. Harold E. Kirsch Memorial Scholarship from Cass Regional Medical Center Foundation. Terry Johns of Adrian was selected to receive the Geraldine Kidd Scholarship.

Myers holds a bachelor's degree in nursing and is the quality/patient safety manager at Cass Regional Medical Center. She has been employed by the organization since 2017. Myers is currently enrolled at Western Governors University, and is pursuing a master's degree in nursing.

Campbell has worked as a licensed practical nurse on the Medical/Surgical Unit at Cass Regional since 2018. She previously worked in the same unit as a telemetry technician from 2009 to 2011. Campbell is currently pursuing an associate's degree in nursing at Donnelly College in order to become a registered nurse.

Johns is a registered nurse and has worked as the manager of Cass Regional's Cardiac Rehabilitation department since 2011. She is currently enrolled at Chamberlain University to obtain a bachelor's degree in nursing.

The Dr. Harold E. Kirsch Memorial Scholarship was established by the late Evelyn Kirsch, who left a gift to Cass Regional Medical Center Foundation in her will. She directed that her donation be used to establish a scholarship program in memory of her husband, Dr. Harold E. Kirsch, who cared for generations of Cass Countians prior to his untimely death in 1977. The Kirsch Scholarship awards of \$2,000 each for both Myers and Campbell will be paid directly to their respective universities.

The Geraldine Kidd Scholarship was established by friends and family in memory of "Gerri" Kidd, who worked as a licensed practical nurse at Cass Regional Medical Center. The Kidd Scholarship award of \$500 will be paid directly to Chamberlain University on Johns' behalf.



Tonya Myers



Alexandra Campbell



Terry Johns

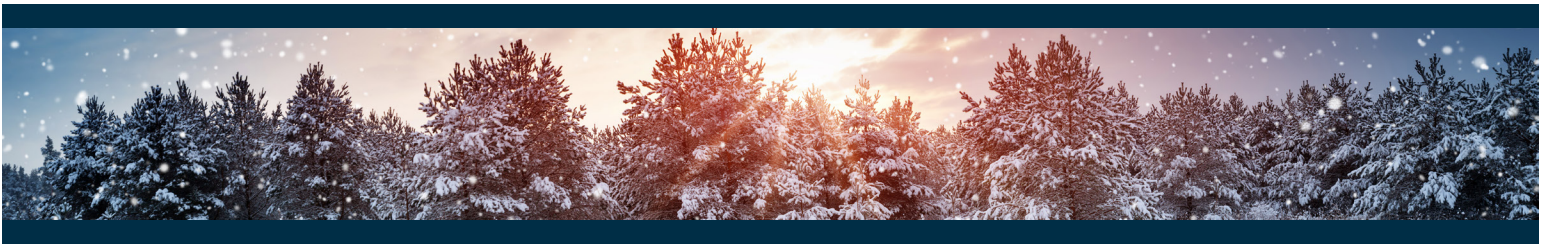

Board Establishes Franceline Parris Scholarship Endowment



Franceline Parris

The board of directors of Cass Regional Medical Center Foundation has established the Franceline Parris Scholarship endowment fund with a portion of the gift that Mrs. Parris left to the foundation through her trust.

The endowment fund will be \$100,000, which will be permanently invested. The earnings from the investment will be used to fund the Franceline Parris Scholarship for students who are pursuing education in certain health disciplines, including nursing, medical technology, radiologic technology, and respiratory therapy.

“Education was very important to Mrs. Parris, as evidenced by the scholarships she funded through Cass Regional Medical Center Foundation during her lifetime,” said Sonya McLelland, Foundation director. “We are honored to extend her legacy for years to come through the Franceline Parris Scholarship endowment fund.”

The annual scholarship award will vary based on the earnings of the fund. For more information, contact the Foundation office at (816) 380-3474, extension 4810.



Upcoming Events

Spring into Action for Patients

6:00 p.m., Friday, April 3
Beck Event Space, Harrisonville, Mo.
See more information on page 1

“Like” Cass Regional Medical Center Foundation on Facebook to keep up with the latest information and upcoming events.

Our Mission

The mission of Cass Regional Medical Center Foundation is to support the medical center in its quest to provide exceptional quality health care for the community. The Foundation encourages private philanthropy to further the vision, values, and goals of the medical center, especially in community outreach.



Cass Regional Medical Center Foundation is an IRS-designated 501(c)(3) charity (EIN 43-1501416).



Please remember Cass Regional Medical Center Foundation in your will.



We hope you have enjoyed this issue of “Making a Difference.” If you wish to be removed from our mailing list, please email rwelch@cassregional.org or call (816) 380-5888, extension 4810.