

HUMBOLDT GENERAL HOSPITAL

DISTRICT BOARD OF TRUSTEES

REGULAR BOARD MEETING

TUESDAY

MAY 4, 2021

5:30 P.M.

SARAH WINNEMUCCA CONFERENCE ROOM

Alicia Cramer - Chairman
Michelle Miller - Secretary
JoAnn Casalez - Member
Gene Hunt - Member
Lewis Trout - Member
Ken Tipton - Member-Humboldt
County Commissioner

HUMBOLDT GENERAL HOSPITAL
118 EAST HASKELL STREET
WINNEMUCCA, NEVADA 89445

DISTRICT BOARD OF TRUSTEES SPECIAL MEETING AGENDA

MEETING DATE: Tuesday May 4, 2021
MEETING TIME: 5:30 pm
MEETING PLACE: Sarah Winnemucca Conference Room
Humboldt General Hospital
118 E Haskell St, Winnemucca, Nevada
PLACES POSTED: in Winnemucca, Nevada at:
Humboldt General Hospital, 118 E Haskell Street
Humboldt County Courthouse, 50 W Fifth Street
Winnemucca City Hall, 90 W Fourth Street
Humboldt County Library, 85 E Fifth Street
United States Post Office, 850 Hanson Street
www.hghospital.org https://notice.nv.gov
PERSON POSTING: Alicia Wogan

MEETING ATTENDANCE MAY BE
VIA TELECONFERENCE OR VIDEOCONFERENCE OR IN-PERSON
THE ATTENDANCE FOR MEMBERS OF THE GENERAL PUBLIC AT THE
PHYSICAL LOCATION MAY BE LIMITED DUE TO DISTANCING REQUIREMENTS
THE TELECONFERENCE AND VIDEOCONFERENCE ACCESS INSTRUCTIONS APPEAR BELOW

Teleconference: Dial 1-646-749-3122 - Access Code 368-086-437

Videoconference: <https://global.gotomeeting.com/join/368086437>

A. CALL TO ORDER

B. PUBLIC COMMENT

(This agenda item is designated to give the general public the opportunity to address the Hospital Board. No action may be taken upon a matter raised under this section until it is placed on an agenda for action. Public comment is generally limited to three (3) minutes per person.)

F. BUSINESS ITEMS-OTHER REPORTS

(The agenda items in this section are for discussion and for possible action. The action may consist of approval, disapproval, acceptance, rejection, authorization, adoption, recommendation, review, referral to staff, or any other action as appropriate. The items may be heard in any order and at any time unless a time is specified; two or more items may be combined for consideration; an item may be removed from the agenda; or, discussion relating to an item may be delayed at any time.)

1. Hospital Administration-EMS / determination that emergency service vehicles used for dealer and/or manufacturer demonstration purposes can be purchased at a reasonable savings over the cost of similar equipment and below market cost / authorization to purchase demonstrator emergency service vehicle(s) at a total cost not to exceed \$500,000 / EMS Chief-Administration

DISTRICT BOARD OF TRUSTEES MEETING AGENDA

May 4, 2021

Page 2

G. TRUSTEE COMMENTS-STAFF REPORTS

(This period is designated for receiving reports, information, updates and proposals from the board and/or staff. No action may be taken upon a matter raised under this section until it is placed on an agenda for action.)

H. PUBLIC COMMENT

(This agenda item is designated to give the general public an opportunity to address the Hospital Board. No action may be taken upon a matter raised under this section until it is placed on an agenda for action. Public comment is generally limited to three (3) minutes per person.)

Notice: This agenda has been physically posted at the locations noted above and electronically posted at <http://www.hghospital.org/> and at <https://notice.nv.gov/>.

Notice: The meeting may be accessed via: (i) teleconference by dialing 1-646-749-3122 and using access code 368-086-437; or, (ii) videoconference by entering <https://global.gotomeeting.com/join/368086437> in a web browser.

Notice: Members of the public may make a public comment at the meeting without being physically present by emailing adminoffice@hghospital.org no later than 5:00 p.m. on the business day prior to the day of the meeting and messages received will be transcribed for entry into the record and provided to the Board of Trustees for review. Members of the public may also make a public comment at the meeting without being physically present by accessing the meeting through: (i) a telephone connection by dialing 1-646-749-3122 and using access code 368-086-437; or, (ii) through the Internet by entering <https://global.gotomeeting.com/join/368086437> in a web browser.

Notice: The Executive Assistant at the Administration Office located at Humboldt General Hospital, 118 E. Haskell Street, Winnemucca, Nevada, telephone number 775-623-5222 extension 1123, is the designated person from whom a member of the public may request the supporting material for the meeting. Staff reports and supporting material for the meeting are available on the Humboldt General Hospital website at <http://www.hghospital.org/> and are available to the general public at the same time the materials are provided to the Board of Trustees.

Notice: By law a public body may receive information from legal counsel regarding potential or existing litigation involving a matter over which the public body has supervision, control, jurisdiction, or advisory power and such gathering does not constitute a meeting of the public body.

Notice: Reasonable efforts will be made to assist and accommodate disabled persons. Please contact the Administration Office by telephoning 775-623-5222 extension 1123, one (1) business day in advance of the meeting.



23005 N 15th Avenue, Suite 207, Phoenix AZ 85207

**BRAUN CHIEF XL
DEMERS MXP170
TYPE I AMBULANCES**

April 29, 2021 - UPDATED

EMS Chief Brett Peine
HGH EMS & Rescue
118 E. Haskell Street
Winnemucca, NV 89445

Dear Chief Peine:

Thank you for giving us an opportunity to update our proposal for a selection of stock and demo ambulances for your fleet needs. This proposal covers two different Type I ambulances, each very attractive in their own way. This proposal does not include any graphics or wrap. The proposed units are white.

RedSky has been a Braun dealer for about 18 months. We have been in business since 2010, and represented Demers Ambulances for most of that time. With the merger between Demers and Braun in 2018, we were really excited about the opportunity to represent both product lines. Braun's quality is exceptional, and we really enjoy working with them to customize ambulances exactly like our customers need.

All of the proposed Brauns feature their trademark design and construction attributes:

- All aluminum SolidBody™ break-formed construction for exceptional durability and lifetime structural warranty
- Roof and side load testing that exceeds the required load capacity by 300%
- Industry first rollover and side-impact crash testing for the Braun module design for added assurance of occupant safety. [See videos.](#)
- Arched roof design allows for more internal headroom, gives added strength across the top, and eliminates water and snow pooling.
- Sprayed foam insulation on the ceiling, walls, doors, and entire underside of body provides superior acoustical and thermal insulation
- EZ Glide™ sliding door for added safety. Braun was the innovator that developed, introduced and perfected the sliding door to the ambulance market.

In the case of Demers, they also have a number of defining features that make them very attractive:

- Outstanding separate, independent air conditioning / heat systems, with individually ducted AC for even-flow distribution from front to rear
- All-aluminum & composite interior with powder-coated surfaces
- **Keyless Anti-Theft system so crews can leave the engine (and air conditioning) on**, take the key and lock the unit without having to worry that someone might drive it away
- DEMS multiplex electrical system with remote diagnostics from the factory, reducing downtime
- All aluminum cabinetry structure
- Strongest warranties in the industry
- Pull-testing of all installed features and options

We understand that keeping your ambulances in service is vital. Our focus is ensuring fast, convenient service. For that reason, we have relationships with two mobile service providers – D&M Emergency Services and KNB Fire. We are also happy to establish a relationship with any local service provider to ensure you have excellent care for warranty and repair. Details of Braun and Demers warranty coverage are below. To arrange warranty service, you just call us and we'll handle it with our service partners.



23005 N 15th Avenue, Suite 207, Phoenix AZ 85207

Standard Warranties, Braun:

- Electrical: 7 years / 84,000 miles
- Structural: Lifetime
- Paint: 7 years
- Materials & Workmanship: 3 years / 36,000 miles

Standard Warranties, Demers:

- Module Structure: 25 Years "Lifetime"/Unlimited Miles
- Paint: 5 Years/180,000 Miles (non-prorated)
- Electrical: 5 Years/180,000 Miles
- Materials and Workmanship: 5 Years/180,000 Miles
- **OEM Materials: 2 Years/75,000 Miles**

The proposed ambulance prices include RedSky providing and installing a Stryker PowerLoad powered cot retention system. We would have KNB Fire come to Winnemucca to stall them after delivery. Stryker tells me that their lead time on PowerLoads is about 8 weeks, but our experience recently has been faster than that.

We are pleased to extended the following pricing for your consideration:

Ambulance Pricing:

Description	Unit Price
One (1) Braun Chief XL Type I Ambulance, 2019 Ford F450 4x4 diesel-driven chassis	\$249,300.00*
One (1) Demers MXP170 Type I Ambulance, 2021 Ford F450 4x4 diesel-driven chassis	\$224,150.00*
Total	\$473,450.00

**Includes Ford rebate of -\$4,800 per unit based on HGH Ford FIN code of QA660 and HGH's willingness to work with RedSky for dealer to collect rebate after sale. Changes or elimination of the Ford FIN code rebate will cause adjust to final price.*

Terms

Payment Terms: Payment shall be made directly to RedSky Fire Apparatus, Inc. Payment is due before or at time of delivery.

Delivery: **The Braun Chief XL is complete and available now. The Demers MXP170 is scheduled to be complete in late May / early June.** The Seller shall not be liable for failure to deliver or for any delay in delivering the motor vehicles covered by this agreement where such failure or delay is due, in whole or in part, to any cause beyond the control or without the fault or negligence of the Seller. Delays from the chassis manufacturer will result in extended delivery time, as will changes to this contract once the order has been placed with Demers Ambulance or Braun Industries. Additions or deletions may be made if the vehicle has not passed that point in production at the time of change.

Delivery Terms: FOB Humboldt General Hospital EMS & Rescue, Winnemucca NV



23005 N 15th Avenue, Suite 207, Phoenix AZ 85207

Sales & Use Taxes: The price for the motor vehicle specified in this agreement does not include Sales Taxes and Use Taxes (Federal, State, or Local) unless expressly stated. Purchaser assumes and agrees to pay, unless prohibited by law, and such Sales, Use, or Occupational Taxes imposed on or applicable to the transaction covered by this agreement, regardless of which party may have primary tax liability.

Validity: First come, first serve

We thank you for allowing us the opportunity to earn your business. Please do not hesitate to contact me with any questions.

With best regards,

A handwritten signature in black ink, appearing to read "Kirsten Skyba".

Kirsten Skyba
VP – Operations & Customer Service
RedSky Fire Apparatus LLC

**Braun Chief XL Stock, Type I, #8097
Configuration Highlights**

- 2019 Ford F450 4x4 diesel-powered chassis
- Liquid Spring suspension
- Power locks for module entry and compartment doors
- 169" module with 72" interior headroom
- Weldon Vmux multiplex electrical system
- EZ O2 Lift
- Inverter prewire
- Rear view camera
- EZ Glide side entry door
- LED strip lights in exterior compartments
- Backboard / scoops storage with vertical divider and 2 adjustable shelves in rear curbside compartment (OSS #4)
- Attendant Seat: Valor seat with 4-point harness, child safety seat, swivel
- CPR seat: Valor seat back with 4-point harness
- Squad Bench: One (1) Valor seat back with 4-point harness, extended seat cushion
- Work station with pull-out sharps/waste containers on curbside at head of squad bench
- Third Vista screen on curbside
- Cabinet above squad bench area
- Interior access to rear curbside compartment
- Cabinet under pass through for extra storage
- Full-sized drawer and two cabinets in front wall cabinet
- Franklin digital clock above rear entry doors
- Universal tapping plate for PowerLoad installation
- Dealer-supplied PowerLoad and installation at customer location

Mileage: Approximately 10,000



QUOTATION

Ó:æ } Å^æ! È · È È	
--------------------------------	--

Exp. Date: 09/15/2017
Quote No: 10003-0014
Job/Order No: 8057
AMB I: 18BDDI Chief XL 2018 Braun Dealer Demo TYPE I

REF. NO.	PART NO.	Q	DESCRIPTION	QTY
		S	== Chief XL 2018 TYPE I - 18.100 05/02/17 == CHANGES: Description, Special	1
KKK FED SPEC REQ		S	KKK FEDERAL SPECIFICATION REQUIRED CHANGES: Special, Print on Shop	1
CN8 COMPLIANCE REQ			KKK CHANGE NOTICE 8 REQUIRED	1
KKK-A-1822F CN8	00-01-0018		BIDDER KKK-A-1822F CHANGE NOTICE 8 COMPLIANT	1
KKK-A-1822F CN9	00-01-0019		BIDDER KKK-A-1822F CHANGE NOTICE 9 COMPLIANT	1
KKK-A-1822F CN10	00-01-0020		BIDDER KKK-A-1822F CHANGE NOTICE 10 COMPLIANT	1
	00-01-0031		NO PERFORMANCE BOND REQUIRED SHOP NOTE: No Performance Bond Required	1
	00-01-0041		NO BID BOND REQUIRED SHOP NOTE: No Bid Bond Required	1
	00-01-0051		NO REQUIRED DELIVERY DATE SHOP NOTE: No Specific Required by Delivery Date	1
	00-01-0053		PRECONSTRUCTION MEETING NOT REQUIRED / REQUESTED CHANGES: Print on Shop SHOP NOTE: The purchaser and / or end user does not wish to request a Pre-Construction meeting with the manufacturer.	1
	00-01-0061	S	PURCHASE AGREEMENT CHANGES: Specification, Special, History, Print on Quote, Print on Spec, Print on Shop	1
2017-XX LEAD TIME	00-01-0062		LEAD TIME DEFINED CHANGES: Print on Shop SHOP NOTE: PLEASE NOTE: Vehicle lead time is established upon date of accepted order and receipt of chassis	1

REF. NO	PART NO	S	DESCRIPTION	QTY
STD 2015	00-01-0091		REQUIRED REMAINING EQUIPMENT PAYLOAD: CHANGES: Print on Shop	1
			SHOP NOTE: The required remaining equipment payload for this unit is: _____	
2018 BDD I F450	00-01-0222 20	S	TYPE I - AMBULANCE - CHIEF XL I - 72" INTERIOR HEADROOM CHANGES: Price, Special	1
			SHOP NOTE: 2018 CHIEF XL I - 169" MODULE	
SECTION HEADING 2018 BDDI F450 4X2	10-01-0195	S	CHASSIS PACKAGES CHASSIS - FORD F-450 CHASSIS, 193" WB 4 x 4 CHANGES: Description, Price, Special, Shop Note	1 1
			SHOP NOTE: 2019 Chassis	
STD 2014 2017 -XX STD CHFSLI	20-10-0099 20-10-0103 70		FUEL TANK - FULL UPON FACTORY RELEASE SUSPENSION - LIQUID SPRING SHOP NOTE: Liquid Spring STD	1 1
STD F-SERIES STD 2014/15 STD 2018-XX BDDI	20-10-0206 20-10-0603 20-20-0133 10		BATTERY - TWO SYSTEM - F SERIES CHASSIS ENGINE BLOCK HEATER - OEM PLUG FLOOR CONSOLE - ANGLED FACE REMOVABLE PLATES - ALUMINUM SHOP NOTE: A center floor console manufactured out of aluminum and covered in a black onyx scratch resistant, multi-use polychromatic coating with a clear epoxy finish shall be installed in the cab	1 1 1
STD STD E & F CHASSIS	20-20-0251 20-20-0277	^	HEAT SHIELDS HIGH IDLE SYSTEM, AUTOMATIC NOTE: ECR 14-034	1 1
STD E-SERIES STD 2018-XX BDDI	20-30-0201 20-30-0261 10		MIRRORS, EXTERIOR OEM MANUAL TELESCOPING- REMOTE WITH/CONVEX OEM AUTO-LOCK DISABLED (cab & module doors do not auto lock or unlock) SHOP NOTE: The OEM auto-lock feature will be disabled.	1 1
STD 2014/15 TYPE III STD	20-30-0804 20-40-0206		RUNNING BOARDS - STAR PUNCHED DIAMOND PLATE WHEEL SIMULATORS, STAINLESS STEEL WITH VALVE STEM EXTENSIONS	1 1
SECTION HEADING			ELECTRICAL SYSTEM FEATURES	1
STD 2017-XX	30-06-0004		ELECTRICAL SYSTEM - WELDON V-MUX, MICRO PROCESSOR BASED SHOP NOTE: A Weldon V-MUX 100% solid state microprocessor based multiplex system shall be installed to control the	1

REF. NO	PART NO	S	DESCRIPTION	QTY
			electrical functions: (1) color control console (Vista) in the cab / (1) color control console (Vista) in the patient compartment / (3) control nodes: (2) High Content nodes and one (1) 8 X 16 node / cab warning display	
STD 2014/15 M-TECH	30-06-0010		VISTA IV MCC - PUSH BUTTON	1
STD 2014/15 M-TECH	30-06-0015		VISTA IV ACP - PUSH BUTTON	1
STD 2014/15 M-TECH	30-06-0026		WARNING DISPLAY - MULTIPLEX ELECTRICAL SYSTEM	1
STD 2014/15 M-TECH	30-06-0050		DAYTIME RUNNING LAMPS - MULTIPLEX ELECTRICAL SYSTEM	1
STD 2014/15 M-TECH	30-06-0076		MASTER CONTROL CONSOLE (MCC) - MULTIPLEX ELECTRICAL SYSTEM	1
STD 2014/15 M-TECH	30-06-0101		ATTENDANT CONTROL PANEL (ACP) - MULTIPLEX ELECTRICAL SYSTEM	1
STD 2014/15 M-TECH	30-06-0126		ELECTRICAL COMPARTMENT (PDQ) - MULTIPLEX ELECTRICAL SYSTEM	1
STD 2014/15 M-TECH	30-06-0150		SPARE CIRCUIT - MULTIPLEX ELECTRICAL SYSTEM	1
STD 2014/15 M-TECH	30-06-0175		WIRING HARNESS CONNECTORS - MULTIPLEX ELECTRICAL SYSTEM	1
STD 2014/15 M-TECH	30-06-0200		RADIO TIE-IN POINTS - MULTIPLEX ELECTRICAL SYSTEM	1
STD 2014/15 M-TECH	30-06-0225		EMERGENCY MASTER SWITCH - MULTIPLEX ELECTRICAL SYSTEM	1
STD 2014/15 M-TECH	30-06-0250		CONTROL PANEL SWITCHES - MULTIPLEX ELECTRICAL SYSTEM	1
STD 2014/15 M-TECH	30-06-0275		MODULE POWER SWITCH - MULTIPLEX ELECTRICAL SYSTEM	1
STD 2014/15 M-TECH	30-06-0285		MODULE DISCONNECT - MULTIPLEX ELECTRICAL SYSTEM	1
STD 2014/15 M-TECH	30-06-0300		VOLTMETER - MULTIPLEX ELECTRICAL SYSTEM	1
STD 2014/15 M-TECH	30-06-0325		FLASHER - MULTIPLEX ELECTRICAL SYSTEM	1
STD 2014/15 M-TECH	30-06-0350		FLASHING HEADLIGHTS - MULTIPLEX ELECTRICAL SYSTEM	1
STD 2014/15 M-TECH	30-06-0375		PARK OVERRIDE - MULTIPLEX ELECTRICAL SYSTEM	1
STD 2014/15 M-TECH	30-06-0400		LOAD MANAGER-SEQUENTIAL SWITCHING SYSTEM - MULTIPLEX ELECTRIC SYSTEM	1
STD 2016-20XX M-TECH	30-06-0410		WARNING LIGHTS FLASH PATTERN SIGNAL ALERT 75 - MULTIPLEX ELECTRICAL SYSTEM	1
			SHOP NOTE: The default flash pattern for the vehicle warning lights shall be Signal Alert 75.	
STD 2014/15 M-TECH	30-06-0450		FRONT CLEAR DISABLE SWITCH - MULTIPLEX ELECTRICAL SYSTEM	1
STD 2014/15 M-TECH	30-06-0475		CURBSIDE SCENE LIGHTS "ON" WITH CURBSIDE DOOR - MULTIPLEX ELECTRICAL SYSTEM	1
STD 2014/15 M-TECH	30-06-0500		REAR SCENE LIGHTS "ON" WITH REAR DOORS OPEN - MULTIPLEX ELECTRICAL SYSTEM	1
STD 2014/15 M-TECH	30-06-0525		DISABLE SWITCH FOR REAR SCENE LIGHTS - MULTIPLEX ELECTRICAL SYSTEM	1
STD 2014/15 M-TECH	30-06-0550		DISABLE SWITCH FOR SIDE SCENE LIGHTS - MULTIPLEX ELECTRICAL SYSTEM	1
STD 2014/15 M-TECH	30-06-0575		REVERSE (TRANSMISSION) FUNCTIONS - MULTIPLEX ELECTRICAL SYSTEM	1
STD	30-10-0030		BACKUP ALARM	1
STD	30-10-0050		BATTERY CONVERTER / CHARGER	1
			CHANGES: Print on Shop	
STD 2013 CHXL/SCHF	30-10-0071		CAMERA REAR VIEW - SINGLE SYSTEM - VISTA SCREEN	1
			SHOP NOTE: Install camera system rear view, tied to M-Tech display screen. Per Dwg #2	
STD	30-10-0110		ELECTRICAL CIRCUITS	1
STD 2014/15	30-10-0190		GROUND FAULT CIRCUIT INTERRUPTER (GFCI)	1
2018-XX BDD I	30-10-0248		INVERTER - PREWIRE	1
			SHOP NOTE: vehicle shall be pre-wired to accommodate a Vanner 20-1000TUL2 1000 watt inverter /wiring from the power distribution quarters (PDQ), terminate in top of OSS # 2/ include a 150 AMP fuse to be shipped loose.	
STD 2015 CXL/SCHF	30-10-0291 20		LIGHT, ATTENDANT CONTROL PANEL AREA - LED - WARM WHITE	1
			SHOP NOTE: A Tecniq Silho-X 2.75" round warm white LED light with SS trim ring, shall be mounted above the left wall forward action area counter. The light shall be operated through the a button on the ACP Vista screen labeled "Attendant Light". (Braun #26415)	
STD CHXL/SCHF/FRE/PAT	30-10-0310		LIGHT, ELECTRICAL COMPARTMENT (PDQ)	1
			SHOP NOTE: A 12 VDC light shall be located in the PDQ. The light shall be wired "battery-hot" to activate when the PDQ door	

REF. NO	PART NO	S	DESCRIPTION	QTY
			is in the open position. The light shall be off when the door is in the closed position.	
STD 2018-XX CHXL BDD	30-10-0424	S	LIGHT, OSS COMPARTMENTS - LED STRIP RIDGEBACK CHANGES: Description, Price, Special SHOP NOTE: Each outside storage compartment equipped with LED strip lighting / located one each side of the door opening /activated by a magnetic switch / all 5 OSS door openings /not include the battery compartment	1
STD CHXL BDD	30-10-0507	S	LIGHTS, INTERIOR CABINETS, RIDGEBACK BLUE LED STRIP CHANGES: Description, Price, Special, Shop Note, Note SHOP NOTE: All polycarbonate door, interior cabinets shall have a Ridgeback blue LED strip light across inside top of cabinet opening. This excludes all I/O cabinets. NOTE: Changed to state polycarbonate doors and added note to exclude I/O cabinets. Changed to Ridgeback brand IPO E410 model.	1
STD 2018-XX BDD	30-10-0530		OUTLETS, 125VAC - THREE (3) INTERIOR DUPLEX STREETSIDE BACK PANEL CHANGES: Quantity SHOP NOTE: Two (2) outlet located in forward action area per dwg #5 One (1) outlet located in rear action area per dwg #5	1
OPT 2015 BDD	30-10-0531		OUTLET, 125VAC - ONE (1) INTERIOR DUPLEX CHANGES: Quantity, Print on Shop SHOP NOTE: One (1) on the curbside wall above the cabinet at the head of the squad bench. Per dwg #5	1
OPT 2015 BDD	30-10-0545		OUTLET, 12VDC - ONE (1) INTERIOR POWERPOINT CHANGES: Quantity SHOP NOTE: One (1) on the curbside wall above the cabinet at the head of the squad bench.	1
STD 2018-XX BDD	30-10-0547		OUTLET, 12VDC - TWO (2) INTERIOR POWERPOINT STREETSIDE BACK PANEL CHANGES: Quantity, Print on Shop SHOP NOTE: One (1) outlet located on left wall main action area One (1) outlet located on left wall secondary action area	1
STD/IATS 2018-XX BDD	30-10-0551		OUTLETS, 125VAC - TWO (2) INTERIOR DUPLEX, LOWER FRONT WALL CABINETS CHANGES: Quantity, Print on Shop SHOP NOTE: (2), 2-wire +plus ground 125 VAC hospital-grade duplex outlets in the two (2) cabinets on lower front wall: (1) outlet located inside upper of the cabinets in upper left hand corner/ (1) outlet located inside lower of the cabinets in upper left hand corner / indicator lamp located within each 125 VAC outlet/outlets labeled, "125 VAC".	1

REF. NO	PART NO	S	DESCRIPTION	QTY
STD/IATS 2018-XX BDD	30-10-0552		OUTLETS, 12VDC - TWO (2) INTERIOR POWERPOINT, CABINETS LOWER FRONT WALL CHANGES: Quantity, Print on Shop SHOP NOTE: Two (2) 12 VDC power point outlets shall be installed in the two (2) cabinets on lower front wall: (1) outlet inside the upper of the cabinets in upper left hand corner. (1) outlet in the lower of the cabinets in upper left hand corner/ outlets labeled, "12 VDC" / a Schottky diode medical isolator provided.	1
OPT 2018XX BDDIII	30-10-0572		USB - DUAL OUTLET CHANGES: Quantity SHOP NOTE: (1) dual USB 5 volt 2.1 amp panel mount outlet (dual ports) installed in the street side lower interior wall near the attendant's seat over main action area.	1
OPT 2018XX BDDIII	30-10-0573		USB - DUAL OUTLET, CURBSIDE, ANGLED PANEL ABOVE COUNTERTOP CHANGES: Quantity SHOP NOTE: (1) dual USB 5 volt 2.1 amp panel mount outlet (dual ports) installed in the curbside interior wall on angled panel above countertop.	1
STD TYPE III	30-10-0655		RADIO ANTENNA BASES - TWO (2) CHANGES: Print on Shop SHOP NOTE: Two (2) antenna bases with attached coax cables shall be installed on the module roof. The coax cables shall terminate in the cab behind the driver's seat. Access to the antenna bases shall be through adjacent module interior dome lights.	1
STD -BDD	30-10-0723 20		RECEPTACLE SHORELINE INLET-SUPER 20 AMP, AUTO EJECT SHOP NOTE: Install a Kussmaul 20 AMP super auto eject shoreline inlet receptacle with yellow cover on the module exterior (forward street side) near the driver's door.	1
STD	30-10-0753		SIREN, WHELEN 295-HFSA7-REMOTE WITH MICROPHONE SHOP NOTE: A Whelen 295-HFSA7 remote dual siren amplifier shall be flush-mounted in the master control console located in the cab. The siren shall be capable of hands-free operation and shall be equipped with a noise canceling microphone.	1
STD 2017-XX F450	30-10-0812		SIREN SPEAKERS, CAST PRODUCTS - IN FRONT BUMPER SHOP NOTE: Two (2) Cast Products - 100-watt siren speakers, shall be installed in outer ends of the front bumper.	1
STD WITH V-MUX OPT C287 - 8 LED DOMES	30-10-0901 30-11-0104	S	SYSTEM ACTIVE AND CHECK OUT LIGHTS - 5 MINUTES LIGHTS, DOME LED (8) Whelen CHANGES: Part Upgraded, Price, Special SHOP NOTE: Eight (8) Whelen #LED (80C0EHCR) dome lights, shall be installed IPOS. See dwg #9	1 1
STD 2015	30-11-0152		LIGHTS, TECNIQ LED PANEL (3) STREETSIDE - ANGLED SHOP NOTE: Three (3) Tecniq (E30-L010-1) 21 LED lights streetside (Braun #27469). See Dwg #5	1

REF. NO	PART NO	S	DESCRIPTION	QTY
STD 2018-XX BDD	30-11-0156		LIGHTS, DELETE LIGHTS ON PANEL CURBSIDE ANGLED CHANGES: Print on Shop SHOP NOTE: The lights on panel,curbside angled, shall be not be installed if raised cabinets #1 & #2 streetside are present.	1
SECTION HEADING			EXTERIOR LIGHTING	1
STD CHXL BDD	30-25-0021		WARNING LIGHTS - CONSTANT POWER SHOP NOTE: The warning lights shall be set to steady burn out of the nodes, this will allow the lights to be programmed at the light head. (Does not include the Grille Lights)	1
STD SS - TECNIQ	30-25-0122		LIGHTS, ICC / LED CLEARANCE - ON MODULE FRONT - TECNIQ SHOP NOTE: The vehicle shall have five (5) amber Tecniq LED (S33-AA00-1) clearance / ICC lights on the front of the module near the roof line. Per Dwg #1	1
STD SS - TECNIQ	30-25-0123		LIGHTS, ICC / LED CLEARANCE - ON MODULE REAR - TECNIQ SHOP NOTE: The vehicle shall have five (5) red TECNIQ LED (S33-RR00-1)clearance / ICC lights on the rear of the module near the roof line. Per Dwg #2	1
OPT D012 - ALL	30-25-0201		LIGHTS, RUNNING BOARD - WHELEN MINI - LED (1) EACH SIDE SHOP NOTE: Light, Running Board - (Whelen) mini LED, one (1) white cluster on each side, IATS. Lights to operate with the cab door switches.	1
OPT E-F CHASSIS	30-25-3112		LIGHTS, FRONT GRILLE - (4) WHELEN 500 SUPER LED - RED W/CLR LENS SHOP NOTE: Install two (2) additional Whelen 500 red LED lights w/clear lens, making a total of four (4) installed. All with clear lens IPOS Lights to flash in an X pattern.	1
STD 2014/15 CHXL/SCHF	30-25-4201		LIGHTS, FRONT MODULE - WHELEN (7)900 - (6)RED, (1) CLEAR LED W/CLEAR LENS SHOP NOTE: Seven (7) Whelen 900 series super LED lights with chrome flanges shall be installed on the module front. There shall be six (6) red and one (1) center clear light. All lights to have clear lens IPOS	1
STD CHXL BDD	30-25-4504		PRE-WIRE LIGHTS, FRONT MODULE TURN SIGNAL SHOP NOTE: Pre-wire shall be provided on the module front behind the panel on each side for future installation of turn signal lights. Per dwg #1	1
STD BDD 2018-XX	30-25-4905		PRE-WIRE/PROGRAMMING, OPTICOM EMITTER SHOP NOTE: pre-wire in the power distribution quarters and programming in the cab Vista control panel shall be provided for a purchaser supplied/installed Opticom Emitter System / terminate behind streetside front panel. NOTE:	1
OPT D642 IPOS LED	30-26-3008		LIGHTS, REAR TAIL - WHELEN 600 LED STOP, TURN, & MINIMUM INTENSITY BACK-UP CHANGES: Part Upgraded	1

REF. NO	PART NO	S	DESCRIPTION	QTY
			SHOP NOTE: One (1) pair each of Whelen 600 series LED stop/tail lights, turn lights, and LED minimum intensity back-up lights with chrome bezels shall be installed on the rear of the module. (meets SAE)	
STD 2014/15 CHXL/SCF/S	30-26-5101		LIGHTS, REAR WINDOW-LEVEL - WHELEN (2)900 LED - RED W/CLR LENS SHOP NOTE: Two (2) Whelen 900 series red super LED lights w/clear lenses and chrome flanges shall be installed on the rear of the module at window level, one (1) on each side. Per dwg #2	1
			NOTE:	
STD 2018 BDD III	30-26-6105	S	LIGHTS, REAR MODULE -WHELEN (2)900 RED, (1)900 AMB LED, (2)900 LED SCN CLR LEN CHANGES: Description, Price, Special, Shop Note	1
			SHOP NOTE: (2) Whelen 900 series red super LED lights w/clear lens / (2) Whelen 900 series 24-Diode LED scene/load lights / (1) Whelen 900 series amber super LED light w/clear lens installed on the rear of the module w/chrome flanges. See dwg #2	
STD 2009	30-26-7002		LIGHT, LICENSE PLATE LED CHANGES: Print on Shop	1
STD - TECNIQ	30-27-1102		LIGHTS, ICC / LED CLEARANCE - ON MODULE SIDE - TECNIQ SHOP NOTE: The vehicle shall have two (2) Tecniq (S330) red mini LED marker lights : one (1) red on each side at the rear of the vehicle which will also flash with turn signal. Per Dwg #3 and #4	1
STD 2014/15 15D	30-27-1114	^	LIGHTS, INTERSECTION FRONT - WHELEN 700 SUPER LED - RED W/CLR LENS SHOP NOTE: Two (2) Whelen 700 series red super LED warning lights, with clear lens and water-proof connectors shall be mounted, in 15 degree tilt housings on the front chassis fenders, one (1) on each side.	1
			NOTE: NOTE: When vehicle is placed in park, the override switch must be on for intersection light(s) to remain on.	
OPT IPOS	30-27-2008 10	S	LIGHTS, SIDE MODULE SCENE - WHELEN 900 24 DIODE LED - CLEAR CHANGES: Part Upgraded, Price, Special	1
			SHOP NOTE: Four (4) Whelen 900 series 24 diode LED scene lights with chrome flanges shall be installed, two (2) each module side, inboard of the warning lights. IPOS - Per Dwg #3 and #4	
STD 2014/15	30-27-3009		LIGHTS, SIDE MODULE WARNING - WHELEN 900 SUPER LED - RED W/CLR LENS SHOP NOTE: Four (4) Whelen 900 series red super LED warning lights with clear lenses and chrome flanges shall be installed, two (2) each module side, outboard of the side module scene lights. Per dwg #3 & #4	1
STD 2014/15 CHXL SCHF	30-27-4115		LIGHTS, INTERSECTION REAR - WHELEN 700 SUPER LED - RED W/CLR LENS SHOP NOTE: Two (2) Whelen 700 series red super LED warning lights with clear lenses, chrome flanges and water-proof connectors, shall be installed above the rear wheel wells, one (1) on each side Per Dwg #3 & #4	1

REF. NO	PART NO	S	DESCRIPTION	QTY
			NOTE: NOTE: When vehicle is placed in park, the override switch must be on for intersection light(s) to remain on.	
OPT D011 - ALL	30-27-4151		LIGHTS, ABOVE RUB RAIL - TECNIQ LED - 4 EACH SIDE SHOP NOTE: Light Package - TecNiq-LED lights shall be installed above the rub rail. Four (4) LED's each side, two (2) white LED's and two (2) red LED's equally spaced along the module side, for a total of eight (8) lights. (Red-White-Red White on each side)The LED mini clusters shall alternate flash with box warning lights.	1
SECTION HEADING			MODULE BODY CONSTRUCTION AND CONNECTIONS	1
STD SOLIDBODY	39-00-0001		MODULE BODY CONSTRUCTION - SEAMLESS	1
STD ALL	39-00-0005		AWS ALUMINUM CERTIFIED WELDERS	1
STD TYPE I (12)	39-10-0003		CONNECTIONS, MODULE	1
SECTION HEADING			MODULE FEATURES / EXTERIOR	1
STD 2014	40-00-0009		ALUMINUM PARTS - MODULE EXTERIOR	1
STD	40-00-0010		CORROSION MINIMIZATION - MODULE	1
STD	40-00-0019		DOOR SKINS, OUTSIDE STORAGE COMPARTMENTS - DIAMOND PLATE INTERIOR SKINS CHANGES: Print on Shop	1
			SHOP NOTE: The interior door skins for all outside storage compartments shall be constructed of .063" thick aluminum diamond plate.	
STD	40-00-0020		DOOR CONSTRUCTION - GASKET PLACEMENT	1
STD	40-00-0030		EXTERIOR COMPARTMENTS DESIGN	1
STD	40-00-0050		EXTERIOR COMPARTMENTS, VENTING	1
STD	40-00-0055		EXTERIOR COMPARTMENTS, VENTING - OXYGEN STORAGE	1
STD	40-00-0060		EXTERIOR COMPARTMENTS - SWEEP-OUT	1
STD	40-00-0070		HANDLES, EBERHARD - CHROME FREE FLOATING TYPE	1
STD	40-00-0080		INSULATION - POLYURETHANE SPRAY FOAM	1
STD TYPE I	40-00-0091		THRESHOLD, STAINLESS STEEL - EXTERIOR STORAGE COMPARTMENT	1
OPT 2014/15 B070 -	40-10-0030		DOCK BUMPERS, REAR SHOP NOTE: Install rear dock bumpers.	1
STD 2014/15	40-10-0066		DOOR SLIDING - MODULE CURBSIDE PASSAGE	1
STD 2015	40-10-0072		LOWERED MODULE SIDES	1
STD 2014/15	40-10-0088		DOORS - REAR PASSAGE	1
STD 2014/15	40-10-0103		FENDERETTES - POLISHED ALUMINUM	1
STD 2014/15	40-10-0120	10	HOLD-OPEN - REAR DOORS - GRABBERS SHOP NOTE: Door grabbers (1 pair) with hard rubber inserts shall be installed on the rear doors. Reference dwg #2 for location.	1
STD 2017-XX UNLOCK	40-10-0151		SWITCH UNLOCK, WATERPROOF - HIDDEN IN FRONT GRILLE AREA SHOP NOTE: An exterior hidden door unlock switch shall also be included and located in the front grille area.	1
STD 2014/15 SS 5 OSS	40-10-0189		LOCKS POWER - PASSAGE, COMPARTMENTS, KEY FOBS SHOP NOTE: Install power door locks on module passage doors, and (5) OSS compartments use OEM key fobs.	1

REF. NO	PART NO	S	DESCRIPTION	QTY
STD 2015	40-10-0204		MUD FLAPS, REAR - BLACK RUBBER FIBERGLASS REINFORCED - THREE COLOR	1
STD 2014/15 STAR PUNCH	40-10-0266		REAR STEP/BUMPER -FLIP-UP CENTER SECTION - STAR PUNCHED AND ANODIZED	1
STD 2014	40-10-0280		RUB RAILS, ANODIZED ALUMINUM	1
			SHOP NOTE: Bright dip anodized polished aluminum rub rails shall be installed on the lower sides of the body below the outside compartment sill areas. The rub rails shall be offset 3/16" from the body to facilitate wash down of road debris.	
STD 2014/15	40-10-0320		STEPWELL, CURBSIDE DOORWAY	1
STD 2014/15	40-10-0340		STONE GUARDS, MODULE FRONT - ANODIZED DIAMOND PLATE (24" H)	1
STD 2014/15	40-10-0360		KICKPLATE/THRESHOLD, REAR DOORWAY - ANODIZED DIAMOND PLATE	1
			SHOP NOTE: A bright dip anodized aluminum diamond plate kick plate shall be installed at the rear exterior doorway, providing a kick / scuff plate at the rear of the vehicle above the rear step, per dwg. # 2.	
STD 2014/15 CHXL/LIB/P	40-10-0381		TOW HOOKS, MODULE REAR	1
STD	40-10-0505		WINDOWS, PASSAGE DOOR - (CURB SLIDING, REAR FIXED)	1
			CHANGES: Print on Shop	
OPT 2018-XX BDD I	41-01-0117	S	OUTSIDE STORAGE #1-O2 CYL. STORAGE WITH E-Z O2 LIFT	1
			CHANGES: Part Upgraded, Price, Special, Shop Note	
			SHOP NOTE: Oxygen Location - Locate cylinder in OSS #1. An E-Z O2 tank lift shall be installed on the door. This includes all necessary compartment changes and hardware, (heavier hinge, reinforced door w/tapping plates, wear plate, relocated shock mount bracket, door skin w/pre-punched drill pattern and instruction plate). Install one (1) adjustable shelf above the oxygen storage. Shelf is to be installed using exposed shelf track. Per dwg. #3.	
STD 2018-XX BDDI	42-01-0204		OUTSIDE STORAGE #2 - STREETSIDE CENTER	1
			SHOP NOTE: #2 (street side center compartment) shall have a 44.25" high x 39.50" wide clear door opening with double doors and shall have 47.75" high x 45.50" wide x 20.75" deep interior dimensions. The compartment shall contain one (1) adjustable shelf. The double doors shall be held open with spring loaded gas cylinders. An exterior handle shall be installed on each door. A locking handle shall be installed on the forward door.	
STD 2015	42-02-0054		SHELF TRACK - EXPOSED - OSS #2	1
			SHOP NOTE: Install exposed shelf track in OSS #2 (Exposed tracks will be welded in place and coated with Gatorhyde material for a cleaner look and no exposed fasteners)	
STD 2015	42-02-0107		SHELF ONE (1) IN OSS #2	1
			SHOP NOTE: Install one (1) adjustable shelf in OSS #2.	
STD 2018-XX BDDI	43-01-0206		OUTSIDE STORAGE #3 - STREETSIDE REAR - TALL DOOR	1
			SHOP NOTE: #3 (street side rear compartment) shall have a 63.50" high x 28.75" wide clear door opening with 65.25" high x 32.50" wide x 20.75" deep interior dimensions. This compartment shall have inside/outside access and contain one (1) adjustable shelf. The compartment door shall be held open with a spring loaded gas cylinder. A locking handle shall be installed on the exterior of the door.	
STD 2015	43-02-0051		SHELF TRACK - EXPOSED - OSS #3	1
			SHOP NOTE:	

REF. NO	PART NO	S	DESCRIPTION	QTY
			Install exposed shelf track in OSS #3. (Exposed tracks will be welded in place and coated with Gatorhyde material for a cleaner look and no exposed fasteners)	
STD 2015	43-02-0108		SHELF ONE (1) IN OSS #3 SHOP NOTE: Install one (1) adjustable shelf in OSS #3.	1
STD 2017-XX CHXL BDD	44-01-0119		OUTSIDE STORAGE #4A BOARD/SCOOP, #4B W/INSIDE/OUTSIDE ACCESS SHOP NOTE: #4 (rear curbside compartment) shall have split compartments (#4A / #4B): compartment #4A: provide storage for backboards and a scoop stretcher. Compartment #4B: (2) adjustable shelves and shall have inside / outside access / door with a spring loaded gas cylinder / locking handle exterior of the door.	1
OPT 2015	44-02-0054		SHELF TRACK - EXPOSED - OSS #4 SHOP NOTE: Install exposed shelf track in OSS #4 (Exposed tracks will be welded in place and coated with Gatorhyde material for a cleaner look and no exposed fasteners)	1
OPT 2015 EXPOSED	44-02-0107		SHELVES TWO (2) IN OSS #4 SHOP NOTE: Install two (2) adjustable shelves in OSS #4.	1
STD 2015 CHXL I	45-01-0203		OUTSIDE STORAGE #5 - CURBSIDE FORWARD CHANGES: Print on Shop	1
SECTION HEADING			MODULE INTERIOR / PATIENT COMPARTMENT FEATURES	1
STD 2014/15 CH/SCH/	50-00-0202		ROUNDED INTERIOR CORNERS	1
OPT 2014/15 8 LOOPS L	50-01-0300 10		INVENTORY CONTROL SYSTEM SHOP NOTE: Install mini footman loops on the sliding door cabinet frames, and drill holes in the cabinet door handles for the inventory control system	1
2018-XX LATCHES	50-01-0408		LATCHES, CABINET, CN10 COMPLIANT AS APPLICABLE SHOP NOTE: Install latches per drawings.	1
STD 2018-XX BDD I	50-10-0347	S	CABINET - LEFT WALL, LOWER REAR #3 - INSIDE/OUTSIDE CHANGES: Special, Shop Note, Note SHOP NOTE: The left wall, lower rear interior cabinet (#3)w/ inside/outside access; hinged polycarbonate doors with full length handles and center squeeze latches. NOTE: Updated doors to state polycarbonate IPOS aluminum with polycarbonate inserts.	1
STD CHXL III & BDD	50-10-0602		PRIMARY ACTION AREA	1
STD 2014/15	50-10-0705		DRAWER - SLIDE-OUT / WRITING TABLE STREETSIDE INTERIOR	1

REF. NO	PART NO	S	DESCRIPTION	QTY
OPT 2018-XX CHXL BDD	50-11-0016		<p>LEFT WALL CABINET BACK PANEL / CPR SEAT - OPTION #2 CHANGES: Part Upgraded</p> <p>SHOP NOTE: The left wall back panel: (1) 125VAC / (1) 12VDC over Second Action Area. (2) oxygen outlets and bypass valve, radio fader, suction control,(1) 12VDC, (2) 125VAC , (1) dual USB port over Main Action Area.</p>	1
OPT 2018-XX BDD	50-11-0304		<p>CABINET - LEFT WALL, UPPER REAR OVER SECONDARY ACTION AREA OPT # 1 CHANGES: Part Upgraded</p> <p>SHOP NOTE: Section #2, Option # 1 Cabinet includes one (1) adjustable shelf each side of the center divider with sliding polycarbonate cabinet doors with lift up restocking door frame</p>	1
OPT 2018-XX BDD I	50-11-0407	S	<p>CABINET - LEFT WALL, UPPER OVER PRIMARY ACTION AREA OPTION #2 CHANGES: Part Upgraded, Description, Special, Note</p> <p>SHOP NOTE: The left wall forward, upper interior area over the primary action area shall contain two (2) cabinets above the attendant control panel.</p> <p>NOTE: Changed header state option #2 instead of #3. Per std demo drawings, only 2 options available.</p>	1
OPT 2015 BDD	50-11-0502		<p>LEFT WALL - ATTENDANT CONTROL PANEL - HINGED PANEL - SECTION #5 - OPTION #2 CHANGES: Quantity</p> <p>SHOP NOTE: The Vista shall be installed on an angled panel located to the immediate right of the attendant's seat.</p>	1
OPT 2018-XX BDD I	50-11-0608		<p>DRAWERS - LEFT WALL - REAR ACTION AREA (2) DRAWER UNIT BDD SECTION #4 OPTION #1 CHANGES: Part Upgraded</p> <p>SHOP NOTE: Section #4, Option #1 - Two (2) drawers open towards aisle</p>	1
OPT 2018-XX BDD I	50-20-0503		<p>PASS THROUGH - CAB TO MODULE, WINDOW OPENING W/ DRAWER & CABINET OPT 2 CHANGES: Part Upgraded</p> <p>SHOP NOTE: A pull - out drawer and cabinet shall be located below the window opening in the pass-through. The cabinet shall be enclosed with hinged polycarbonate doors with center squeeze latches.</p>	1
STD 2018-XX BDD	50-30-0106	S	<p>ACCESS COMPARTMENT - RIGHT WALL, REAR WITH (1) DOOR, INSIDE/OUTSIDE CHANGES: Special, Shop Note</p> <p>SHOP NOTE: Compartment (#1) to the rear of squad bench: hinged poly carbonate with center squeeze latch with inside/outside access to OSS #4.</p>	1

REF. NO	PART NO	S	DESCRIPTION	QTY
STD 2018-XX BDD I	50-31-0016		<p>CABINETS - RIGHT WALL, UPPER #2 - #3</p> <p>SHOP NOTE: Cabinets #2 / #3: (2) cabinets: curbside above the squad bench /each with top hinged polycarbonate door with center squeeze latches/ minimum of 43" of headroom below the cabinets.</p>	1
2018-XX BDD	50-31-0301		<p>CABINET - RIGHT WALL, SQUAD BENCH, FORWARD (3) DRAWER - SECTION #1, OPTION #3</p> <p>CHANGES: Quantity</p> <p>SHOP NOTE: A cabinet shall be installed at the forward end of the squad bench: two (2) equal size drawers /open towards the aisle / secured with locking stainless steel flush pull latches. The lower portion of the cabinet shall contain a sharps/waste pull-out drawer: open towards the aisle /secured with a stainless steel flush pull latch. Solid acrylic counter top installed on the top of the cabinet /same color as counter tops within the module.</p>	1
OPT 2018-XX BDD I	50-41-0023	S	<p>CABINET - FRONT WALL, LOWER BDD SECTION #1 OPTION #3</p> <p>CHANGES: Part Upgraded, Price, Special, Shop Note</p> <p>SHOP NOTE: The lower front wall shall have two (2) separate cabinets and one (1) pull out drawer. Upper cabinet: inside/outside access/ (1) adjustable shelf on Unistrut adjustable track brackets/ aluminum beveled ramp edging installed on two edges of the shelf/ (1) 12VDC and one (1) 125VAC outlet inside cabinet in upper left hand corner/ enclosed by one (1) pair of hinged polycarbonate doors and center squeeze latches.</p> <p>A pull-out drawer shall be located between the two (2) cabinets: constructed of .090" thick aluminum / (1) locking stainless steel flush pull latch.</p> <p>The lower of the cabinets: inside/outside access / (1) adjustable shelf on Unistrut adjustable track brackets/ aluminum beveled ramp edging installed on two edges of the shelf/ (1) 12VDC and (1) 125VAC outlet inside cabinet in upper left hand corner/ enclosed by (1) pair of hinged polycarbonate doors and center squeeze latches.</p>	1
STD 2015 CHXL/LIB	50-41-0203		<p>HEAT/AIR CONDITIONING, PROAIR 4X4 AC/HEAT CORE</p> <p>CHANGES: Quantity</p> <p>SHOP NOTE: Install ProAir IW-3856 with 4x4 AC/Heat Core in the upper front wall.</p>	1
OPT 2018-XX BDD I	50-41-0208	S	<p>CABINET - FRONT WALL, UPPER, SECTION #2 - OPTION #3</p> <p>CHANGES: Part Upgraded, Special, Shop Note, Note</p> <p>SHOP NOTE: The front wall, upper interior cabinet located to the right of the Heat / AC system: enclosed by (1) lift-up aluminum door a polycarbonate insert, hold-open and center squeeze latch / (1) adjustable shelf.</p> <p>NOTE: Corrected to state aluminum door with polycarbonate insert per option available.</p>	1
STD 2016 -20XX	50-41-0210		<p>** NO CONDENSER - HOSELINE TMC 2007, MODULE FRONT MOUNT **</p> <p>CHANGES: Quantity, Print on Shop</p>	1
OPT 2015 BDD	50-41-0302		<p>ELECTRICAL COMPARTMENT (PDQ) - MULTIPLEX ELECTRICAL SYSTEM</p> <p>CHANGES: Quantity</p>	1

REF. NO	PART NO	S	DESCRIPTION	QTY
OPT 2018-XX BDD I	50-41-0318		<p>CABINET - FRONT WALL, LOWER BELOW PDQ - HINGED O2 TIP-OUT DOOR - SEC #3 OPT #4 CHANGES: Part Upgraded, Quantity</p> <p>SHOP NOTE: The compartment below the power distribution cabinet (PDQ): (1) bottom hinged, tip-out cabinet / storage / storage bracket on the door to accommodate two (2) "D" oxygen cylinders/ cylinders provided by the customer. PDQ and lower cabinet with chrome locking lever latches.</p>	1
OPT 2018-XX BDD CN8	50-50-0020	S	<p>SEATING - SQUAD BENCH BASE W/ STORAGE CN8 COMPLIANT BDD OPT #3 CHANGES: Part Upgraded, Special, Shop Note, Note</p> <p>SHOP NOTE: A squad bench seat with one (1) individual seating position and one (1) VALOR A-VAL shelf mount back frame with internal bolsters will be installed on the curb side of the patient compartment, per dwg. #6. (1) seat belt shall consist of a (4) point / (2) retractors single click internal mount belt system. The VALOR A-VAL shelf mount back frame and the bench shall be padded and covered with cushioned, color coordinated, cut and sewn vinyl. A storage area in the squad bench base under the lift up cushion. The squad bench base constructed of .090" thick aluminum/ interior of the squad bench sprayed with sound absorbing polyurethane material. A forward cabinet with (2) upper pull out drawers at the head end of the bench. Each drawer pull out towards the aisle. (1) sharps / waste drawer below below the upper drawers / drawers with locking stainless steel flush pull latches.</p> <p>NOTE: Updated to state 2 retractors instead of 4 per std.</p>	1
OPT 2018-XX BDD CN8	50-50-0040	S	<p>SEATING - SQUAD BENCH, ONE (1) SEAT POSITION W/ VALOR SEAT BACK CHANGES: Quantity, Special, Shop Note, Note, Print on Shop</p> <p>SHOP NOTE: One (1) individual seating position with one (1) VALOR A-VAL shelf mount back frame with internal bolsters will be installed on the squad bench on the curb side of the patient compartment: (1) seat belt / (4) point / (2) retractors single click internal mount belt system. Reference dwg for seat location on bench.</p> <p>NOTE: updated to state 2 instead of 4 retractors</p>	1
2018-XX STD CN8	50-50-0118		<p>ATTN SEAT - USSC VALOR R - BACK INTEGRAL CHILD, SWIVEL SEAT CN8 COMPLIANT SHOP NOTE: A USSC Valor rear facing, R-back attendant seat with an integrated child seat installed at the head of the patient cot: a (2) position swivel seat mounted on a pedestal base with a heavy duty seat frame / ABTS (All Belts To Seat) application with (4) point / (4) retractors single click internal mount belt system. The seat shall be padded and covered with sewn matching antimicrobial vinyl upholstery.</p>	1
STD 2018-20XX	50-50-0318	S	<p>CPR SEAT FIXED, VALOR A-VAL BACK, CN8 COMPLIANT CHANGES: Quantity, Special, Shop Note, Note, Print on Shop</p> <p>SHOP NOTE: A CPR seat shall be installed on the street side of the patient compartment aft of the main action area counter with VALOR A-VAL shelf mount back frame and internal bolsters with (4) point / (2) retractors single click internal mount belt system / padded and covered with cushioned, color coordinated, cut and sewn vinyl.</p>	1

REF. NO	PART NO	S	DESCRIPTION	QTY
			NOTE: Changed to 2 retractors instead of 4 per std.	
STD STD ALUM CABINETS	50-51-1001 50-51-1011		CABINET CONSTRUCTION - INTERIOR - ALUMINUM RECESSED ADJUSTABLE SHELF TRACK - CABINETS SHOP NOTE: Install recessed adjustable shelf track in cabinets.	1 1
STD 2014/15	50-51-2001	S	CABINET DOORS - POLYCARBONATE CHANGES: Description, Special, Shop Note SHOP NOTE: Clear Polycarbonate	1
STD LB/CH/SC/P	50-51-3001		CABINETS/ WALLS - POLYCHROMATIC COATING - MARBLE STONE SHOP NOTE: Headliner, walls, cabinet faces, and cabinet interiors MultiSpec color to be #99-7371 Marble Stone	1
STD 2015 CHXL/SCHF	50-51-4011	S	COUNTER TOP - SOLID ACRYLIC - NIGHT STARS (BLACK) CHANGES: Description, Special, Shop Note SHOP NOTE: A Wilson Art solid acrylic counter top, Night Stars.	1
STD 2018-XX	50-51-5001		UPHOLSTERY - PATRIOT PLUS CHARCOAL #8605 SHOP NOTE: All cushions, head pads and seating surfaces shall be covered with Patriot Plus Charcoal #8605 expanded vinyl upholstery material.	1
STD CHXL/BDD/SCF	50-51-6003		LONPLATE II, NON-SLIP EMBOSSED SM. GRID - GUNMETAL #424 SHOP NOTE: The floor in the patient compartment shall be covered with Lonseal brand "Lonplate II" non-slip; small grid (embossed) Gunmetal #424,	1
COT MOUNT FASTENERS STD 2017-XX BDD CN8			COT MOUNT FASTENERS COT MOUNT / FASTENER FEATURES **CN8 COMPLIANT** STD CHANGES: Print on Shop	1 1
SECTION HEADING STD 2018-XX BDD			MISC PATIENT COMPARTMENT FEATURES ASPIRATOR / SUCTION - SSCOR - WITH ELECTRIC PUMP - RECESSED CHANGES: Quantity SHOP NOTE: A SSCOR suction system shall be recessed into the street side lower interior wall near the attendant's seat . The 12 VDC SSCOR electric vacuum pump to be installed in the standard OSS compartment (must use SSCOR pump and tubing)	1 1
STD 2018-XX BDD CHXL	50-60-0032	S	ASSIST HANDLES, (2) 'V' ANTI-MICROBIAL (YELLOW), (4) BLACK U CHANGES: Price, Special SHOP NOTE: A total (6) assist handles: (2) Yellow Anti-Microbial "V" assist handles, (1) on each rear passage door / (4) 10-7/8" black vulcanized rubber with steel core assist handles/ (2) handles at the rear doorway / (1) at the curbside doorway / (1) on the curbside sliding door.	1

REF. NO	PART NO	S	DESCRIPTION	QTY
STD 2018-XX BDDCHXLIII	50-60-0096	S	CLOCK - FRANKLIN DIGITAL - REAR HEAD PAD CHANGES: Price, Special SHOP NOTE: A Franklin digital clock in the head pad above the rear doors.	1
STD 2016 CHXL/BDD	50-60-0161 10	S	COT FASTENER -UNIVERSAL TAPPING PLATE CHANGES: Description, Price, Special, Shop Note SHOP NOTE: Install a universal tapping plate. Along with pre-wire for a Stryker Powerload Per dwg. #9. No other cot hardware will be installed until the unit has been sold.	1
STD	50-60-0220		EMBLEMS / SIGNS - REAR PATIENT COMPARTMENT	1
STD 2014/15	50-60-0256		EXHAUST VENTILATOR, 3-SPEED - MULTIPLEX ELECTRIC SYSTEM	1
STD	50-60-0300		FLOOR CONSTRUCTION- PATIENT COMPARTMENT, NON-WOOD COMPOSITE	1
STD	50-60-0301		FLOORING - COVE	1
STD CHXL/SCF/PAT	50-60-0322		GLOVE DISPENSER - (3) BOX - ABOVE ENTRY DOOR - CURBSIDE (ABS) CHANGES: Print on Shop SHOP NOTE: An ABS three (3) - box glove dispenser unit, with a clear plexi hinged access panel with three (3) cut-outs, shall be provided above the curbside entry door. (holder to accommodate three (3) 5.375" wide x 10.375" long x 3.25" deep glove boxes)	1
OPT 2014/15	50-60-0326		GLOVE DISPENSER - (3) BOX - STREETSIDE (ALUMINUM) SHOP NOTE: An aluminum three (3) - box glove dispenser unit, with a clear plexi hinged access panel with three (3) cut-outs, shall be provided inside the left rear door, below the street side rear interior cabinet. (NOTE- Shelf track in OSS #3 shall not extend below glove box) (holder to accommodate three (3) 5.375" wide x 10.375" long x 3.50" deep glove boxes)	1
STD 2018-XX BDD CHXL	50-60-0352		GRAB RAILS, 1-1/4" DIAMETER, ANTI-MICROBIAL(YELLOW) 96" AND 64" SHOP NOTE: (2) 1-1/4" diameter stainless steel, yellow Anti-microbial grab rails installed on the ceiling of the patient compartment: (1) 64" rail over the squad bench area / (1) 96" rail over the patient cot area. The 96" grab rail will be attached to the ceiling with (3) mounting brackets.	1
STD 1 PC ALUM WELDED	50-60-0391		HEADLINER - REAR PATIENT COMPARTMENT	1
STD 2017-XX BDD	50-60-0432		I V HANGERS - CEILING RECESSED - CAST PRODUCTS #IV2008-1 (3) CHANGES: Print on Shop SHOP NOTE: Three (3) Cast Products #IV2008-1 recessed, dual, ceiling I.V. hangers shall be provided and installed above cot area.	1
2018-XX BDD	50-60-0609		OXYGEN OUTLET (1) CEILING - OHIO MEDICAL TYPE SHOP NOTE: One (1) Ohio Medical flush mounted, quick release oxygen outlet installed in the ceiling above the foot of cot, left of the center mount position.	1
2018 -XX BDD	50-60-0624	S	OXYGEN OUTLETS (3) WALL - OHIO MEDICAL TYPE CHANGES: Description, Quantity, Special, Shop Note, Note, Print on QPA SHOP NOTE: Left wall above main after area: (2) Ohio Medical flush mounted, quick release wall outlets / (1) oxygen	1

REF. NO	PART NO	S	DESCRIPTION	QTY
			by-pass valve. (1) Ohio Medical flush mounted, quick release wall outlet located on the curbside, above the head end of the squad bench.	
			NOTE: Could not find anywhere in quote writer that called out the 3rd wall outlet that is on the curbside, so I added to option.	
STD	50-60-0629		FLOW METER, OXYGEN - THORPE STYLE SHOP NOTE: One (1) Thorpe style oxygen flow meter shall be shipped loose with the completed vehicle. (Braun #15920)	1
STD 2014/15	50-60-0640		OXYGEN SYSTEM, ELECTRIC - MULTIPLEX ELECTRIC SYSTEM CHANGES: Print on Shop	1
STD	50-60-0660		PADDED EDGING PROTECTION	1
STD	50-60-0661		PADS, HEAD AND BACK	1
STD 2018-XX BDD	50-60-0682	S	RADIO SPEAKERS, REAR HEAD PAD(OEM RADIO & ACP FADER CONTROL) CHANGES: Description, Quantity, Price, Special, Print on Shop SHOP NOTE: (1) radio fader control installed in the street side lower interior wall near the attendant's seat over main action area; (1) radio fader control also in the cab radio; (2) stereo speakers installed in the head pad over the rear doors.	1
2018-XX BDD	50-60-0712		SHARPS AND TRASH CONTAINERS WITH SLIDE-OUT DRAWER CHANGES: Quantity SHOP NOTE: A 3.3 qt. #BD5488 sharps container, and a 8 qt. trash container installed within a slide-out drawer, located below upper drawers in the forward end of the squad bench, open toward the aisle and be secured with a latch.	1
STD 2014/15	50-60-0730		DOOR PANELS - MODULE PASSAGE DOORS - FULL LENGTH ALUMINUM - W/ACCESS PANELS SHOP NOTE: Interior rear and curbside passage door panels to be full length aluminum, Multi-Spec sprayed to match interior color and contain removable latch access panel per dwg. # 6 & # 8. (Total 3).	1
STD 2014/15	50-60-0761		STAINLESS STEEL WALL PROTECTION - INTERIOR STREETSIDE	1
STD 2017-XX BDD	50-60-0763		STAINLESS STEEL PANEL, SQUAD BENCH BASE FACE CHANGES: Quantity, Print on Shop SHOP NOTE: Full-length brushed stainless steel panel on the face of the squad bench base, extend up to the bottom of the squad bench lid.	1
OPT 2017-XX BDD	50-60-0805		VISTA DISPLAY SCREEN - PUSH BUTTON - CURBSIDE ADDITIONAL - FIXED ANGLED CHANGES: Part Upgraded SHOP NOTE: One (1) additional Vista screen shall be provided in the patient compartment, located on the curbside wall on a fixed angled mount above counter at the head end of the squad bench. (Braun #830064)	1

REF. NO	PART NO	S	DESCRIPTION	QTY
STD 2014/15	50-60-0820		TURTLE TILE - SKID-RESISTANT MAT, CURBSIDE STEPWELL	1
SECTION HEADING			PAINT / GRAPHICS	1
STD	60-01-0001		PAINT PROCEDURE CHANGES: Print on Shop	1
STD	60-01-0002		PAINT MODULE - OEM WHITE SHOP NOTE: Paint module OEM white to match the chassis	1
STD	60-01-0003		CLEAR COATING - MODULE PAINT	1
STD	60-01-0004		BUFFING, PAINT - MODULE	1
STD 2016	60-01-0005		STANDARDS AND SPECIFICATIONS FOR VEHICLE PAINT APPEARANCE CHANGES: Print on Shop	1
STD	60-10-0108		CAB - OEM PAINT	1
STD	60-25-0101		BLACK REFLECTIVE MATERIAL IN RUB RAILS SHOP NOTE: Install black reflective material in rub rails.	1
STD S CHF, CHFXL, & RD	60-30-0200		DOOR REFLECTIVITY	1
STD	80-10-0101		KKK-A-1822F COMPLIANCE	1
STD			VEHICLE MANUALS	1
STD	80-20-0001		VEHICLE MANUALS (1) PACKAGE SET SHOP NOTE: One (1) Delivery Manual Package shall be supplied with the vehicle, and shall include the following items: Ambulance manufacturer parts, service and operation manuals OEM chassis owner's guide Complete 12 VDC and 125 VAC wiring schematics for all included standard and optional systems Multiplex Electrical system programming - electronic media	1
STD 2017 SOLIDBODY -	90-10-0005		WARRANTIES	1
	CO-02-0000	U	CHANGE ORDER #2 CHANGES: Quantity, Shop Note SHOP NOTE: Customer Change QW #30-10-0031 Delete the Fleet Connect.	1
	PC-CS-0001	U	Braun Approved Price CHANGES: Quantity	1
	SR-CS-0001	U	Sales Resolution CHANGES: Quantity	1

DIMENSIONS FOR OVERALL HEIGHT AND LENGTH ARE APPROXIMATE
 OVERALL HEIGHT = 112"
 OVERALL WIDTH WITH RUB
 RAILS & FENDERETTES = 98"

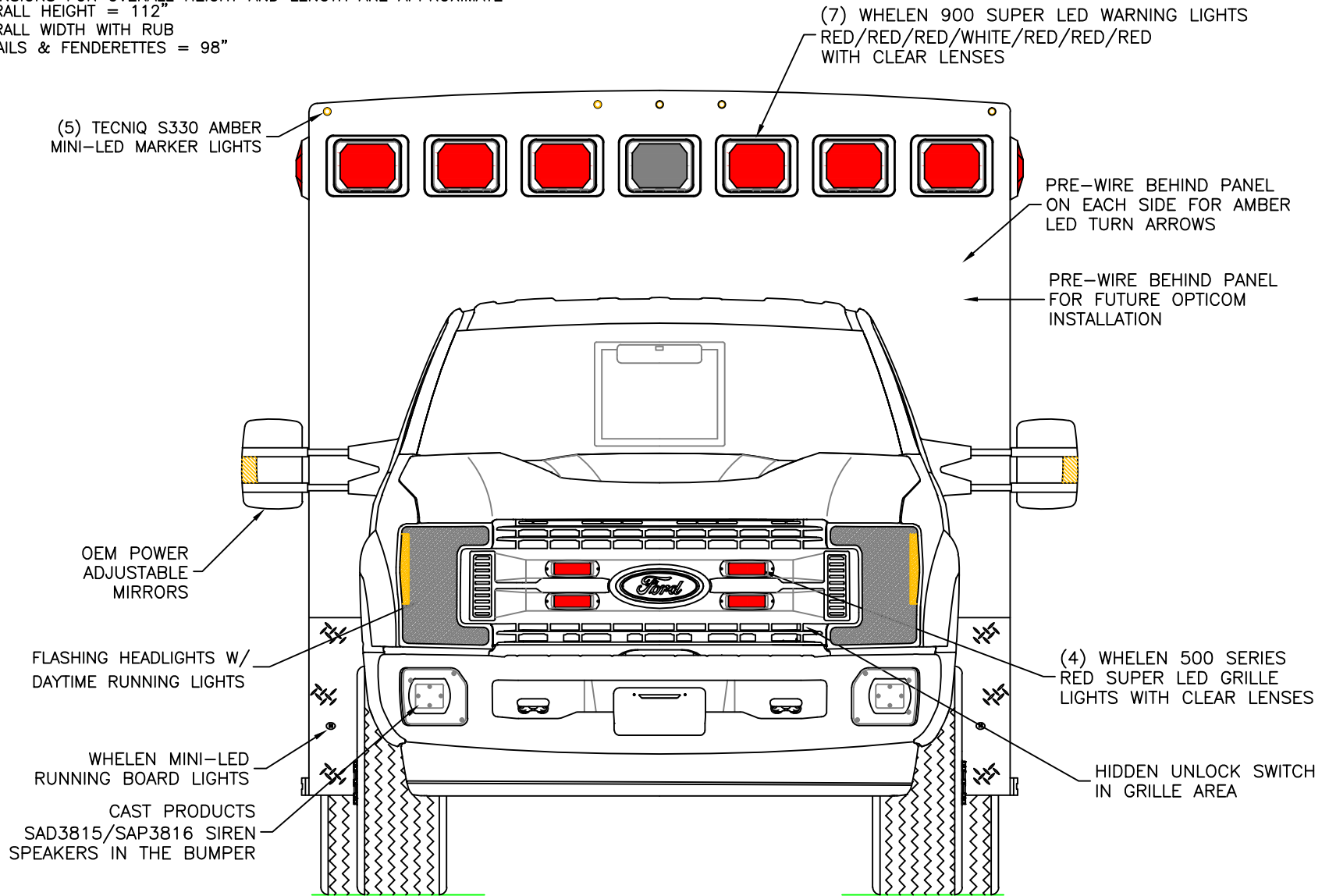

CUSTOMER APPROVAL: _____ DATE: _____

THIS DRAWING IS FOR REPRESENTATIONAL PURPOSES ONLY. DETAILS ARE CONCEPTUAL AND ARE SUBJECT TO CHANGE DURING DESIGN AND CONSTRUCTION
 DIMENSIONS ARE APPROXIMATE UNLESS NOTED OTHERWISE TO MEET A SPECIFIC CUSTOMER NEED.

CHIEF XL
 BRAUN DEMO



2018 FRONT EXTERIOR VIEW
 CHIEF XL-1/FORD F-450 CHASSIS

DATE: 8-17-17	DRAWING NO. 18XLF-DEMO-1
DWG. REV. AAB NR	
1:17	
DATE:	

APPROVAL SIGNATURE:

DIMENSIONS FOR OVERALL HEIGHT AND LENGTH ARE APPROXIMATE
 OVERALL HEIGHT = 112"
 OVERALL WIDTH WITH RUB
 RAILS & FENDERETTES = 98"

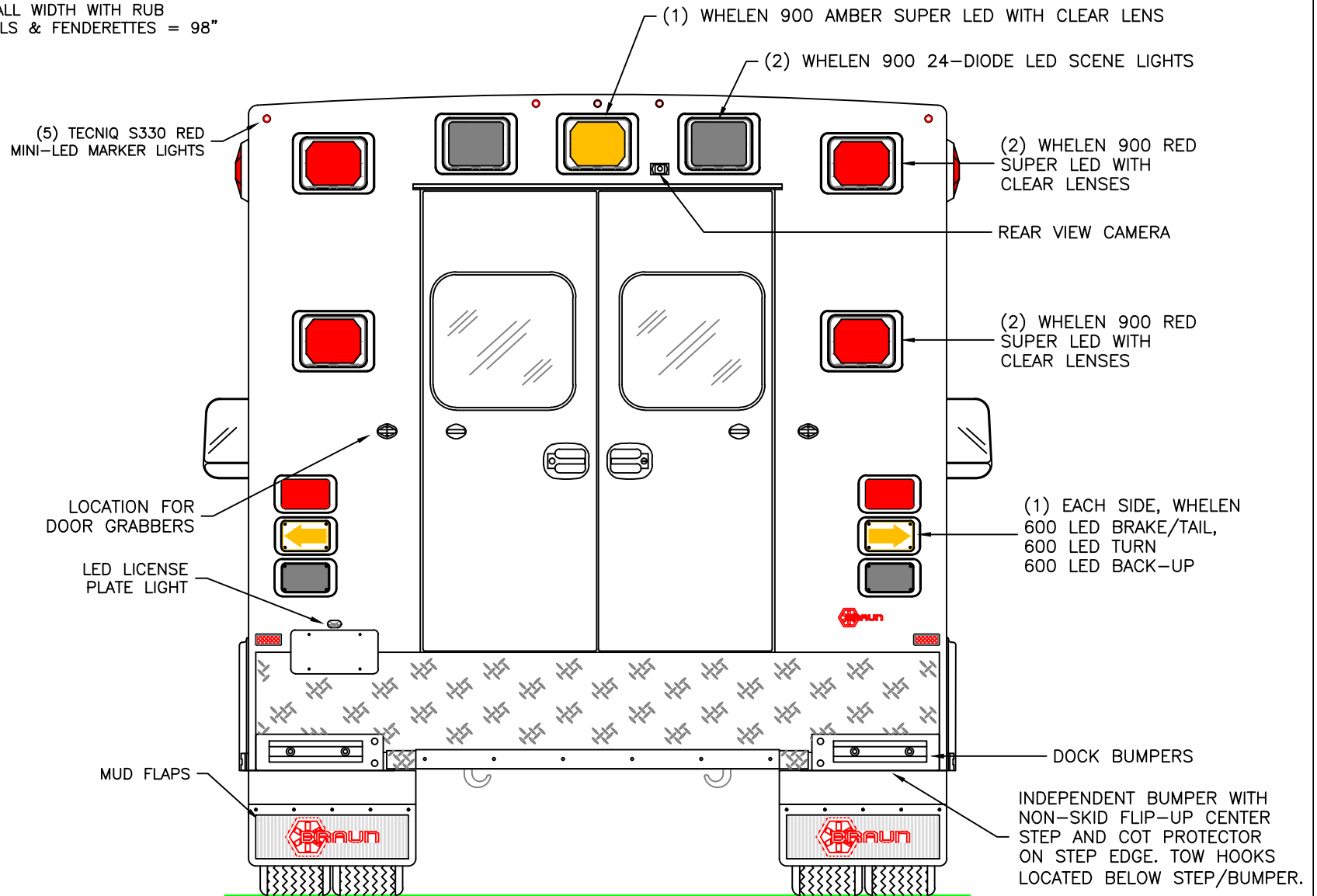

CUSTOMER APPROVAL: _____ DATE: _____

THIS DRAWING IS FOR REPRESENTATIONAL PURPOSES ONLY. DETAILS ARE CONCEPTUAL AND ARE SUBJECT TO CHANGE DURING DESIGN AND CONSTRUCTION
 DIMENSIONS ARE APPROXIMATE UNLESS NOTED OTHERWISE TO MEET A SPECIFIC CUSTOMER NEED.

CHIEF XL
 BRAUN DEMO



2018 REAR EXTERIOR VIEW
 CHIEF XL-I/FORD F-450 CHASSIS

1:16

DATE: 8-17-17	REV.
DWG. AAB	NR

DRAWING NO. 18XLF-DEMO-2

DIMENSIONS FOR OVERALL HEIGHT AND LENGTH ARE APPROXIMATE
 OVERALL HEIGHT = 112"
 OVERALL LENGTH = 307"
 MODULE LENGTH = 169"

TECNIQ S330 RED MINI-LED MARKER LIGHT TO ALSO FLASH WITH TURN SIGNAL

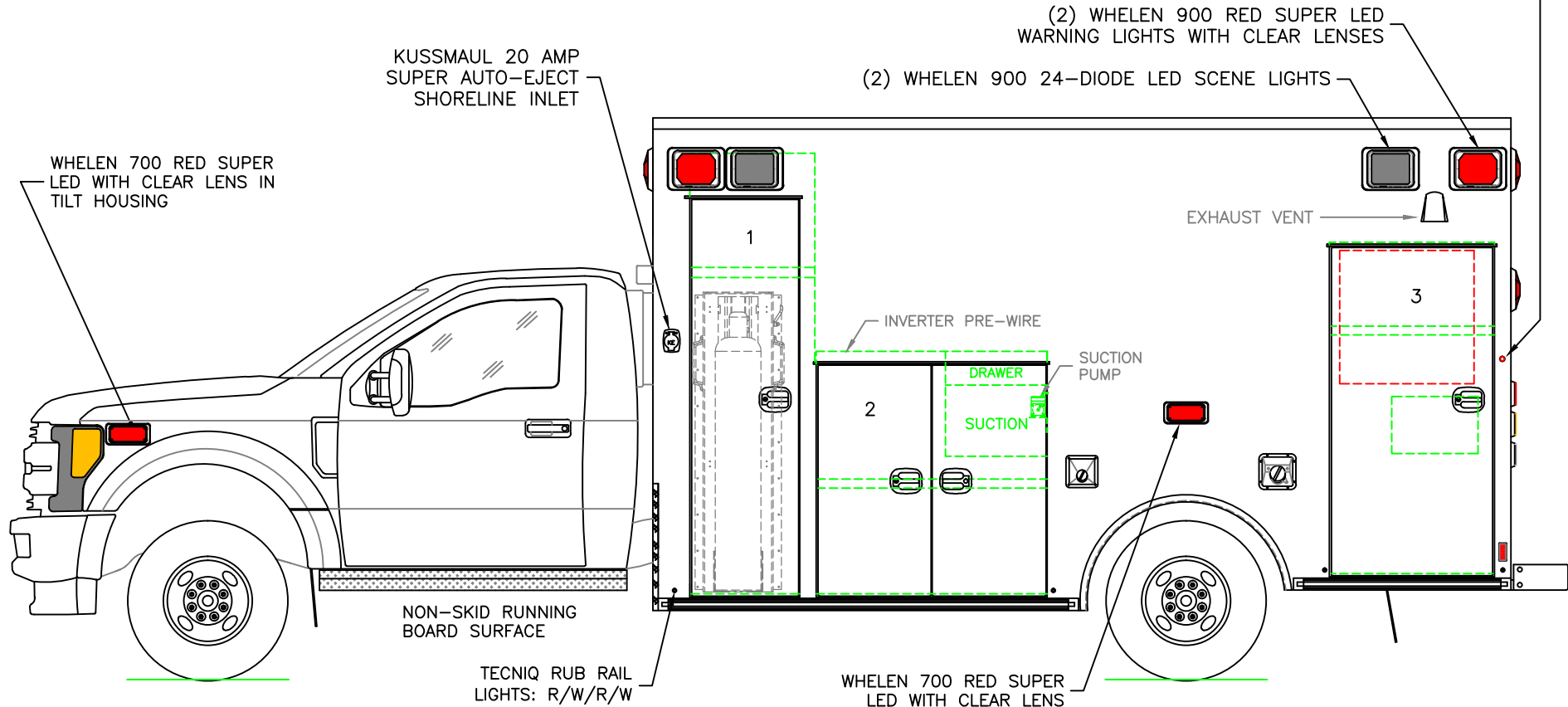

(2) WHELEN 900 RED SUPER LED WARNING LIGHTS WITH CLEAR LENSES
 (2) WHELEN 900 24-DIODE LED SCENE LIGHTS

COMPARTMENT
 O.S.S #1

CLEAR OPENING: 77.00h x 18.25w
 INSIDE DIM'S.: 86.75h x 24.50w x 20.75d
 "EZ-02 LIFT" OXYGEN SYSTEM ON THE DOOR
 (1) ADJUSTABLE SHELF ABOVE OXYGEN

O.S.S #2

CLEAR OPENING: 44.25h x 39.50w
 INSIDE DIM'S.: 47.75h x 45.50w x 20.75d
 (1) ADJUSTABLE SHELF

O.S.S #3

CLEAR OPENING: 63.50h x 28.75w
 INSIDE DIM'S.: 65.25h x 32.50w x 20.75d
 INSIDE/OUTSIDE ACCESS
 (1) ADJUSTABLE SHELF
 DOOR REINFORCED FOR POSSIBLE POCKET ON THE DOOR FOR STAIR CHAIR

CUSTOMER APPROVAL: _____ DATE: _____

THIS DRAWING IS FOR REPRESENTATIONAL PURPOSES ONLY. DETAILS ARE CONCEPTUAL AND ARE SUBJECT TO CHANGE DURING DESIGN AND CONSTRUCTION
 DIMENSIONS ARE APPROXIMATE UNLESS NOTED OTHERWISE TO MEET A SPECIFIC CUSTOMER NEED.

CHIEF XL
 BRAUN DEMO



2018 STREETSIDE EXTERIOR VIEW
 CHIEF XL-1/FORD F-450 CHASSIS

DATE:	10-8-18		DRAWING NO.
DWG.	AAB	REV.	NR
1:30			18XLF-DEMO-3

DIMENSIONS FOR OVERALL HEIGHT AND LENGTH ARE APPROXIMATE
 OVERALL HEIGHT = 112"
 OVERALL LENGTH = 307"
 MODULE LENGTH = 169"

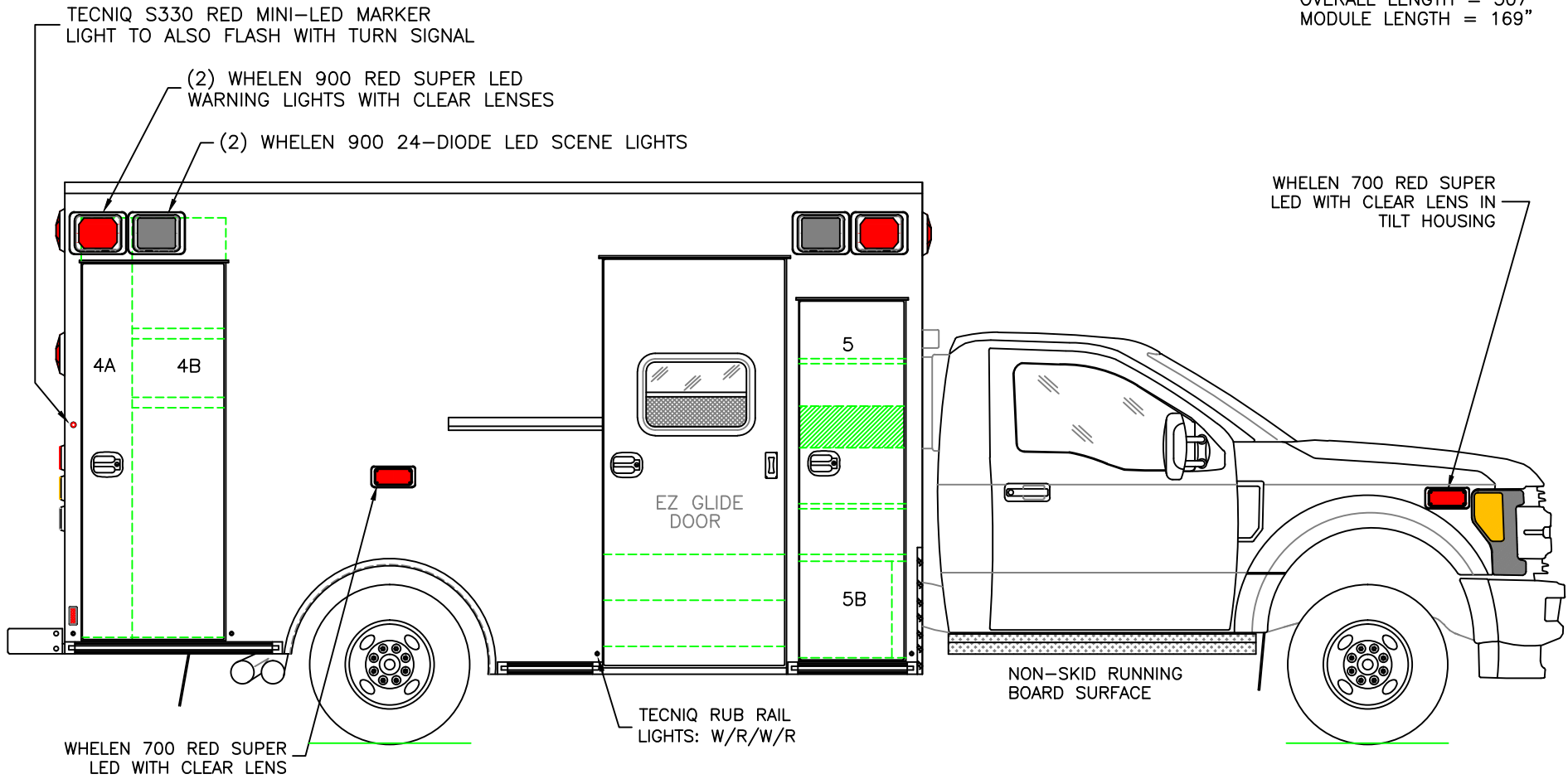

COMPARTMENT
 O.S.S #4
 CLEAR OPENING: 73.00h x 24.75w
 INSIDE DIM'S. 4A: 82.75h x 10.00w x 20.75d
 BACKBOARD/SCOOP STORAGE
 INSIDE DIM'S. 4B: 82.75h x 18.50w x 20.75d
 (2) ADJUSTABLE SHELVES WITH INSIDE/OUTSIDE ACCESS

O.S.S #5
 CLEAR OPENING: 69.50h x 17.50w
 INSIDE DIM'S. 5A: SEE PARTITION INTERIOR VIEW
 INSIDE/OUTSIDE STORAGE WITH (2) ADJUSTABLE SHELVES
 INSIDE DIM'S. 5B: 19.00h x 20.25w x 18.00d

CUSTOMER APPROVAL: _____ DATE: _____

THIS DRAWING IS FOR REPRESENTATIONAL PURPOSES ONLY. DETAILS ARE CONCEPTUAL AND ARE SUBJECT TO CHANGE DURING DESIGN AND CONSTRUCTION
 DIMENSIONS ARE APPROXIMATE UNLESS NOTED OTHERWISE TO MEET A SPECIFIC CUSTOMER NEED.

CHIEF XL
 BRAUN DEMO



2018 CURBSIDE EXTERIOR VIEW
 CHIEF XL-I/FORD F-450 CHASSIS

DATE: 10-8-18	DRAWING NO.	
DWG. AAB	REV. NR	18XLF-DEMO-4

1:30

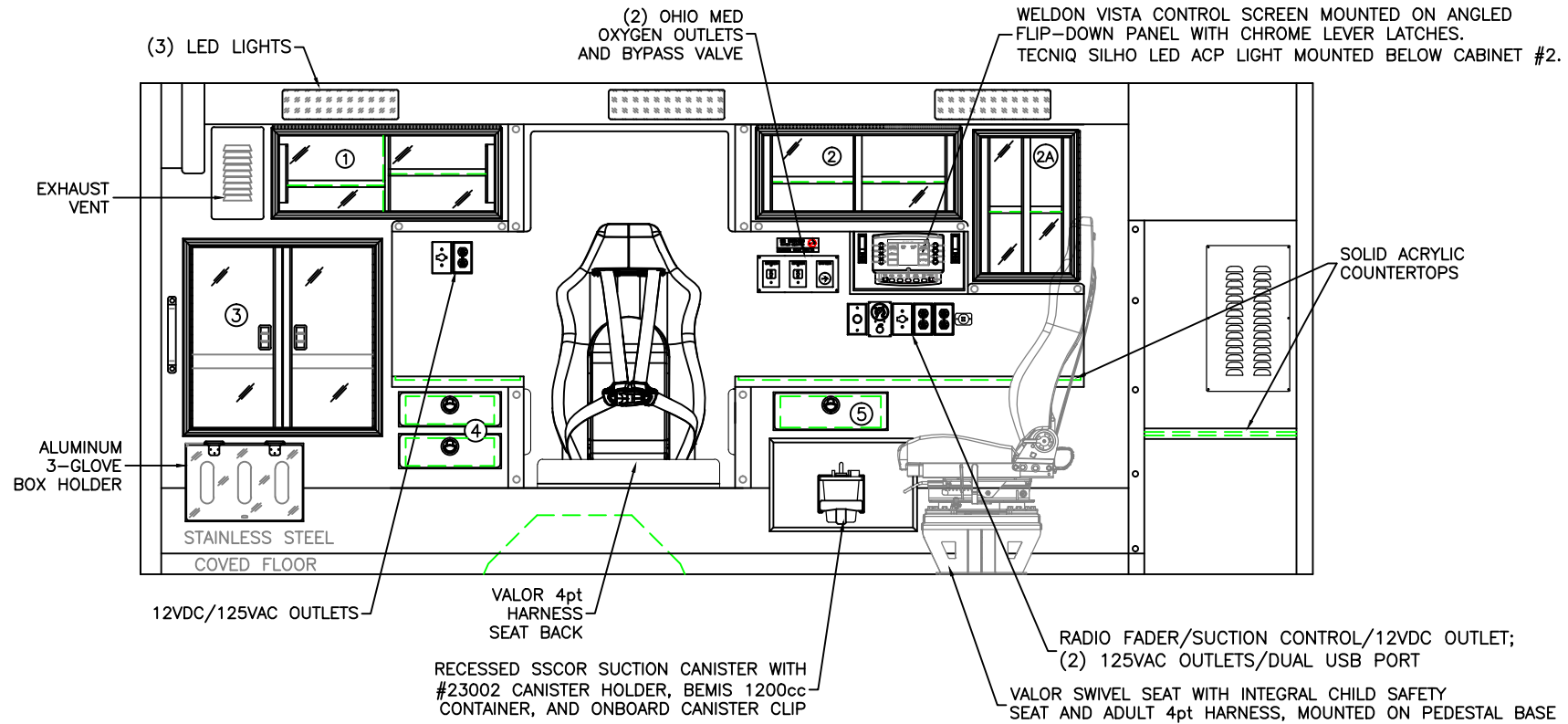

#1 DOOR OPENING: 10.75h x 31.00w
 INSIDE DIMS: 13.25h x 33.00w x 17.25d
 (1) ADJ SHELF EACH SIDE OF CENTER DIVIDER
 SLIDING POLYCARBONATE DOORS
 LIFT-UP RESTOCKING DOOR FRAME.
 TOTAL CABINET WEIGHT RATING = 25 lbs.

#2 DOOR OPENING: 10.75h x 27.25w
 INSIDE DIMS: 13.25h x 29.25w x 17.25d
 (1) ADJUSTABLE SHELF
 SLIDING POLYCARBONATE DOORS
 LIFT-UP RESTOCKING DOOR FRAME
 TOTAL CABINET WEIGHT RATING = 25 lbs.

#2A DOOR OPENING: 19.50h x 12.75w
 INSIDE DIMS: 21.50h x 15.25w x 17.25d
 (1) ADJUSTABLE SHELF
 SLIDING POLYCARBONATE DOORS
 RIGHT HINGE RESTOCKING DOOR FRAME
 TOTAL CABINET WEIGHT RATING = 20 lbs.

#3 DOOR OPENING: 26.50h x 26.75w
 INSIDE DIMS: O.S.S. #3
 HINGED POLYCARBONATE DOORS WITH FULL LENGTH HANDLES
 CENTER SQUEEZE LATCHES
 TOTAL CABINET WEIGHT RATING = 40 lbs.

#4 (2) PULL-OUT DRAWERS TOWARDS AISLE
 INSIDE DIMS: 4.50h x 12.75w x 12.75d
 LOCKING STAINLESS STEEL FLUSH PULL LATCHES.
 TOTAL DRAWER WEIGHT RATING = 10 lbs. EACH

#5 PULL-OUT DRAWER WITH HINGED ACRYLIC WRITING SURFACE
 INSIDE DIMS: 4.50h x 14.50w x 13.25d
 LOCKING STAINLESS STEEL FLUSH PULL LATCH
 TOTAL DRAWER WEIGHT RATING = 10 lbs.

INVENTORY CONTROL SYSTEM
 CABINETS TO BE ALUMINUM

CUSTOMER APPROVAL: _____ DATE: _____

THIS DRAWING IS FOR REPRESENTATIONAL PURPOSES ONLY. DETAILS ARE CONCEPTUAL AND ARE SUBJECT TO CHANGE DURING DESIGN AND CONSTRUCTION DIMENSIONS ARE APPROXIMATE UNLESS NOTED OTHERWISE TO MEET A SPECIFIC CUSTOMER NEED.

CHIEF XL
 BRAUN DEMO



2018 STREETSIDE INTERIOR VIEW
 CHIEF XL-1

1:22

DATE: 8-17-17	
DWG. AAB	REV. NR

DRAWING NO. 18XLF-DEMO-5

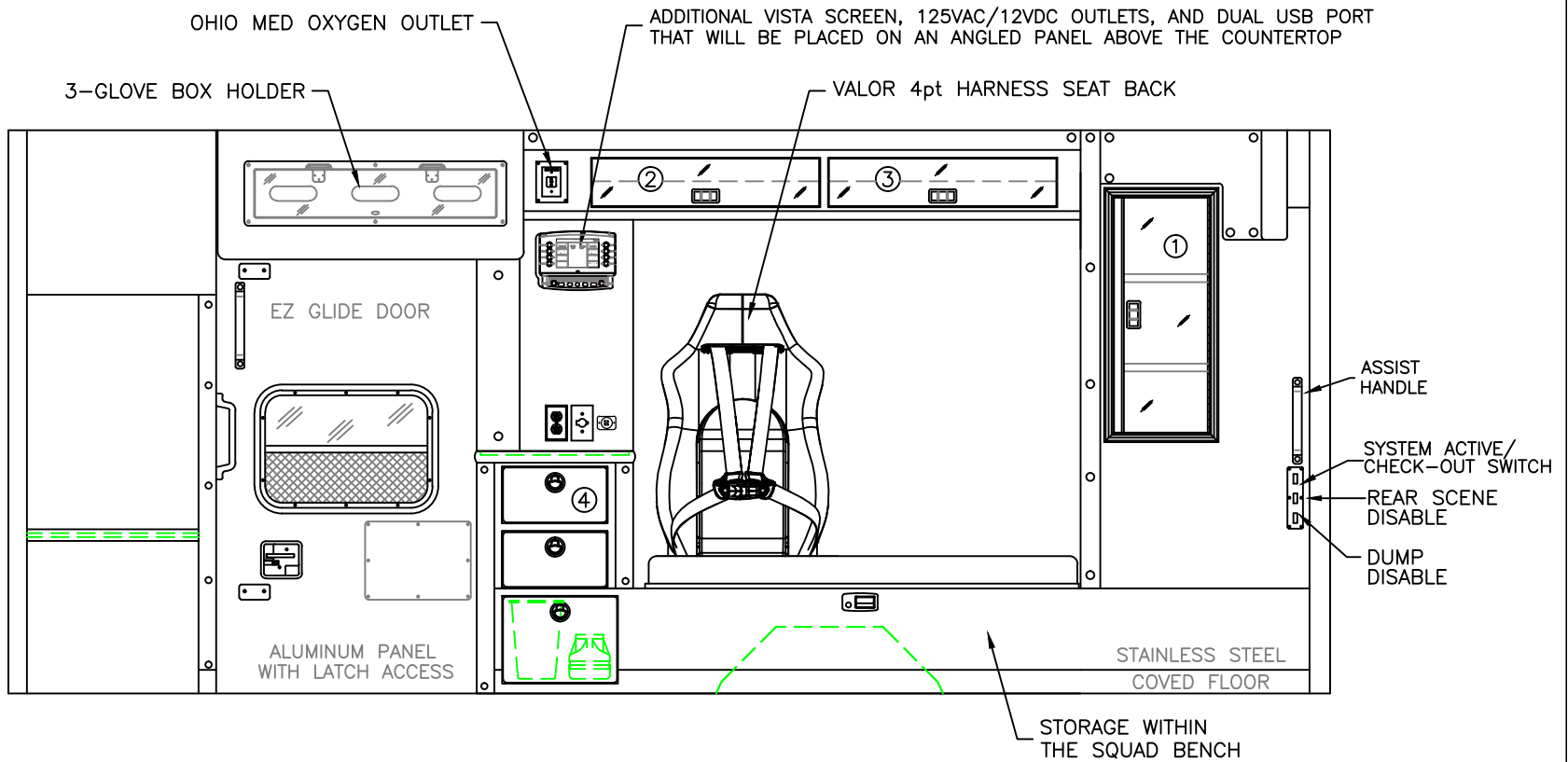

#1 DOOR OPENING: 30.00h x 12.25w
 INSIDE DIMS: OSS #4B
 HINGED POLYCARBONATE DOOR WITH FULL LENGTH HANDLE
 CENTER SQUEEZE LATCH
 INSIDE/OUTSIDE ACCESS
 TOTAL CABINET WEIGHT RATING = 15 lbs.

#2/#3 DOOR OPENING: 6.25h x 29.25w
 INSIDE DIMS: 6.25h x 29.25w x 10.25d
 HINGED POLYCARBONATE DOORS
 CENTER SQUEEZE LATCHES
 43" MINIMUM HEADROOM BELOW THE CABINET
 TOTAL CABINET WEIGHT RATING = 10 lbs. EACH

#4 CABINET WITH SOLID ACRYLIC COUNTERTOP
 (2) PULL-OUT DRAWERS TOWARDS AISLE.
 INSIDE DIMS: 6.25h x 11.50w x 12.75d
 SHARPS/WASTE DRAWER BELOW UPPER
 DRAWERS. ALL DRAWERS HAVE LOCKING
 STAINLESS STEEL FLUSH PULL LATCHES.
 TOTAL DRAWER WEIGHT RATING = 10 lbs. EACH

INVENTORY CONTROL SYSTEM
 CABINETS TO BE ALUMINUM

CUSTOMER APPROVAL: _____ DATE: _____

THIS DRAWING IS FOR REPRESENTATIONAL PURPOSES ONLY. DETAILS ARE CONCEPTUAL AND ARE SUBJECT TO CHANGE DURING DESIGN AND CONSTRUCTION
 DIMENSIONS ARE APPROXIMATE UNLESS NOTED OTHERWISE TO MEET A SPECIFIC CUSTOMER NEED.

CHIEF XL
 BRAUN DEMO



2018 CURBSIDE INTERIOR VIEW
 CHIEF XL-I

DATE: 8-17-17	DRAWING NO.
DWG. AAB	REV. NR
1:20	18XLF-DEMO-6

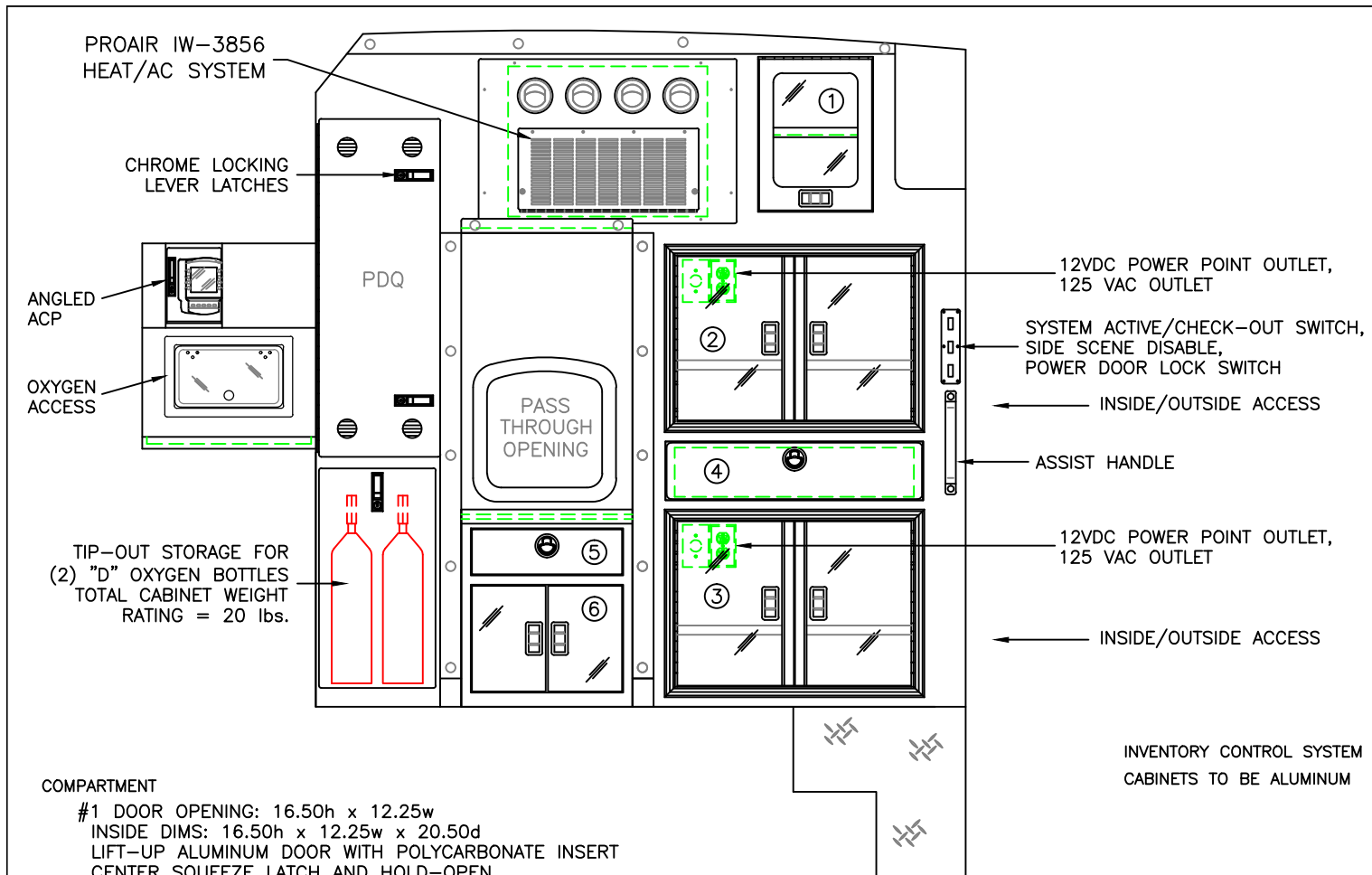

COMPARTMENT

#1 DOOR OPENING: 16.50h x 12.25w
 INSIDE DIMS: 16.50h x 12.25w x 20.50d
 LIFT-UP ALUMINUM DOOR WITH POLYCARBONATE INSERT
 CENTER SQUEEZE LATCH AND HOLD-OPEN
 (1) ADJUSTABLE SHELF
 TOTAL CABINET WEIGHT RATING = 20 lbs.

#2 & #3 DOOR OPENINGS: 17.75h x 25.25w
 INSIDE DIMS: 19.50h x 31.50w x 21.50d
 HINGED POLYCARBONATE DOORS WITH FULL LENGTH HANDLES
 CENTER SQUEEZE LATCHES
 (1) ADJUSTABLE SHELF PER CABINET.
 TOTAL CABINET WEIGHT RATING = 40 lbs. EACH

#4 PULL-OUT DRAWER
 INSIDE DIMS: 5.25h x 25.50w x 16.25d
 LOCKING STAINLESS STEEL FLUSH PULL LATCH
 TOTAL DRAWER WEIGHT RATING = 10 lbs.

#5 PULL-OUT DRAWER
 INSIDE DIMS: 4.00h x 14.25w x 16.00d
 LOCKING STAINLESS STEEL FLUSH PULL LATCH
 TOTAL DRAWER WEIGHT RATING = 10 lbs.

#6 CABINET OPENING DIMS: 11.50h x 16.25w
 INSIDE DIMS: 11.50h x 16.25w x 19.00d
 HINGED POLYCARBONATE DOORS
 CENTER SQUEEZE LATCHES
 TOTAL CABINET WEIGHT RATING = 20 lbs.

CUSTOMER APPROVAL: _____ DATE: _____

THIS DRAWING IS FOR REPRESENTATIONAL PURPOSES ONLY. DETAILS ARE CONCEPTUAL AND ARE SUBJECT TO CHANGE DURING DESIGN AND CONSTRUCTION
 DIMENSIONS ARE APPROXIMATE UNLESS NOTED OTHERWISE TO MEET A SPECIFIC CUSTOMER NEED.

CHIEF XL BRAUN DEMO		2018 PARTITION INTERIOR VIEW CHIEF XL-1	DATE:	DRAWING NO.
			8-17-17	18XLF-DEMO-7
			DWG.:	REV.:
			AAB	NR

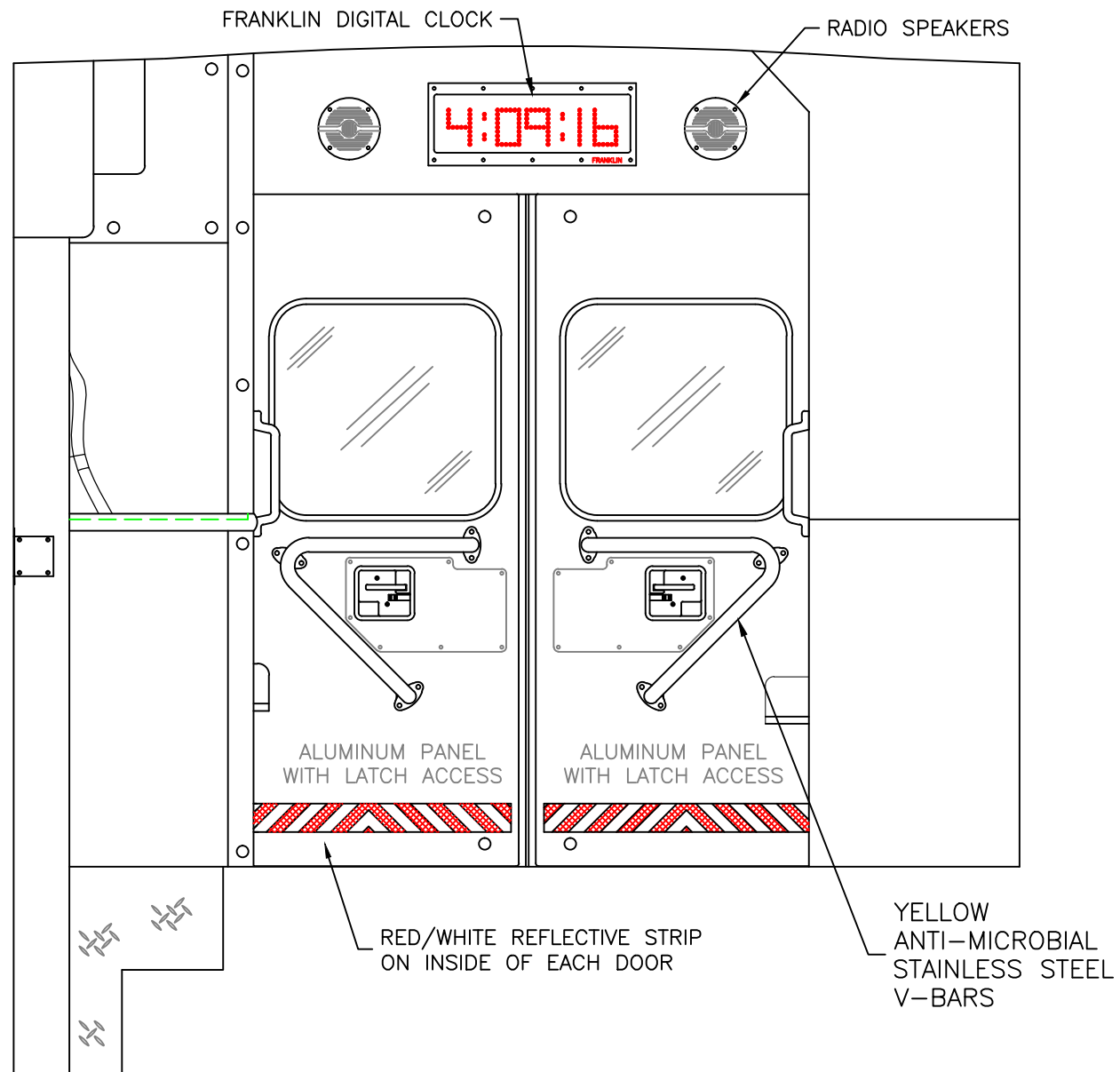

CUSTOMER APPROVAL: _____ DATE: _____

THIS DRAWING IS FOR REPRESENTATIONAL PURPOSES ONLY. DETAILS ARE CONCEPTUAL AND ARE SUBJECT TO CHANGE DURING DESIGN AND CONSTRUCTION DIMENSIONS ARE APPROXIMATE UNLESS NOTED OTHERWISE TO MEET A SPECIFIC CUSTOMER NEED.

CHIEF XL
BRAUN DEMO



2018 REAR INTERIOR VIEW
CHIEF XL-I

DATE:	8-17-17	DRAWING NO.	18XLF-DEMO-8
DWG.	AAB	REV.	

1:12

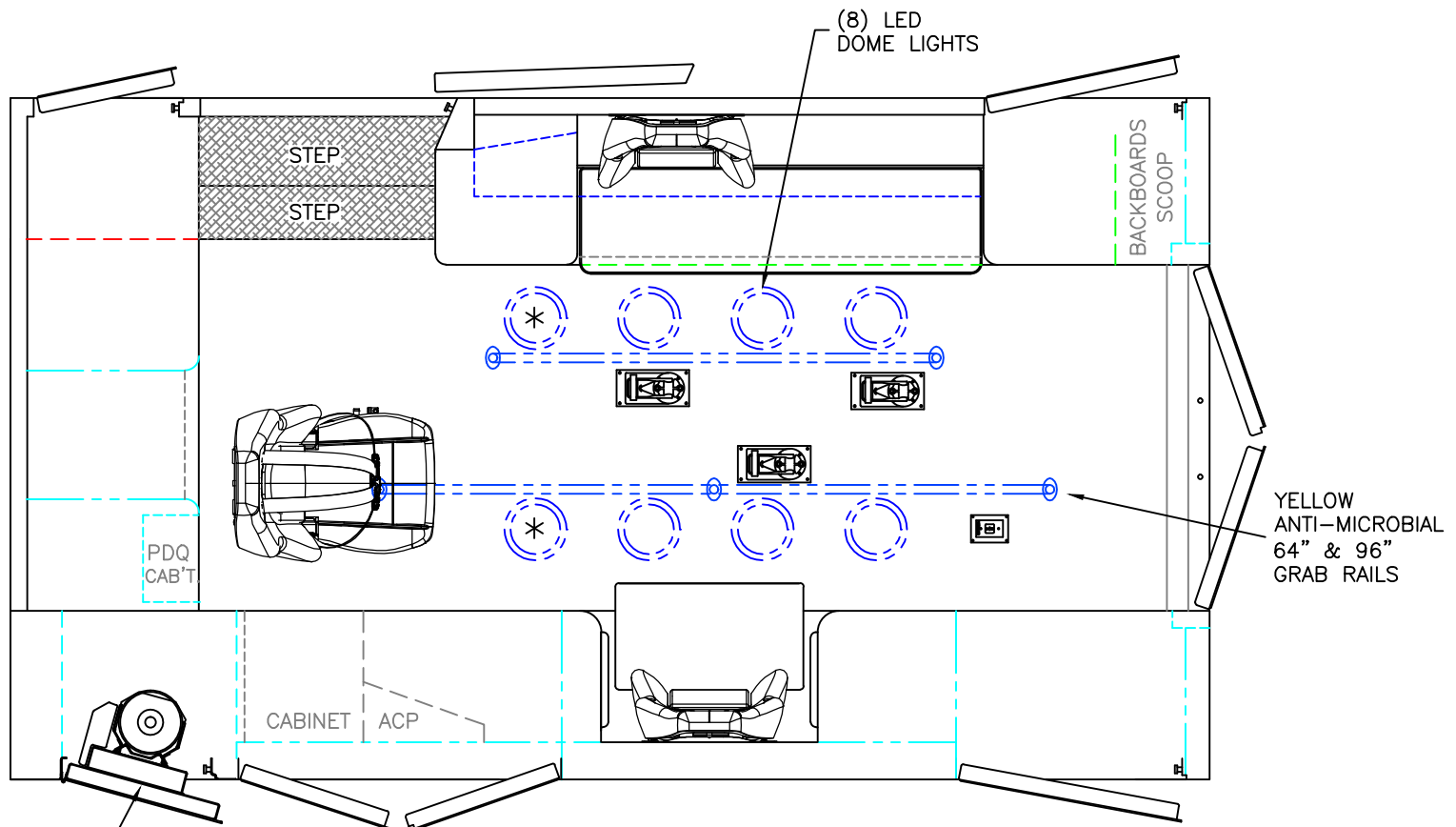

"EZ O2 LIFT"
OXYGEN SYSTEM



= (3) RECESSED CEILING IV HANGER LOCATIONS



= (1) CEILING OXYGEN OUTLET

* (2) ANTENNA BASES LOCATED OUTBOARD OF
DOME LIGHTS WITH COAX SERVICE LOOP

UNIVERSAL TAPPING PLATE AND PRE-WIRE FOR FUTURE POWERLOAD INSTALLATION

MODULE WIDTH = 96"
MODULE LENGTH = 169"
MODULE HEAD ROOM = 72"

CUSTOMER APPROVAL: _____ DATE: _____

THIS DRAWING IS FOR REPRESENTATIONAL PURPOSES ONLY. DETAILS ARE CONCEPTUAL AND ARE SUBJECT TO CHANGE DURING DESIGN AND CONSTRUCTION DIMENSIONS ARE APPROXIMATE UNLESS NOTED OTHERWISE TO MEET A SPECIFIC CUSTOMER NEED.

CHIEF XL
BRAUN DEMO



2018 FLOOR INTERIOR VIEW
CHIEF XL-I

1:22

DATE:	8-17-17
DWG.	AAB
REV.	NR

DRAWING NO.	18XLF-DEMO-9
-------------	--------------



BRAUN PERFORMANCE EXCELLENCE SYSTEM

Statement of Limited Warranty New Ambulances

Document No. and Level:	BPES-P-076-100 / Level II
Effective Date:	December 22, 2017
Revision No.:	C
Prepared By:	Kim Braun
Owner:	Kim Braun
Page:	1 of 2

SOLIDBODY™ MODEL WARRANTY

Subject to the provisions, limitations, and conditions set forth in this warranty, Braun Industries, Inc. (the "Manufacturer") warrants to each original purchaser that its ambulances are free of defects in material and workmanship and shall maintain such integrity under normal use and service. This warranty is valid only in the United States and Canada and all warranty periods start from the date of manufacture and expire per the disclosures listed below. The Manufacturer warrants to repair or replace at its sole discretion; components, installation, or workmanship deemed to be defective under the terms and conditions set forth in this warranty statement. Warranty repairs must be performed by the Manufacturer or by a Braun Authorized Dealer / Service Center.

EXCLUSIONS AND LIMITATIONS

NOTWITHSTANDING ANY OTHER PROVISION HEREOF TO THE CONTRARY, OTHER THAN THE EXPRESS WARRANTIES SET FORTH HEREIN, THE MANUFACTURER MAKES NO OTHER WARRANTY REGARDING THE AMBULANCES, PRODUCTS AND/OR SERVICES PROVIDED BY MANUFACTURER, EXPRESS OR IMPLIED, AND MANUFACTURER EXPRESSLY DISCLAIMS ANY AND ALL OTHER WARRANTIES, INCLUDING WITHOUT LIMITATION, ANY IMPLIED WARRANTY OF MERCHANTABILITY OR FITNESS FOR A PARTICULAR PURPOSE, OR THE WARRANTY IN SECTION 2-312 OF THE UCC THAT SUCH AMBULANCES AND/OR PRODUCTS DO NOT INFRINGE ON THE RIGHTS OF ANY OTHER PERSON. The purchaser's right to repair or replacement of defective parts or workmanship is the exclusive remedy, and neither the Manufacturer nor any Braun Authorized Dealer / Service Center shall be liable for damages, whether ordinary, incidental, or consequential under this warranty. Any remedy of consequential damages; including but not limited to economic loss, transportation, mileage, trip charges, wages, etc., and any remedy of incidental damages or loss are hereby excluded. Any acts of God or natural disasters, such as flood, storm, lightning, etc. are excluded. Purchaser's noncompliance with any part of this specific limited warranty shall immediately render the total warranty null, void and non-enforceable.

The purchaser shall use, service and maintain the ambulance according to the written instructions furnished by the Manufacturer and failure of purchaser to properly use, service and maintain the product in accordance with such instructions shall void the warranty, including, without limitation, (i) use of modular body for any purpose other than what it was originally designed to perform, (ii) resale or remounting of modular body without written warranty-transfer approval within the required time period, (iii) overloading the ambulance beyond its applicable weight rating, (iv) overloading the electrical system beyond its applicable electrical load rating, (v) remounting the modular body by anyone other than the Manufacturer or a Braun Authorized Remounter, (vi) defects or damage as a result of misuse, abuse, negligence, damage, or failure to provide normal routine maintenance, **and/or (vii) defects or damage as a result of pass-through and after-market work performed by any entity other than the Manufacturer.**

This statement of limited warranty does not apply to: (i) any product or component supplied by the purchaser, (ii) any product or component that is added, repaired, modified, altered, or replaced by anyone other than the Manufacturer, or (iii) any component that is not produced by the Manufacturer, and carries

its own warranty. Purchaser shall be responsible and liable for such modifications, alterations, integrations and installations performed by purchaser and purchaser hereby agrees to indemnify and hold harmless Manufacturer and its successors and assigns from all liabilities, obligations, cost, losses, demands, actions, proceedings, claims, damages, and penalties (including, without limitation, all attorney fees) incurred or suffered by Manufacturer and arising or relating to such modifications, alterations, integrations and installations performed by purchaser.

The Manufacturer reserves the right to make changes to the design and features of its products without any obligation to make corresponding changes to products previously manufactured. No other person is authorized to make any representation or warranty on behalf of the Manufacturer or any Braun Authorized Dealer / Service Center, other than as stated in the Manufacturer's warranty.

STRUCTURAL WARRANTY

The aluminum modular body (Braun SOLIDBODY™ ambulances) are warranted to be structurally sound and free of joint separation, weld cracks, and all other structural defects in materials and workmanship for the life of the vehicle in accordance with the provisions of this warranty. The original Braun Limited Warranty may be extended to the remounted ambulance when authorized.

Inclusions to warranty – The modular body construction, including seams, joints, door frames, roof, floor, and wall construction. All exterior doors. All aluminum cabinetry.

Exclusions from warranty – Paint finish, sealant deterioration, filler shrinkage, hardware, moldings, windows, non-aluminum cabinets, and other accessories that are not structural components of the module. Normal wear parts such as door rollers, latches, hinges, etc. Any part or component becoming defective as a result of accident damage or other casualty.

An accident will void the structural warranty. The potential for reinstatement of the structural warranty is dependent on an inspection by the Manufacturer or a Braun Authorized Dealer / Service Center within sixty days of the occurrence. The inspection will determine the structural integrity of the module and if there is an opportunity to reinstate the warranty.

TRANSFER OF OWNERSHIP:

The structural warranty may be transferred to a subsequent owner(s), provided that the vehicle is inspected by the Manufacturer or a Braun Authorized Dealer / Service Center within sixty days of transfer of ownership and the warranty revalidation forms are completed and filed with the Manufacturer verifying warranty compliance. A warranty transfer fee, in addition to inspection charges, will apply. Once this warranty has become invalidated by failure to comply with this provision or for any other reason, it cannot be reinstated.

CONVERSION WARRANTY

The non-structural construction, assembly and installation of the module is warranted to be free of defects in materials and workmanship for a period of three years from the date of manufacture, or up to 36,000 miles, whichever occurs first. Performance of components and equipment not manufactured by the manufacturer are covered by the applicable warranty from the

**This is an Electronically CONTROLLED Document and the property of Braun Industries
Uncontrolled When Printed**



BRAUN PERFORMANCE EXCELLENCE SYSTEM

Statement of Limited Warranty New Ambulances

Document No. and Level:	BPES-P-076-100 / Level II
Effective Date:	December 22, 2017
Revision No.:	C
Prepared By:	Kim Braun
Owner:	Kim Braun
Page:	2 of 2

supplier of the specific item in question and may be more or less than the three year conversion warranty period and in some cases may not cover labor.

Inclusion to warranty – Non-aluminum cabinets, interior doors and acrylic or polycarbonate windows, hardware, latches and locks, trim, wall coverings, floor, kick plates, cot mount hardware, grab handles, IV hangers and other accessories. Braun manufactured seating, head pads, and other cushions and upholstery items. Air conditioning and heating system hoses, connections, and installation. Peeling or de-lamination of the topcoat and/or other layers of graphics. Cracking or checking of the graphics material and loss of gloss or color.

Exclusion from warranty – Effects from normal wear/use. Floor discoloration and marring. Damage to graphics caused by chemicals including but not limited to: DEF (diesel exhaust fluid), gasoline, diesel fuel, anti-freeze, power steering fluid, brake fluid, fuel additives, magnesium, calcium chloride, road salt, or other substances which are used to free roads from ice/snow. Damage caused by power washers, or other aggressive forms of washing. Damage caused by rolling, sliding or segmented doors.

CHASSIS WARRANTY

All new Braun ambulances that are mounted on a new chassis will carry the full OEM warranty, as issued by the specific chassis OEM. This warranty is administered by the chassis OEM's representing dealer and is subject to the guidelines, restrictions, and limitations that they set forth. This warranty does not apply to any portion of the truck or chassis directly included in the alteration process – including materials added to and work accomplished on the original chassis by a vehicle modifier. Should any chassis service/repairs be required due to Braun alterations, such repairs/service are covered under the Braun warranty for a term equal in duration, and in every other aspect, to the warranty provided by the OEM for the applicable chassis model year. The purchaser should complete an alignment after the unit is loaded and readied for use, as added weight and weight distribution will affect vehicle alignment. Alignments are not covered by OEM nor Braun warranty.

ELECTRICAL WARRANTY - MASTERTECH

The MasterTech microprocessor based, multiplex electrical system is warranted to be free of mechanical, electrical, and physical defects (excluding lamps, switches, and electrical display screens) for a period of seven years from the date of manufacture (up to 84,000 miles), whichever occurs first. The electrical display screens are also covered by a seven year pro-rated warranty, with a maximum allowable coverage of \$200 for parts replacement after three years. Labor is covered for the entire seven year period.

Inclusion to warranty – All Manufacturer installed wiring, wiring terminals, connectors, nodes and electrical display screens. Initial programming and proper system functions. Installation and proper wiring of standard and specified optional components such as fans, lights, sirens, compressors, IV warmers etc.

Exclusion from warranty – Chassis electrical systems which are covered by the chassis OEM. Batteries and alternator systems

which are covered by the OEM warranty. Light bulbs, batteries, and other normal wear/consumable type items.

ELECTRICAL WARRANTY - TRADITIONAL

The electrical wiring harness, electrical components, and electrical system installation and workmanship are warranted to be free of defects for a period of five years from the date of manufacture (up to 75,000 miles), whichever occurs first. Performance and function of components and equipment not manufactured by the manufacturer are covered by the applicable warranty from the supplier of the specific item in question and may be less than the five year electrical warranty period, may not cover labor and may require repair instead of replacement.

Inclusion to warranty – All Manufacturer installed wiring, wiring terminals, connectors, relays, rocker switches, circuit breakers, diodes, solenoids, voltmeters, ammeters, and hour meters. Installation and proper wiring of components.

Exclusion from warranty – Chassis electrical systems which are covered by the chassis OEM. Batteries and alternator systems which are covered by the OEM warranty. Light bulbs, batteries, and other normal wear/consumable type items.

PAINT WARRANTY

The pro-rated paint warranty covers the areas of the ambulance body finished with paint products specified by the Manufacturer for a period of seven years from the date of manufacture, or up to 84,000 miles, whichever occurs first. The first four years, or up to 48,000 miles, are covered at 100% parts and labor. The fifth year or up to 60,000 miles, is covered at 75% parts and labor. The sixth and seventh years or up to 84,000 miles, are covered at 50% parts and labor. Paint repairs must be pre-authorized by the Manufacturer and performed by the Manufacturer or an Authorized Braun Dealer / Service Center.

Inclusion to warranty – Peeling or de-lamination of the topcoat and/or other layers of paint. Cracking, checking or loss of gloss. Any paint failure caused by defective materials which are covered by this warranty. Corrosion caused by improper surface preparation, dissimilar metal reaction, or improper paint application.

Exclusion from warranty – Paint deterioration caused by road salt, magnesium, calcium chloride, or other substances which are used to free roads from ice/snow. Paint deterioration caused by accidents, acid rain, chemical fallout, acts of nature, or the lack of routine maintenance such as regular washing and waxing or the failure to touch-up stone chips. Damage caused by chemicals including but not limited to: DEF (diesel exhaust fluid), gasoline, diesel fuel, anti-freeze, power steering fluid, brake fluid, fuel additives, abrasive cleaners, etc. Failures resulting from product misuse or abuse including but not limited to stone chips, scratches, gouges, other impact damage, etc. Hazing, chalking or loss of gloss caused by improper care, abrasive polishes, cleaning agents, pressure washing, or aggressive mechanical wash systems. Failure of finishes that were applied without the prior, written authorization of the Manufacturer.



Specification Summary

Reference: QUO0000003410 **Rev:** 0
Purchaser: RedSky Emergency Vehicles
Contact:
Address:

Opportunity: 2021 MXP-170 Stock
Account: Demers USA Stock
Contact:
Shipping Address:

Telephone:

Currency: USD
Quotation Date: 2021-03-25
Expiration: 2021-04-24

Sales Contact: Kirsten Skyba
Mobile:
Phone: 304.839.4051

Factory Contact: Greg Tucci
Mobile: 570-640-8099

Name

Type I - MXP170

Specifications

Overall Length 294" - 311" (747 cm - 790 cm)
 Overall Width 95" (241 cm)
 Overall Height 110" (279 cm)**
 Headroom 72" (183 cm)
 Wheelbase 174" - 192" (442 cm - 488 cm)*
 Payload Capacity Up to 5500 lbs (2495 kg)



*Depending on chassis selection

**Total height of vehicle may differ according to chassis and suspension

Sales Options by Category

10-Base (BAS)

Item Number	Name/Description	Quantity
BAS-CER-11	KKK This specification identifies the minimum requirements for new automotive Emergency Medical Services (EMS) ambulances (except military field ambulances) built on Original Equipment Manufacturer's Chassis (OEM) that are prepared by the OEM for use as an ambulance.	1.00
BAS-PLA-12	TYPE I - MXP170 TYPE I - MXP170	1.00
BAS-REG-11	United States Sales Administration Charge	1.00
BAS-TYP-11	Type I - Pick up Type I - Pick up	1.00

11-Chassis (CH*)



<i>Item Number</i>	<i>Name/Description</i>	<i>Quantity</i>
BAS-CHA-21	Chassis Model year 2021 Chassis Model year 2021	1.00
CHP-FRD-00	Conversion Ford F350/F450 Chassis Cab Conversion Ford F350/F450 Chassis Cab	1.00
CHP-FRD-17	Ford F450XLT Super Duty Diesel Chassis Cab 4X4 193 Ford F450XLT Super Duty Diesel Chassis Cab 4X4 193 6,7L POWER STROKE V8 Diesel Engine Wheelbase 193" (4902 mm), 4 X 4 GVWR (Gross vehicle weight rating) 16,500 Lbs / 7,486 Kg	1.00
CHP-SCR-11	Audible Lane Departure Warning (60C) Audible Lane Departure Warning (60C) for Ford F-Series chassis.	1.00
CHP-SCR-12	Pre-Collision Assist with Automatic (94P) Pre-Collision Assist with Automatic (94P) for Ford F-Series chassis.	1.00

12-Suspension (SUS)

<i>Item Number</i>	<i>Name/Description</i>	<i>Quantity</i>
SUS-LIQ-11	LiquidSpring™ Suspension Type I Compressible Liquid Adaptive Suspension System, is a smart suspension systems. Liquid--based struts and an on--board processor provide better handling and control, and a smoother, softer ride. The reduced vehicle vibration increases comfort.	1.00

13-Module (MOD)

<i>Item Number</i>	<i>Name/Description</i>	<i>Quantity</i>
MOD-ALU-14	MXP170 Ambulance Module Ambulance Module Structure / Door Structure and Accessories Included	1.00

14-Module Configuration (MCF)

<i>Item Number</i>	<i>Name/Description</i>	<i>Quantity</i>
MCF-CC1-11	C1 Door, ALS Access and Battery Location First door on curbside (C1) for ALS compartment access and battery slide out sealed compartment. (Included)	1.00
MCF-CC2-12	C2, Curbside Entry Door, with Opening Window Side entry door on curbside (C2) for patient compartment access, with flush-mounted, automotive-style opening window.	1.00
MCF-CC3-11	C3 Door, Storage Exterior Compartment Third door on curbside (C3) for backboard or other storage. (Included)	1.00
MCF-CC3-13	Stair Chair Location, Two (2) Adjustable Shelves Stair chair location with two (2) adjustable shelves and retaining safety belt for backboard in C3 compartment.	1.00
MCF-CC3-22	Third door (C3) Compartment In/Out Access Third door (C3) Compartment In/Out Access	1.00
MCF-CML-12	High-Intensity Compartment Tube Lighting High-intensity tube lighting for Compartments. With Side entry Door Steps.	1.00
MCF-ELE-11	E Door, Electrical Exterior Compartment Upper door (E) for electrical panel access. (Included)	1.00
MCF-RDR-11	A1 and A2, Rear Entry Doors, Indiv. Door Handles Two (2) rear entry doors for patient compartment access, each with its individual exterior door handle.	1.00
MCF-SS1-11	S1 Door, Main Oxygen Exterior Compartment First door on streetside (S1) for main vertical oxygen cylinder. (Included)	1.00
MCF-SS2-12	Full-Depth Shelf, One (1), Adjustable One (1) full-depth, adjustable shelf in S2 compartment.	1.00
MCF-SS2-14	Fire Extinguisher, ABC-Rated, 5 lbs, with Bracket Fire extinguisher, 5 lbs, ABC-rated, with heavy duty bracket in S2 compartment.	1.00



MCF-SS2-15	S2 Door, Storage Exterior Comp Second door on streetside (S2) for equipment storage for MX/MXP170. (included)	1.00
MCF-SS3-12	S3 Compartment, Equipment Storage, In/Out Access Third door on streetside (S3) for equipment storage, with interior/exterior access.	1.00
MCF-SS3-13	Full-Depth Shelves, Two (2), Adjustable Two (2) full-depth, adjustable shelves in S3 compartment.	1.00

15-Lighting (LGT)

Item Number	Name/Description	Quantity
LGT-LSL-11	Turn Signal Lights, Amber (2), LED Two (2) amber turn-signal lights, intermediate side mount. Whelen 700 series (7 x 3) LED lights.	1.00
LGT-RSL-11	Third Upper Brake Light, LED Third upper brake light at rear of module. Whelen 600 series (6 x 4) LED light.	1.00
LGT-RSL-14	Rear Step Plate: Turn Signal Light, Brake, Reverse Two (2) red brake/tail lights, two (2) amber turn lights, and two (2) reverse lights installed in rear step plate. Round LED lights.	1.00
LGT-RSL-22	Mid-Height Lights: Arrow, Brake, Reverse Two (2) amber arrows, two (2) red brake lights, and two (2) reverse lights at mid height. Whelen 600 series LED lights (6 x 4).	1.00
LGT-TPL-11	Marker Lights, Amber (7) and Red (7), LED Seven (7) front upper center and corner amber LED marker lights. Seven (7) rear upper center and corner red LED marker lights.	1.00
LGT-TPL-12	Marker Lights, Two (2) rear mid-height red LED Two (2) rear mid-height red LED marker lights.	1.00

16-Emergency and Working Lights (EWL)

Item Number	Name/Description	Quantity
EWL-ACC-11	Clear Lenses Clear lenses.	1.00
EWL-BEZ-11	Chrome bezels Chrome bezels	34.00
EWL-FWD-17	Emergency Lights, Red (3), White (1), Red (3), LED Seven (7) emergency lights installed on the front of the module. Includes three (3) red, one (1) white, and three (3) red. Whelen 900 series (7 x 9) LED lights.	1.00
EWL-GRL-14	Lights in Front Grille, Red (2), Wig-Wag (2), 500 Two (2) red and two (2) clear lights in front grille with Wig Wag flash pattern. Whelen 500 series (5 x 1) LED lights.	1.00
EWL-INT-11	Emergency Lights on Inside of Doors, One (1) each One red emergency light on each compartment and entry door inside panel. Total of eight (8) round LED lights.	1.00
EWL-ITC-12	Intersection Lights, Clear/Red (2), LED Two (2) clear/red intersection lights with turning priority. Whelen 700 series (7 x 3) LED lights.	1.00
EWL-LTI-11	Emergency Lights, Red (2), LED, Inter. Side Mount Two (2) red emergency lights, intermediate side mount. Whelen 700 series (7 x 3) LED lights.	1.00
EWL-LTS-11	Four (4) red LED lateral emergency lights (900) Four (4) red lateral emergency lights (two (2) on each side). Whelen 900 series (7 x 9) LED lights.	1.00
EWL-LTS-17	Scene Lights, Four (4), Clear LED, (900) Four (4) lateral scene lights (two (2) on each side). Whelen 900 series (7 X 9) LED scene lights.	1.00



EWL-RER-11	Emergency Lights, Red (2), LED, Rear Corners Two (2) red rear emergency lights at upper rear corners. Whelen 900 series (7 x 9) LED lights.	1.00
EWL-RER-12	Emergency Lights, Amber (2), LED Two (2) rear upper amber lights. Whelen 600 series (6 x 4) LED lights.	1.00
EWL-RER-15	Loading Lights, Two (2), LED Two (2) rear loading lights. Whelen 600 series (6 x 4) LED lights.	1.00
EWL-RER-16	Emergency Lights, Red (2), LED, Addt'l, Window Hgt Two (2) additionnal red lights at window height. Whelen 900 series (7 x 9) LED lights.	1.00
SR00078342	Camera monitor OEM Dash Display FEB 19_Only Backup camera connected to OEM // Patient compartment camera connected to 5 inch display monitor __RN Display for both cameras should display on OEM Dash Screen	1.00

17-Audible Warning System (WRN)

<i>Item Number</i>	<i>Name/Description</i>	<i>Quantity</i>
WRN-BUA-11	Back-Up Alarm Back up alarm (97dB) with override switch. (Included)	1.00
WRN-SIR-11	Whelen 295SLS Hands-Free Siren Whelen model 295HFSA1 siren amplifier with 17 Scan-Lock™ siren tones.	1.00
WRN-SIR-13	Switch to Mute OEM Horn when Siren Speakers Active Switch to mute the OEM horn when the siren speakers are activated.	1.00
WRN-SPK-11	Whelen SA315 Series Speakers Whelen SA315 series speakers is a compact speaker meeting SAE Class A requirements when paired with Whelen 100 watt siren amplifier.	1.00

18-Exterior Vehicle features (VFT)

<i>Item Number</i>	<i>Name/Description</i>	<i>Quantity</i>
VFT-FUL-11	Quarter-Tank Fuel Fill Quarter-tank fuel fill.	1.00
VFT-MIR-11	OEM exterior mirrors Keep OEM exterior mirrors	1.00
VFT-MOP-11	Module Rub Rails, Aluminum Aluminium rub rails on module sides. (Included)	1.00
VFT-MOP-12	Module Corner Protectors, Stainless-Steel Stainless-steel protectors on module corners. (Included)	1.00
VFT-MOP-13	Module Wheel Trims, Fiberglass Formed fiberglass wheel trimming on module. (Inlcuded)	1.00
VFT-MOP-14	Undercoating Protection Undercoating protection for module and chassis. (Included)	1.00
VFT-MOP-15	Rear Wheel Mud Guards Mud guards on module for rear wheels. (Included)	1.00
VFT-PLT-12	Chrome License Plate with Light Recessed chrome license plate holder with LED light.	1.00
VFT-STP-11	Cab Steps, Anti-Skid Material with Mud Guards Anti-skid lateral steps. Includes mud guards for front wheels. (Included)	1.00
VFT-STP-12	Rear Step Bumper, Retractable Center Section Anti-skid rear retractable step. Diamond plate corner bumper. Rubber bumperette. (Included)	1.00

19-Convenience (CNV)

<i>Item Number</i>	<i>Name/Description</i>	<i>Quantity</i>
CNV-ACC-13	Valet Switch in Front Grille The door unlock valet switch is located on the back of the front grille, on the driver's	1.00



	side half portion of the grille. It allows to unlock all doors of the vehicle, but cannot lock the doors. (Included)	
CNV-ACC-15	Demers Fast Idle Demers fast idle is generated by the multiplex module, it allows fast charging of the batteries by the engine when specific conditions are met. (Included)	1.00
CNV-CAM-11	Black Back-Up Camera Zone Defense standard back-up camera with build-in audio support and infra-red night vision.	1.00
CNV-CAM-12	Black Dome Interior Camera Zone Defense dome interior camera with build-in audio support and 120 degree viewing angle.	1.00
CNV-CAM-14	5 inches Monitor Zone Defense 5" backup digital LCD monitor is a stand-alone monitor and cable kit that connects to camera(s) installed on your vehicle.	1.00
CNV-LCK-11	Anti-Theft System The anti-theft allows to leave the vehicle with the keys with the engine running to keep the vehicle at the ideal operating temperature. It protects against theft by running off the engine if the vehicle moves. (Included)	1.00
CNV-LCK-12	ECOSMART Anti-Idling System The ECOSMART Anti-Idling System automatically stops the engine and restarts the engine of the vehicle in idling conditions. The ECOSMART Anti-Idling System is managed by the Demers Electronic Multiplex System (DEMS).	1.00

21-Paint and Decals (DEC)

<i>Item Number</i>	<i>Name/Description</i>	<i>Quantity</i>
DEC-PNT-11	Tri-Star Urethane Paint Two (2) coats of primer with two (2) coats of urethane. All four (4) sides and roof. No sanding. No buffing.	1.00
DEC-REG-14	Emblems and Markings "Star of Life" (3", 12", 16" and 32"), "AMBULANCE" (3), and mirrored "AMBULANCE" (1).	1.00

22-Drivers Compartment (CAB)

<i>Item Number</i>	<i>Name/Description</i>	<i>Quantity</i>
CAB-ACC-11	Spotlight in Front Cab, Hand-Held, with Bracket Hand-held spotlight, 2000 lumens, with trigger-type switch and bracket.	1.00
CAB-ACC-17	Glove Storage in Cab OEM Door Panels, Loose Gloves Glove storage compartment in OEM door panels for loose gloves.	1.00
CAB-CON-11	Floor-Mounted Console with control Floor-mounted console in front cab.	1.00
CAB-CON-13	Storage for Flare and Fire Extinguisher Storage compartment in front cab for flares and one (1) five-pound (5 lbs) fire extinguisher.	1.00
CAB-CON-14	Armrests, Driver and Passenger, Individual Individual driver- and passenger-side armrests on sides of floor-mounted console.	1.00
CAB-CON-15	Cup Holders, Dual, in Floor-Mounted Console Dual cup holders in floor-mounted console.	1.00
CAB-CTR-13	Control Center with Switches and Touch Pad Control center with switches and LED backlit pictograms in the floor mounted console.	1.00
CAB-LGT-11	Cab headliner with Reading Lights, Red/Clear (2) Two (2) clear and red overhead LED reading lights.	1.00

23-Curbside configuration (CRB)

<i>Item Number</i>	<i>Name/Description</i>	<i>Quantity</i>
--------------------	-------------------------	-----------------



CRB-TEC-11	Full-Length Seat Cushion Full-length, thermoformed, molded seat cushion.	1.00
CRB-TEC-14	Seat Backrest Individual, thermoformed, molded backrests.	3.00
CRB-TEC-23	Seating, Three (3) Passengers, 6-Pt Safety Belts Seating for three (3) passengers with 6-point safety belts. Space for Flip-down and hands-free opening mechanism.	1.00

24-Streetside configuration (STR)

Item Number	Name/Description	Quantity
STR-ACS-23	Flip-Up Door, Tinted Self Latching Sliding Windows Aluminum flip-up frames, self latching for easy restocking of cabinets. Polycarbonate tinted self latching sliding windows.	3.00
STR-MED-12	Medical Cabinet, CPR Bench Seat, Int/Ext Access Medical cabinet with CPR bench seat, the rear lower storage compartment is accessible from the S3 exterior compartment.	1.00
STR-REA-12	CPR Seat , 6-Pt Safety Belt Seating for one EMT with 6-point safety belt.	1.00

25-Forward Bulkhead (FWB)

Item Number	Name/Description	Quantity
FWB-DIV-11	Sliding Door Crawl-Through Crawl-through with sliding door on front division to access to the cab.	1.00
FWB-LFT-11	Corner Cabinet, Streetside, Two Adjustable Shelves Corner cabinet on streetside of front wall. Includes two (2) aluminum extruded doors with see through windows, two (2) adjustable shelves and LED strip lighting.	1.00
FWB-LFT-14	Locking Radio Communication Compartment Lockable compartment on street side for radio communication	1.00
FWB-RGT-11	ALS Cabinet, with Drawer ALS cabinet on curbside of front wall. Includes four (4) aluminum extruded doors with see-through windows, adjustable shelf(s), one (1) drawer at mid-height, LED strip lighting, and inside/outside access via curbside door.	1.00
FWB-RGT-13	Compartment above ALS Cabinet, Lockable Lockable compartment located above the front wall ALS cabinet.	1.00
FWB-RGT-16	See-Through Door, Two Handles Four (4) extruded doors with see through windows and handles	1.00

26-Attendant seat (AST)

Item Number	Name/Description	Quantity
AST-BSE-11	EVS Swivel Seat Base, Two (2) Positions EVS swivel 360 degrees seat base, locking in two (2) positions, forward and rearward positions	1.00
AST-HRS-12	EVS 1880 3Pts Vac-Formed Seamless Child Seat The EVS 1880 is a vac-form, seamless ambulance attendant's seat. Integrated child restraint system that allows uninjured children weighing between 20-65 lbs to be transported in a five point safety harness. When it is not needed, the child-insert can be folded into the seat and allow an adult to use the seat as a standard attendant's seat	1.00

27-Cot Configuration (COT)

Item Number	Name/Description	Quantity
COT-ANC-23	Floor Plate for Stryker Power-LOAD with pre-wiring Stryker Power-Load floor plate. No cot fastener included. Include pre-wiring for charging feature.	1.00



COT-POS-11	Center Floor-Mount Cot Configuration Center floor mount cot configuration	1.00
-------------------	---	------

28-Rear Control Panel (CAR)

<i>Item Number</i>	<i>Name/Description</i>	<i>Quantity</i>
CAR-AUX-11	Rocker Switch Controls with LED Backlit Pictograms Auxiliary Rocker switch controls with LED backlit pictograms.	1.00
CAR-CTR-11	Rocker Switch Controls with LED Backlit Pictograms Rocker switch controls with LED backlit pictograms.	1.00

29-Oxygen (OXY)

<i>Item Number</i>	<i>Name/Description</i>	<i>Quantity</i>
OXY-NTW-14	Oxygen Outlets, Four (4) Four (4) oxygen outlets. Two (2) in ECC, one (1) on curbside, and one (1) on the ceiling.	1.00
OXY-OUT-11	Oxygen Outlet, Quick-Connect Quick-connect-style oxygen outlet.	4.00
OXY-REG-12	Oxygen Regulator, Manual, Sensor and Dig. Read-Out Manual oxygen regulator with pressure sensor and digital read-out.	1.00
OXY-REG-13	Oxygen Control Valve, Electronic, Manual By-Pass Electronic oxygen control valve with manual by-pass.	1.00
OXY-SPO-11	Storage for Two (2) D-Size Portable Cylinders "D" Portable oxygen cylinder storage (2), located in side entry door.	1.00
OXY-SPR-11	Universal Vertical Holder for Main Oxygen Cylinder Universal vertical holder for types "K" or "M" main oxygen cylinder in S1 streetside exterior compartment.	1.00

31-Suction (SUC)

<i>Item Number</i>	<i>Name/Description</i>	<i>Quantity</i>
SUC-LOC-11	Suction System location in ECC Main suction system is located in front streetside action area.	1.00
SUC-MOT-11	Thomas high flow vacuum pump Thomas high flow vacuum pump	1.00
SUC-OUT-11	Vacuum outlet QD in action area Vacuum outlet QD Puritan with yellow 5/16" hose 4 ft long	1.00
SUC-REG-11	Vacuum regulator with disposable canister Vacuum regulator with disposable canister (Rico RS-4X)	1.00

32-Electrical System (ELE)

<i>Item Number</i>	<i>Name/Description</i>	<i>Quantity</i>
ELE-ALT-11	Power Inverter, Xantrex Freedom, True Sine, 1000W The inverter/charger provides AC power using the DC power from the conversion battery bank. Recharge all battery banks and power all 120 volts AC outlets when the external shoreline is connected.	1.00
ELE-ALT-14	Super Auto Eject Power Inlet, 20 Amps, Yellow Kusmaull 120 Volts AC, 20 Amps Automatically disconnects shoreline Completely sealed Yellow cover Indicator light	1.00
ELE-ALT-15	Electrical Outlet, 120V AC with Indicator 120V AC hospital-grade electrical outlets with indicator. (Included)	1.00
ELE-CON-13	ACDelco Conversion Batteries Two (2) ACDelco conversion Batteries. (Included)	1.00
ELE-CON-14	Electrical Outlet, 12V DC 20 amp with Indicator 12V DC, 20 amp Duplex electrical outlets. (Included)	1.00
ELE-CON-18	Add Dual USB DC outlet with indicator Additional dual USB DC outlet with indicator. Details and location are as follows: (1) in	2.00



ELE-GES-11	ECC (Action Area); (1) cab console Demers Multiplex Electronic Management System Demers Electronic Management System (DEMS) – Multiplex system. (Included)	1.00
------------	---	------

33-Communication System (COM)

<i>Item Number</i>	<i>Name/Description</i>	<i>Quantity</i>
COM-RAD-11	Pre-Wiring for 2-Way Radio, Two (2) Antenna Cables Wiring preparation for two-way radio, with two (2) antenna cables. (routed from front cab to radio communication compartment)	1.00
COM-RAD-14	Radio Communications Compartment Radio communications compartment universal board, Bussmann blade-type fuse panels, and harness to power the radio communication devices. (12V battery feed, ground, ignition).	1.00
COM-RAD-15	Radio Communications Front Console Radio communications front console universal board, Bussmann blade-type fuse panels, and harness.	1.00
COM-REC-11	Data Recorder Available Signals Data recorder available signals through a universal connector in the electrical compartment. (Included)	1.00

34-HVAC (CVC)

<i>Item Number</i>	<i>Name/Description</i>	<i>Quantity</i>
CVC-AUX-18	Dual condenser 135000 BTU, Roof LP Auxiliary dual condenser low profile roof mounted - ACC Climate Control 135000 BTU	1.00
CVC-CLD-12	Independant Air Conditioning System The compressor, condensor and evaporator formed an assembly independant of the OEM, cooling the air of the patient compartment through the ducted outlets.	1.00
CVC-DIF-11	Air Conditioning Outlets, Round Round outlets for ducted air conditioning unit. (Included)	1.00
CVC-HOT-11	OEM Tie-In Heating Unit The heating system is an extension of the OEM heating system, heating the patient compartment area trough invisible opening underneath the medical cabinet at floor level. (Included)	1.00
CVC-VNT-13	Exhaust Fans (2) Two (2) exhaust fans for contaminated air. Activated by front control interface or rear console switch. (Included)	1.00

35-Interior Lights (ILG)

<i>Item Number</i>	<i>Name/Description</i>	<i>Quantity</i>
ILG-PLF-11	LED Dome Lights, Adjustable, Dig. Timer The ceiling lights have four (4) different intensities. Each time the ceiling lights button is pushed, the intensity increases, until maximum intensity is reached.	8.00

36-Grab Handles (GBR)

<i>Item Number</i>	<i>Name/Description</i>	<i>Quantity</i>
GBR-COL-12	Grab Bars Color, Yellow Color of selected grab bars is Yellow.	1.00
GBR-DRS-11	Rear Door-Mounted Grab Bars, 16" x 16" Two (2) door-mounted grab bars, 16" x 16", inside of rear doors (A1 and A2). (Included)	1.00
GBR-DRS-12	Curbside Door-Mounted Grab Bar, 12" One (1) door-mounted grab bar, 12" each, on the inside of the side entry door (C2). (included)	1.00
GBR-EMB-11	Embarking Grab Bars, 12"	1.00



GBR-PLF-11	Two (2) entry grab bars, 12" each, mounted inside the patient compartment. One (1) near the curbside entry door, and one (1) near the R2 rear entry door. (Included) Ceiling Grab Rails, 90", Two (2) Two (2) ceiling-mounted grab rails, 90".	1.00
-------------------	---	------

37-Finish and Trim (FNS)

<i>Item Number</i>	<i>Name/Description</i>	<i>Quantity</i>
FNS-FLR-11	Lonseal, Lonplate II, Gun metal Lonseal, Lonplate II, Gun Metal floor covering.	1.00
FNS-GRD-11	Cobalt Blue Upholstery Cobalt blue vinyl upholstery for seat and padding covering. (Included)	1.00
FNS-GRD-15	Safety Yellow Upholstery Yellow vinyl upholstery for safety exit padding covering. (Included)	1.00
FNS-MAT-11	Wood Flooring Exterior grade plywood, 0,75 inches thick.	1.00
FNS-PLF-11	Fiberglass Ceiling Fiberglass ceiling in Patient Compartment. (Included)	1.00
FNS-STK-11	General Vehicle Identification Vehicle general labels identification. (Included)	1.00
SR00078339	Floor LonPlate II P443TXM Midnight Floor LonPlate II P443TXM Midnight	1.00
SR00078340	black upholstery All seats and pads to be BLACK except head strike YELLOW pads	1.00

38-Functionality (FCT)

<i>Item Number</i>	<i>Name/Description</i>	<i>Quantity</i>
FCT-LFT-17	Four Gloves Box Holder Rear of Medical Cabinet Recessed holder contain four (4) gloves box, at rear of medical cabinet next to rear entry door. Restocking via pivoting door. (Glove box not included)	1.00
FCT-LFT-24	Glove Box Compartment, Three (3) boxes Glove box compartment above CPR seat for three (3) horizontal boxes.	1.00
FCT-PLF-11	Radio Speakers, Recessed, Two (2) Two (2) recessed radio speakers. (Included)	1.00
FCT-PLF-13	IV Hooks, Recessed in Ceiling, Flexible, Four (4) Four (4) recessed flexible IV hooks in ceiling.	1.00
FCT-RGT-17	Combo Storage Compartment and Glove Box Holders Combo storage cabinet with LED strip lighting and sliding doors, and glove box compartment for three (3) boxes.	1.00
FCT-RGT-21	Trash Container, Flip-Down, Hands-Free Trash container bracket in curbside flip-down container.	1.00
FCT-RWR-11	Digital Clock, Driver and Step Indicator Lights Digital clock, rear step indicator light, driver intention indicator lights (direction, braker) located in padding above the rear doors.	1.00

**Demers MXP170 Stock, Type I, #F20P-1582
Configuration Highlights**

- 2021 Ford F450 4x4 diesel-powered chassis
- Audible lane departure warning
- Pre-Collision assist
- Liquid Spring suspension
- 170" module with 72" interior headroom
- Power locks for module entry and compartment doors
- Multiplex electrical system with remote diagnostic capability
- Anti-theft system
- EcoSmart anti-idle system
- Inverter/battery charger, Xantrex Freedom, True Sine, 1000W
- Kussmul Super Auto Eject 20 amp shoreline
- Two (2) dedicated conversion batteries with emergency "boost" starting for chassis
- Rear view and patient module cameras with display in OEM dash
- Stair chair holder on interior of intermediate streetside compartment
- Auxiliary AC condenser, 13,500 BTU, roof-mounted, low profile
- Auxiliary AC compressor, dedicated to patient module
- All LED warning and scene lights
- LED strip lights in exterior compartments
- Crawl-through with sliding door
- Locking radio cabinet above crawl through
- Aluminum interlocking extrusion cabinet structure
- Restocking cabinet doors on streetside
- LED strip lighting in all interior cabinet
- Attendant Seat: EVS 1880 3Pts Vac-Formed Seamless Child Seat, swivel
- CPR seat: 6-point harness
- Squad Bench: Three-person seating with 6-point harnesses
- Full-sized drawer and two cabinets in front wall cabinet
- Digital clock above rear entry doors
- Stryker PowerLOAD floor plate and prewire
- Dealer-supplied PowerLoad and installation at customer location



DEMERS AMBULANCES

EASY STEPS

WARRANTY GUIDE

(United States)

UNDERSTANDING YOUR DEMERS AMBULANCES LIMITED WARRANTIES

Your satisfaction is very important to us.

If you have questions or concerns with your vehicle, please do not hesitate to take the following steps:

1. Contact your Service Advisor at your authorized service center.
2. If the inquiry or concern is not resolved in a reasonable delay, please contact the **Demers Ambulances** Customer Assistance at:

Demers Ambulances
Customer Assistance Center
1-800-363-7591 (toll free - U.S.)
info@demers-ambulances.com

1. INTRODUCTION

Thank you for buying a **Demers Ambulance**.

When warranty repairs are required, you may take your vehicle to any **Demers Ambulances** authorized service center (see separate sheet for these locations). Please be aware that since certain warranty repairs require specifically trained employees, not all service centers are authorized to perform these warranty repairs. If a particular center cannot assist you, then contact the **Demers Ambulances** Customer Assistance Center at the number shown above.

This guide explains in detail the warranty coverage that apply to your Demers Ambulances.

Demers Ambulances provides the following Limited Warranties (Hereafter collectively referred to as the "Limited Warranties"):

1. **Modular Body Structure Limited Warranty**
2. **Modular Body Paint Limited Warranty**
3. **Electrical Limited Warranty**
4. **Demers Ambulances Materials/Workmanship Limited Warranty**
5. **OEM Materials/Workmanship assembled by other than Demers Ambulances Limited Warranty**

Chassis Manufacturer provides the New Vehicle Limited Warranty as well as the Federal and California Emissions Defect Warranties and Emissions Performance Warranties.

Please see the separate Chassis Manufacturer warranty booklet for coverage.

2. IMPORTANT INFORMATION YOU SHOULD KNOW: IF YOU NEED CUSTOMER ASSISTANCE:

For customer assistance, please follow the procedures outlined in the section 3 of this warranty guide.

DEFINITION:

Demers Ambulances refers to legal name Demers Ambulance Manufacturer Inc.

OEM refers to Original Equipment Manufacturer

OWNER refers to Original purchaser and/or Original license operators

KNOW WHEN EACH LIMITED WARRANTY BEGINS AND HOW LONG IT LASTS:

The **Start Date** for each Limited Warranty is the day the unit is first put into service (requires proper documentation to be filled and returned to **Demers Ambulances**) or the date of invoice, if no in service document was returned to **Demers Ambulances**. Each Limited Warranty lasts for the length of time specified or until the applicable mileage has been met, whichever occurs first.

CHECK YOUR VEHICLE:

If you see any damage when you receive your vehicle, notify your **Demers Ambulances Representative** immediately.

MAINTAIN YOUR VEHICLE PROPERLY:

Your vehicle contains an **Owner's Manual** and a **Recommended Maintenance Schedule** which indicates the scheduled maintenance required for your vehicle. Proper maintenance guards against major repair expenses resulting from neglect or inadequate maintenance.

It is your responsibility to make sure that all of the scheduled maintenances are performed and that the materials used meet applicable engineering specifications. Failure to perform scheduled maintenance as specified in the Service Guide will invalidate warranty coverage on parts affected by that lack of maintenance. Make sure that receipts for completed maintenance work are retained with the vehicle and confirmation of maintenance work is always kept.

COVERAGE UNDER THE LIMITED WARRANTIES:

During a Limited Warranty coverage period, the authorized **Demers Ambulances** service center will repair, replace, or adjust all parts on your vehicle (except specific exclusions as stated in the exclusions section of each Limited Warranty) that are defective in factory-supplied materials or workmanship. Items and conditions that are not covered by the Limited Warranties are stated in each Limited Warranty.

When making warranty repairs on your vehicle, the authorized service center will use new or remanufactured **Demers Ambulances** parts or other parts authorized by **Demers Ambulances**.

VEHICLES TO WHICH THE LIMITED WARRANTIES DO APPLY:

The **Limited Warranties** described in this booklet apply to your vehicle if:

- It was originally registered/licensed in United States and
- It is being operated in United States.

LIMITATIONS ON ALL OF YOUR LIMITED WARRANTIES:

ANY IMPLIED WARRANTY OF MERCHANTABILITY OR FITNESS FOR A PARTICULAR PURPOSE APPLICABLE TO THE VEHICLE IS LIMITED TO THE DURATION OF THE APPLICABLE LIMITED WARRANTY. THE PERFORMANCE OF REPAIRS AND NEEDED ADJUSTMENTS ARE THE EXCLUSIVE REMEDIES UNDER ALL THE LIMITED WARRANTIES. **DEMERS AMBULANCES** SHALL NOT BE HELD RESPONSIBLE FOR ANY INCIDENTAL OR CONSEQUENTIAL DAMAGE, SUCH AS LOSS OF TIME, INCONVENIENCE, LOSS OF USE OF THE VEHICLE, LOANER VEHICLES, LODGING, FOOD, TOWING, PERSONAL PROPERTY, OR LOSS OF BUSINESS PROFITS.

The implied warranties are limited (to the extent allowed by law) to the time period covered by the written warranties, or to the applicable time period provided by state law, whichever period is shorter.

Some states do not allow **Demers Ambulances** to limit how long an implied warranty may last, or to exclude or limit incidental or consequential damages, so the limitation and exclusions described above may not apply to you.

NOTE

This information about the limitation of implied warranties and the exclusion of incidental and consequential damages is applicable to all the Limited Warranties.

Your Limited Warranties give you specific legal rights. You may have other rights that vary from state to state. The Limited Warranties are the only express warranties from **Demers Ambulances** applicable to your vehicle. **Demers Ambulances** does not authorize anyone to assume any other obligation or liability in connection with your vehicle or the Limited Warranties.

Demers Ambulances reserves the unrestricted right at any time, and from time to time, to make changes in design of and/or improvements on its products without thereby imposing any obligation upon itself to make corresponding changes or improvements in or on its products theretofore manufactured.

WHAT IS NOT COVERED UNDER ANY OF THE LIMITED WARRANTIES:

Damage Caused By:

- Abuse, negligence or unapproved alteration of original parts
- Damage from accidents
- Proven failure of a third party, certified or not by Demers Ambulances to make repairs, to adhere to comprehensively detailed remount instruction of the proponent that results in any impairment is also exempted.
- Collision or objects striking the vehicle
- Theft, vandalism, or riot
- Fire or explosion
- Freezing
- Misusing the vehicle, such as driving over curbs, overloading
- Altering or modifying the vehicle – including the engine, body, chassis, or components – after the vehicle leaves **Demers Ambulances'** control
- Non-**Demers Ambulances** approved parts installed after the vehicle leaves **Demers Ambulances'** control. For example, but not limited to, cellular phones, alarm systems, and automatic starting systems
- Tampering with the vehicle
- Disconnecting or altering the odometer or allowing the odometer to be inoperative for an extended period of time with the result that the actual mileage cannot be determined
- Using contaminated or improper fuel/fluids
- Customer-applied chemicals or accidental spills
- Driving through water deep enough to cause water to be ingested into the engine

Damaged Caused by Use and/or the Environment

Your Limited Warranties do not cover surface corrosion and deterioration that result from use and/or exposure to the elements. Here are examples:

- Stone chips, scratches (some examples are on paint and glass)
- Dings, dents
- Cuts, burns, punctures or tears
- Road salt, tree sap
- Bird and bee droppings
- Lightning, hail
- Windstorm
- Earthquake
- Water or flood

Damaged Caused by Improper Maintenance

Your Limited Warranties do not cover damage caused by failure to maintain the vehicle, improperly maintaining the vehicle, or using the wrong part, fuel, oil, lubricants, or fluids. See the **Owner's Manual** for correct fluid types and levels, and consult the **Recommended Maintenance Schedule** for proper ways to maintain your vehicle.

Maintenance/Wear

Your Limited Warranties do not cover: (1) parts and labor needed to maintain the vehicle; and (2) the replacement of parts due to normal wear and tear. You, as the owner, are responsible for these items. Examples are:

- Oil changes
- Oils, lubricants, other fluids
- Oil/air filters
- Brake linings/pads or adjustments
- Tire rotation
- Cleaning/polishing
- Wiper blades
- Clutch linings or adjustments
- Engine tune-up
- Batteries
- Bulbs
- Belts
- Hoses

Other Items and Conditions Not Covered

Your Limited Warranties also do not cover:

- Vehicles that have ever been labeled or branded as “dismantled”, “fire”, “flood”, “junk”, “rebuilt”, “reconstructed”, or “salvaged”; this will void the Limited Warranties
- Vehicles that have been determined to be a “total loss” by an insurance company; this will void the Limited Warranties
- Tires, wheel alignment and tire balancing.
- Adjustments as part of normal preventive maintenance such as hinges / door latches and hardware
- Components and installations other than those specified and approved by **Demers Ambulances**
- Batteries; batteries are covered by their respective OEM manufacturer.
- Programs, updates and/or software used by and for upgrade of equipment such as, but not limited to: GPS, AVL, Data recorder, mapping system, driver behavior, etc. Support and Warranty coverage beyond that of Demers Ambulances, for such equipment is to be provided by their Original Equipment Manufacturer.

3. STEPS YOU MUST FOLLOW IN ORDER TO OBTAIN WARRANTY SERVICE

To obtain warranty service, you must:

1. First contact the authorized **DEMERS AMBULANCES DEALER** from whom you purchased your vehicle, or contact a **Demers Ambulances** Warranty Service Representative directly:

1-800-363-7591 (toll free - U.S.)
info@demers-ambulances.com

- Have all pertinent information ready for the representative (using warranty claim form), including:
 - Vehicle make and model (Ford E350, GM Express, etc.);
 - **Demers Ambulances** model (MX164; MX170: EXE : LT2E : etc.);
 - **Demers Ambulances** stock number (located in the driver B pillar);
 - VIN (Vehicle Identification Number);
 - Date of delivery;
 - In Service Date;
 - Current mileage;
 - And any other pertinent information associated with the purchase of your ambulance.
- 2. To be eligible for any warranty service, you or your dealer (whichever applies) must send the warranty claim form (via fax; email or regular mail) found in your Owner's Manual with the proper information within 30 days of failure.
- 3. Your warranty replacement parts will be sent as soon as possible. Defective parts must be returned to your **Demers Ambulances DEALER** within 30 days of shipment of the replacement part. If the defective part is received within the required 30 day period, and is confirmed as being defective by **Demers Ambulances** technical personnel, there will be no charge to you. **Demers Ambulances will cover parts repair and shipping.**

NOTE

If the claimed defective part or the claim form is not received by your **Demers Ambulances DEALER** within 30 days of shipment of the warranty replacement part, or if the part is determined not to be defective, your **Demers Ambulances DEALER** will invoice you for the entire cost, plus shipping and handling, for the replacement part. It is your responsibility to return the claimed defective part to your **Demers Ambulances DEALER** within 30 days of receipt of the replacement part in order to avoid being invoiced for the replacement part.

4. All approved warranty work must be completed by a **Demers Ambulances** authorized service center.
5. Your dealer may need to obtain authorization from **Demers Ambulances** for major work to be completed. Please do not take it upon yourself to make arrangements for the completion of warranty work. By doing so, and without the appropriate approval from a **Demers Ambulances** Warranty Service representative, you may VOID your warranty and/or be responsible for the total cost of the service repair.
6. If you have any questions concerning **Demers Ambulances'** warranty policies, please contact a **Demers Ambulances** Warranty Service representative.



DEMERS AMBULANCES LIMITED WARRANTIES

1. MODULAR BODY STRUCTURE LIMITED LIFETIME WARRANTY

WHAT IS COVERED?

Demers Ambulances hereby warrants to each original owner of a **Demers Ambulance** that, under normal use and service, each new **Demers Ambulances Modular Body Structure** (exclusive of paint finish, hardware, mouldings, windows and other components and accessories) shall be structurally sound and free of all structural defects of both material and workmanship, under normal use and service and further warrants that it will maintain such structural integrity for a period of **TWENTY FIVE (25) YEARS**. The obligations of **Demers Ambulances** under this warranty is limited to repairing and replacing, at its sole discretion, any component as a whole or any part related to the Modular Body Structure. Parts may be replaced with refurbished parts of like kind and quantity. Thereof which shall be returned with transportation charges prepaid to an authorized **Demers Ambulances** Service Center or dealer, and which examination shall disclose to have been defective, except as hereinafter provided. Service will be provided during normal business hours.

In the event that a modular body remount by the original owner is performed prior to the expiration of the original Modular Body Structure Limited Warranty, The Modular Body Structure Limited Warranty shall remain in effect provided the remount work is completed by **Demers Ambulances** personnel or a facility approved by **Demers Ambulances**.

Should repairs become necessary under the term of this warranty, the extent of that repair shall be determined solely by **Demers Ambulances** and shall be performed solely by **Demers Ambulances** or a repair facility designated by **Demers Ambulances**.

This warranty is conditioned upon:

- normal use and proper maintenance of such modular body;
- prompt written notice of any defects submitted to **Demers Ambulances** or one of its authorized dealers in the area;
- no alteration or additions to the modular structure except by **Demers Ambulances** or authorized by it;

If any of such conditions are not complied with, this warranty shall become void and unenforceable.

WHAT IS NOT COVERED?

The following items are specifically excluded from the **Demers Ambulances** Modular Body Structure Limited Warranty:

- All paint, striping, hardware, hinges, latches, mouldings, windows, appointments and accessories;
- Any and all structural damage resulting from any form of accident or operator negligence.
- Any and all structural damage resulting from unmaintained galvanic corrosion.
- Any and all structural damage resulting from unmaintained oxidation.
- The expense of any transportation to or from a repair facility.
- Any defect resulting from misuse, negligence, accident, remounting, overloading beyond applicable weight rating by customer or third parties.

2. MODULAR BODY PAINT LIMITED WARRANTY 5 YEARS / 180 000 MILES

WHAT IS COVERED?

Demers Ambulances hereby warrants to each original owner of a **Demers Ambulance**, that under normal use and service, each new **Demers Ambulances Modular Body Paintwork** provided by **Demers Ambulances or a Demers Ambulances PAINT & COATING ACCREDITED MANUFACTURER and/or SERVICE SUPPLIER** shall be free from defects of both material and workmanship, and further warrants that it will maintain such integrity for a period of **FIVE (5) YEARS or 180 000 miles**, whichever occurs first. The obligations of **Demers Ambulances** under this warranty is limited to repairing and replacing, at its sole discretion, any component as a whole or any part related to the **Demers Ambulances Modular Body Paintwork**. Parts may be replaced with refurbished parts of like kind and quantity. Thereof which shall be returned with transportation charges prepaid to an authorized **Demers Ambulances** service center or dealer, and which examination shall disclose to have been defective except as hereinafter provided. Service will be provided during normal business hours.

The following paint failures are covered:

- Peeling or delaminating of the topcoat and/or other layers of paint
- Cracking or checking
- Loss of gloss caused by cracking, checking, and hazing
- Any paint failure caused by defective paint or paint curing process at **Demers Ambulances** or **Demers Ambulances Accredited** paint service supplier.

WHAT IS NOT COVERED?

The following items are specifically excluded from the **Demers Ambulances Modular Body Paint Limited Warranty**:

- Hazing, chalking, or loss of gloss caused by improper care, abrasive polishes, cleaning agents, heavy duty pressure washing, or aggressive mechanical wash systems
- Paint deterioration caused by abuse, accidents, acid rain, chemical fallout or acts of nature
- Accidents, scratches, chips, bruises, and gloss reduction due to normal vehicle use and maintenance
- Custom finishes, exotic finishes or any other finish than standard refinish procedure
- Failures resulting from product misuse or abuse
- Repairs done to previously refinished areas unless stripped to bare metal or appropriate substrate
- Failures on finishes performed by **Non-Demers Ambulances Service Center**
- Paint failures resulting from improper application of striping, tapes, decals or custom painted designs / numerals.
- Defects resulting from normal and customary wear as a result of operating the vehicle.
- The expense of any transportation to or from a repair facility.

Should repairs become necessary under the term of this warranty, the extent of that repair shall be determined solely by **Demers Ambulances** and shall be performed by **Demers Ambulances** or a repair facility designated by **Demers Ambulances**.

3. ELECTRICAL LIMITED WARRANTY 5 YEARS / 180 000 MILES

WHAT IS COVERED?

Demers Ambulances hereby warrants to each original owner of a **Demers Ambulance** that, under normal use and service, each new **Demers Ambulances Electrical System** shall be free from defects of both materials and workmanship, and further warrants that it will maintain such integrity for a period of **FIVE (5) YEARS or 180 000 MILES**, whichever occurs first. The obligations of **Demers Ambulances** under this warranty is limited to repairing and replacing, at its sole discretion, any component as a whole or any part related to the **Demers Ambulances Electrical System**. Parts may be replaced with refurbished parts of like kind and quantity. Thereof which shall be returned with transportation charges prepaid to an authorized **Demers Ambulances** service center or dealer, and which examination shall disclose to have been defective except as hereinafter provided. Service will be provided during normal business hours.

Should repairs become necessary under the terms of this warranty, the extent of that repair shall be determined solely by **Demers Ambulances** and shall be performed solely by **Demers Ambulances** or a repair facility designated by **Demers Ambulances**.

Items specifically covered under the **Demers Ambulances** Electrical Warranty include:

- Electrical harnesses and harness installation
- Printed circuit board(s)
- Switches, timers, outlets
- Circuit breakers and relays
- Shoreline

WHAT IS NOT COVERED?

The following items are specifically excluded from the **DEMERS** Ambulances Electrical Limited Warranty:

- OEM electrical systems and components
- Equipment not manufactured by **DEMERS** Ambulances but which are installed by **DEMERS** Ambulances personnel. These items include, but are not limited to, the following: battery chargers; sirens; inverters; light bars and similar OEM equipment. These excluded items are typically covered by separate warranties supplied by **DEMERS** Ambulances and/or the OEM manufacturer of the component.
- Periodic tightening and cleaning of connection terminals as this is considered routine maintenance
- Defects arising from abuse, accident, negligence or unapproved alteration of original parts or systems.
- The expense of any transportation to or from a repair facility.

**DEMERS AMBULANCES MATERIALS AND WORKMANSHIP
LIMITED WARRANTY
5 YEARS / 180 000 MILES**

WHAT IS COVERED?

Demers Ambulances hereby warrants to each original owner of a **Demers Ambulance** that, under normal use and service, each new **Demers Ambulances Materials and Workmanship**, shall be free from defects and further warrants that it will maintain such integrity for a period of **FIVE (5) YEARS or 180 000 MILES**, whichever occurs first. The obligations of **Demers Ambulances** under this warranty is limited to repairing and replacing, at its sole discretion, any part or materials related to the **Demers Ambulances Supplied Parts and Materials**. Parts may be replaced with refurbished parts of like kind and quantity. Thereof which shall be returned with transportation charges prepaid to an authorized **Demers Ambulances** distributor or dealer, and which examination shall disclose to have been defective except as hereinafter provided. Service will be provided during normal business hours.

Should repairs become necessary under the terms of this warranty, the extent of that repair shall be determined solely by **Demers Ambulances** and shall be performed solely by **Demers Ambulances** or a repair facility designated by **Demers Ambulances**.

WHAT IS NOT COVERED?

The following items are specifically excluded from the **Demers Ambulances** Features Limited Warranty:

- Chassis, OEM body structure, engine, interior or any other items supplied by chassis manufacturer (see chassis manufacturer's warranties)
- Any required maintenance adjustment, general tightening or headlamps adjustments
- Normal wear, or defects arising from abuse, accident, negligence or unapproved alteration of original parts or systems.
- The expense of any transportation to or from a repair facility.

4. OEM MATERIALS AND WORKMANSHIP ORIGINALLY ASSEMBLED BY OTHER THAN DEMERS AMBULANCES LIMITED WARRANTY 2 YEARS / 75 000 MILES

WHAT IS COVERED?

Demers Ambulances hereby warrants to each original owner of a **Demers Ambulances** body that, under normal use and service, each new **OEM Materials And Workmanship Originally Assembled By OTHER Than Demers Ambulances**, shall be free from defects and further warrants that it will maintain such integrity for a period of **TWO (2) YEARS or 75 000 MILES**, whichever occurs first. The obligations of **Demers Ambulances** under this warranty is limited to repairing and replacing, at its sole discretion, any component as a whole or any part related to the **OEM Parts And Materials originally assembled by OTHER than Demers Ambulances**. Parts may be replaced with refurbished parts of like kind and quantity. Thereof which shall be returned with transportation charges prepaid to an authorized **Demers Ambulances** distributor or dealer, and which examination shall disclose to have been defective except as hereinafter provided. Service will be provided during normal business hours.

These items include, but are not limited to, the following: battery chargers; sirens; inverters; light bars; fluorescent ballasts; door handles & latches; gas cylinders; laptops; laptop mounts; docking stations; actuators and similar OEM equipment. These items are typically covered by separate warranties supplied by the OEM manufacturer of the component. When necessary, **Demers Ambulances** Customer Assistance personnel will assist you in pursuing warranty assistance with the OEM manufacturers of these components, should their stated warranty be in excess of the basic **Demers Ambulances** warranty

Should repairs become necessary under the terms of this warranty, the extent of that repair shall be determined solely by **Demers Ambulances** and shall be performed solely by **Demers Ambulances** or a repair facility designated by **Demers Ambulances**.

WHAT IS NOT COVERED?

The following items are specifically excluded from the **Demers Ambulances** Features Limited Warranty :

- Chassis, OEM body structure, engine, interior or any other items supplied by chassis manufacturer (see chassis manufacturer's warranties)
- Any required maintenance adjustment, general tightening or headlamps adjustments
- Normal wear, or defects arising from abuse, accident, negligence or unapproved alteration of original parts.
- The expense of any transportation to or from a repair facility.



DEMERS AMBULANCES

RECEIPT AND ACKNOWLEDGMENT OF LIMITED WARRANTIES

DELAY WARRANTY REGISTRATION

The undersigned acknowledges receipt and understanding of DEMERS AMBULANCES Modular Body Structure Limited Warranty, Modular Body Paint Limited Warranty, Electrical Limited Warranty, Demers Ambulances Materials And Workmanship Limited Warranty and OEM Materials And Workmanship Originally Assembled By Other Than Demers Ambulances Limited Warranty. These Limited Warranties have been reviewed in detail and I understand the policies and procedures outlined in each warranty.

Accepted and agreed to this day of _____.

OWNER INFORMATION

Name : _____

Address : _____

Phone Number: _____

Representative Name : _____

Representative Email Address: _____

Representative Signature : _____

DEALERSHIP INFORMATION

Name : _____

Address : _____

Phone Number: _____

Dealership Representative : _____

Representative Email Address: _____

Dealership Signature : _____

VEHICLE INFORMATION

Vehicle Identification Number (VIN): _____

Demers Ambulance Vehicle Stock Number: _____

Date of delivery: _____

Mileage on the vehicle at date of delivery: _____

WARRANTY SHOULD BE ACTIVATED WITHIN 24HRS OF DELIVERY
Please fill and return to:
Fax.: 450-467-6526 or dchatelle@demers-ambulances.com



Warranty claim form

F-5.02e

Rev. : 1

1	Vehicle serial number (V.I.N) (Number on dash, driver's side)	
----------	---	--

2	Fleet unit number		3	Demers stock number	
----------	-------------------	--	----------	---------------------	--

4	Date in service (YY/MM/DD)		5	Milles / Miles	
----------	----------------------------	--	----------	----------------	--

6	Date of failure (YY/MM/DD)		7	Date of warranty claim	
----------	----------------------------	--	----------	------------------------	--

8	Description of the issue

9	Cause(s) of the issue

10	Corrective(s) action(s)

11	Estimated repair time	
-----------	-----------------------	--

12	Claim requested by		13	Invoice N°	
-----------	--------------------	--	-----------	------------	--

14	Billing address
Phone:	

15	Shipping address
Phone:	

Part N°	QTY	DESCRIPTION

DEMERS RESERVED SECTION

1. Warranty claim authorization no. :	<input style="width: 90%;" type="text"/>
2. Time allowed for repairs :	<input style="width: 90%;" type="text"/>
3. Warranty claim authorization date :	<input style="width: 90%;" type="text"/>