

## **DS-K4G100**

### **Electric Strike Lock**

The electric strike lock is designed for wooden door, metal door, and PVC door. It can work depending on the thrust or pull producing by the electromagnetism.



### **Available Model**

DS-K4G100

### **Key Feature**

- Fail-secure and fail-safe selectable
- Material of latch: US304 stainless steel  
Material of plate: wire-drawing on the surface
- The magnetic lock supports static linear thrust of 800 kg (1764 lb)
- 100,000 times usage of the electromagnetic coil when powering on
- Depth of the latch groove: 15 mm
- Strong suction which protects the door from forced opening when the door is locked
- Double insulation



## Specifications

Model	DS-K4G100
Dimension of lock body (L × W × H)	165 mm × 43.7 mm × 35 mm (6.5" × 1.7" × 1.4")
Material of latch	Stainless steel
Maximum thrust	800 kg (1764 lb)
Input voltage	12 VDC, 320 mA/24 VDC, 160 mA ± 15%
Signal Output	Dry contact signal output; NO output while locking and NC output while unlocking
Suitable door	Wooden door, metal door, PVC door
Working temperature	-10 °C to 55 °C (14 °F to 131 °F)
Working humidity	0 to 95% (non-condensing)
Weight	0.4 kg (0.9 lb)

## Dimension

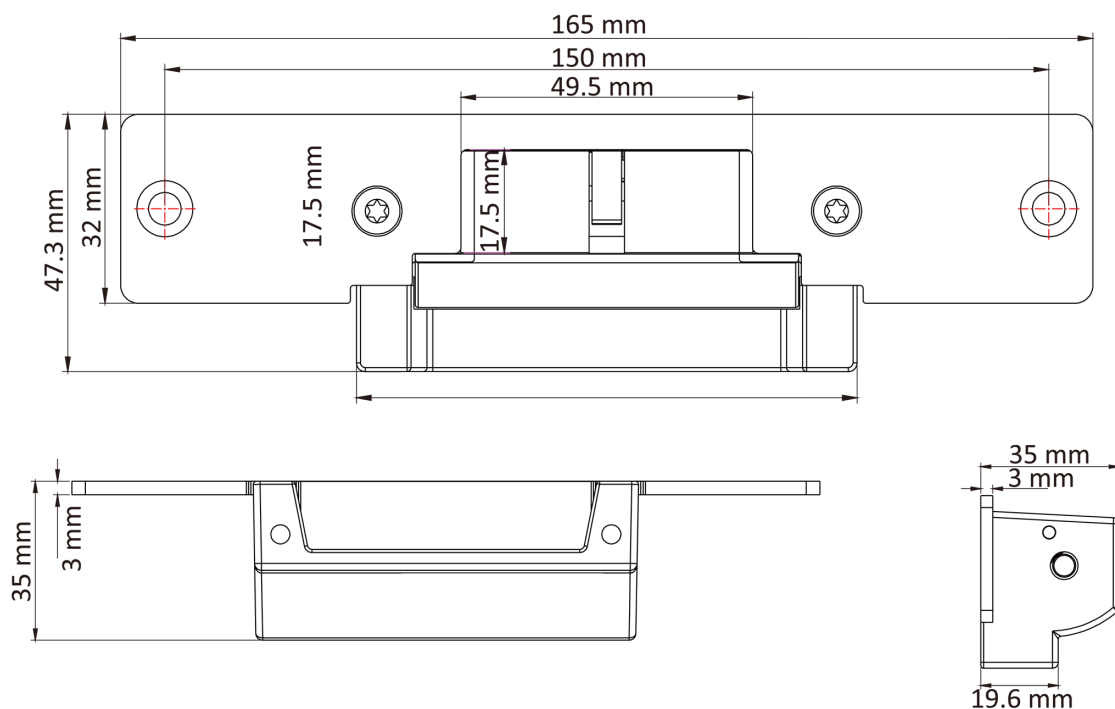

## Circuit Board Diagram

COLOR	5-PIN
Red	+
Black	-
White	COM
Yellow	NC
Green	NO

