

# DR. PHILLIPS CENTER FOR THE PERFORMING ARTS

SPECIAL EVENTS & MEETINGS



## HOME TO THE ARTS. DESIGNED TO INSPIRE. THIS IS WHERE EVENTS SHINE.

A premier events destination and performing arts venue in the heart of downtown Orlando, Dr. Phillips Center for the Performing Arts offers unique and unparalleled event possibilities.

From our iconic rooftop space to our award-winning theaters to our sweeping floor-to-ceiling windows, our spaces transcend the expected. No matter the size of your event, you'll experience world-class production in every detail from our creative in-house events team along with our stellar full-service, on-site food & beverage team.

**Let's make it happen.**

- Flexible spaces for grand or intimate events
- Full-service, in-house culinary team
- Dedicated meeting & event team
- Production & A/V services
- 300+ shows annually, from Broadway to concerts

# FULL VENUE

## Planning & Coordination

- Your Event Manager will coordinate all venue logistics, including but not limited to vendor access, food & beverage operations, venue staffing, etc.
- Event timelines, deliveries, floorplans, and vendor arrival schedules will be finalized in advance.

## Included Event Staffing/Services

- Ushers will assist with wayfinding and guest support.
- Security personnel monitor entry points and maintain a safe environment for the duration of your event.
- Additional staffing may be added based on event complexity or at the discretion of our operations team – including Orlando Police Department (OPD) officers, EMTs, or other specialized personnel as needed.

## Outside Catering

- All food and beverage must be provided by our exclusive in-house catering team.
- Customized menus and premium upgrades are available.

## Vendors

- Outside vendors are welcome for services such as décor, entertainment, florals, etc.
  - A Certificate of Insurance (COI) is required for each vendor and must be submitted in advance.
- A preferred vendor list is available.

## Parking

- Multiple public garages and surface lots within walking distance. Recommended garages:
  - City Commons Garage – 460 Boone Avenue
  - Administration Center Garage – 300 Liberty Avenue
- Parking fees are not included in your rental and must be coordinated directly with the garage operator if you wish to cover guest parking or offer validations.

## Wi-Fi & Internet Access

- Complimentary Wi-Fi available throughout building.
- Most event spaces include Access Points (APs) and 50/50 hardline ports
- Custom SSID networks, password-protected Wi-Fi, and hardline drops available for an additional fee

## Loading Dock Access

- Address: 480 Rosalind Avenue, Orlando FL 32801
- Load-in/load-out must be scheduled through your Event Manager.
- Access to freight elevators is available as needed

## Valet Services

- Available upon request. Additional charges apply and subject to availability.

## Off-site Hotel Options

- Grand Bohemian Orlando (Autograph Collection)  
325 S Orange Avenue ~0.09 mi (steps away)
- Aloft Orlando Downtown  
500 S Orange Avenue ~0.1–0.19 mi (~2–4 min walk)
- Embassy Suites by Hilton Orlando Downtown  
191 E Pine Street ~0.2 mi (~3–5 min walk)
- AC Hotel by Marriott Orlando Downtown  
333 S Garland Avenue ~0.2 mi (~4 min walk)
- Marriott Orlando  
400 W Livingston St 1.3 mi (7 min drive)

# FRONTYARD & SENEFF ARTS PLAZA

Make The City Beautiful your backdrop at our outdoor space located in front of the arts center.

Surrounded by palm trees and city views, the Frontyard including Seneff Arts Plaza hosts everything from big cocktail receptions to day-long festivals.

## Ideal for:

- Outside receptions
- Large-scale events & facades
- Festivals

## Square Footage

- 100,000 sq. ft.

## Location

- Directly in front of the arts center, with Seneff Arts Plaza being the center of the three parcels.



# DELLA PHILLIPS GRAND LOBBY



## MAKE THE HEART OF THE ARTS CENTER YOUR EVENT BACKDROP

Located at the foot of the Dr. Phillips Center signature, custom-lit wave wall, the Della Phillips Grand Lobby provides an epic and versatile setting. With its open-air continuity, this space boasts flexibility for evolving plans and any number of guests.

### Ideal for:

- Cocktail receptions
- Pre-function mingling
- Dinners
- Exhibitors

### Location

- Tier 1



TIER 4

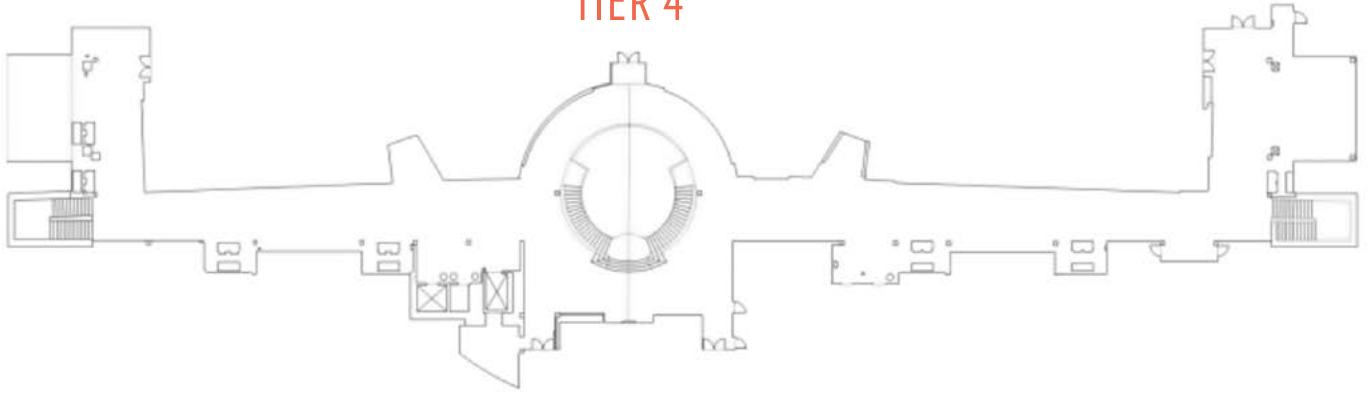

TIER 3

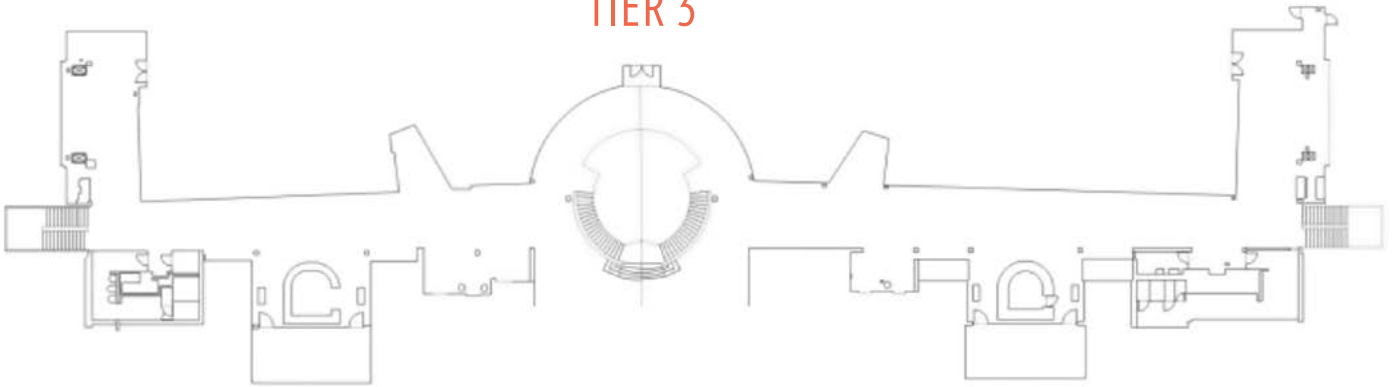

TIER 2

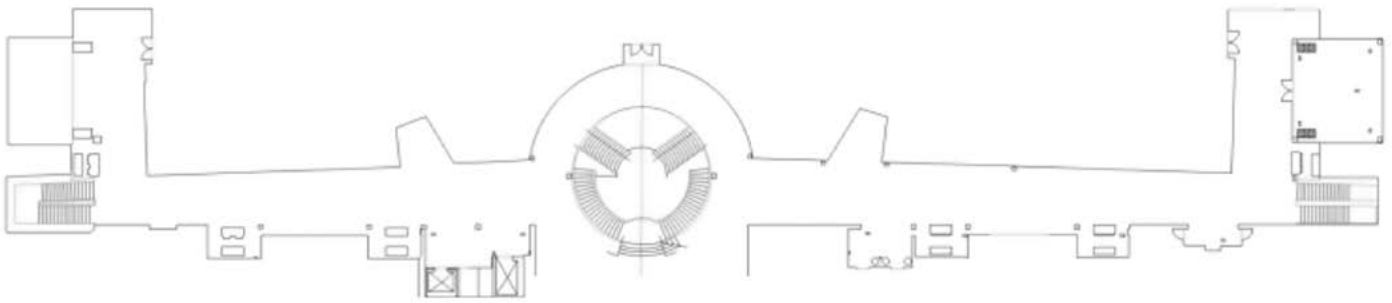

DELLA PHILLIPS GRAND LOBBY / TIER 1

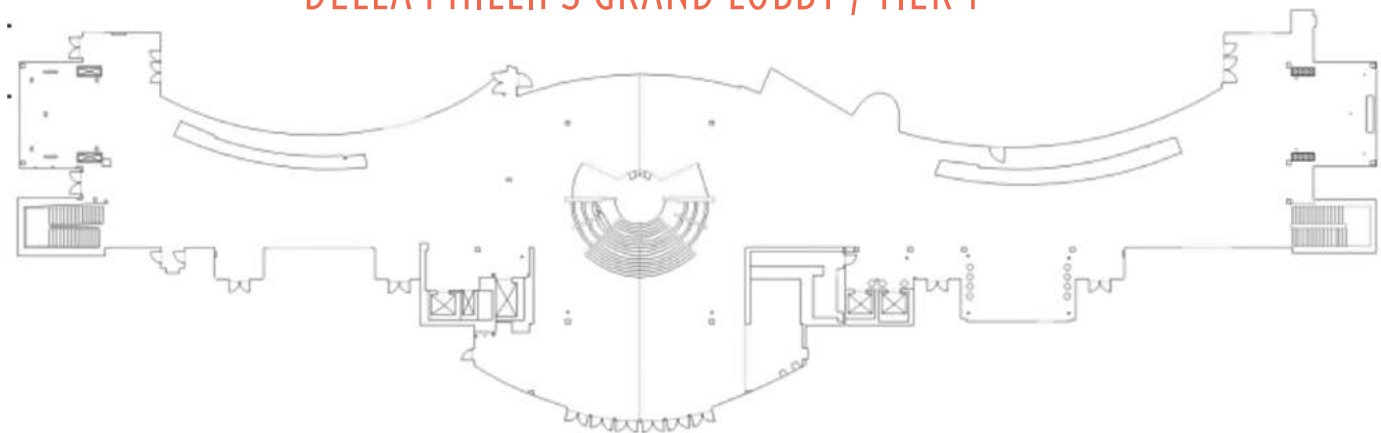

# WALT DISNEY THEATER



## GATHER WHERE THE STARS COME TO SHINE

Hosting everything from Broadway shows and rock legends to award ceremonies and conferences, our largest theater offers the best experience in sight and sound. This space boasts a striking tiered seating, providing an intimacy unmatched in Central Florida for gatherings.

### Ideal for:

- Large-scale award ceremonies
- Corporate events & presentations
- Corporate keynote & general session
- Private concerts & entertainment nights
- National conferences with multi-tiered seating needs
- Dinners or receptions on the stage

### Square Footage

- Stage: 3,000 sq. ft.

### Location

- Located within the Dr. Phillips Center, Walt Disney Theater is accessible via the main entrance on Magnolia Avenue. It offers guest entry on Levels 1 through 4, with tiered access to orchestra, mezzanine, balcony, and upper balcony levels.
- Rental also includes use of the Della Phillips Grand Lobby directly outside the theater doors.  
Ideal for:
  - Pre-event receptions, breakout conversations, registration and check-in, coffee breaks or buffets and exhibitor tables or sponsor activations

# DETAILS

## Restrooms

- Located on multiple levels of the venue, accessible by elevator or stairs

## Configuration Styles

- Stage level flat floor
- Stage extensions or orchestra pit covers
- Proscenium theater (2,700 fixed seats)

## Stage & Venue Dimensions

- Stage Width: 65 ft (proscenium opening)  
115 ft (wall to wall)
- Stage Depth: 53 ft from plaster line to back wall
- Stage Height to Grid: 90 ft
- Orchestra Pit: Accommodates up to 50 musicians

## Loading Dock Access

- Adjacent with direct access to the stage

## Green Rooms & Dressing Rooms

- Available for talent, staff, etc

## Power Access

- Multiple 400A & 200A company switches
- Isolated audio power
- Dimmer and video drops

## Wi-Fi & Internet Access

- Building-wide public and private Wi-Fi
- Hardline drops upon request
- Custom SSIDs and event-specific bandwidth packages

## Audio Visual & Rigging

- Meyer Sound Constellation® Acoustic System
- Full line array PA system
- 78 line sets, motorized, with 1500–2000 lb load capacities
- Follow spots, lighting booms, side ladders and pipe grids
- In-house and preferred production vendors for full A/V support required
- Integrated projectors, screens, cameras and recording options

# EXAMPLE SEATING ARRANGEMENTS

## Plated - stage level

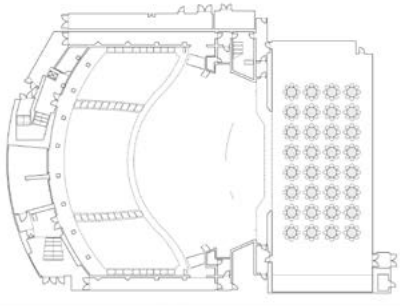

## Reception

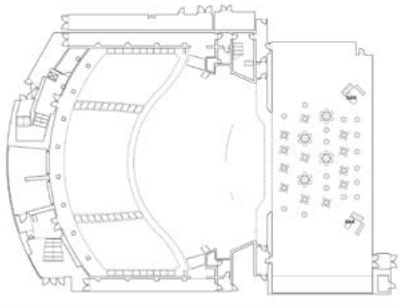

## Existing Theater

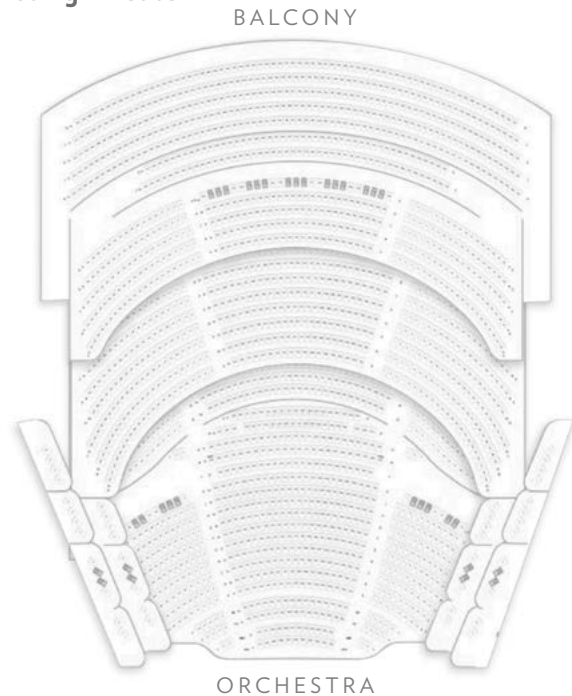

# STEINMETZ HALL



## CUSTOMIZE A WORLD-RENOWNED THEATER

Crowned as one of *Architectural Digest's* "11 Most Beautiful Theaters in the World," the multiform Steinmetz Hall transforms in shape and seating to accommodate everything from high-profile productions to elegant private events and dinners. Designed as an acoustically perfect space with an N1 sound rating, this space boasts sleek, modern architectural design with unobstructed views from every level.

### Ideal for:

- Corporate award ceremonies
- Concerts and film screenings
- Conferences, keynote presentations & panel discussions
- High-end fundraisers & galas
- Exhibition hall

### Square Footage

- House: 4,200 sq. ft.
- Stage: 4,700 sq. ft.

### Location

- Within Dr. Phillips Center, access from the main entrance, Steinmetz Hall features guest access on Levels 1 through 4, with multiple entry points into the theater from every level.
- Rental also includes use of the adjacent Della Phillips Grand Lobby, located directly outside the theater doors.  
Ideal for:
  - Pre-event receptions, breakout conversations, registration and check-in, coffee breaks or buffets and exhibitor tables or sponsor activations

# DETAILS

## Restrooms

- Located on multiple levels of the venue, accessible by elevator or stairs.

## Configuration Styles

- Flat Floor Event Layout (banquet-style available)
- Orchestra Pit & Stage Extensions (small/large)
- Concert Hall
- Proscenium Theater

## Stage Dimensions

- Width: 50 ft (proscenium opening), 148 ft (wall-to-wall)
- Depth: 55 ft from plaster line
- Height to grid: 110 ft

## Flooring

- Oak over sprung semi-floating floor

## Power Access

- Multiple 200A & 400A company switches at stage level and throughout the theater
- Audio power on isolated transformers
- Dedicated video, dimmer and IT drops

## Wi-Fi & Internet Access

- Wi-Fi available throughout Della Phillips Grand Lobby and theaters
- Hardline drops available upon request
- Custom SSIDs and hardline tech support coordinated by in-house team

## Audio Visual & Rigging

- D&B V-Series line array system with delay and fill for multi-tiered seating
- Multiple soundboard mix positions: enclosed booth, orchestra, terrace
- 83 rigging line sets with motorized options
- Extensive lighting grid with over 650 dimmers and full front of house lighting
- In-house video and recording packages available

## Rigging Grid & Line Sets

- 110 ft grid height
- 83 line sets (6 and 12 inches on center)
- 2,000 lb max load per batten
- Additional chain motors and lighting booms available

# EXAMPLE SEATING ARRANGEMENTS

Plated - flat floor

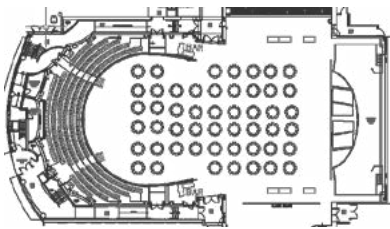

Plated - flat floor, mixed seating

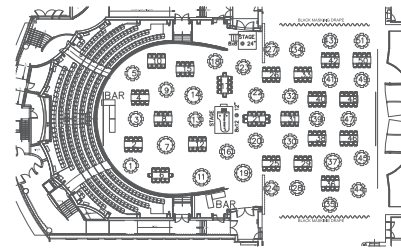

Plated - concert

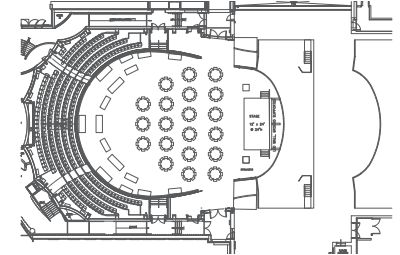

Reception - concert

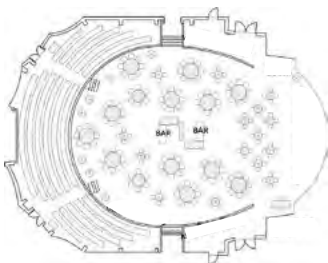

Reception - stage level

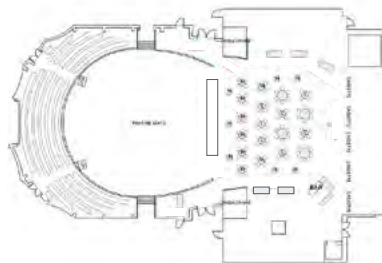

Exhibitions

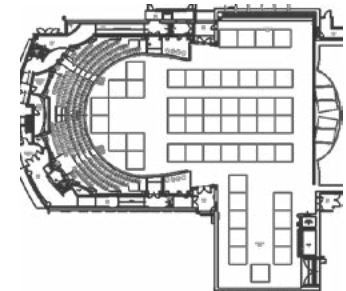

# ALEXIS & JIM PUGH THEATER



## SPARK INSPIRATION IN A COLORFUL & VERSATILE THEATER

Centered with a striking and colorful ceiling installation, this intimate, multi-level theater offers multiple seating and stage configurations. Enjoy perfect acoustics and sightlines for keynote speakers, film screenings and panel discussions, or transform the orchestra level into a flat floor for galas, dinners and receptions.

### Ideal for:

- Keynote presentations
- Film screenings
- Corporate town halls
- Fireside chats
- Award ceremonies
- Intimate concerts & performances
- Theatrical & lecture series
- Plated dinners & receptions

### Square Footage

- Flat floor, House: 1,200 sq. ft.
- Stage: 1,000 sq. ft.

### Location

- Level 2, accessible via elevators, staircases and adjacent to the loading dock

# DETAILS

## Restrooms & Dressing Rooms

- Two 6-person dressing rooms with secure key code access
- Greenroom area
- Restrooms located nearby for guest access

## Ceiling Height

- Up to 36 ft 4 inches to rigging steel
- 32 ft proscenium height

## Stage Dimensions

- Width: 55 ft 10 inches
- Depth: 27 ft
- Proscenium opening: 36 ft wide x 32 ft high

## Flooring

- Semi-sprung stage and orchestra floor with masonite finish

## Power Access

- Multiple power locations: in-floor pockets, stage left/right, upstage, balcony, booth
- K-13 transformer ensures clean audio/video power
- Shore power available for buses/trucks

## Wi-Fi & Internet Access

- Hardline and wireless connectivity available

## Audio Visual & Rigging

- (21) hand-operated line sets under-hung (not a grid system)
- 40 ft battens, 1,000 lb max load per set
- Meyer Sound audio system, Yamaha CL5 FOH console
- Full theatrical lighting system with ETC Ion console, Source 4 fixtures and followspots

## Mixing Positions

- Control booth (rear of third level)
- House mix (orchestra level, 11-seat hold required)

# EXAMPLE SEATING ARRANGEMENTS

Plated - rounds, stage level

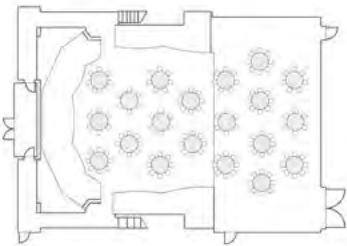

Plated - rounds, orchestra level

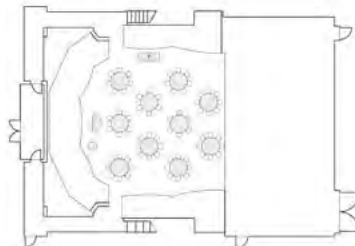

King's Tables - stage level

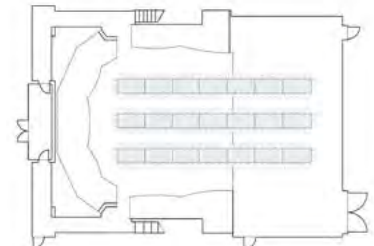

King's Table - orchestra level

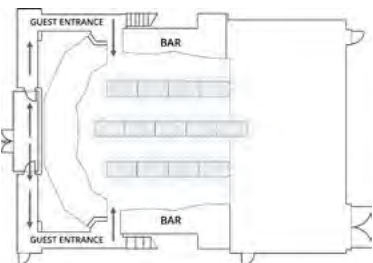

Reception

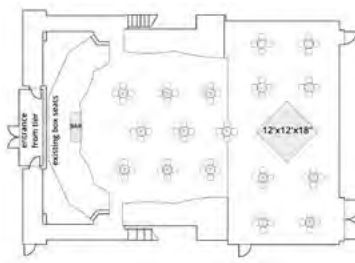

Existing Theater

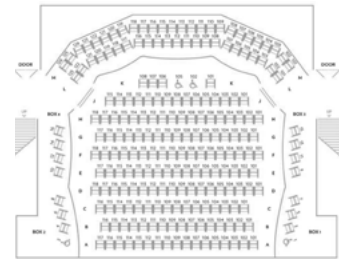

# JUDSON'S LIVE



## ELEVATE ANY EVENT IN AN INTIMATE MUSIC LOUNGE

Inspired by the great jazz clubs of New York City and beyond, this venue offers the perfect blend of elevated atmosphere, fine dining and live performance capability. From networking events and meetings to corporate receptions and dinners, inspire your guests in the art center's artistic oasis.

### Ideal for:

- Corporate receptions & dinners
- Intimate concerts & showcases
- Client entertainment
- Private parties & celebrations
- Cocktail-style networking events
- Fireside chats, panels & discussions
- Cultural & nonprofit gatherings

### Square Footage

- House, without furniture: 1,500 sq. ft.
- Stage: 375 sq. ft.

### Location

- Ground floor of Dr. Phillips Center; accessible via the main entrance or the north side entry off Rosalind Avenue and South Street

### Capacity & Layout

- Table/cabaret style seating for up to 150 guests; flexible layout for seated dinners, receptions and live performances

## DETAILS

### Restrooms & Green Room

- Dedicated backstage support and access for performers

### Ceiling Height

- Approx. 20 ft
- Intimate with acoustics optimized for live performance
  - Non-rigging environment designed as a listening room rather than theatrical fly space

### Power Access

- Multiple power access points throughout the room
- Infrastructure designed to support both live music and event needs

### Wi-Fi & Internet Access

- Hardline and wireless connectivity available

### Audio Visual & Rigging

- Fully integrated world-class sound system designed for intimate, high-quality performances
  - Steinway piano (on site)
  - Yamaha custom drum kit
  - 19th-century upright bass
- Professional-grade lighting system designed for both performances and private events
- Video and projection capabilities for presentations or ambient visuals

### Mixing Positions

- Dedicated in-room control booth with professional front of house setup

## EXAMPLE SEATING ARRANGEMENT

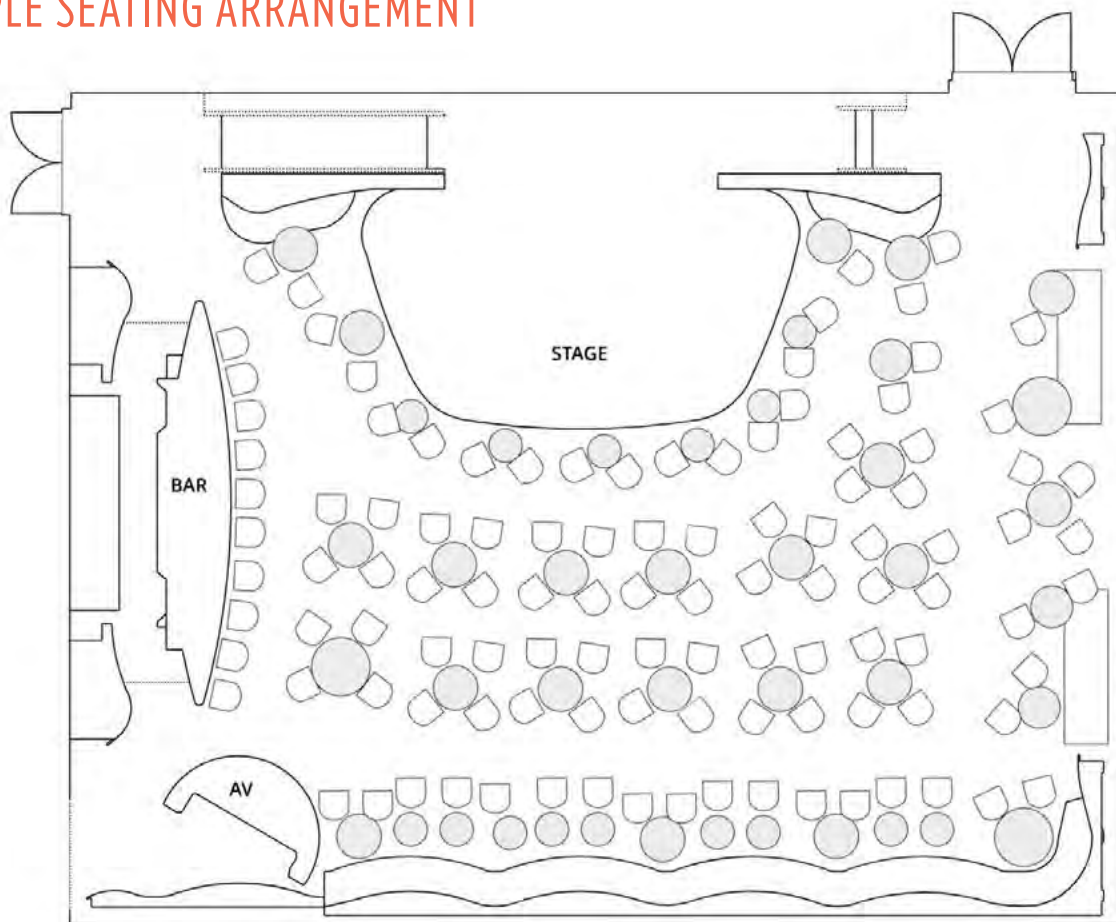

# DEVOS FAMILY ROOM

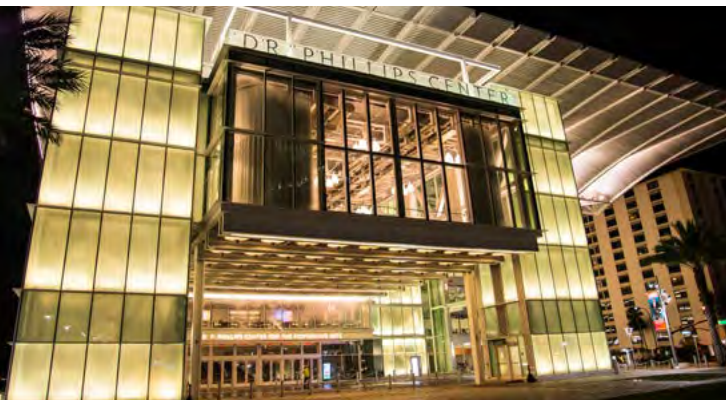

## CITY ENERGY IN A MODERN, AIRY SPACE

Offering spectacular views of downtown Orlando, our DeVos Family Room features windows on three sides and magnificent sliding glass doors to let the outdoors in. From pre-function mingling to station-style service to sit-down plated dinners,, the room's clean, neutral design and minimal fixed obstructions provide a comfortable flow for any event.

### Ideal for:

- Awards Dinners
- Luncheons
- Fundraising Galas
- Networking Events
- Exhibitors
- Parties

### Square Footage

- 4,500 sq. ft.

### Location

- Level 3, accessible via 5 elevators and the Grand Staircase

# DETAILS

## Restrooms

- Located directly outside of the room

## Ceiling Height

- 20 ft.

## Flooring

- Neutral-toned carpet

## Windows & Lighting

- Expansive floor-to-ceiling glass windows with panoramic skyline views
- Motorized shades for light filtering
- Manually operated drapery panels that can fully cover every window

## Power Access

- Electrical outlets along the perimeter
- Multiple in-floor power ports throughout the space
- Standard voltage options available (details per event)

## Wi-Fi & Internet Access

- (2) Dedicated Access Points (APs) for wireless connectivity
- (6) 50/50 hardline ports available for wired internet
- Custom SSIDs and password-protected networks available (*additional fee*)
- Suitable for live-streaming, hybrid meetings, registration kiosks, etc.

## Audio Visual & Rigging

- Fully equipped with overhead sound system and specialty lighting as part of our in-house a/v packages
- Rigging points throughout ceiling grid. Ideal for:
  - Projection screen installation
  - Fabric treatments, décor, signage, lighting enhancements
- A/V services and rigging available via in-house production team or preferred partners

# EXAMPLE SEATING ARRANGEMENTS

## Plated

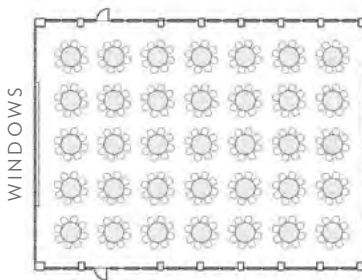

## Plated with Stage

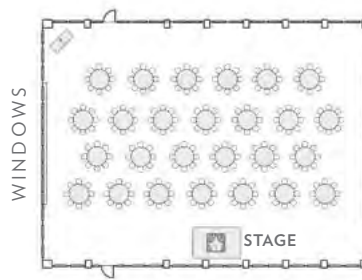

## Plated with Dance Floor

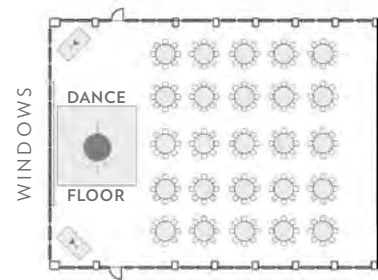

## Reception

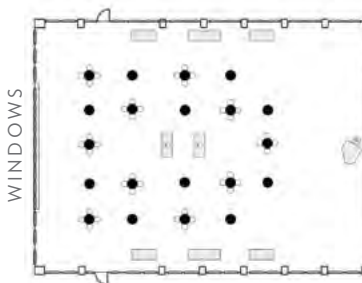

## Theater

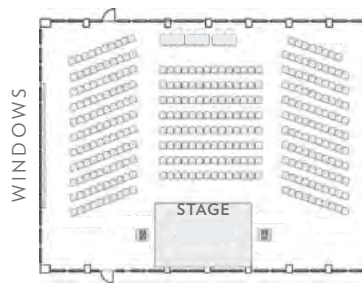

## Exhibitions

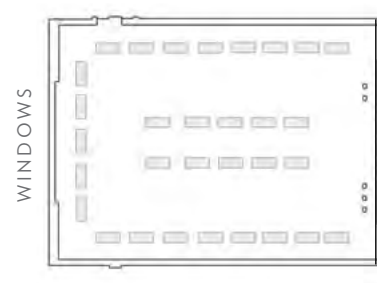

# KESSLER TIER



## FEEL ON TOP OF THE WORLD IN AN ELEVATED ATMOSPHERE

Overlooking our signature wave wall and sweeping cityscape views, this indoor space sits on the highest floor of the arts center with open sightlines and flexible layout options. Complete with a dedicated guest elevator, the Kessler Tier is perfect for receptions, dinners and gatherings.

### Ideal for:

- Cocktail receptions
- Pre-show dining experiences
- Breakout sessions
- Exhibitors
- Luncheons

### Square Footage

- Approx. 3,300 sq. ft.

### Location

- Tier 5 — the top floor of the Dr. Phillips Center, overlooking the iconic Wave Wall

## ROOM DETAILS

### Restrooms

- Located below the Kessler Tier with elevator access

### Flooring

- Neutral-toned carpet

### Windows & Lighting

- Ambient architectural lighting
- Uplighting and enhancements available through in-house production or preferred vendors

### Power Access

- Standard power available along perimeter
- Extension power available upon request

### Wi-Fi & Internet Access

- Wireless internet available for general use
- Hardline drops available with advance notice

## EXAMPLE SEATING ARRANGEMENTS

### Plated

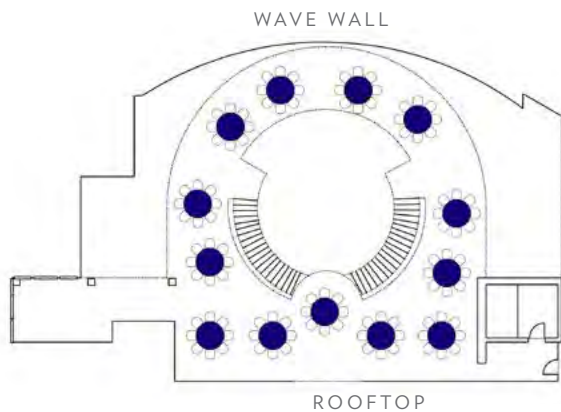

### Reception

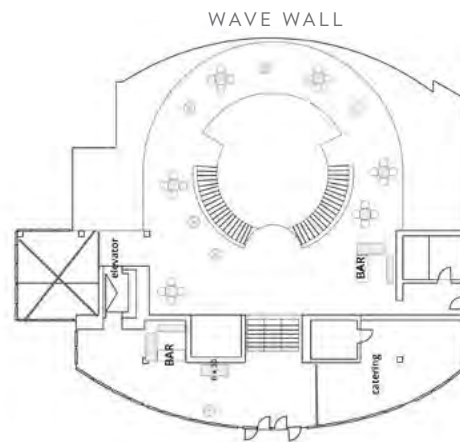

### Breakout

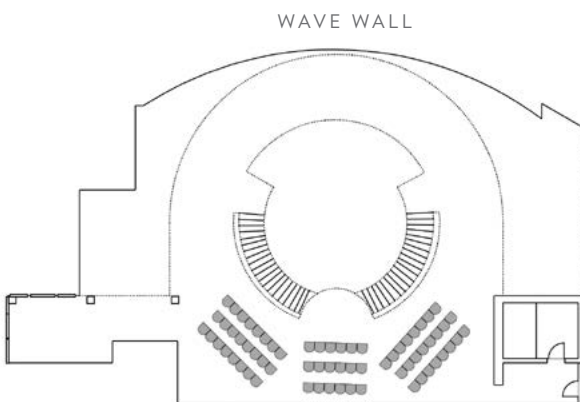

### Exhibitors

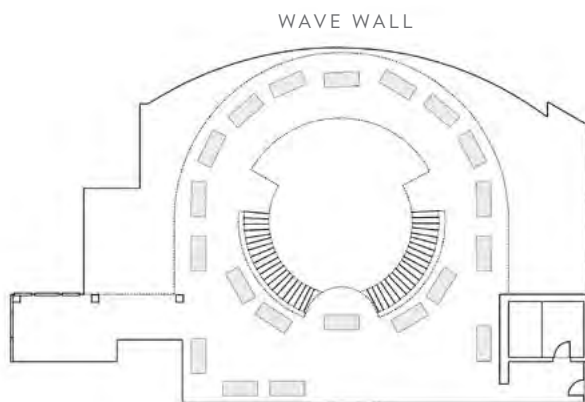

# ROOFTOP TERRACE



## MINGLE ON ONE OF ORLANDO'S LARGEST ROOFTOP EVENT SPACES

Surrounded by panoramic downtown views, the Rooftop Terrace is home to golden hour sunsets and open-air ambiance. Partially covered by our signature canopy roof, this iconic space is perfect for rain or shine moments.

The terrace also includes exclusive access to our Kessler Tier for an indoor lounge, dining area or a contingency space.

### Ideal for:

- Elevated receptions & cocktail parties
- Scenic luncheons
- Sponsor & donor events
- Brand activations & product launches
- Welcoming & Closing Night Events

### Square Footage

- 8,000 sq. ft.
- Rooftop Terrace: ~4,700 sq. ft.
- Kessler Tier (Tier 5, indoor): ~3,300 sq. ft.

### Location

- Top of the Dr. Phillips Center with private access via designated guest elevators and stairwell

# DETAILS

## Restrooms

- Located below the Kessler Tier on Tier 4

## Flooring

- Rooftop Terrace: Paved stone
- Kessler Tier: Carpet

## Windows & Lighting

- Rooftop includes perimeter lighting and event-friendly fixtures

## Power Access

- Rooftop perimeter and lighting zones powered
- Extension power available upon request
- Access to indoor power via Kessler Tier

## Wi-Fi & Internet Access

- Venue-wide Wi-Fi available
- Hardline drops available inside Kessler Tier with advanced coordination

# EXAMPLE SEATING ARRANGEMENTS

## Plated

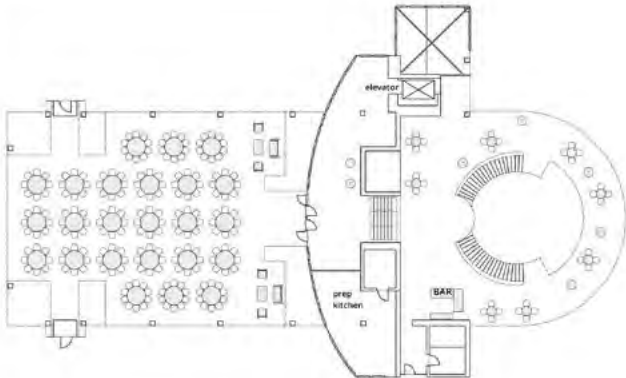

## Reception

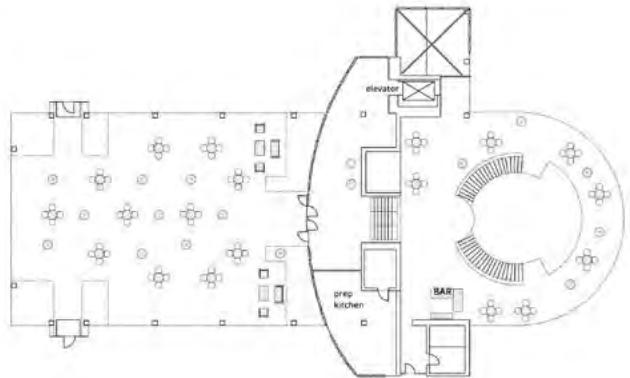

## Rooftop - Reception Plus Kessler Tier - Plated

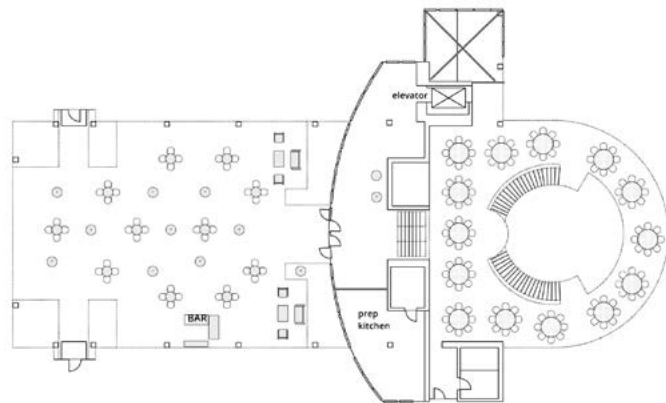

# HOSPITALITY SUITES



## CONVENE IN PRIVATE AND ADAPTABLE SPACES

Flip the script on traditional board room spaces with our multi-purpose suites. Featuring large windows and natural light, these versatile areas can accommodate any kind of group or function, offering several available configurations.

### Ideal for:

- Pre-show receptions
- Board meetings
- Workshops
- Luncheons

### Locations

- BAA Atrium – Tier 1, south side of arts center
- Dan Dantin – Tier 1, north side of arts center
- Tupperware Brands Suite – Tier 2, south side of arts center
- North Hospitality Suite – Tier 2, north side of arts center
- Tier 4

# EXAMPLE SEATING ARRANGEMENTS

BAA Atrium

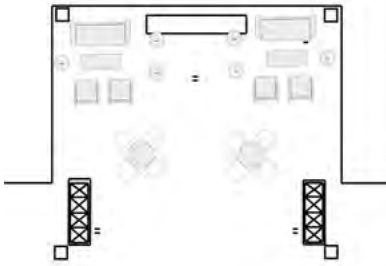

Dan Dantin

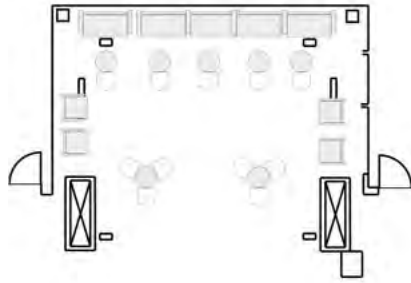

Tupperware Suite

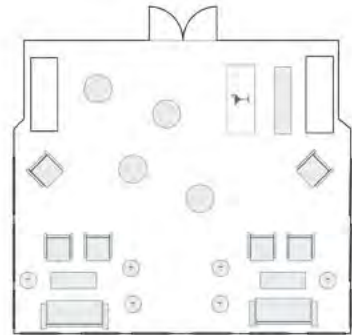

Tupperware Suite - Breakout

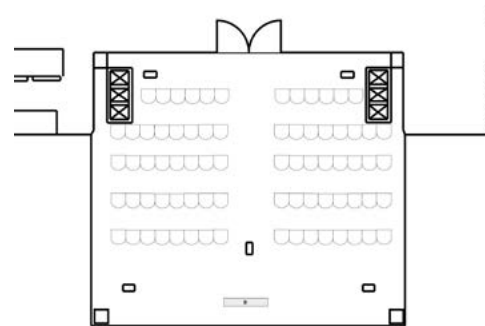

North Hospitality Suite

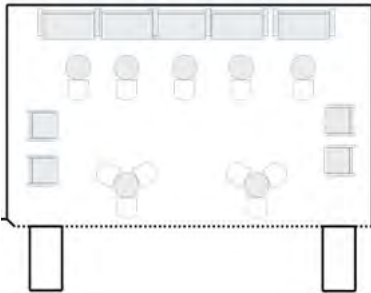

North Hospitality Suite - Breakout

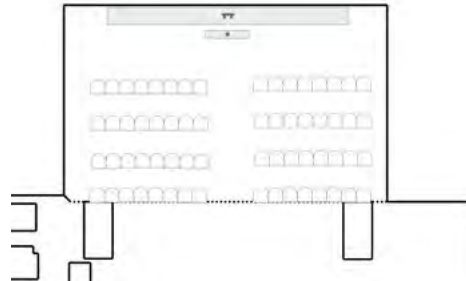

Tier 4 - South Breakout

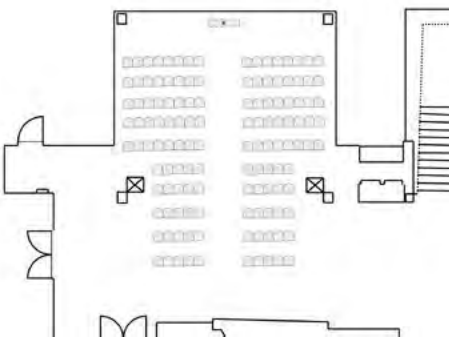

Tier 4 - North Breakout

