

128QVS

QUEEN VICTORIA STREET // EC4

THE BUILDING

Newly refurbished Grade A office accommodation, located conveniently within a 1 minute walk of St Paul's and a 5 minute walk of the vibrant Southbank.





THE ACCOMMODATION

Spaceplan - Open
10,877 sq ft (1,011 sq m)

Core
 WCs
 Office
 Lifts

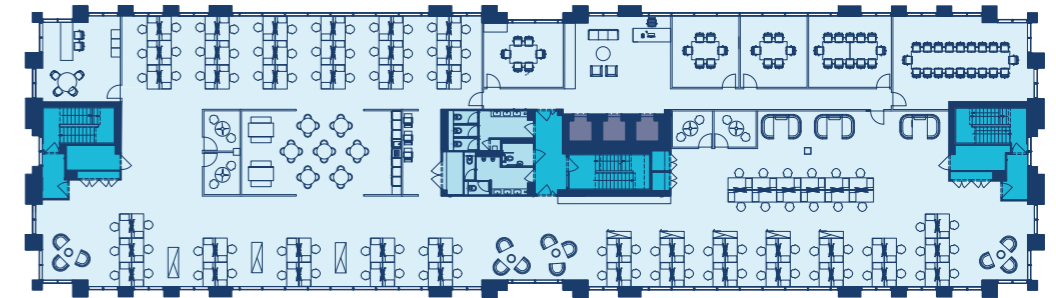

Comms / store room	2	6 person meeting room	3	Informal meeting room	4
20 person board room	1	Office room	1		
12 person meeting room	1	Open plan desks	100		

1st
Let
2nd
10,877 sq ft (1,011 sq m)

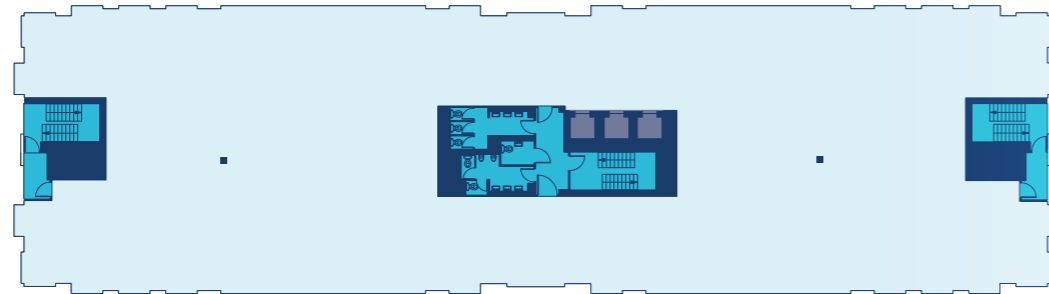

Core
 Lifts
 Office



Spaceplan - Media
10,877 sq ft (1,011 sq m)

Core
 WCs
 Office
 Lifts

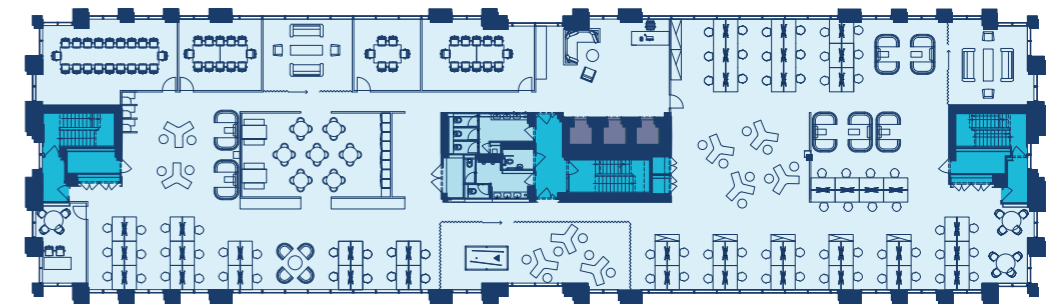

Comms / store room	2	12 person meeting room	2	Office room	1
20 person board room	1	6 person meeting room	1	Open plan desks	77





NEWLY DESIGNED AND REMODELLED RECEPTION



NEW TENANT LOUNGE



NEW BICYCLE STORAGE AND LOCKERS













NEW CHANGING ROOMS



CYCLE ENTRANCE



TYPICAL FLOOR

-  COMPREHENSIVELY REFURBISHED OFFICE FLOORS
-  NEW FOUR-PIPE FAN COIL AIR CONDITIONING
-  NEW CYCLE STORAGE AND SHOWER FACILITIES
-  NEWLY DESIGNED AND REMODELLED RECEPTION AND TENANT LOUNGE
-  BREEAM RATING VERY GOOD
-  NEW HYBRID CEILINGS WITH LED LIGHTING
-  NEW FULLY ACCESSIBLE RAISED FLOORS
-  3 PASSENGER LIFTS
-  EPC RATING - C
-  WIRED SCORE RATING GOLD

TRANSPORT AND CONNECTIVITY

LOCAL TRANSPORT

Mansion House
2 MINS

St. Paul's
3 MINS

Blackfriars
4 MINS

City Thameslink
5 MINS

Cannon Street
5 MINS

Bank
6 MINS

LOCAL AMENITIES

 Fitness First
1 MIN

 Festival Gardens
2 MINS

 Paternoster Sq
4 MINS

 Bow Lane
4 MINS

 One New Change
4 MINS

 Globe Theatre
5 MINS

 Tate Modern
5 MINS

 The Ned
5 MINS

 Oyster Shed
8 MINS

 Mondrian Hotel
10 MINS

 OXO Tower
11 MINS



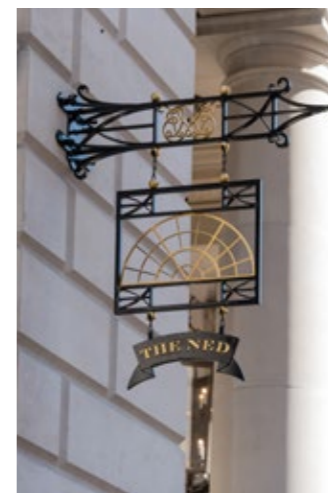
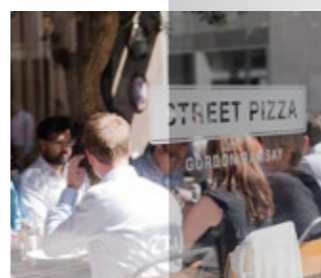
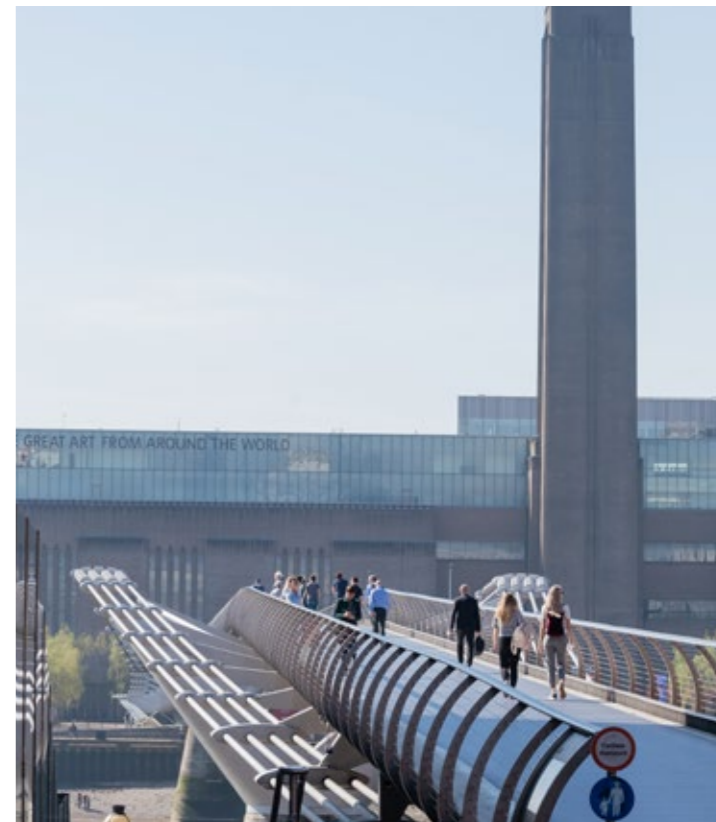

128 QVS

QUEEN VICTORIA STREET // EC4

For more information please contact:



Jamie Nurcombe

020 7456 0712

jn@newtonperkins.com

Chris Sutcliffe

020 7456 0706

crs@newtonperkins.com



Jason Collier

020 7399 5514

jason.collier@eu.jll.com

Sarah Shell

020 7399 5708

sarah.shell@eu.jll.com

JLL and Newton Perkins gives notice to anyone who may read these particulars as follows: 1. These particulars are prepared for the guidance only of prospective purchasers. They are intended to give a fair overall description of the property but are not intended to constitute part of an offer or contract. 2. Any information contained herein (whether in the text, plans or photographs) is given in good faith but should not be relied upon as being a statement or representation of fact. 3. Nothing in these particulars shall be deemed to be a statement that the property is in good condition or otherwise nor that any services or facilities are in good working order. 4. The photographs appearing in this brochure show only certain parts and aspects of the property at the time when the photographs were taken. Certain aspects may have changed since the photographs were taken and it should not be assumed that the property remains precisely as displayed in the photographs. Furthermore no assumptions should be made in respect of parts of the property which are not shown in the photographs. 5. Any areas, measurements or distances referred to herein are approximate only. 6. Where there is reference in these particulars to the fact that alterations have been carried out or that a particular use is made of any part of the property this is not intended to be a statement that any necessary planning, building regulations or other consents have been obtained and these matters must be verified by any intending purchaser. 7. Descriptions of a property are inevitably subjective and the descriptions contained herein are used in good faith as an opinion and not by way of statement of fact. September 2018.