

To Let

Office 0 sq ft NIA

One Angel Court, London, Greater London, EC2R 7EQ



Summary

- Angel Court is a new 300,000 sqft development comprising garden floors with outside space and sky floors with panoramic City views
- Type: Office
- Tenure: To Let
- Size: 0 sq ft NIA
- Rent: Available on Request

Highlights

- Excellent communication links
- Prominent development
- Impressive entrance
- Communal roof gardens
- 360 degree views of Central London
- Communal business lounge / cafeteria
- The Club House (high end business club)

Location

Angel Court is located a short walk from Bank, Moorgate and Liverpool Street stations providing access to the Northern, Central, Hammersmith and City, Waterloo and City, Metropolitan, District and Circle underground lines as well as national rail and crossrail from 2018.

Specifications

- Excellent communication links
- Prominent development
- Impressive entrance
- Communal roof gardens
- 360 degree views of Central London
- Communal business loung/cafeteria
- The Club House (high end business Club)
- Coya, Notes, Natural Kitchen and Temper

Availability

Now.

Terms

A new lease is available directly from the landlord for a term by arrangement.

Viewings

Strictly by appointment by the sole agents.

Amenities

- Floor to ceiling glazing
- Four-pipe fan coil air conditioning
- Raised floors
- Male and female WCs
- Outdoor Space
- Manned reception
- Cycle spaces and lockers
- Showers
- 24 hour access
- Excellent BREEAM Rating

Angel Court Bank

<http://www.angelcourtbank.com>

Energy Performance Rating

This property has been graded as 25(A).

Rent

Available on Request

Business Rates

Rates Payable: £26 per sq ft
Estimated

Service Charge

£10.13 per sq ft

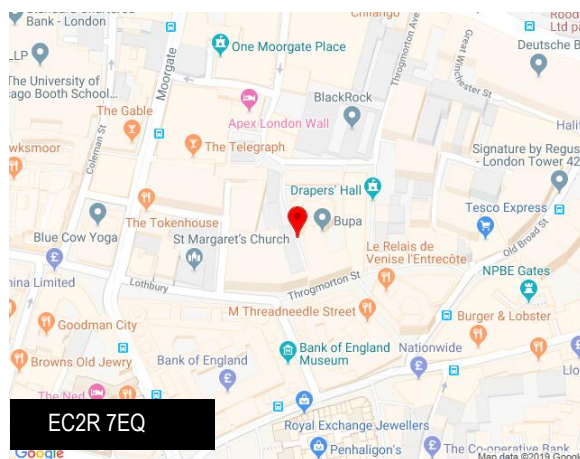

Viewing & Further Information

If you are interested and would like more information please get in touch.

Contacts

Freddie MacGregor

t: +44 (0)207 318 7856

e: Freddie.MacGregor@eu.jll.com

Dan Burn

t: +44 (0)207 399 5966

e: dan.burn@eu.jll.com

Simon Crotty

t: +44 (0)207 852 4230

e: simon.crotty@eu.jll.com

Neil Prime

t: +44 (0)207 399 5190

e: Neil.Prime@eu.jll.com

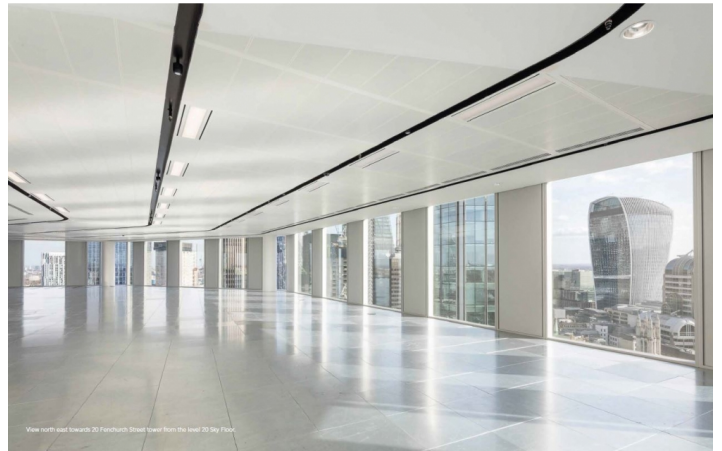

jll.co.uk/property

JLL for themselves and for the vendors or lessors of this property whose agents they are, give notice that:- a. the particulars are set out as a general outline only for guidance and do not constitute, nor constitute part of, an offer or contract; b. all descriptions, dimensions, references to condition and necessary permissions for use and occupation, and other details are believed to be correct, but any intending purchasers, tenants or third parties should not rely on them as statements or representations of fact but satisfy themselves that they are correct by inspection or otherwise; c. All properties are measured in accordance with the RICS property measurement, 1st Edition May 2015 (incorporating IPMS) unless designated NIA/GIA/GEA, in which case properties are measured in accordance with the RICS Code of Measuring Practice (6th Edition); d. Any images may be computer generated. Any photographs show only certain parts of the property as they appeared at the time they were taken.

© 2019 Jones Lang LaSalle IP, Inc. Date: 22/02/19 - one-angel-court_220219_4805.pdf



jll.co.uk/property

JLL for themselves and for the vendors or lessors of this property whose agents they are, give notice that:- a. the particulars are set out as a general outline only for guidance and do not constitute, nor constitute part of, an offer or contract; b. all descriptions, dimensions, references to condition and necessary permissions for use and occupation, and other details are believed to be correct, but any intending purchasers, tenants or third parties should not rely on them as statements or representations of fact but satisfy themselves that they are correct by inspection or otherwise; c. All properties are measured in accordance with the RICS property measurement, 1st Edition May 2015 (incorporating IPMS) unless designated NIA/GIA/GEA, in which case properties are measured in accordance with the RICS Code of Measuring Practice (6th Edition); d. Any images may be computer generated. Any photographs show only certain parts of the property as they appeared at the time they were taken.

© 2019 Jones Lang LaSalle IP, Inc. Date: 22/02/19 - one-angel-court_220219_4805.pdf



jll.co.uk/property

JLL for themselves and for the vendors or lessors of this property whose agents they are, give notice that:- a. the particulars are set out as a general outline only for guidance and do not constitute, nor constitute part of, an offer or contract; b. all descriptions, dimensions, references to condition and necessary permissions for use and occupation, and other details are believed to be correct, but any intending purchasers, tenants or third parties should not rely on them as statements or representations of fact but satisfy themselves that they are correct by inspection or otherwise; c. All properties are measured in accordance with the RICS property measurement, 1st Edition May 2015 (incorporating IPMS) unless designated NIA/GIA/GEA, in which case properties are measured in accordance with the RICS Code of Measuring Practice (6th Edition); d. Any images may be computer generated. Any photographs show only certain parts of the property as they appeared at the time they were taken.

© 2019 Jones Lang LaSalle IP, Inc. Date: 22/02/19 - one-angel-court_220219_4805.pdf

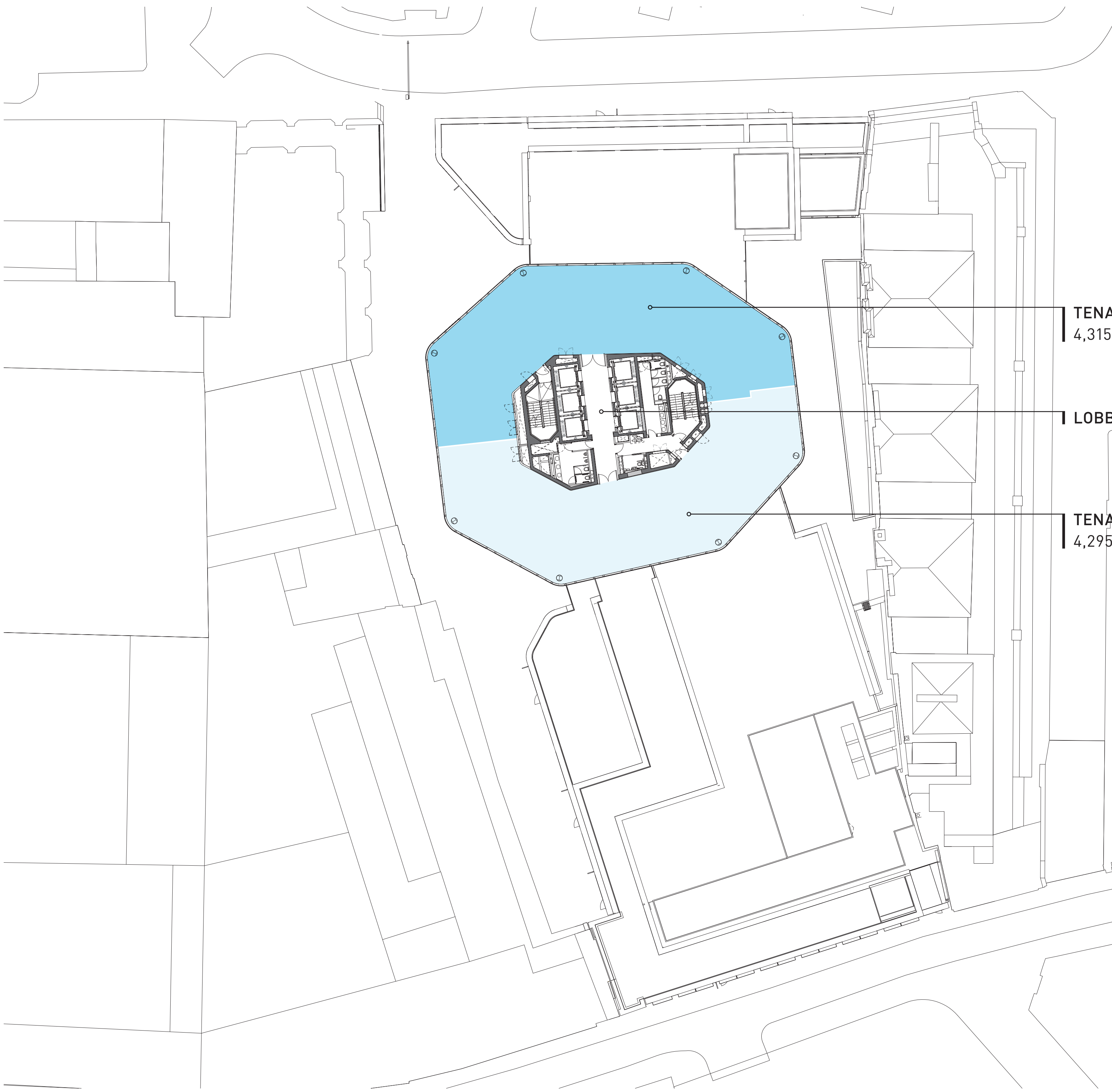

TENANT
4,315

LOBBY

TENANT
4,295