

2. Verify patient identification per your facility protocol and open the FinalCheck lock

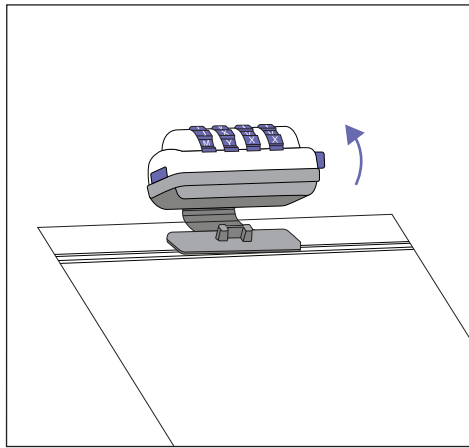
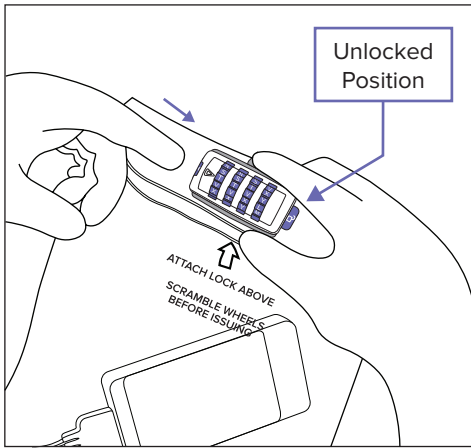

a. Push the slide-bar to the unlocked position. There should be minimal resistance in pushing the slide-bar.

b. Open the lock by gently pulling the lock-plate from the lock body. The lock can be removed from the FinalCheck bag. The FinalCheck bag can now be opened to access the telebox. Conduct any remaining steps per facility protocol.

If the lock cannot be opened with the code entered, the code entered is incorrect.

Do not force the lock open.
Do not cut or tear the FinalCheck bag.

If the lock does not open, there are three primary causes:

- The code was incorrectly set.
- The code was incorrectly entered at the bedside.
- The code was correctly entered at the bedside, but the locked component was not intended for that patient.

Steps to take if the lock does not open:

- Double-check the code you were given is the same as the code entered into the lock.
- Contact the Centralized Telemetry Unit per your facility protocol.

3. Recycle the lock

The FinalCheck lock is made of multiple plastic resins and is categorized as resin code 7 (“Other”) per The American Chemistry Council. Check with appropriate hospital staff to determine if this resin code, and therefore the lock, can be recycled.

FinalCheck[®] Lock

Telemetry

Description of Lock

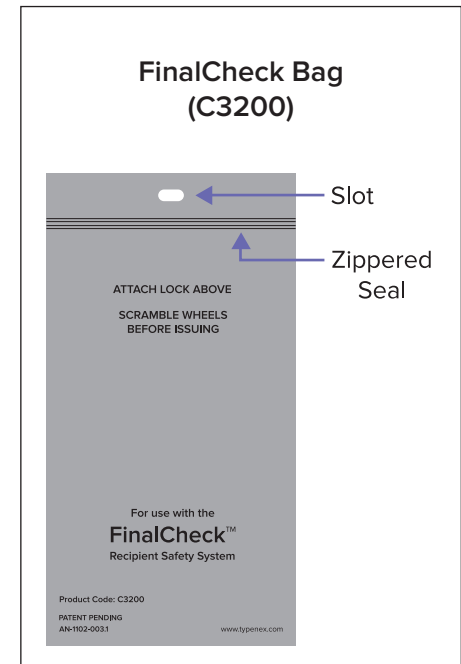
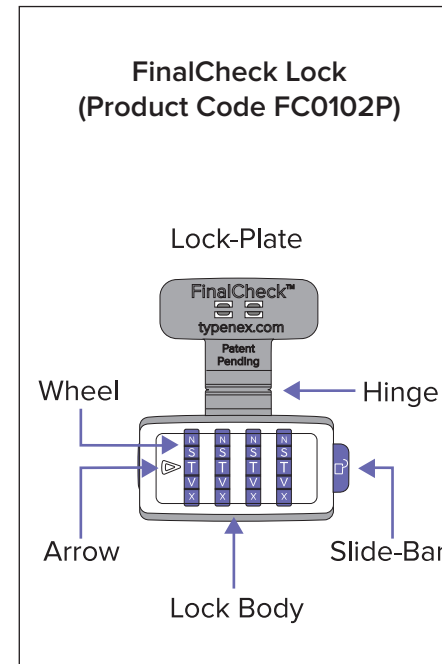

Directions for Use

1. Set the FinalCheck® Lock

- Gather one FinalCheck® lock and one FinalCheck bag.
- Have the code nearby when ready to use the lock.
- Set the FinalCheck lock by following the steps below:

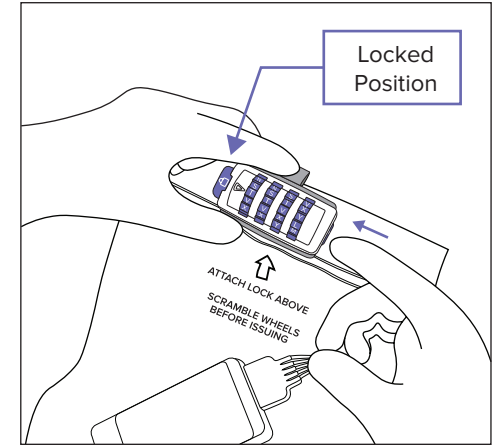
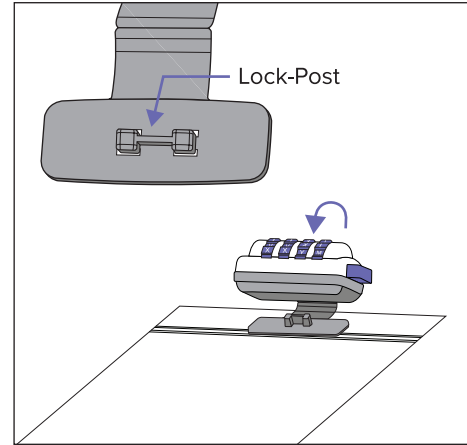
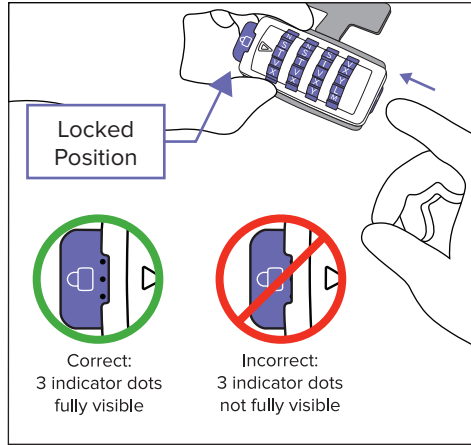
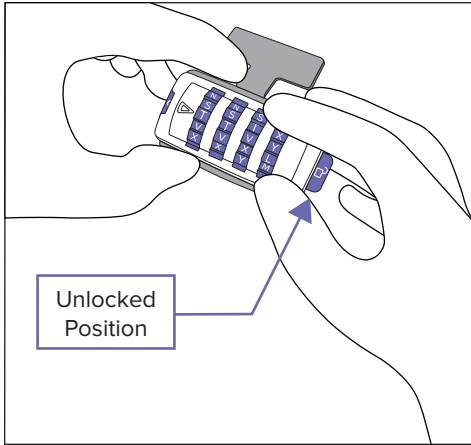

a. With the lock in the unlocked position, carefully enter the code by turning each wheel so the code lines up next to the arrow.

b. Set the lock by pushing the slide-bar to the locked position until the three indicator dots are visible and the slide-bar snaps into position. Be sure the full dots can be seen. At this point the combination has been permanently set for this lock.

e. Seal the zippered bag and insert the lock-post (on lock-plate) into the slot at the top of the bag. Fold the lock over the top of the bag and close the lock.

f. Push the slide-bar to the locked position. Ensure the lock-plate is fully secured in the lock body. Tug slightly at the top of the bag to be sure the lock-plate is secured.

NOTE: If unable to set the code into the lock

- Be sure the lock-plate is not inserted into the lock body while attempting to set the lock.
- Be sure the lock has not already been set with a different combination.
- If the lock still will not set, obtain a new lock. Save the original lock to return to Typenex® Medical for evaluation.

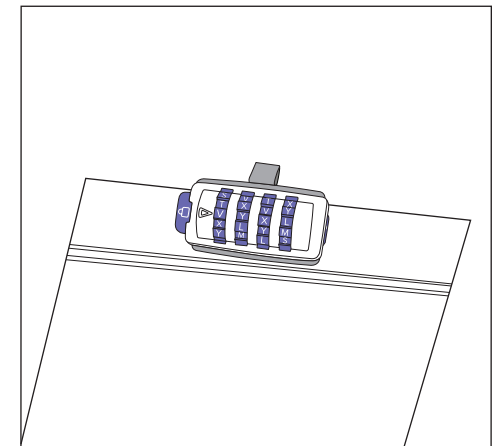
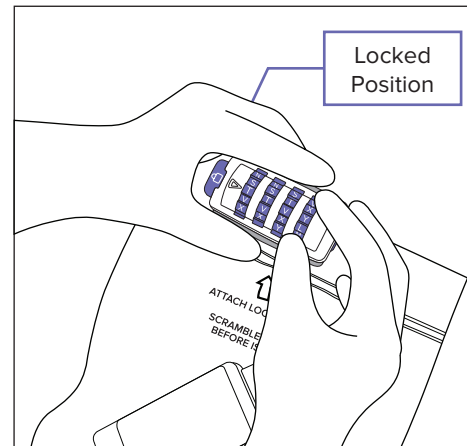
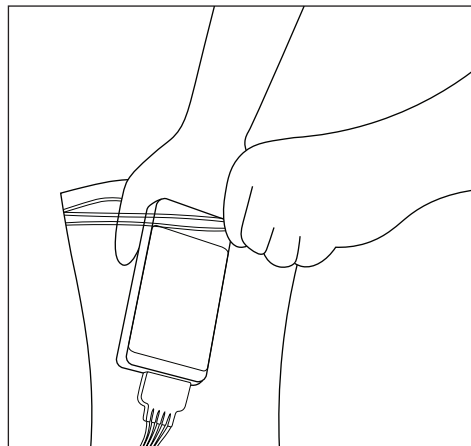
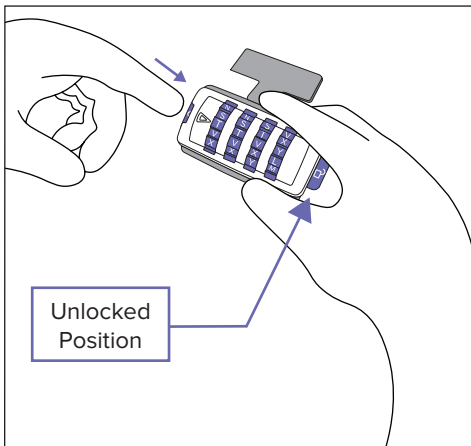

c. Before applying the lock to the bag, push the slide-bar back to the unlocked position. At this point, the wheels on the lock will not turn.

d. Place the telebox with appropriate paperwork into the FinalCheck bag. Squeeze out excess air.

g. **IMPORTANT:** Scramble the wheels.

h. The FinalCheck lock and bag are ready to be issued per facility protocol.