

UHF Bandpass filter

1.2 kW rms, 4 Pole

BAND IV-V

10 year GUARANTEE

PRODUCT FEATURES

- Small size
- Retunable
- Compact design
- Low insertion loss
- Temperature compensated
- Available with cross-coupling
- 10-year comprehensive warranty



SPECIFICATIONS	94 mm Series
FREQUENCY	470 - 862 MHz
BANDWIDTH	6 - 8 MHz
STANDARD ORDER	4 Poles
OPTIONAL ORDER	4 Poles single cross coupling
ATV	Spurious supress
DVB	Spurious supress
ATSC	Non stringent mask
ISDB	Spurious supress
IMPEDANCE	50 Ohm
VSWR	>26 dB (<1.11)
TEMPERATURE STABILITY	< 2 kHz / °C
MAX PRODUCT TEMPERATURE	70 °C
ENVIROMENTAL CONDITION	-5 to 70 °C IP40
STANDARD CONNECTION	1 5/8" unflange (male)
OPTIONAL CONNECTIONS	7/16 m/f, 7/8" unflange

DIMENSIONS AND WEIGHT	
DIMENSIONS	230 x 210 x 250-320 mm
L x W x H	(9 x 8.2 x 9.8-12.5 in)
WEIGHT	5.8 kg (12.8 lb)
STANDARD FRAME	Stand alone
OPTIONAL FRAME	19" subrack
COLOUR	Frosted black

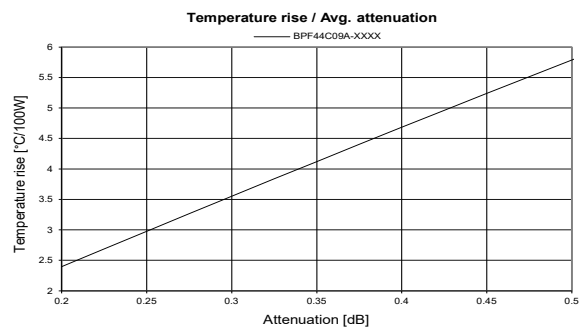
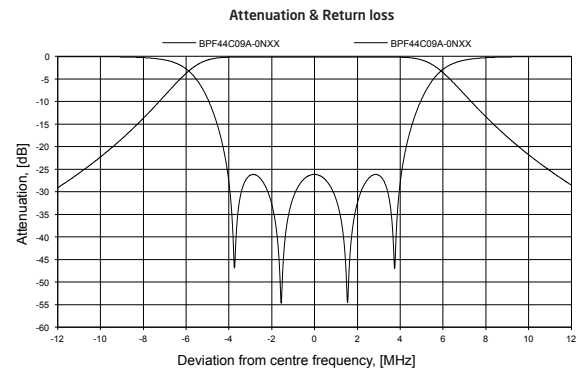
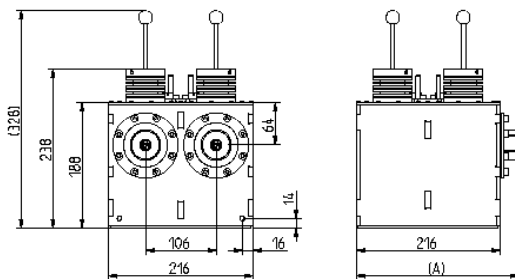

TYPICAL DATA*	8 MHz DVB-T	6 MHz ISDB-T	6 MHz ATSC
ARTICLE NO	BPF44C09A-0PHH	BPF44C09A-0PHH	BPF44C09A-0PHH
INSERTION LOSS			
Avg. signal bandwidth	<0.31 dB	<0.41 dB	<0.36 dB
Centre frequency	<0.31 dB	<0.40 dB	<0.35 dB
Signal band edge	± 3.8 MHz <0.39 dB	± 2.79 MHz <0.50 dB	± 2.69 MHz <0.43 dB
	± 4.2 MHz >0.40 dB	± 3.15 MHz >0.50 dB	± 3.5 MHz >0.47 dB
	± 6.0 MHz >3.50 dB	± 4.5 MHz >3.80 dB	± 6.0 MHz >9.00 dB
	± 12.0 MHz >28.0 dB	± 9.0 MHz >28.0 dB	± 9.0 MHz >24.0 dB
GROUP DELAY	<25 ns	<30 ns	<15 ns
MAX INPUT POWER RATING**	1.2 kW / 13 dB (crest factor)	0.9 kW / 13 dB (crest factor)	1.0 kW / 11 dB (crest factor)
TEMPERATURE RISE	<3.7 °C / 100 W	<4.8 °C / 100 W	<4.2 °C / 100 W
MASK COMPLIANT	Spurious supress	Spurious supress	Non stringent mask

* Data in table is typical data at 665 MHz. To fulfil mask transmitter shoulder level must be >36 dB. The filter can be tuned for other specification or bandwidth, please contact us for a designed specification.
 ** Max input power at <50 °C temprice at max frequency