

Waveguide TRL Calibration Kit

WR

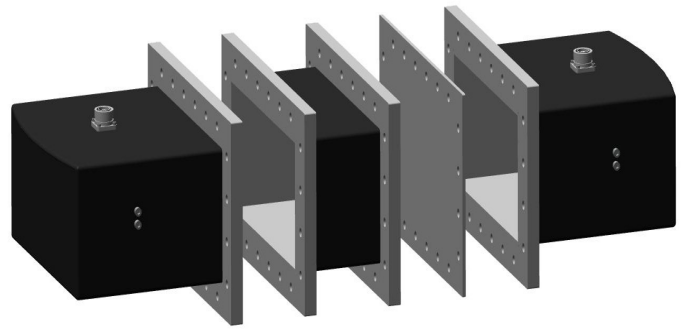

PRODUCT FEATURES

- High quality low-loss aluminium alloy
- Can be optimised to custom requirements
- Standards, RS-271-A, RS-261, IEC 60154-2, IEC 60153-1, 2, MIL-DTL-85K, MIL-DTL-3922D

PRODUCT PROFILE

Exir Broadcasting supplies Waveguide lines of different types. Low-loss aluminium alloys are used to ensure high conductivity.

Exir Broadcastings waveguides fulfill all general standards. It's welded in a welding process with no welding in direction of propagation which yield excellent performance and minimise loss.

More detailed information is available on request.

The calibration kit is a Thru Reflect Line (TRL) two port calibration kit. The kit includes 3 standards to define the calibrated reference plane. Precision waveguide to coaxial adapters are used together with a short circuit plate and a precision $\lambda/4$ waveguide section for the specific calibration frequency span.

This to provide a balanced phase response over the operating frequency range of the waveguide.

Our kits includes:

- 2 pcs of Waveguide to coaxial (N-type or 7/16) adapter
- 1 pcs of 1/4 Lambda waveguide section.
- 1 pcs of shorting plate

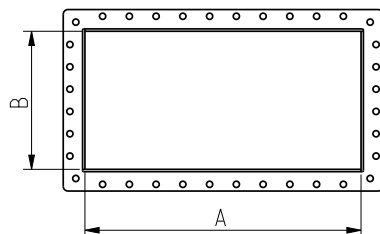

ARTICLE STRUCTURE:

ARTICLE: WR1500-CAL-TRL-A

- WR = Rigid type
- 1500 = Size of line
- CAL = Product typ of calibration kit
- TRL = Type of calibration kit
- A = Version

ARTICLE	WR2300-CAL-TRL-x	WR23HH-CAL-TRL-x	WR1800-CAL-TRL-x	WR1500-CAL-TRL-x	WR1150-CAL-TRL-x	WR650-CAL-TRL-x	
TYPE OF LINE	WR2300 (R3)	WR2300 Half Height	WR1800 (R5)	WR1500 (R6)	WR1150 (R7)	WR650 (R14)	OPTIONS
IEC FREQUENCY	320 - 490 MHz	320 - 490 MHz	410 - 620 MHz	490 - 750 MHz	640 - 980 MHz	1130 - 1730 MHz	
A	584.2 mm	584.2 mm	4572 mm	381.0 mm	292.1 mm	165.1 mm	
B	292.1 mm	146.05 mm	228.6 mm	190.5 mm	146.05 mm	82.55 mm	
WALL THICKNES	5 mm	5 mm	5 mm	5 mm	5 mm	5 mm	
WEIGHT	Approx 50 kg	Approx 42 kg	Approx 38 kg	Approx 35 kg	Approx 16 kg	Approx 10 kg	
MATERIAL	6082-T6	6082-T6	6082-T6	6082-T6	6082-T6	6082-T6	Other on request
COLOUR	Frosted black	Frosted black	Frosted black	Frosted black	Frosted black	Frosted black	Other on request