

OH
SO
CLOSE

PREMIUM APARTMENTS
-
EALING LONDON



THE HEART OF THE CAPITAL A STØNE'S THRØW AWAY

The information in this document is indicative and is intended to act as a guide only as to the finished product. Accordingly, the finished product may vary from the information provided. These particulars should not be relied upon as statements of fact or representations and applicants must satisfy themselves by inspection or otherwise as to their correctness. This information does not constitute a contract or warranty. All computer generated images and lifestyle photography are indicative only.



MINUTES TO THE MAGIC OF THE CITY OF LONDON





BE IT FOR
FINDING LIFE'S
PERFECT BALANCE





OR UNLEASHING
THE POWER OF
PLEASURE
AND CULTURE!



UNLOCK SERENITY MOMENTS FROM CENTRAL LONDON





OH SO CLOSE

PREMIUM APARTMENTS
EALING - LONDON







CULTURE, CØMMUNITY, AND CØNVENIENCE AT YOUR DØØRSTEP

Escape the hustle and bustle of Central London and discover an exclusive oasis in the heart of Ealing, West London with Oh So Close.

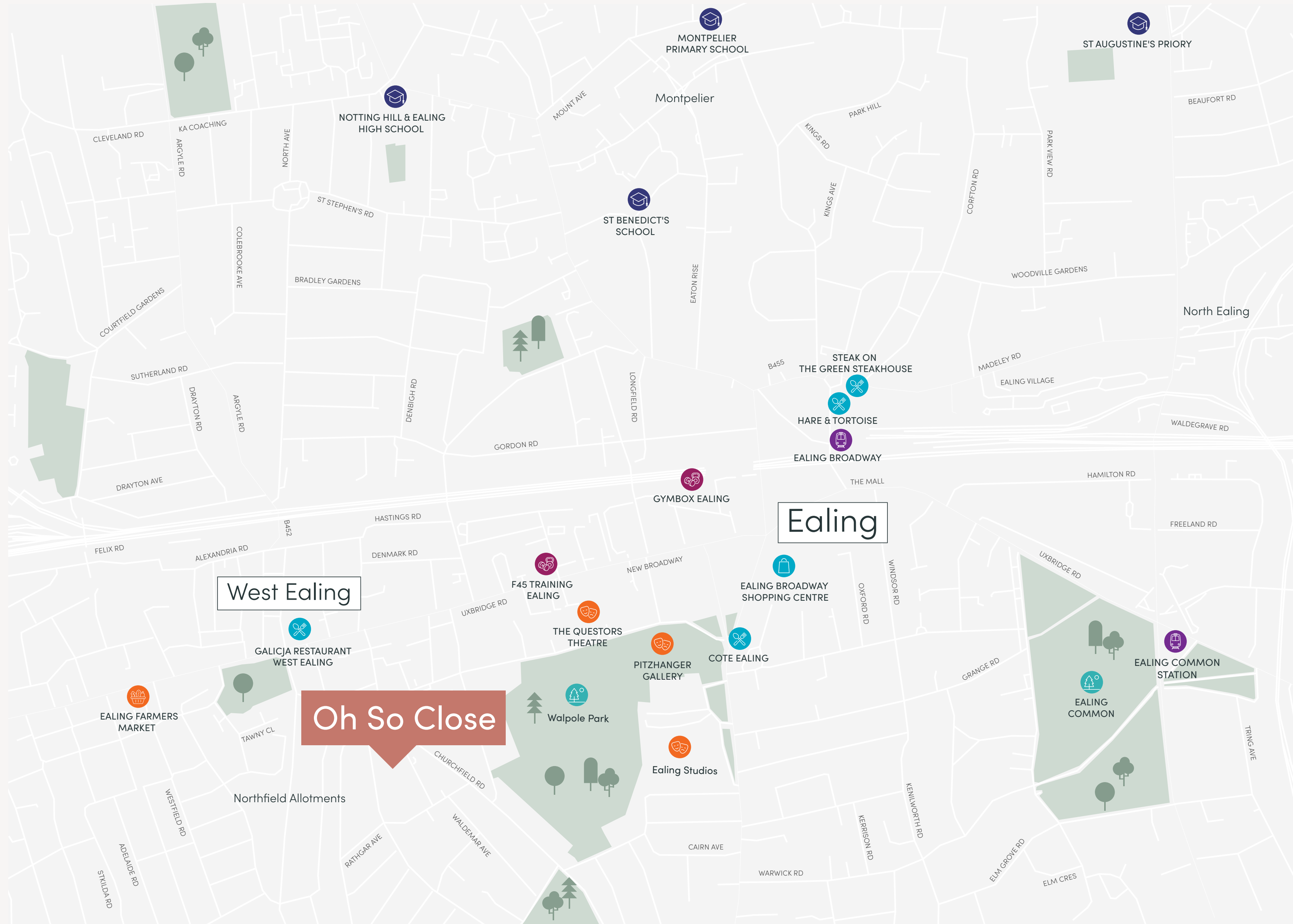

Nestled just steps away from the picturesque Walpole Park and serene Lammas Park, this prestigious property offers the perfect combination of tranquillity and convenience.





TRANSPORTATION

-  Ealing Broadway Station
-  Ealing Common Station





FITNESS

-  Gymbox
-  F45 Training



RESTAURANTS & ENTERTAINMENT

-  Cote
-  Galicja Restaurant
-  Hare & Tortoise
-  Steak on the Green Steakhouse
-  Ealing Broadway shopping centre





CULTURE

-  Ealing Studios
-  Ealing Farmer's Market
-  Pitzhanger Gallery
-  Questors Theatre

GREEN SPACES

-  Ealing Common
-  Walpole Park

SCHOOLS

-  Notting Hill & Ealing High School
-  St Benedict's School
-  St Augustine's Priory
-  Montpelier Primary School



THE VERY ESSENCE OF METRØPØLITAN LIVING

Located just a short distance from Central London, this serene sanctuary offers the perfect balance of convenience and relaxation.



IDYLIC LOCATION TO CALL HOME

With the West Ealing Station just a short 10-minute walk away, Central London becomes effortlessly accessible in just under 20 minutes via the newly opened Elizabeth line. Plus, with easy access to the M4 motorway and excellent transportation options, commuting further into the city has never been easier.

- 
ELIZABETH LINE
 - 8 min LONDON PADDINGTON
 - 12 min HEATHROW AIRPORT
 - 16 min BOND STREET
 - 16 min TOTTENHAM COURT ROAD
- 
CENTRAL LINE
 - 9 min NOTTING HILL GATE
 - 16 min BOND STREET
- 
DISTRICT LINE
 - 28 min SLOANE SQUARE
 - 35 min WESTMINSTER
- 
GREAT WESTERN RAILWAY
 - 11 min LONDON PADDINGTON
 - 40 min READING

A FAST CONNECTION FOR WORK AND PLAY

Welcome to the mesmerizing allure of London, where the world's most charming city center beckons you for business and pleasure. Whether you're a trailblazing entrepreneur, a connoisseur of art and adventure, or a seeker of culinary delights and captivating spectacles, the pulsating vitality and cosmopolitan enchantment of central London awaits your presence.





DISCOVER YOUR
OH SO CLOSE
NEIGHBOURHOOD





Oh So Close welcomes you to an exceptional residential experience that effortlessly combines contemporary aesthetics with the serenity of its green and idyllic surroundings.

**CONVENIENCE
HAS NEVER LOOKED
SØ GOOD**





A NEIGHBORHOOD WITH IT ALL

Ealing, affectionately known as the Queen of the Suburbs, is a true gem in London. Take a stroll down its culturally rich high street and you might just catch a glimpse of a Hollywood star taking a break from filming a hit movie at Ealing Studios, which was home to the award-winning film *Darkest Hour*.



COFFEE DELIGHTS AND FRESH FINDS

If coffee and local produce are your thing, then you'll be thrilled to discover the myriad of hip coffee shops and the vibrant Ealing Farmer's Market just a stone's throw away.





EXPERIENCE THE VIBRANT PULSE OF EALING

With numerous local festivals celebrating everything from jazz to blues, and comedy to beer, there's always something exciting happening in Ealing. And if you're an art enthusiast, you'll love the Pitzhanger Gallery, which showcases the works of up-and-coming artists in stunning Walpole Park, alongside a host of other galleries, museums, and theatres.



EMPOWERING EDUCATION, ENSURING SAFETY

Ealing prioritizes education and safety, making it an ideal place for residents. With a wide range of schools, colleges, and universities, the borough is committed to providing excellent educational opportunities.

Notably, Ealing has earned its reputation as one of the top 20 safest boroughs in London, providing residents with peace of mind and a secure environment.



OH
SO
CLOSE





TIMELESS ELEGANCE AT OH SO CŁOSE

The first thing you notice at Oh So Close is its classic, contemporary exterior, adorned with detailed brick work put down by master craftsmen. A harmonious pair of properties – mirroring each other from the outside – beckons you to indulge in the essence of refined living.

STEP INSIDE THE
APARTMENTS AT
OH SO CLOSE





Inside you'll find living spaces where modern design, deluxe finishes, and a prime location merge effortlessly to create a residential haven that surpasses all expectations.

With opulent fixtures and wood flooring throughout, these spaces enhance your everyday rituals with an unparalleled sense of beauty.

The striking kitchens feature Italian marble worktops, alongside top-of-the-range appliances and integrated lighting, to give a modern, yet homely aesthetic.







A SEAMLESS CONNECTION TO NATURE

The lower ground apartments are beautifully designed with spacious living areas and luxurious finishes. From the living room, you can enjoy the tranquil view of the private garden right outside your door, creating a serene atmosphere.





A DEVELOPMENT BY

DAR
GLOBAL



MOUNTBATTEN
HOMES

MAKE OH SO CLOSE YOUR HOME

Experience the ideal blend of suburban living and city conveniences with Oh So Close. Nestled within a vibrant community, this exclusive neighborhood boasts exceptional amenities and quick access to the world's greatest capital. Don't miss out on the chance to immerse yourself in this unparalleled lifestyle.

Welcome to Oh So Close.

darglobal.co.uk/oh-so-close/



FLOOR PLANS

Disclaimer: All pictures, plans, layouts, information, data and details included in this brochure are indicative only and may change at any time up to the final 'as built' status in accordance with final designs of the project, regulatory approvals and planning permissions. All accessories and interior finishes such as wallpaper, chandeliers, furniture, electronics, white goods, curtains, hard and soft landscaping, pavements, features, gym, swimming pool(s) and other elements displayed in the brochure, or between the plot boundary and the unit, are not part of the unit and are shown for illustrative purposes only.

OH SO CLOSE



1 Bedroom



2 Bedrooms



2 Bedrooms Duplex



3 Bedrooms



3 Bedrooms Duplex

Disclaimer: All pictures, plans, layouts, information, data and details included in this brochure are indicative only and may change at any time up to the final 'as built' status in accordance with final designs of the project, regulatory approvals and planning permissions. All accessories and interior finishes such as wallpaper, chandeliers, furniture, electronics, white goods, curtains, hard and soft landscaping, pavements, features, gym, swimming pool(s) and other elements displayed in the brochure, or within the show apartment or between the plot boundary and the unit, are not part of the unit and are shown for illustrative purposes only.

LOWER GROUND

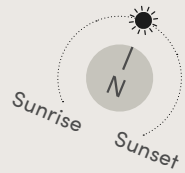
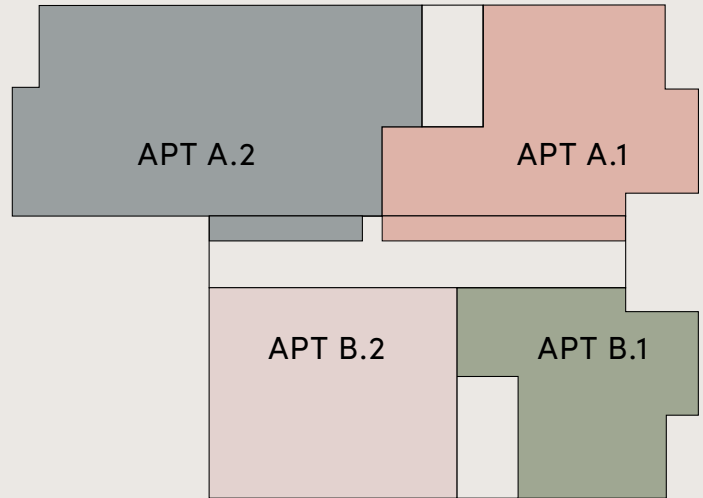

Apt no	Bedrooms	Gross Internal Area
A.1	3 Duplex	1,258 sq ft / 116.9 sq m
A.2	3	1,016 sq ft / 94.4 sq m
B.1	2 Duplex	1,031 sq ft / 95.8 sq m
B.2	1	648 sq ft / 60.2 sq m

GROUND FLOOR

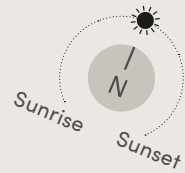
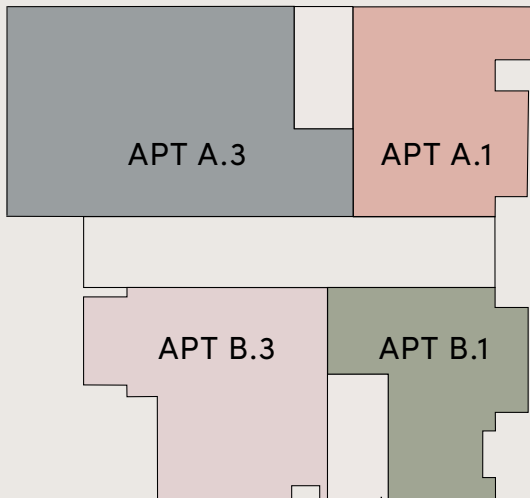

Apt no	Bedrooms	Gross Internal Area
A.1	-	-
A.3	3	927 sq ft / 86.1 sq m
B.1	-	-
B.3	1	565 sq ft / 52.5 sq m

FIRST FLOOR

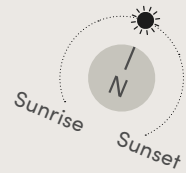
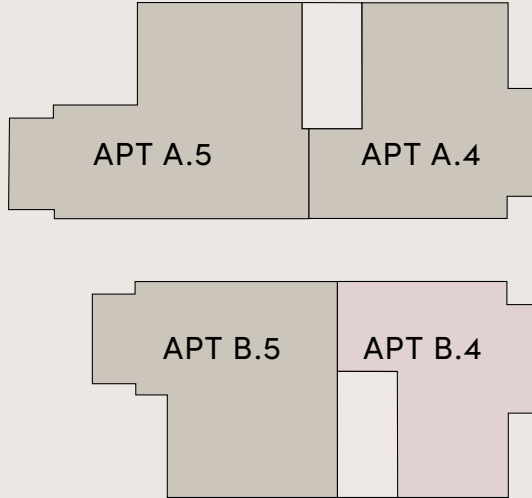

Apt no	Bedrooms	Gross Internal Area
A.4	2	647 sq ft / 60.1 sq m
A.5	2	747 sq ft / 69.4 sq m
B.4	1	527 sq ft / 49 sq m
B.5	2	654 sq ft / 60.8 sq m

SECOND FLOOR

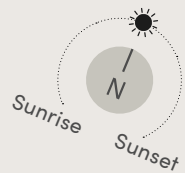
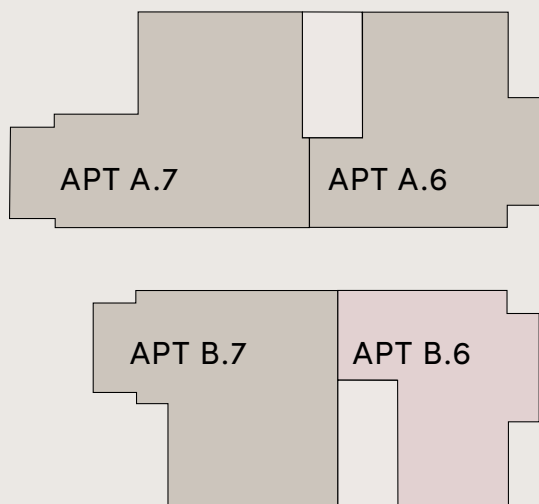

Apt no	Bedrooms	Gross Internal Area
A.6	2	647 sq ft / 60.1 sq m
A.7	2	747 sq ft / 69.4 sq m
B.6	1	529 sq ft / 49.1 sq m
B.7	2	658 sq ft / 61.1 sq m

THIRD FLOOR

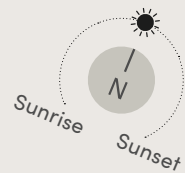
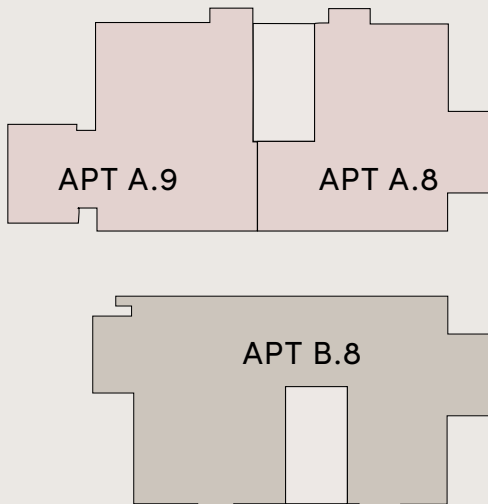

Apt no	Bedrooms	Gross Internal Area
A.8	1	507 sq ft / 47.1 sq m
A.9	1	518 sq ft / 48.1 sq m
B.8	2	917 sq ft / 85.2 sq m

BUILDING A

LOWER GROUND
GROUND FLOOR

APT No. A.1

3-BEDROOMS DUPLEX

1,258 SQ FT / 116.9 SQ M
EXCLUDING TERRACE

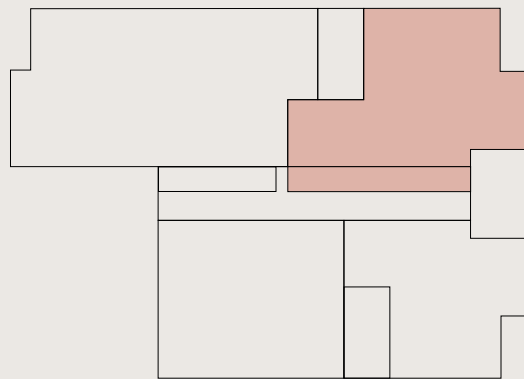
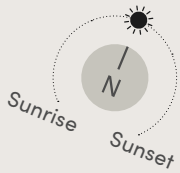

LOWER GROUND

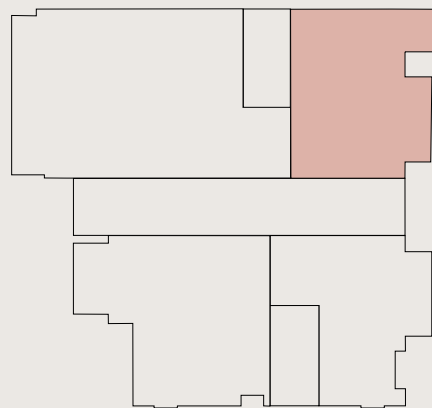

GROUND FLOOR

Disclaimer: All pictures, plans, layouts, information, data and details included in this brochure are indicative only and may change at any time up to the final 'as built' status in accordance with final designs of the project, regulatory approvals and planning permissions. All accessories and interior finishes such as wallpaper, chandeliers, furniture, electronics, white goods, curtains, hard and soft landscaping, pavements, features, gym, swimming pool(s) and other elements displayed in the brochure, or within the show apartment or between the plot boundary and the unit, are not part of the unit and are shown for illustrative purposes only.



LOWER GROUND



GROUND FLOOR

BUILDING A
LOWER GROUND

APT No. A.2
3-BEDROOMS

1,016 SQ FT / 94.4 SQ M
EXCLUDING TERRACE

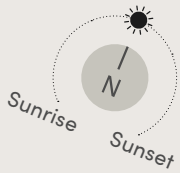
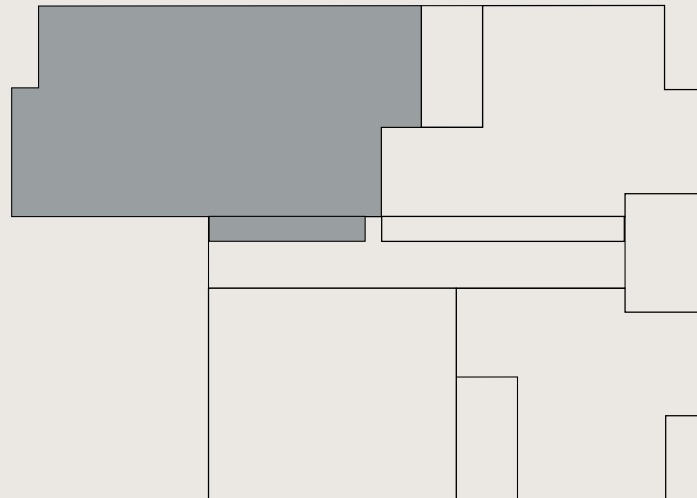

Disclaimer: All pictures, plans, layouts, information, data and details included in this brochure are indicative only and may change at any time up to the final 'as built' status in accordance with final designs of the project, regulatory approvals and planning permissions. All accessories and interior finishes such as wallpaper, chandeliers, furniture, electronics, white goods, curtains, hard and soft landscaping, pavements, features, gym, swimming pool(s) and other elements displayed in the brochure, or within the show apartment or between the plot boundary and the unit, are not part of the unit and are shown for illustrative purposes only.

BUILDING A
GROUND FLOOR

APT No. A.3
3-BEDROOMS

927 SQ FT / 86.1 SQ M
EXCLUDING TERRACE

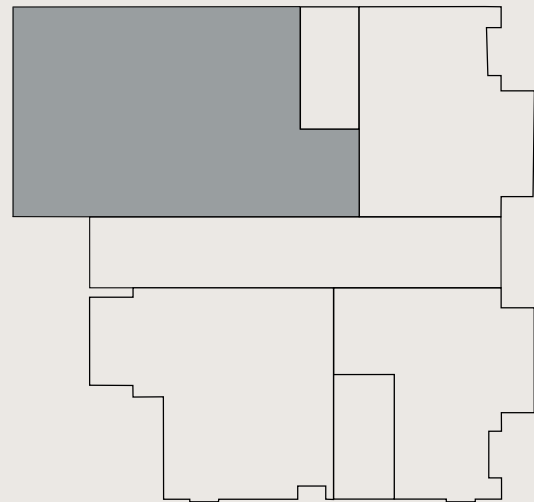
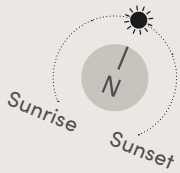

Disclaimer: All pictures, plans, layouts, information, data and details included in this brochure are indicative only and may change at any time up to the final 'as built' status in accordance with final designs of the project, regulatory approvals and planning permissions. All accessories and interior finishes such as wallpaper, chandeliers, furniture, electronics, white goods, curtains, hard and soft landscaping, pavements, features, gym, swimming pool(s) and other elements displayed in the brochure, or within the show apartment or between the plot boundary and the unit, are not part of the unit and are shown for illustrative purposes only.

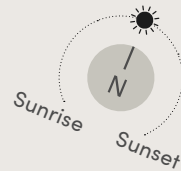

BUILDING A
FIRST FLOOR

APT No. A.4
2-BEDROOMS

647 SQ FT / 60.1 SQ M

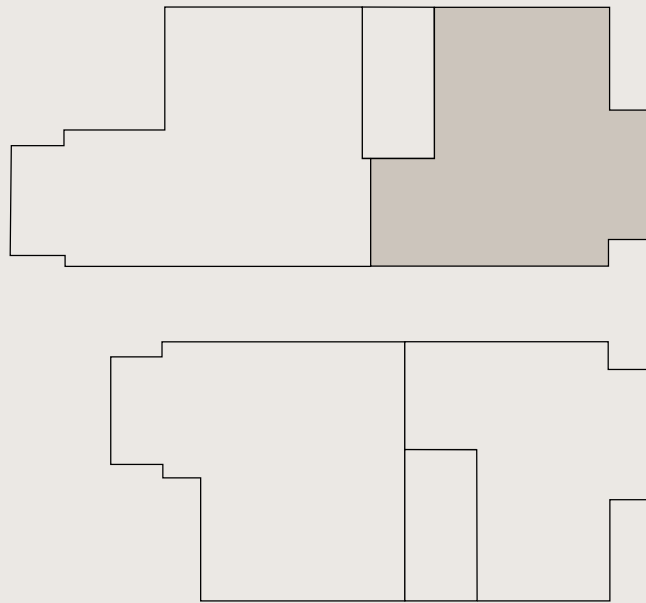

Disclaimer: All pictures, plans, layouts, information, data and details included in this brochure are indicative only and may change at any time up to the final 'as built' status in accordance with final designs of the project, regulatory approvals and planning permissions. All accessories and interior finishes such as wallpaper, chandeliers, furniture, electronics, white goods, curtains, hard and soft landscaping, pavements, features, gym, swimming pool(s) and other elements displayed in the brochure, or within the show apartment or between the plot boundary and the unit, are not part of the unit and are shown for illustrative purposes only.

BUILDING A
FIRST FLOOR

APT No. A.5
2-BEDROOMS

747 SQ FT / 69.4 SQ M
EXCLUDING BALCONY

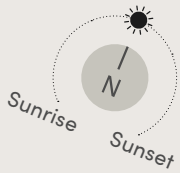
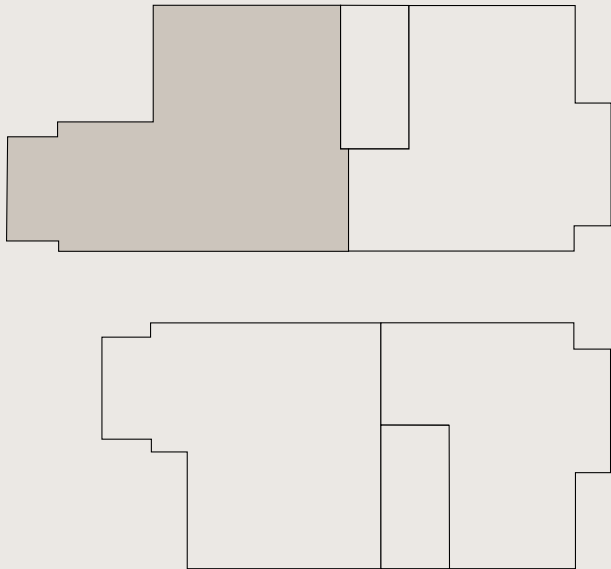

Disclaimer: All pictures, plans, layouts, information, data and details included in this brochure are indicative only and may change at any time up to the final 'as built' status in accordance with final designs of the project, regulatory approvals and planning permissions. All accessories and interior finishes such as wallpaper, chandeliers, furniture, electronics, white goods, curtains, hard and soft landscaping, pavements, features, gym, swimming pool(s) and other elements displayed in the brochure, or within the show apartment or between the plot boundary and the unit, are not part of the unit and are shown for illustrative purposes only.

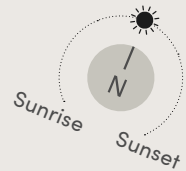

BUILDING A
SECOND FLOOR

APT No. A.6
2-BEDROOMS

647 SQ FT / 60.1 SQ M

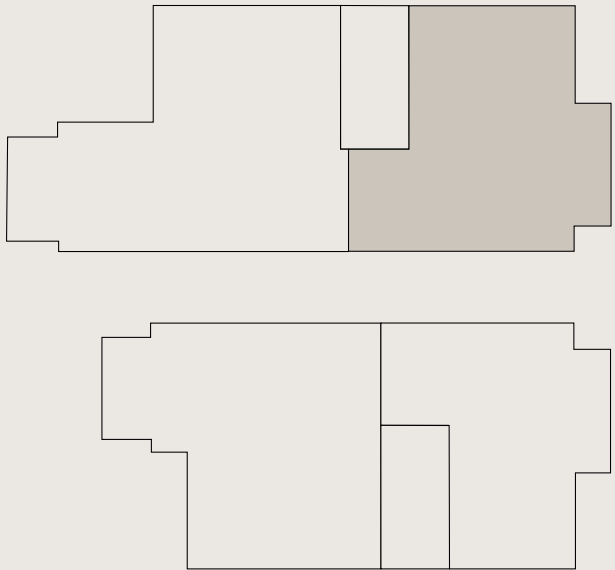

Disclaimer: All pictures, plans, layouts, information, data and details included in this brochure are indicative only and may change at any time up to the final 'as built' status in accordance with final designs of the project, regulatory approvals and planning permissions. All accessories and interior finishes such as wallpaper, chandeliers, furniture, electronics, white goods, curtains, hard and soft landscaping, pavements, features, gym, swimming pool(s) and other elements displayed in the brochure, or within the show apartment or between the plot boundary and the unit, are not part of the unit and are shown for illustrative purposes only.

BUILDING A
SECOND FLOOR

APT No. A.7
2-BEDROOMS

747 SQ FT / 69.4 SQ M
EXCLUDING BALCONY

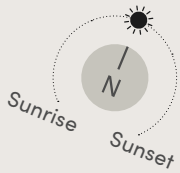
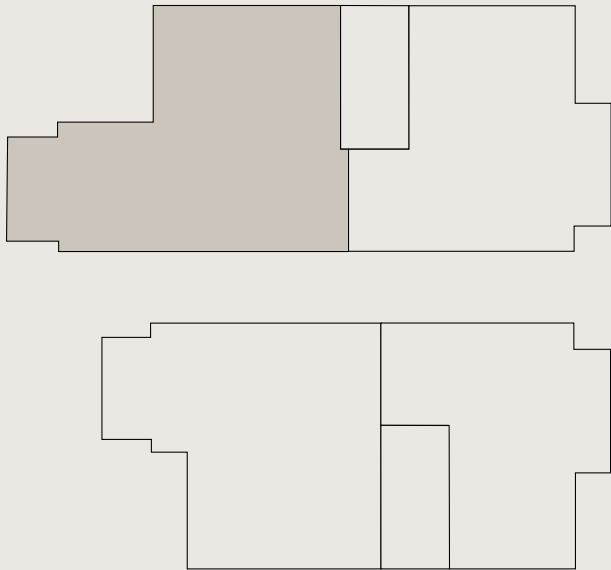

Disclaimer: All pictures, plans, layouts, information, data and details included in this brochure are indicative only and may change at any time up to the final 'as built' status in accordance with final designs of the project, regulatory approvals and planning permissions. All accessories and interior finishes such as wallpaper, chandeliers, furniture, electronics, white goods, curtains, hard and soft landscaping, pavements, features, gym, swimming pool(s) and other elements displayed in the brochure, or within the show apartment or between the plot boundary and the unit, are not part of the unit and are shown for illustrative purposes only.

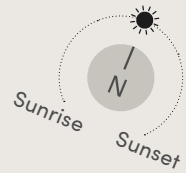

BUILDING A
THIRD FLOOR

APT No. A.8
1-BEDROOM

507 SQ FT / 47.1 SQ M

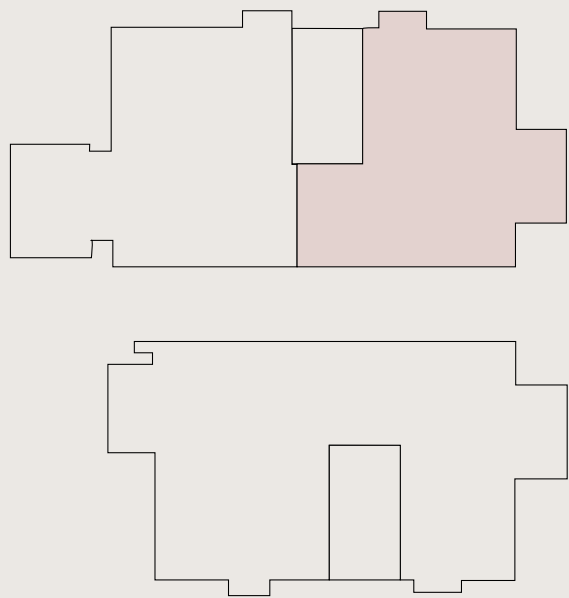

Disclaimer: All pictures, plans, layouts, information, data and details included in this brochure are indicative only and may change at any time up to the final 'as built' status in accordance with final designs of the project, regulatory approvals and planning permissions. All accessories and interior finishes such as wallpaper, chandeliers, furniture, electronics, white goods, curtains, hard and soft landscaping, pavements, features, gym, swimming pool(s) and other elements displayed in the brochure, or within the show apartment or between the plot boundary and the unit, are not part of the unit and are shown for illustrative purposes only.

BUILDING A
THIRD FLOOR

APT No. A.9
1-BEDROOM

518 SQ FT / 48.1 SQ M
EXCLUDING TERRACE

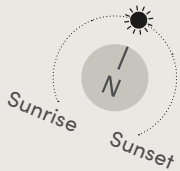
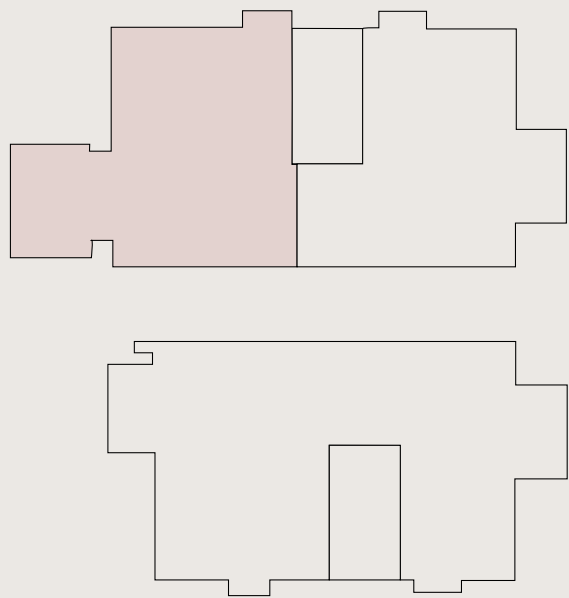

Disclaimer: All pictures, plans, layouts, information, data and details included in this brochure are indicative only and may change at any time up to the final 'as built' status in accordance with final designs of the project, regulatory approvals and planning permissions. All accessories and interior finishes such as wallpaper, chandeliers, furniture, electronics, white goods, curtains, hard and soft landscaping, pavements, features, gym, swimming pool(s) and other elements displayed in the brochure, or within the show apartment or between the plot boundary and the unit, are not part of the unit and are shown for illustrative purposes only.

BUILDING B

LOWER GROUND
GROUND FLOOR

APT No. B.1

2-BEDROOMS DUPLEX

1,031 SQ FT / 95.8 SQ M
EXCLUDING TERRACE

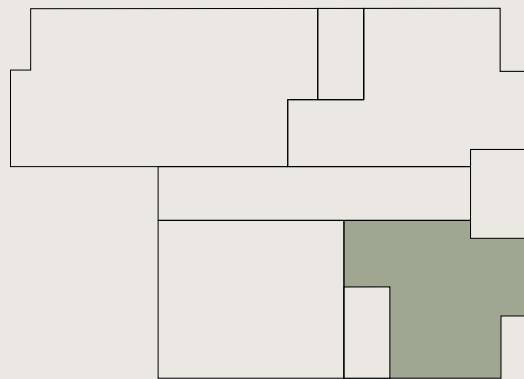
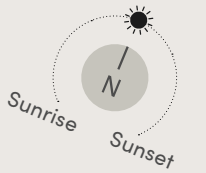

LOWER GROUND

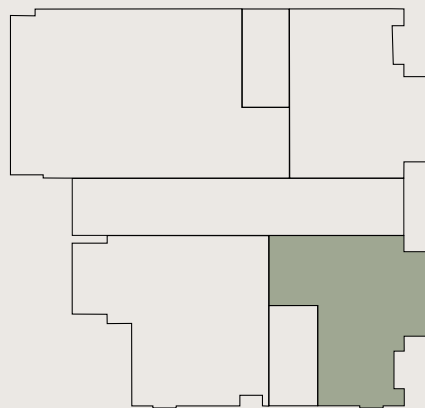

GROUND FLOOR



LOWER GROUND



GROUND FLOOR

Disclaimer: All pictures, plans, layouts, information, data and details included in this brochure are indicative only and may change at any time up to the final 'as built' status in accordance with final designs of the project, regulatory approvals and planning permissions. All accessories and interior finishes such as wallpaper, chandeliers, furniture, electronics, white goods, curtains, hard and soft landscaping, pavements, features, gym, swimming pool(s) and other elements displayed in the brochure, or within the show apartment or between the plot boundary and the unit, are not part of the unit and are shown for illustrative purposes only.

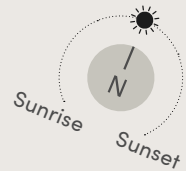

BUILDING B
LOWER GROUND

APT No. B.2
1-BEDROOM

648 SQ FT / 60.2 SQ M
EXCLUDING TERRACE

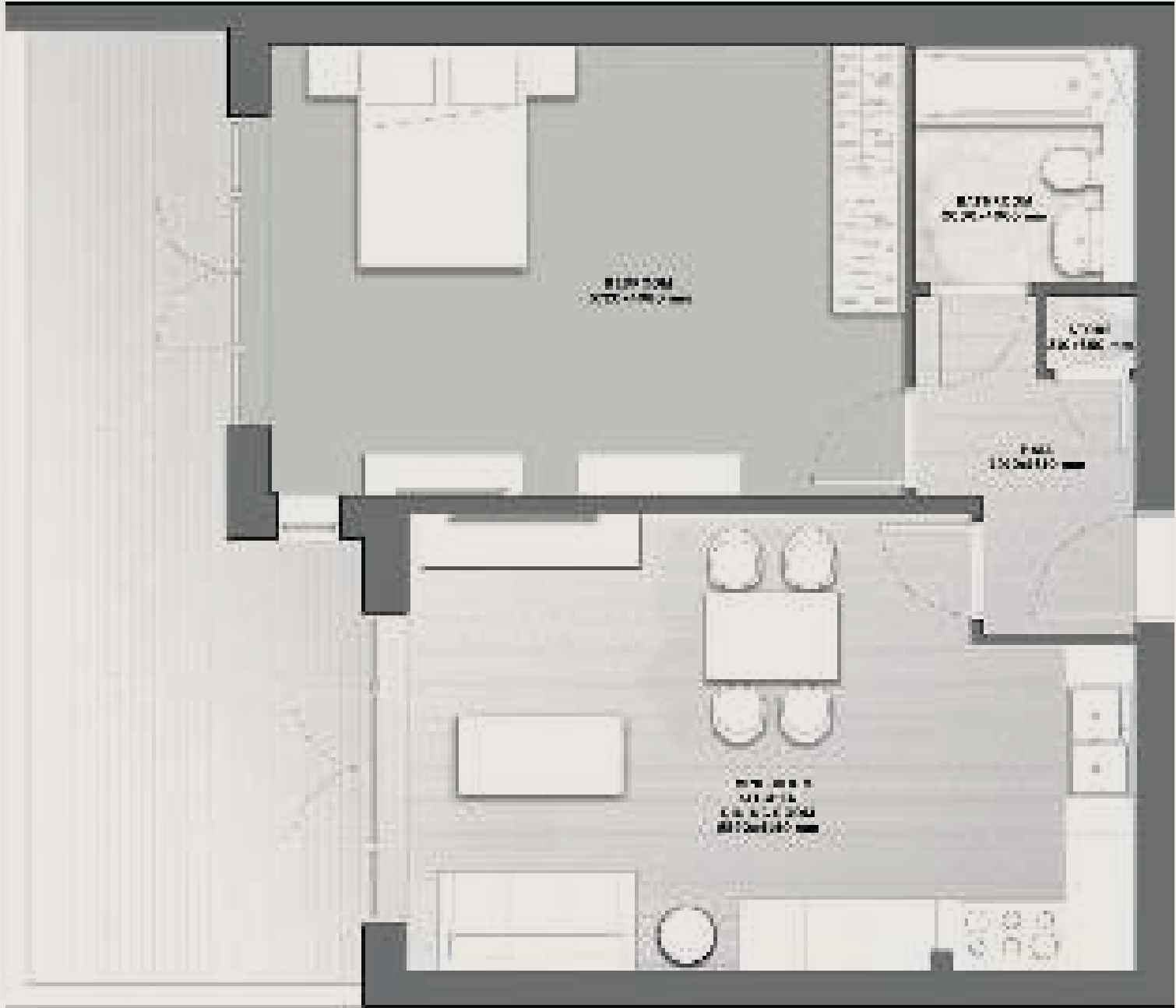
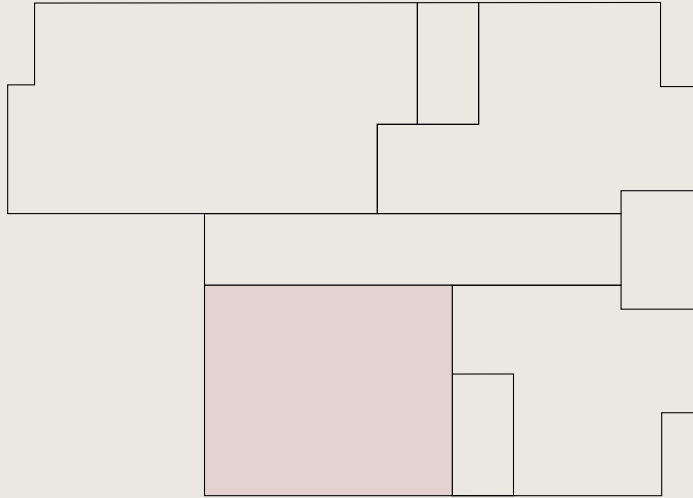

Disclaimer: All pictures, plans, layouts, information, data and details included in this brochure are indicative only and may change at any time up to the final 'as built' status in accordance with final designs of the project, regulatory approvals and planning permissions. All accessories and interior finishes such as wallpaper, chandeliers, furniture, electronics, white goods, curtains, hard and soft landscaping, pavements, features, gym, swimming pool(s) and other elements displayed in the brochure, or within the show apartment or between the plot boundary and the unit, are not part of the unit and are shown for illustrative purposes only.

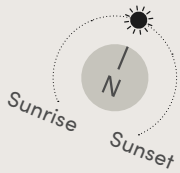

BUILDING B
GROUND FLOOR

APT No. B.3
1-BEDROOM

565 SQ FT / 52.5 SQ M
EXCLUDING BALCONY

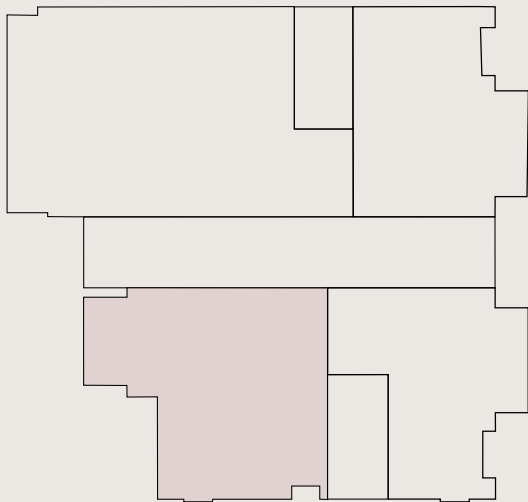

Disclaimer: All pictures, plans, layouts, information, data and details included in this brochure are indicative only and may change at any time up to the final 'as built' status in accordance with final designs of the project, regulatory approvals and planning permissions. All accessories and interior finishes such as wallpaper, chandeliers, furniture, electronics, white goods, curtains, hard and soft landscaping, pavements, features, gym, swimming pool(s) and other elements displayed in the brochure, or within the show apartment or between the plot boundary and the unit, are not part of the unit and are shown for illustrative purposes only.

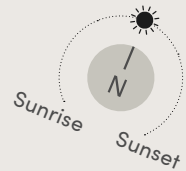

BUILDING B
FIRST FLOOR

APT No. B.4
1-BEDROOM

527 SQ FT / 49 SQ M

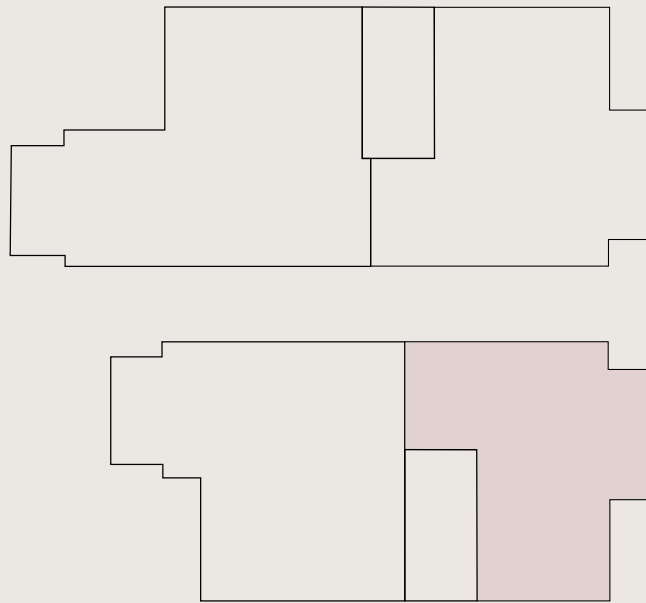

Disclaimer: All pictures, plans, layouts, information, data and details included in this brochure are indicative only and may change at any time up to the final 'as built' status in accordance with final designs of the project, regulatory approvals and planning permissions. All accessories and interior finishes such as wallpaper, chandeliers, furniture, electronics, white goods, curtains, hard and soft landscaping, pavements, features, gym, swimming pool(s) and other elements displayed in the brochure, or within the show apartment or between the plot boundary and the unit, are not part of the unit and are shown for illustrative purposes only.

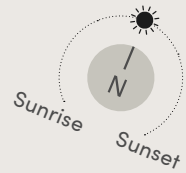

BUILDING B

FIRST FLOOR

APT No. B.5

2-BEDROOMS

654 SQ FT / 60.8 SQ M
EXCLUDING BALCONY

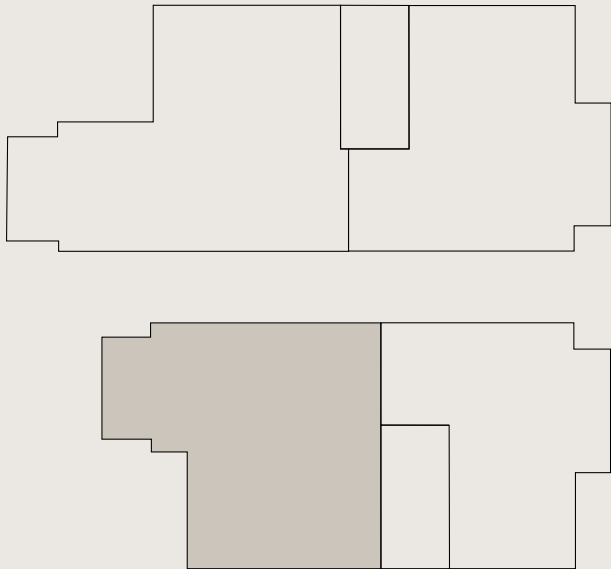

Disclaimer: All pictures, plans, layouts, information, data and details included in this brochure are indicative only and may change at any time up to the final 'as built' status in accordance with final designs of the project, regulatory approvals and planning permissions. All accessories and interior finishes such as wallpaper, chandeliers, furniture, electronics, white goods, curtains, hard and soft landscaping, pavements, features, gym, swimming pool(s) and other elements displayed in the brochure, or within the show apartment or between the plot boundary and the unit, are not part of the unit and are shown for illustrative purposes only.

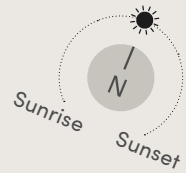

BUILDING B
SECOND FLOOR

APT No. B.6
1-BEDROOM

529 SQ FT / 49.1 SQ M

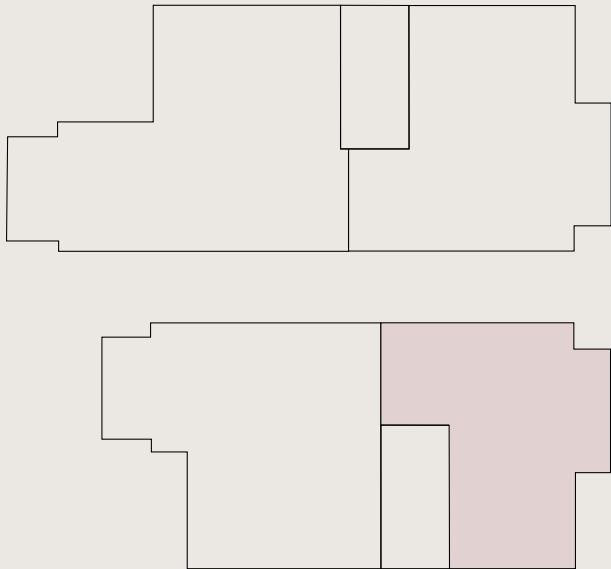

Disclaimer: All pictures, plans, layouts, information, data and details included in this brochure are indicative only and may change at any time up to the final 'as built' status in accordance with final designs of the project, regulatory approvals and planning permissions. All accessories and interior finishes such as wallpaper, chandeliers, furniture, electronics, white goods, curtains, hard and soft landscaping, pavements, features, gym, swimming pool(s) and other elements displayed in the brochure, or within the show apartment or between the plot boundary and the unit, are not part of the unit and are shown for illustrative purposes only.

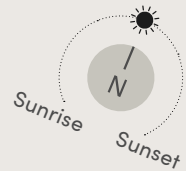

BUILDING B
SECOND FLOOR

APT No. B.7
2-BEDROOMS

658 SQ FT / 61.1 SQ M
EXCLUDING BALCONY

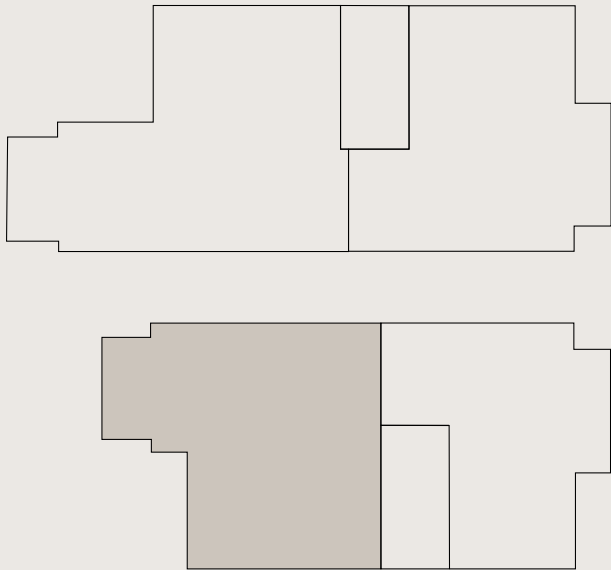

Disclaimer: All pictures, plans, layouts, information, data and details included in this brochure are indicative only and may change at any time up to the final 'as built' status in accordance with final designs of the project, regulatory approvals and planning permissions. All accessories and interior finishes such as wallpaper, chandeliers, furniture, electronics, white goods, curtains, hard and soft landscaping, pavements, features, gym, swimming pool(s) and other elements displayed in the brochure, or within the show apartment or between the plot boundary and the unit, are not part of the unit and are shown for illustrative purposes only.

BUILDING B
THIRD FLOOR

APT No. B.8
2-BEDROOMS

917 SQ FT / 85.2 SQ M
EXCLUDING TERRACE

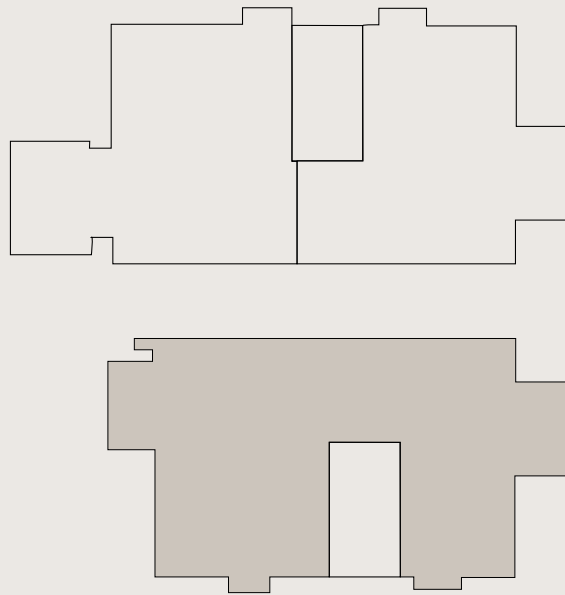
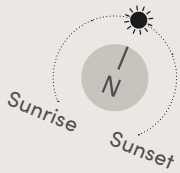

Disclaimer: All pictures, plans, layouts, information, data and details included in this brochure are indicative only and may change at any time up to the final 'as built' status in accordance with final designs of the project, regulatory approvals and planning permissions. All accessories and interior finishes such as wallpaper, chandeliers, furniture, electronics, white goods, curtains, hard and soft landscaping, pavements, features, gym, swimming pool(s) and other elements displayed in the brochure, or within the show apartment or between the plot boundary and the unit, are not part of the unit and are shown for illustrative purposes only.

A DEVELOPMENT BY



MOUNTBATTEN
HOMES



DarGlobal PLC is an international real estate developer specializing in exclusive luxury developments across the world's most coveted cosmopolitan cities .

Catering to global citizens seeking prime investments, second homes, and luxury living, DarGlobal transforms real estate into economic catalysts, unlocking opportunities for both investors and the countries it enters.

DarGlobal has partnered with over 10 world-renowned luxury brands, including Trump Organization, Aston Martin, Automobili Lamborghini, ELIE SAAB, Marriott Residences, Missoni, Mouawad, Pagani Automobili, W Hotels, and Versace. These collaborations offer unique investment opportunities in global cities, providing both wealth growth and protection.

Listed on the London Stock Exchange, DarGlobal goes beyond property development, it drives economic transformation by attracting international clients and Foreign Direct Investment (FDI). By injecting capital, confidence, and industry expertise, DarGlobal enhances local infrastructure while elevating the global appeal of each destination.

With a presence in 14 international cities across 9 countries, DarGlobal's portfolio spans the United Kingdom, Spain, Greece, Saudi Arabia, the UAE, Oman, and Qatar. The company is also expanding into world-class hospitality, developing luxury hotels in Dubai, the Maldives, and Oman.

To support its international clientele, DarGlobal has sales and customer service offices in New York, London, Marbella, Athens, Dubai, Jeddah, Riyadh, Muscat, and Doha.



OUR OFFICES



LONDON, UK

50 Hans Crescent,
Knightsbridge, London,
SW1X 0NA, UK
+44 20 8135 4699

MUSCAT, OMAN

Royal Opera House Muscat
Shatti Al Qurum,
Muscat, Oman
+968 2270 2771

DOHA, QATAR

Malibu Building,
Lusail Entertainment City,
Doha, Qatar
+974 4410 8282

DUBAI, UAE

Jumeirah Emirates Towers
30th Floor, Sheikh Zayed Road,
PO Box 2523, Dubai, UAE
+971 4 562 9616

MARBELLA, SPAIN

Marbella Club Golden Mile,
Av. Bulevar Principe Alfonso de
Hohenlohe, Marbella 29602
Málaga, Spain
+34 951 121 221

RIYADH, KSA

2135 Tahlia St.,
Al Olaya, 12222
Riyadh, KSA
+966 800 118 8081

JEDDAH, KSA

Ash Shati, 23613,
King Abdulaziz Road,
Jeddah, KSA
+966 800 118 8081

NEW YORK CITY, USA

19th floor – Trump Tower
New York, 725 5th Ave,
NY 10022, USA
+1 212 715 1067

For more information on
Oh So Close, please call
+44 20 8135 4699 (UK)

You can also check our website
darglobal.co.uk/oh-so-close/
or our social media platforms





DARGLOBAL.CO.UK

The information in this document is indicative and is intended to act as a guide only as to the finished product. Accordingly, the finished product may vary from the information provided. These particulars should not be relied upon as statements of fact or representations and applicants must satisfy themselves by inspection or otherwise as to their correctness. This information does not constitute a contract or warranty. All computer generated images and lifestyle photography are indicative only.