

What's included

Camera



Wrench



Hardwire cable



OBD cable



Mounting base



NOTE: You will receive the hardwire cable OR the OBD cable.

Step 1

Prepare mounting location

A. Slightly loosen the locking screws to the cameras using the included wrench to allow the rotation of both cameras.

NOTE: The locking screws will need to be re-tightened when Step 4 is complete.

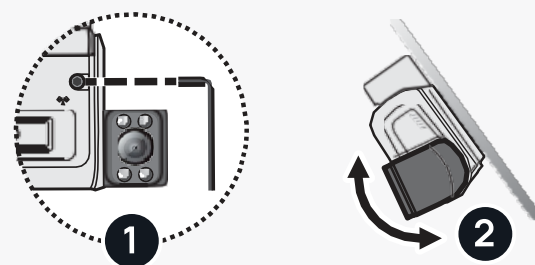

B. Without removing the film from the adhesive mounting plate, attach the mounting base to the back side of the camera.

C. Clean the area of the windshield that is behind the **driver's side** of the rear-view mirror.

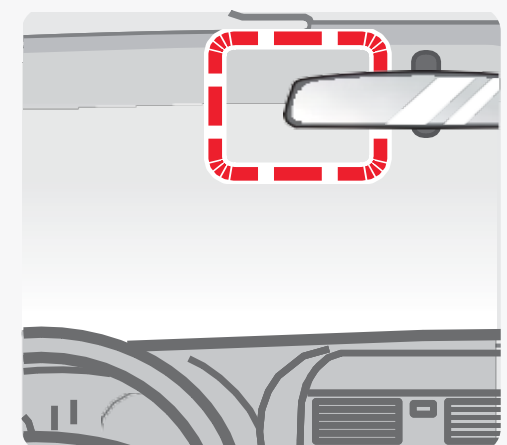

Step 2a

Power harness

A. Determine whether you have the OBD harness or the hardwire harness.

B. For the hardwire harness

- Find a constant power source, ignition power source and ground (fuse taps are recommended).
- Wire the **red wire** (labeled ACC) to an ignition switched power source.
- Wire the **yellow wire** (labeled B+) to a constant power source that supplies power even when the vehicle is turned off.
- Connect the **black wire** to a ground location.
- Run the power cable up to the camera.

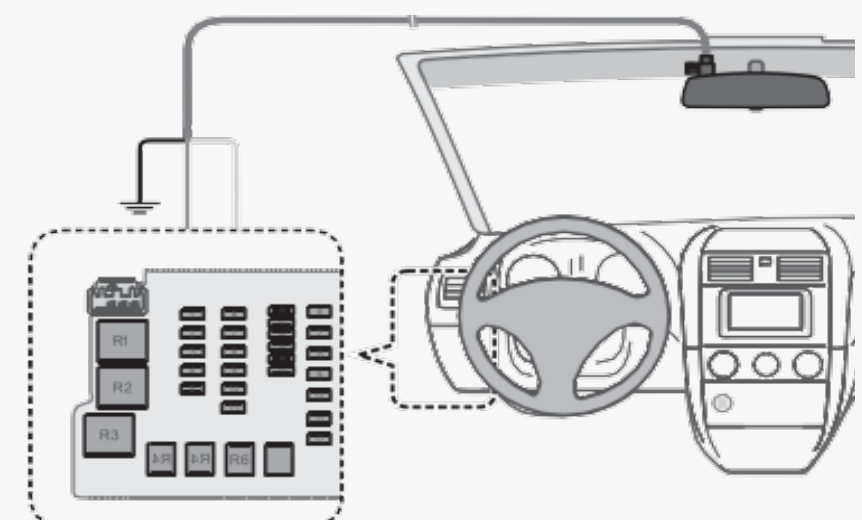

Step 2b

C. For the OBD harness, plug the harness to the OBD port and run the power cable up to the camera.

NOTE: For both installation methods, please route the cabling outside of the driver's view.

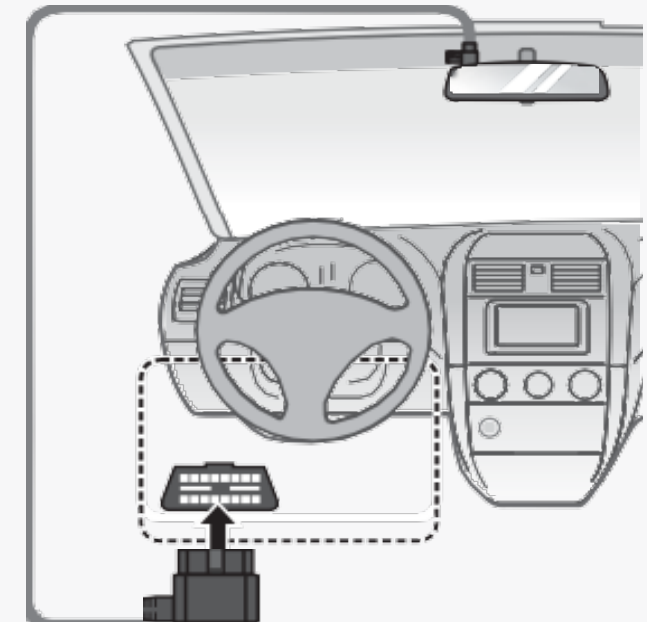

Step 3

Mount camera

A. Attach the included power cable cover where the main connector is attached to the camera and tighten the screw with the included wrench.

B. Remove the protective film from each camera lens.

C. Peel the film from the back of the adhesive mounting plate and affix the camera securely to the windshield. Press on the camera firmly for approximately 30 seconds to ensure it is mounted securely.

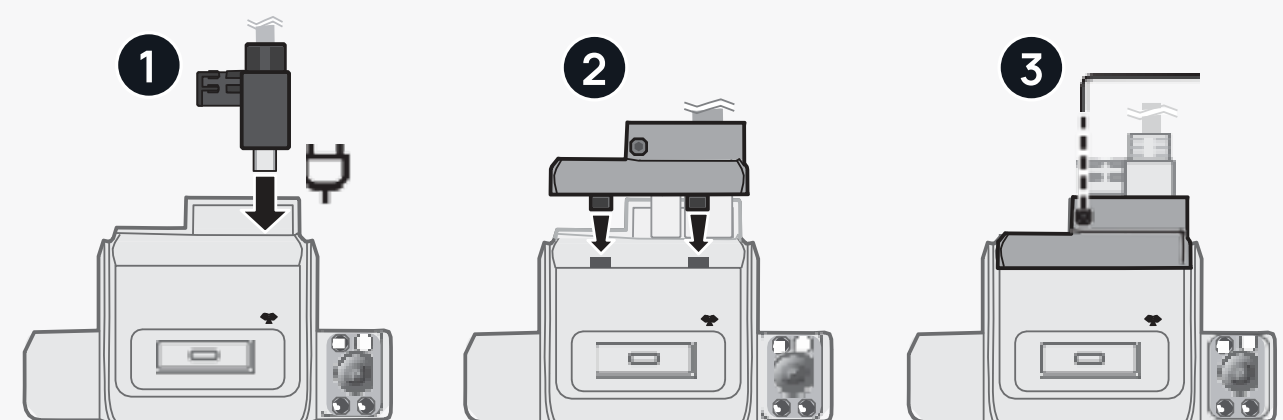

Step 4

Complete installation

A. Power on the camera by starting the vehicle, then download and install the Kinesis Vision app.

- Apple:** <https://apps.apple.com/us/app/kinesis-vision/id6743717089>
- Android:** https://play.google.com/store/apps/details?id=com.radius.kinesisvision&hl=en_SG

B. Launch the mobile app and log in with the account credentials provided by your sales agent.

C. Tap the Installation icon located on the Home page to begin final installation steps.

REMINDER: When all installation steps are complete, tighten the locking screws on the camera mount.

