

Alarm/Release Terminal Type Microswitch



P/N: 87-120047-001

FEATURES

- **For Use In:**
 - WHDR™ Commercial Cooking Fire Suppression Systems
 - IND™ Industrial Fire Suppression Systems
- **Used for Alarm Circuit and Release Circuit**
- **Screw-type Terminals for Secure Wire Mounting**
- **For Use with XV Control System**
- **Stackable with Quick Connect XV™ Control System Microswitch**
- **Ships with Non-Conductive Barrier**

DESCRIPTION

The Alarm/Release Terminal Type Microswitch is a single pole, double-throw switch used for supervision of the XV Control System for alarm activation and release actuation (Figure 1, Table 1). The microswitch kit (P/N 87-120047-001) includes the switch, non-conductive shield and mounting hardware

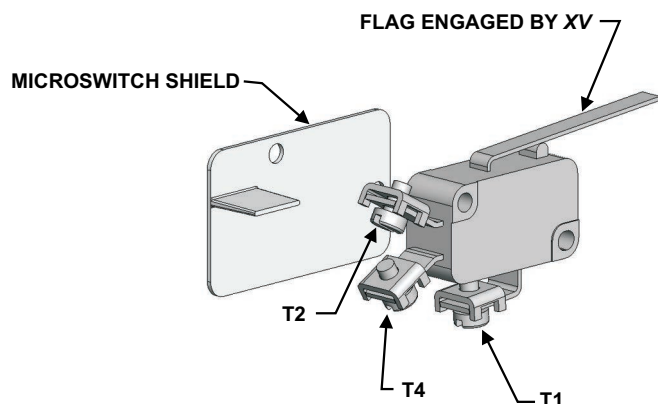

Figure 1. Alarm/Release Terminal Type Microswitch

Table 1: Electrical Rating

250 Vac	15 Amps
250 Vac	1/2 HP
125 Vac	1/2 HP

The Alarm/Release microswitch provides approved supervision for the alarm zone circuit of the Kidde Fire Systems AEGIS™ and ARIES™ panels, and for other UL Listed control panels (Figure 2). The switch can also be wired in series with the XV Control System Solenoid Electric Actuator (P/N 83-100034-001) to open the releasing loop upon system actuation (Figure 3).

Alarm/Release Terminal Type Microswitches are not used for electrical shutdown (i.e., appliance, gas, make-up air). Quick Connect Microswitch Kits (P/Ns 87-120039-001 and 87-120039-501) are available for shutdowns.

The XV Control System has two separate microswitch mounting locations to support up to four (4) microswitches (any combination of Quick Connect and/or Alarm/Release type). Each of the two mounting locations has a corresponding EMT port for wire leads, allowing the use of two electrical junction boxes for separation of signal lines and AC lines.

ORDERING INFORMATION

Description	Part Number
Alarm/Release Terminal Type Microswitch	87-120047-001
XV Control System	87-120099-002
XV Solenoid Electric Actuator Kit	83-100034-001
EMT Connector Kit (set of 3)	87-120058-001
Quick Connect Microswitch Kit, Solid Leads	87-120039-001
Quick Connect Microswitch Kit, Striped Leads	87-120039-501

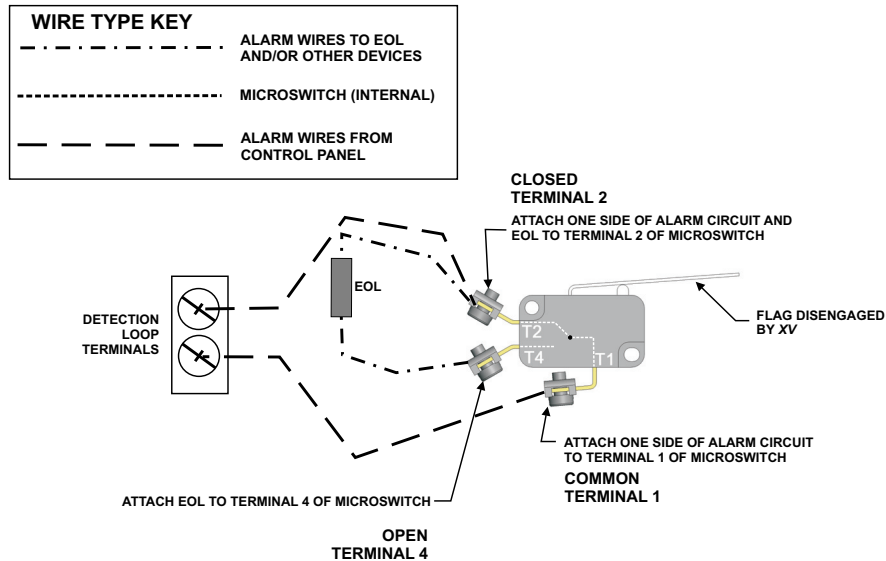

SWITCH POSITION WHEN XV FLAG/CAM IS IN RELEASED POSITION

Figure 2. Alarm Wiring with Terminal Type Microswitch

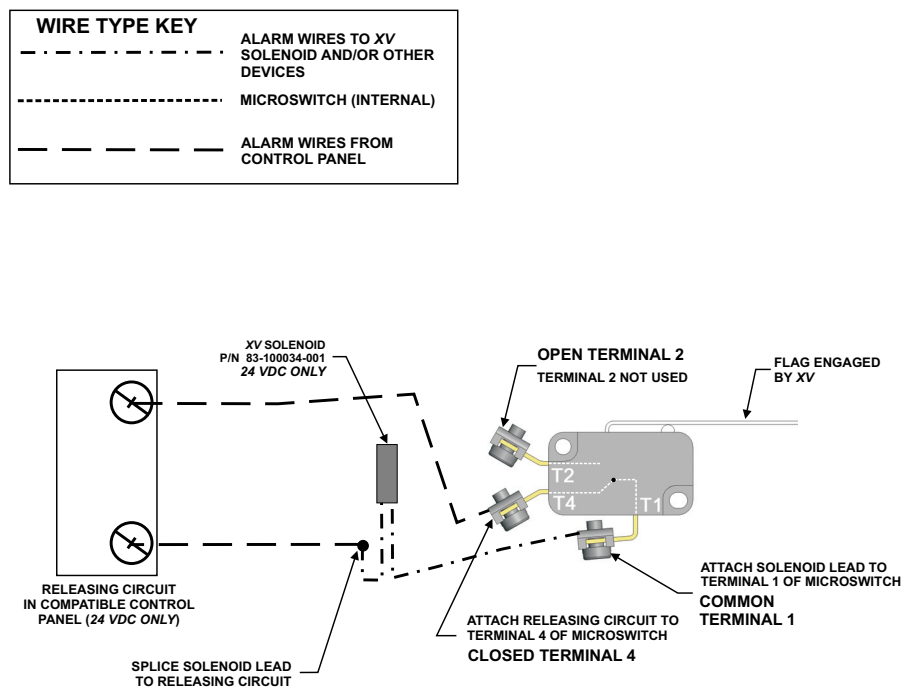

SWITCH POSITION WHEN XV FLAG/CAM IS IN SET POSITION

Figure 3. Release Wiring with Terminal Type Microswitch

Kidde Fire Systems, Kidde Fire Protection and Fenwal Controls branded products are created exclusively by Kidde-Fenwal, LLC, 400 Main St, Ashland, MA 01721, USA. All other trademarks are the property of their respective owners.

This literature is provided for informational purposes only. Kidde-Fenwal, LLC believes this data to be accurate, but it is published and presented without any guarantee or warranty whatsoever. Kidde-Fenwal, LLC assumes no responsibility for the product's suitability for a particular application. The fire suppression system design, installation, maintenance, service and troubleshooting must be performed by trained, authorized Kidde Fire Systems distributors for the product to work correctly. If you need more information on this product, or if you have a particular problem or question, contact: Kidde-Fenwal, LLC, Ashland, MA 01721 USA, Tel: +1 (508) 881-2000.