

Automatic Connector 40

Part No	Description	Weight
SV1700V	Automatic fastening set 40	
SV1705V	Automatic fastening set 40 VA	

Application: No machining of either profile is required when using this fastener. If possible use in pairs.

Material: steel, zinc-plated or stainless-steel

Assembly: The fastener is screwed into a profile groove in the end face. It was recommended to use a lubricant.

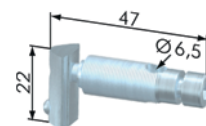
40

SV1610V
Central Fastener 30 S / SV

Part No	Description	Weight
SV1610V	Central Fastener 30 S	17.3 g
SV1620V	Central Fastener 30 SV	17.4 g
SB1332	Machining Central Fastener	

Application: All-purpose universal fastener. The slide-in anchor is held in position in the profile t-slot by a spring-loaded ball in the opposing profile groove. The Central Fastener 30 SV has an anti-twist feature.

Material: steel, zinc-plated

Assembly:

- Bore hole for the barrel housing: Ø 8.5 mm, 15 mm from profile end, 25 mm deep
- bore for center hole – not required

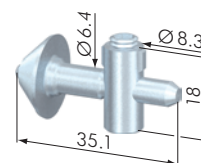
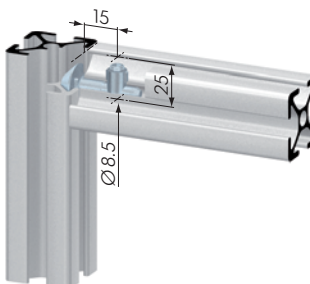
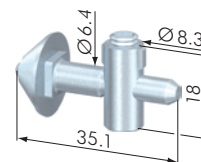
30

SV1610V

SV1620V
Central Fastener 30 EL / EQ

Part No	Description	Weight
SV1601V	Central Fastener 30 EL	16 g
SV1600V	Central Fastener 30 EQ	16 g
SB1332	Machining Central Fastener	

Application: All-purpose universal fastener. The twist-in anchor, with an anti-twist feature, can be fixed in the profile t-slot at any point. The anchor is held in position by a spring-loaded ball in the opposing profile t-slot.

Material: steel, zinc-plated

Assembly:

- Bore hole for the barrel housing: Ø 8.5 mm, 15 mm from profile end, 25 mm deep
- bore for center hole – not required

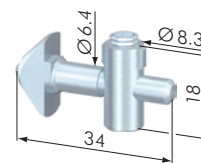
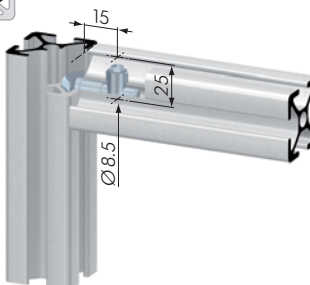
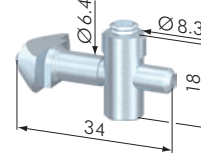
30

SV1601V

SV1600V
Central Fastener 30 G

Part No	Description	Weight
SV1072V	Central Fastener 30 G	8 g
SB1332	Machining Central Fastener	

Application: Butt fastener. Used for joining two profiles end to end. The anchor is screwed into the opposing profile or plate.

Material: steel, zinc-plated

Assembly:

- Tap center hole of mating profile with an M8 thread to orient »diveted« portion of fastener so that it is facing the direction as the barrel housing.

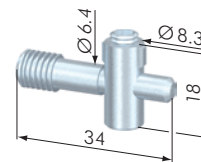
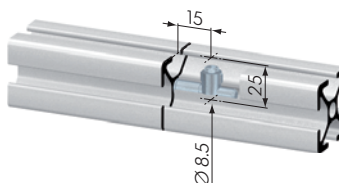
30

SV1072V