

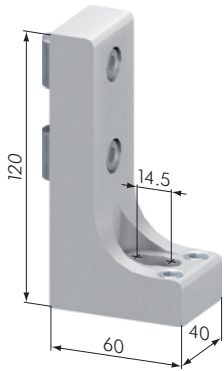

Angle Feet AI		
Part No	Description	Weight
SF1201N	Angle Foot AN	394 g
SF1201S	Angle Foot AS	394 g
SZ1710V	Fixing Set For Angle Feet	3 g

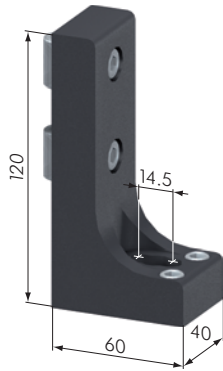

SF1201N



SF1201S



SZ1710V

Application: For adjusting and fixing machine frames and protection panel support legs to the floor.

Material: aluminum, natural or black anodized

Supply:
 1x angle foot
 2x t-nut M 8 / ball-type, slide-in
 2x cap head screw M 8 x 25, DIN 6912
 2x grub screw M 12 x 20

Acc.: SZ1710V floor anchor M 8



Angle Feet AI, adjustable		
Part No	Description	Weight
SF1200N	Angle Foot AN, adjustable	612 g
SF1200S	Angle Foot AS, adjustable	612 g
SZ1710V	Fixing Set For Angle Feet	3 g

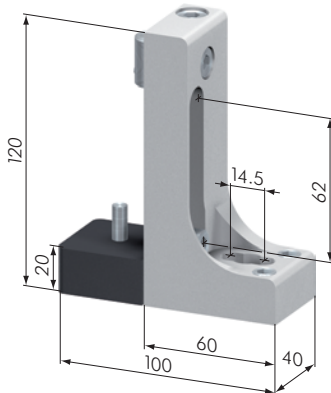

SF1200N

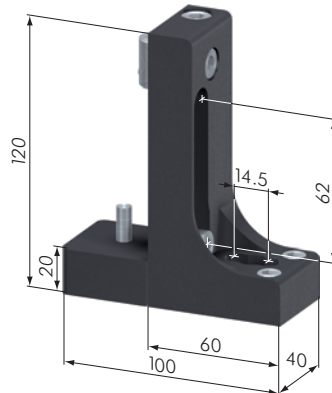

SF1200S

Application: For adjusting and fixing machine frames and protection panel support legs to the floor. Vertical adjustment: 62 mm

Material: aluminum, natural or black anodized

Supply:
 1x angle foot
 2x t-nut M 8 / ball-type, slide-in
 2x cap head screw M 8 x 25, DIN 6912
 2x grub screw M 12 x 20

Acc.: SZ1710V floor anchor M 8



Metal Foot		
Part No	Description	Weight
SZ8040N	Metal Foot	566 g

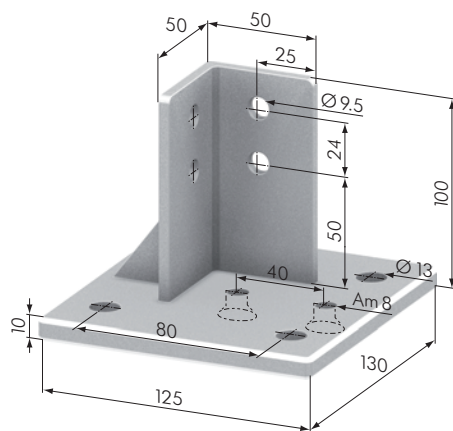

SZ8040N

Application: For fixing protection panel support legs to the floor.

Material: GDZN, natural

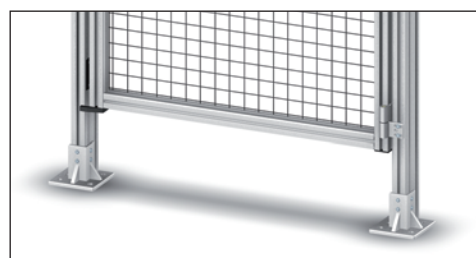

Clamping Feet

Part No	Description	Weight
SZ8080N	Clamping Foot 40 x 40	0,874 kg
SZ8081N	Clamping Foot 60 x 80	1,556 kg
SZ8082N	Clamping Foot 80 x 80	1,784 kg
SZ1735V	Fixing Set Clamping Foot	0,292 kg

40

Application: For adjusting and fixing protection panel support legs to the floor. One fixing set is required per clamping foot.

Material: GDZN, natural

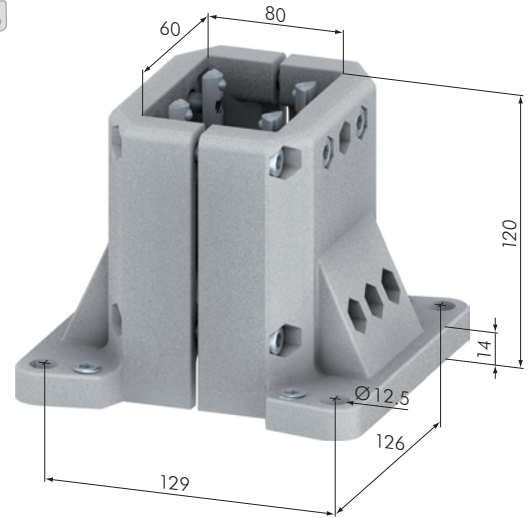

SZ8081N

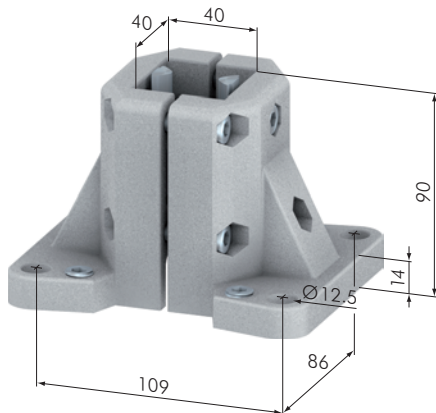

SZ8080N

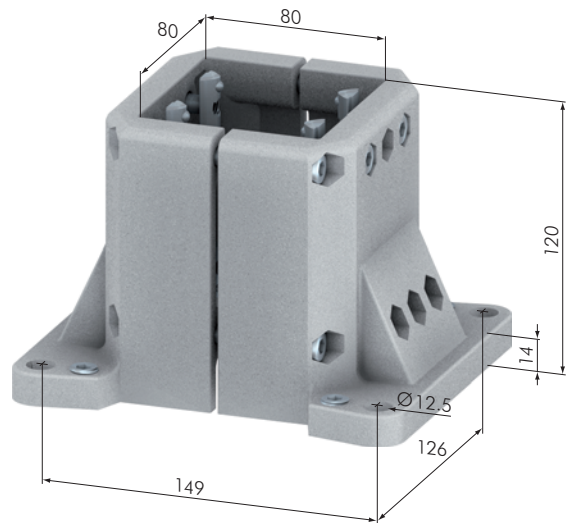

SZ8082N

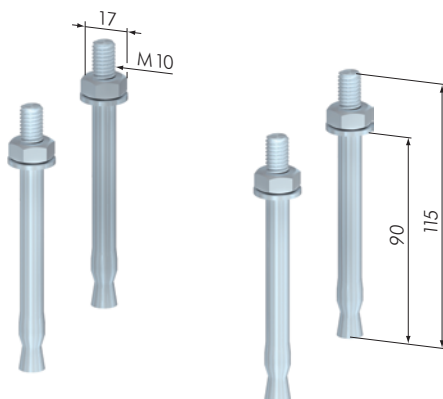

SZ1735V

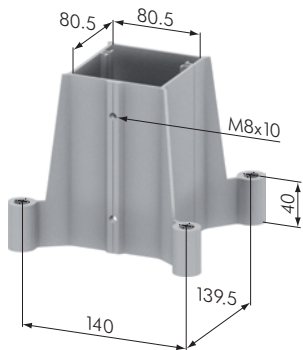

SZ8050N

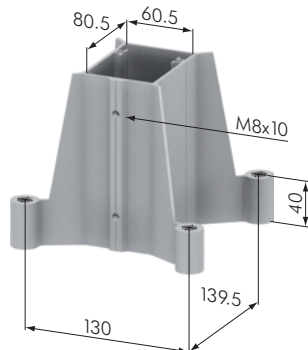

SZ8055N

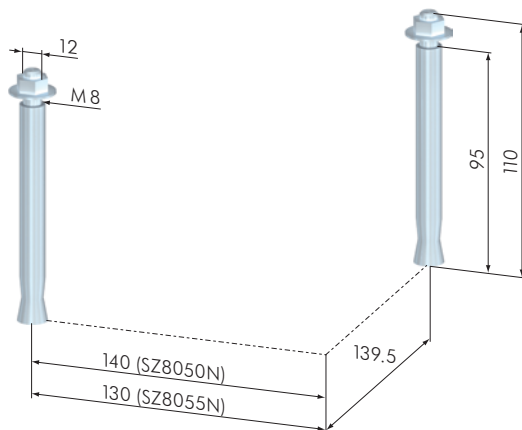

SZ1750V

Mounting Feet		
Part N°	Description	Weight
SZ8050N	Mounting Foot 80 x 80	0,896 kg
SZ8055N	Mounting Foot 60 x 80	0,632 kg
SZ1750V	Fixing Set Mounting Feet 60 x 80 and 80 x 80	0,292 kg

Application: For fixing protection panel support legs to the floor. One fixing set is required per clamping foot.

Material: aluminum, natural anodized

Supply: 2x grub screw M 8 x 10

