

DATA SHEET

Zanoli Synthesis 08/50E-1

20 Inch Electric Impingement Conveyor Oven

2SV4404C-1



Build

- Built entirely in stainless steel
- Double glazed full width inspection door.
- In built cooling system for all external parts ensures oven is cool to touch and work with.
- Heavy duty construction with reliable and durable components.
- Stackable up to 3 units.
- Optional Heavy duty stand with omnidirectional wheels and brakes

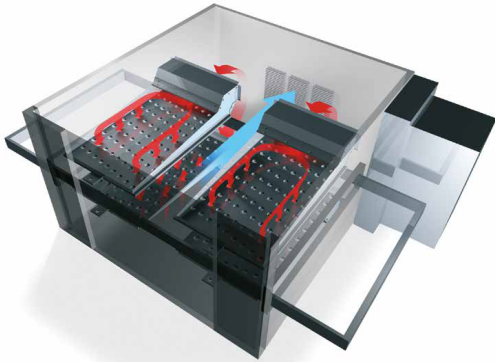

Impingement technology

- Maximum silence of the mesh conveyor system and ventilation motors.
- Latest advancements in air impingement technology allow for rapid heating & cooking of all foods consistently at all times.
- The piercing jets of hot turbulent air encompass every part of the oven delivering exceptional results every time.

Controls

Temperature:

- BRP (power regulation) system reaches working temperature in 20 minutes
- Balanced temperature detection system managed via dual oven probes..
- Maximum cooking temperature up to 320 °C
- Independent adjustment of the top and bottom power from from 50% to 100%.

Advanced control board automatically manages:

- Temperature and power consumption in peak and off peak times contributing to significant savings.
- The cooking intensity ensuring highest performance at the lowest temperatures

Customizable and Programmable up to:

- 10 Programmes with unique control over the below paramters:

- A = setting temperature
- B = top power (%)
- C = cooking timer
- D = bottom power (%)
- E = program name and n°

- 2 auto start ups per day with your selected program

Conveyor:

- Adjustable speed conveyor belt all the way to a complete halt. The dashes on the display move top to bottom simulating its movement

Economy function allows:

- The Economy function enables the oven to maintain a lower temperature when not in active use compared to when it's in operation. This feature conserves energy, leading to cost savings. Additionally, it controls the movement of the wire mesh conveyor, serving a dual purpose beyond just temperature management.

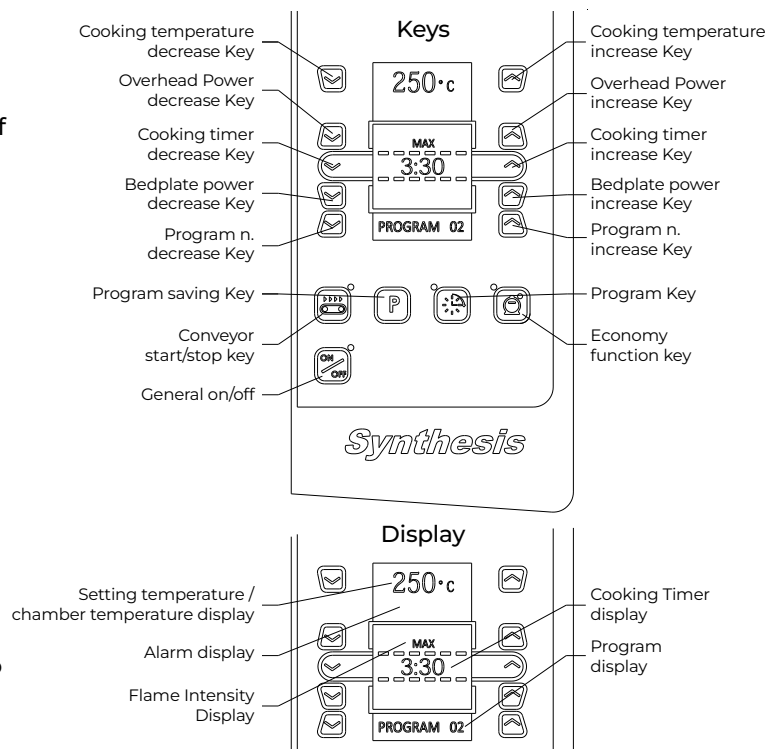

DATA SHEET

Zanoli Synthesis 08/50E-1

20 Inch Electric Impingement Conveyor Oven

2SV4404C-1



Technical specifications

External Size

External Width	1745mm
External Depth	1240mm
External Height	490mm

Cooking Chamber size

Internal Width	850mm
Internal Depth	500mm
Internal Height	100mm

Conveyor Belt Size

Conveyor Width	1670mm
Conveyor Depth	500mm

Weight

Net weight	180 kg
package weight	*

Connection requirements electric

Total electrical power	14.2kW
------------------------	--------

Electrical supply current (per oven)

Voltage	415V
Current at 380-415 V 3N~	24,4A

Cable and Lead

Plug Supplied	No
Cable Length	2m
Wire section	4/10 mm ²
Electrical connection	Plugless 5 lead cable

Recommended Clearances

Minimum clearance	Left	Rear	Right
Standard	200mm	200mm	200mm

Operating Environment

Temperature	0 - 40 °c
Maximum humidity	95% without condensation
Noise	< 70 decibels

Operation

Conveyor Belt speed	1:45 - 30 min / Halt
Maximum Temperature	320°c

Warranty

2 Year Warranty	2 years parts and labour
-----------------	--------------------------

**Subject to a preventative maintenance plan*

We reserve the right to alter specifications without notice.



1800 183 818

support@thegoodlady.com.au

www.thegoodlady.com.au

DATA SHEET

Zanoli Synthesis 08/50E-1

20 Inch Electric Impingment Conveyor Oven

2SV4404C-1



Options

<input type="checkbox"/>	Micromesh belt - 6mm
SKU	--

<input type="checkbox"/>	Right to left Belt configuration
SKU	--

<input type="checkbox"/>	High speed conveyor belt gearbox
SKU	--

<input type="checkbox"/>	Stand suited for Single/Double deck configuration
SKU	OSV2A05
Size	1040 x 850 x 590
Weight	34.5kg

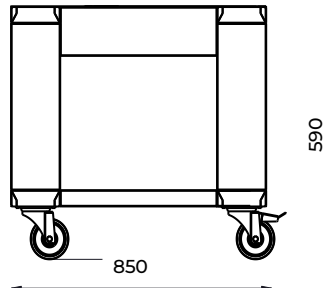
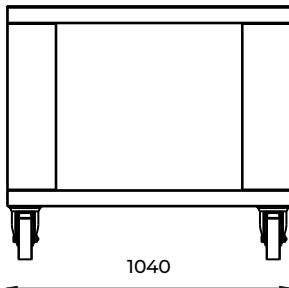

We reserve the right to alter specifications without notice.

DATA SHEET

Zanoli Synthesis 08/50E-1

20 Inch Electric Impingement Conveyor Oven

2SV4404C-1

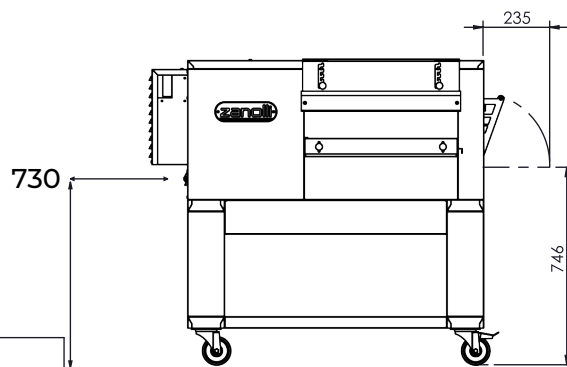
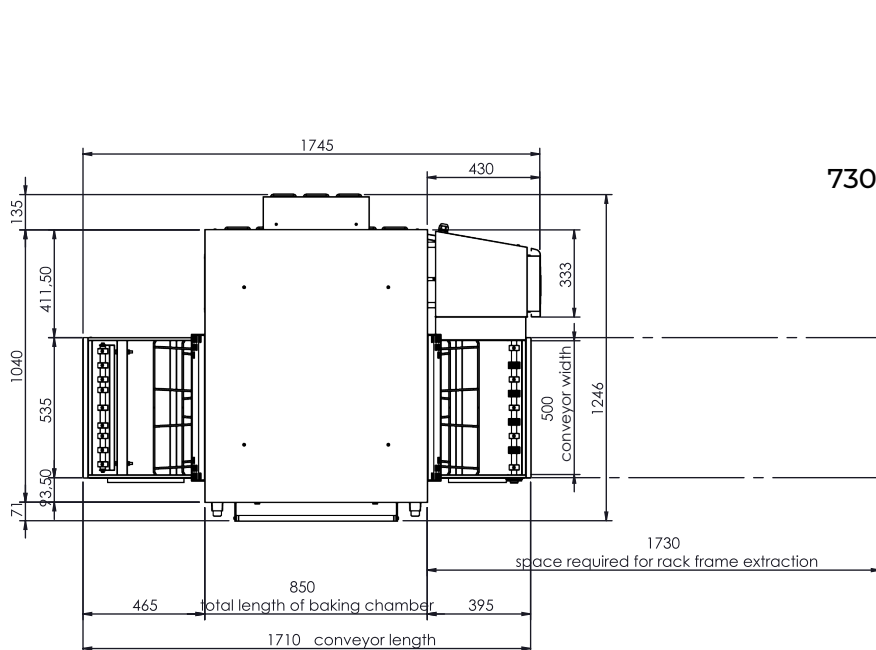
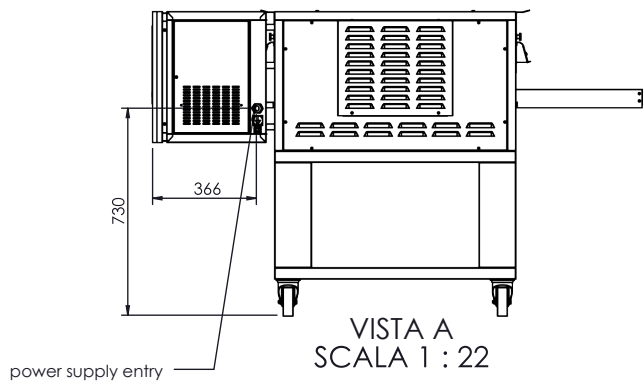
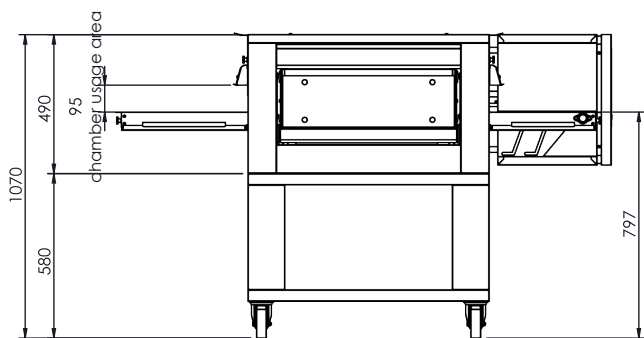
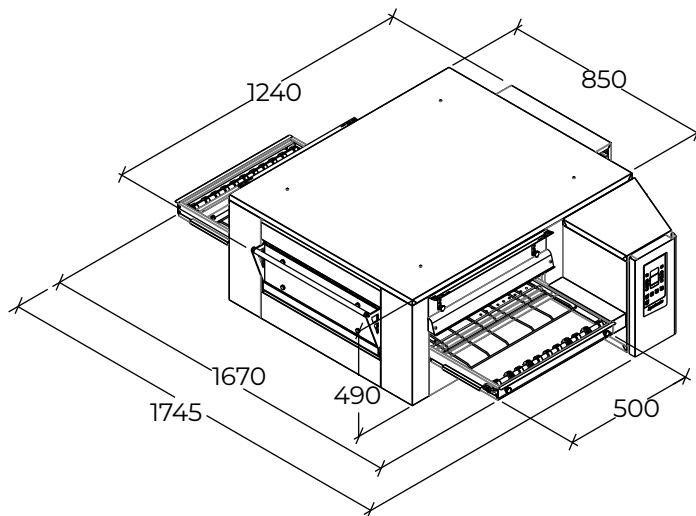
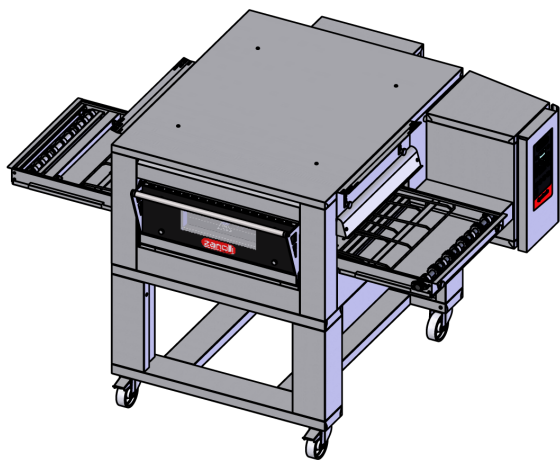

We reserve the right to alter specifications without notice.



1800 183 818

support@thegoodlady.com.au

www.thegoodlady.com.au