

## For Residential and Commercial Applications

Job Name		Engineer / Architect	
Job Location		Wholesaler	
Submittal Date		Contractor	

### DRS84 Integral Shut-Off Straight Stop w/ Screwdriver Slot – Female Sweat x Male Iron Pipe

**Use:** For use in potable water distribution systems. Not intended for recirculating water systems that produce continuous use temperatures above 115° F. For those applications, use BrassCraft KT series ball stops

**Design Features:**

- **Machined one-piece brass body** provides strength, durability and long-lasting performance
- **Screwdriver slot handle** helps protect against accidental stop operation during rough-ins and in general use

**Operating Specifications:**

**Temperature:** 40° - 140° F

**Pressure:** 125 psi maximum

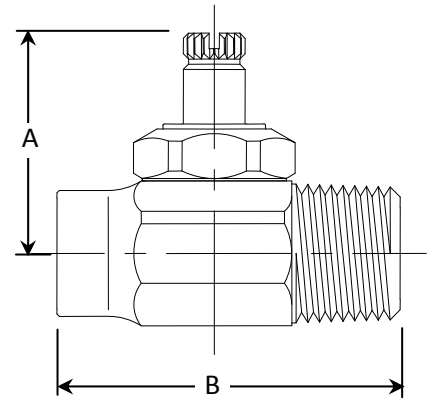

#### MATERIAL SPECIFICATIONS

<b>Valve Body</b>	C36000 brass
<b>Screwdriver Slot Stem</b>	C36000 brass
<b>Bib &amp; Packing Washers</b>	Nitrile or EPDM rubber
<b>Packing Nut</b>	C36000 brass

#### PART DIMENSIONS (Inches)

Model	DIM. A	DIM. B
DRS84	1.33	2.07

**Part Listing:**

- ☐ DRS84 C 1/2" Nom. Female Sweat x 1/2" M.I.P. with screwdriver slot, chrome plated
- ☐ DRS84 R 1/2" Nom. Female Sweat x 1/2" M.I.P. with screwdriver slot, rough brass
- ☐ DRS84 R1 1/2" Nom. Female Sweat x 1/2" M.I.P. with screwdriver slot, rough brass, window tray

**Listings & Certifications:**

- IAPMO listed to ASME A112.18.1-05 / CSA B125.1-05 (File # 0645)
- CSA listed to ASME A112.18.1-05 / CSA B125.1-05 (File # 204593)



*This specification and all information contained herein is the confidential and exclusive property of BrassCraft Manufacturing, and shall not be disclosed to others without the written consent of BrassCraft. This specification must be returned to BrassCraft if requested.*

**BrassCraft®**