

Direct Mount Ball Valve

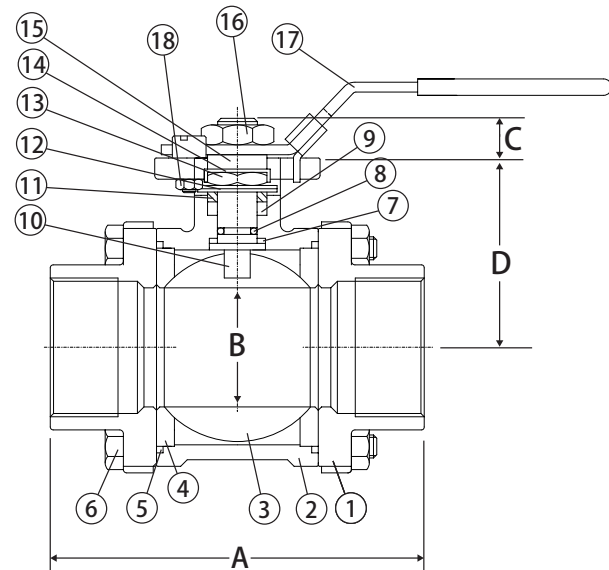

**3 Piece 4 Bolt • Full Port • V Ball • Threaded Connection •
1000 WOG • with ISO Mounting Pad**

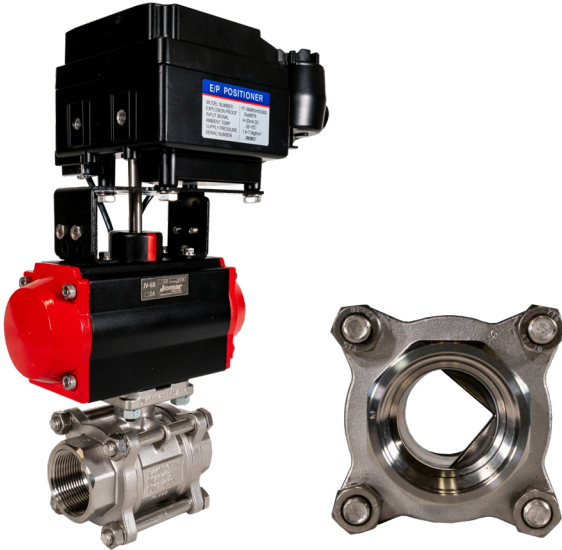

A1000 V Ball (actuator and accessories not included)

Features

- Blow out proof stem
- V Ball for control valve in 30 ° , 60 ° , 90 ° positions
- Adjustable stem packing
- Available seats: PTFE, TFM1600, & TFM4215
- ISO 5211 mounting pad
- 3-piece swing out body
- Wetted surface contains less than .25% lead content
- Spring return handle available

Approvals

- MSS SP-110
- ANSI B1.20.1

Material Specifications

No.	Part	Materials
1	Body	CF8M Stainless Steel
2	End Cap (2)	CF8M Stainless Steel
3	Ball	CF8M Stainless Steel
4	Seat (2)	PTFE or TFM1600 or FM4215
5	Gasket	316 Stainless Steel
6	Bolts	304 Stainless Steel
7	Thrust Washer	PTFE
8	O-Ring	Viton®
9	Stem Packing	PTFE
10	Stem	304 Stainless Steel
11	Gland	301 Stainless Steel
12	Disk Washer	304 Stainless Steel
13	Stem Nut	304 Stainless Steel
14	Nut Stop	304 Stainless Steel
15	Space Washer	304 Stainless Steel
16	Handle Nut	304 Stainless Steel
17	Handle	304 Stainless Steel
18	Nut	304 Stainless Steel

Dimensions

Part No.	Size	A	B	C	D	Torque	ISO
A1000-14	1/4"	2.38	0.43	1.46	0.43	40	F03/4
A1000-38	3/8"	2.38	0.49	1.46	0.43	40	F03/4
A1000-12	1/2"	2.50	0.59	1.46	0.43	40	F03/4
A1000-34	3/4"	2.97	0.79	1.57	0.43	60	F03/4
A1000-1	1"	3.39	0.98	1.89	0.55	70	F04/5
A1000-114	1-1/4"	3.78	1.26	2.11	0.55	110	F04/5
A1000-112	1-1/2"	4.37	1.50	2.50	0.71	170	F05/7
A1000-2	2"	5.08	1.97	2.83	0.71	250	F05/7
A1000-212	2-1/2"	6.00	2.56	3.62	0.87	650	F07/10
A1000-3	3"	6.63	3.15	4.02	0.87	850	F07/10
A1000-4	4"	8.37	3.94	5.20	1.02	950	F010/12

Note: Torque is in (in-lb)



WARNING: This product can expose you to chemicals including diisononyl phthalate (DINP), which is known to the State of California to cause cancer, and diisononyl phthalate (DINP), which is known to the State of California to cause birth defects or other reproductive harm. For more information go to www.P65Warnings.ca.gov.

Valve Seat Rating

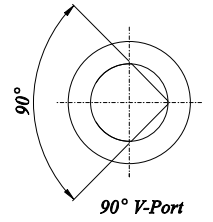
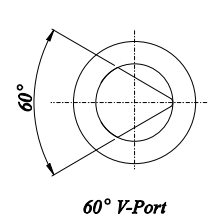
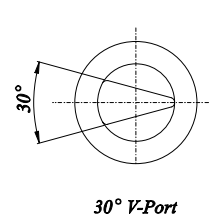
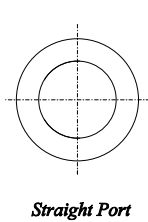
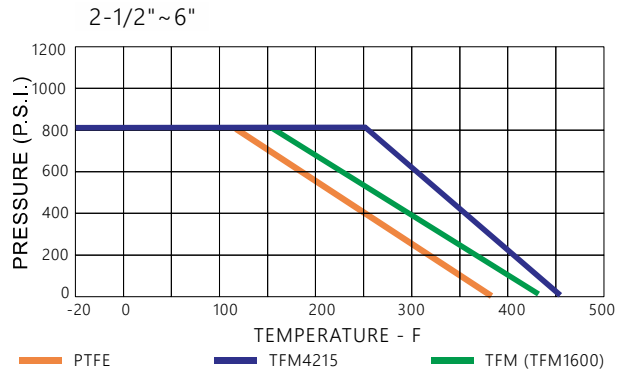
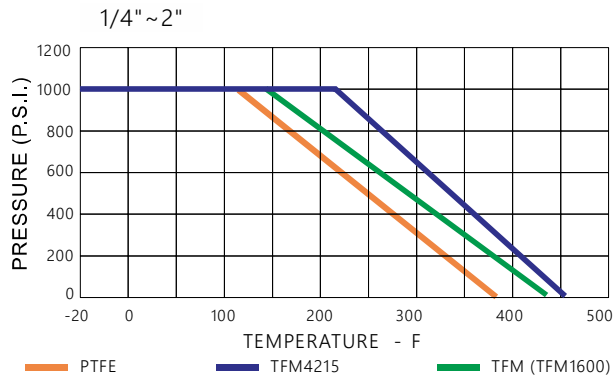

Cv Factor

2-way ball valve, full bore, A1000 and A2020D

Size	V-Notch	Percent of Ball Rotation										
		0%	10%	20%	30%	40%	50%	60%	70%	80%	90%	100%
1/2"	30°	0	0.00	0.03	0.11	0.31	0.50	0.92	1.34	1.85	2.67	3.26
1/2"	60°	0	0.00	0.06	0.35	0.75	1.32	2.12	3.27	4.90	7.12	10.51
1/2"	90°	0	0.00	0.09	0.40	0.90	1.62	2.68	4.29	6.96	9.96	14.44
3/4"	30°	0	0.00	0.06	0.24	0.69	1.13	2.07	3.02	4.17	6.00	7.32
3/4"	60°	0	0.00	0.13	0.31	0.89	1.56	2.73	4.31	6.43	10.89	17.53
3/4"	90°	0	0.00	0.14	0.37	1.13	1.98	3.53	5.86	8.93	15.62	26.31
1"	30°	0	0.00	0.11	0.42	1.23	2.01	3.68	5.38	7.41	10.66	13.02
1"	60°	0	0.00	0.30	0.92	1.92	3.34	5.27	8.05	11.89	17.73	26.35
1"	90°	0	0.00	0.37	1.21	2.49	4.38	7.08	11.23	17.24	26.48	41.39
1-1/4"	30°	0	0.00	0.28	0.75	1.76	4.81	6.38	9.75	13.82	21.01	29.15
1-1/4"	60°	0	0.00	0.51	1.57	3.19	5.52	8.75	13.23	19.76	29.12	40.98
1-1/4"	90°	0	0.00	0.66	2.08	4.20	7.22	11.70	18.64	28.52	44.49	68.10
1-1/2"	30°	0	0.00	0.74	2.09	3.47	6.13	8.35	12.93	18.87	28.77	40.84
1-1/2"	60°	0	0.00	0.49	1.85	4.15	7.50	11.90	18.31	27.92	41.51	68.82
1-1/2"	90°	0	0.00	0.65	2.17	5.02	9.19	15.32	24.73	38.93	60.92	110.16
2"	30°	0	0.00	1.31	3.71	6.16	10.89	14.85	22.99	33.55	51.15	72.60
2"	60°	0	0.00	0.98	3.45	7.26	13.24	18.34	29.37	50.22	73.08	121.90
2"	90°	0	0.00	1.04	4.05	8.89	16.46	24.50	41.37	75.67	112.59	184.80
2-1/2"	30°	0	0.00	2.14	6.06	10.06	17.79	24.26	37.55	54.80	83.55	118.59
2-1/2"	60°	0	0.00	1.78	5.07	9.49	21.63	29.95	47.98	78.89	120.16	177.36
2-1/2"	90°	0	0.00	2.36	7.02	14.02	29.97	42.85	71.86	121.57	197.06	329.35
3"	30°	0	0.00	2.84	7.52	15.60	25.49	37.16	54.90	76.23	108.40	141.89
3"	60°	0	0.00	3.60	11.73	21.36	33.25	51.10	89.62	124.55	203.32	312.96
3"	90°	0	0.00	4.64	12.49	29.40	46.12	71.73	124.02	192.73	325.54	558.35
4"	30°	0	0.00	5.27	13.95	28.94	47.28	68.93	101.84	141.41	201.08	263.21
4"	60°	0	0.00	5.68	18.75	38.62	69.68	108.51	139.24	218.15	338.83	529.60
4"	90°	0	0.00	7.40	22.29	42.36	73.74	127.57	211.50	305.31	603.95	987.30