

1515 1/2"-2"

Bronze Check Valve
150 SWP - 300 WOG †
Horizontal Swing • Solder Ends
Bronze Disc
Conforms to: MSS SP-80

MATERIAL LIST			
No.	PART	MATERIAL	SPECIFICATION
1	Body	Bronze	ASTM B62
2	Cap	Bronze	ASTM B62
3	Lever	Stainless Steel	Commercial
4	Disc	Brass	ASTM B16 1/2" to 3/4"
		Brass	ASTM B453 1" - 1 1/2"
		Bronze	ASTM B62 2"
5	Pin	Stainless Steel	Commercial
6	Plug (not shown)	Brass	ASTM B16
7	Retaining Ring	Stainless Steel	Commercial

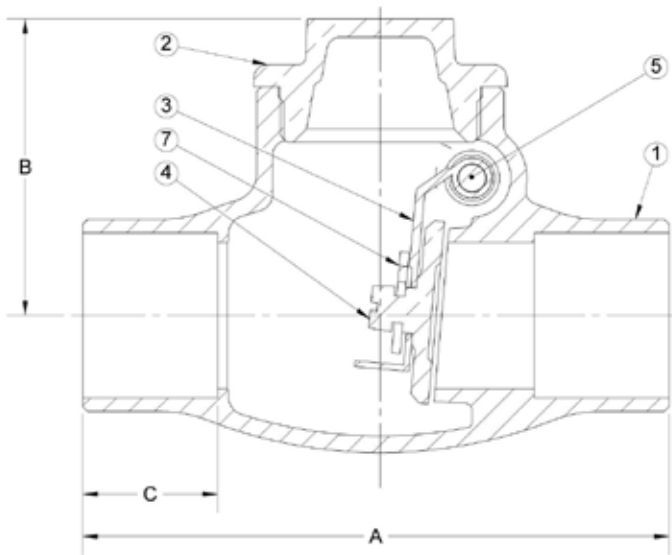

Note: Not intended for use in potable water.

DIMENSIONS - INCHES/MILLIMETERS					
Units	Size	A	B	C	C _v
Inches mm	1/2	2.75 70	1.32 34	0.50 13	10.0
Inches mm	3/4	3.31 84	1.69 43	0.75 19	18.0
Inches mm	1	4.00 102	1.97 50	0.91 23	31.0
Inches mm	1 1/4	4.25 108	2.16 55	0.97 25	54.0
Inches mm	1 1/2	4.94 125	2.41 61	1.09 28	76.0
Inches mm	2	6.13 156	2.81 71	1.34 34	131.0

† Non-Shock

INNOVATION IN EVERY VALVE

The information presented on this sheet is correct at time of publication. Milwaukee Valve reserves the right to change design and/or materials without notice. For our Installation, Operation and Maintenance Manual and the most current product information go to www.milwaukeevalve.com.  State of California Prop 65
WARNING: Cancer and Reproductive Harm. For more information visit www.p65warnings.ca.gov.

MILWAUKEE VALVE