

# Delsia 6636

Model number:	106193
---------------	--------

Dimensions:	66" x 36" x 27"	Installation:	Freestanding	Material:	AcrylX™ Ap-
-------------	-----------------	---------------	--------------	-----------	-------------





Standard Features:
<ul style="list-style-type: none"><li>• 2-piece bathtub with symmetrical look and concealed seam</li><li>• Ample deck space for faucet installation</li><li>• Maximized bathing well, raised backrest and off-center drain</li><li>• Above-the-Floor Rough (AFR) and F² Drain compatible</li><li>• MAAX innovative leveling legs for easy installation</li></ul>
Product characteristics:
<ul style="list-style-type: none"><li>• Made in North America</li><li>• Deck Space for Faucet</li><li>• Transitional design</li></ul>
Warranty:
Lifetime limited

## Standard colors:

	White (002)
--	-------------

Certifications

MAAX products adhere to one or more of the following certifications:



## Options (Visit our website for a complete list of our options)

No	Description
<input type="checkbox"/> OPT 20137	Cable-operated waste and overflow
<input type="checkbox"/> OPT 20210	Waste and overflow

Delsia 6636

Model number:

106193

Dimensions:

66" x 36" x 27"

Installation:

Freestanding

Material:

AcrylIX™ Ap-

1

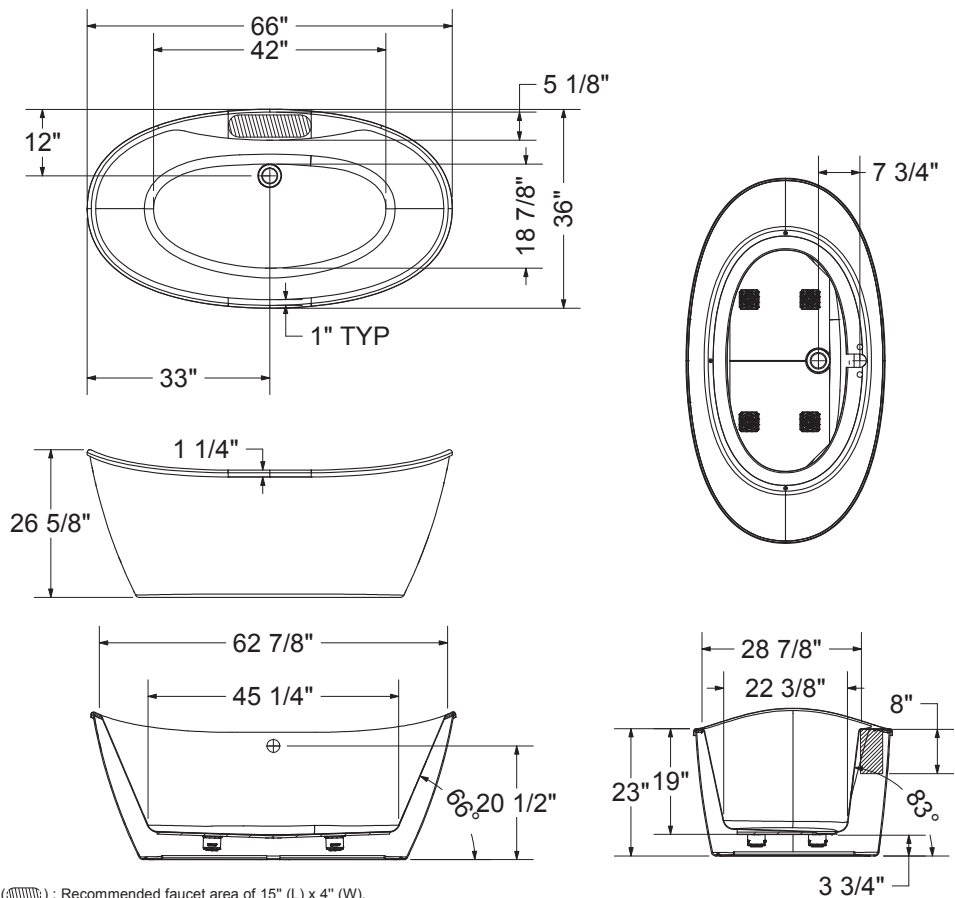

<b>Dimensions:</b>
66 x 36 x 26 5/8 in. (1676 x 914 x 676 mm)
<b>Water capacity:</b>
59 gallons - 223 liters
<b>Weight:</b>
110 lbs - 49.89 kg
<b>Bathing well:</b>
62 7/8 X 28 7/8 in. (1597 X 733 mm)
<b>Deep sump height:</b>
18 1/2 in. - 470 mm
<b>Deck width:</b>
5 in. - 127 mm
<b>Drain location:</b>
Center

(): Recommended faucet area of 15" (L) x 4" (W).  
Depth recommended for straight pipes 8".  
All dimensions are approximate. Structure measurements must be verified against the unit to ensure proper fit.

Project:

Contractor:

Representative:

Date:

Tel:

Notes: