



VARISTONE™, TOPAZ™, DURAWALL®, BATHTUB WALLS & DURATRIM™ WINDOW KITS

E. L. Mustee & Sons, Inc. bathtub walls are designed with durability and style.

We have direct-to-stud bathtub walls systems to fit 30" x 60" bathtubs and 32" x 60" bathtubs. Select Mustee bathtub wall systems are also available for other bathtub sizes.

Code Accepted

VARISTONE™, TOPAZ™ and DURAWALL® Fiberglass Bathtub Walls meet or exceed performance requirements as indicated:

- American Society of Testing and Materials (ASTM) – E-84 
- American National Standards Institute (ANSI) – Specification Z 124-2017 
- CAN/ULC S102-07 Burn and Smoke Test

Common Features of the TOPAZ™ Bathtub Walls, Models 660 Series, 670WHT, 680WHT, 680-32WHT, & 680WHTBB



- Panels with tongue-and-groove seams.



- Reverse side of center panel has clips for securing to bathtub.



- 1 1/4" flanges fasten direct-to-stud walls with screws, drywall conceals flanges.

572T VARISTONE™ Tall Premium Fiberglass Bathtub Walls – Adhesive Mount, Code Accepted



572T VARISTONE™ bathtub walls shown with T6030R bathtub, shower head and valve.

Mustee's VARISTONE™ premium fiberglass, Model 572T bathtub wall surround brings together a classic design, high quality finish and upscale embossed tile pattern across its expansive 72" tall walls.

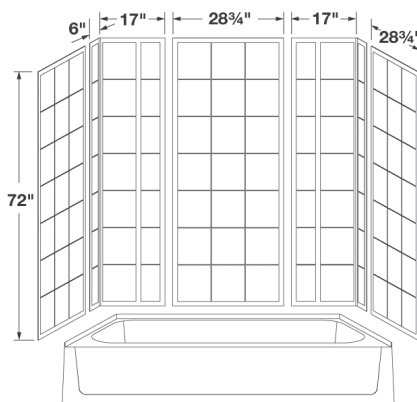

Model Color

572TWHT	White
572TBN	Bone

Fits Up to 60" Wide by 34" Deep

General: Furnish and install as shown on plans, fiberglass VARISTONE™ Bathtub Walls Model 572T as manufactured by E.L. Mustee & Sons, inc. Shall be semi-gloss, 5-piece wall system. Panels are molded using matched metal molds under extreme heat and pressure with a minimum thickness of 125 mils. Shall meet ANSI Specifications Z 124-2017 Colors: _____ (White, Bone)

680WHTBB TOPAZ™ Premium Fiberglass Bathtub Walls – Direct-To-Stud Mounted, with Baker Boards

NEW

680WHTBB – Model 680WHT with backer boards preinstalled at the factory for ADA applications. Inquire with us about quoted quantities. Yellow indicates placement of backer boards.

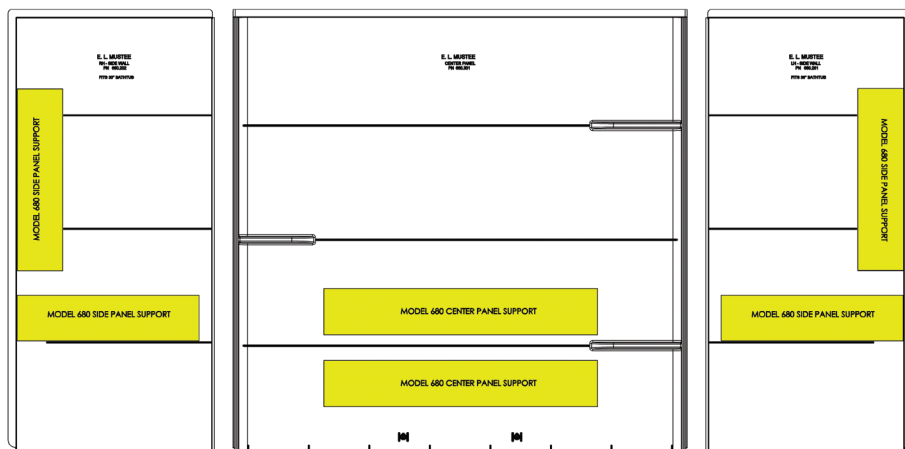

Features

- Compression molded fiberglass for strength
- Fits Topaz™ 30" x 60" Bathtubs and others
- Includes three self-draining selves molded
- Stylish tile pattern
- Three panel system with tongue-and-groove seams for a watertight surround
- Mounts direct-to-stud with mounting flanges hidden behind drywall
- Smooth, colorfast semi-gloss finish, resists scuffs
- Mold and mildew-resistant...easy to clean

Model Color

680WHTBB	White
----------	-------



572T VARISTONE™ SHOWER WALLS

Model 572T walls with their distinctive embossed tile pattern, fit perfectly with Mustee's DURABASE® shower floors and STYLEMATE® shower enclosures. CareGiver™ grab bars and seats can be easily installed.

Features

- Embossed 8 ⁵/₈" x 9 ³/₄" tile pattern on side and back panels
- Seamless corner panels are overlapped by the side and back panel and create a high-quality, watertight wall system
- Adhesive-mounts to drywall or like surfaces
- Colorfast, mold and mildew-resistant finish
- Easily trimmed for out-of-plumb alcoves or to install DURATRIM™ window trim kits
- 5 panel, package...two corners, two side walls and one back panel
- Designed to fit a maximum alcove range up to 39" wide by 42" deep... or up to 60" wide and by 34" deep
- 12" x 7" VARISTONE™ shelves can be used to create handy storage
- Available in white, bone and biscuit



572.300 VARISTONE™ — Shelves (Order Separately)

572.300

White

Order desired number of shelves separately. Sturdy shelf is easy to install. Carton is 12" x 7 ¹/₄" x 4" and weighs 2.5 lbs.

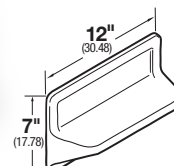
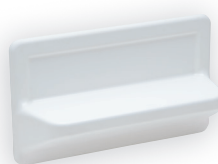

These self-draining 12" x 7" shelves easily mount to the shower wall at any location on the wall. Order multiple shelves to best meet your personal preference.

Code Accepted

VARISTONE™ Shower/Bathtub Walls meet or exceed performance requirements:

- American National Standards Institute (ANSI) — Specification Z 124-2017 

General: Furnish and install as shown on plans, VARISTONE™ Shower/Bathtub Shelf Model: 572.300, White, as manufactured by E. L. Mustee & Sons, Inc. Shall be semi-gloss, 1-piece molded shelf using matched metal molds under extreme heat and pressure. Shall meet ANSI Specification Z 124-2017.

572T VARISTONE™ — Shower/Bathtub Walls

Carton contains two side, one center, two corner panels and easy to follow, illustrated installation instructions. Carton is 7 ⁵/₈" x 32" x 76" and weighs 110 lbs.

Model

572TWH

Color

White

Up to 60" Wide by 34" Deep

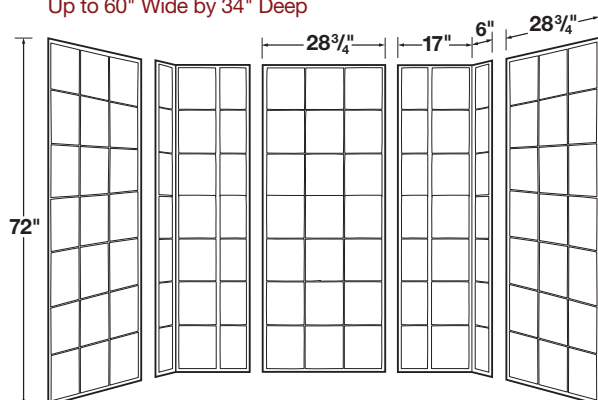

Reverse Corner Panels for Deep Alcoves
Up to 39" Wide by 42" Deep

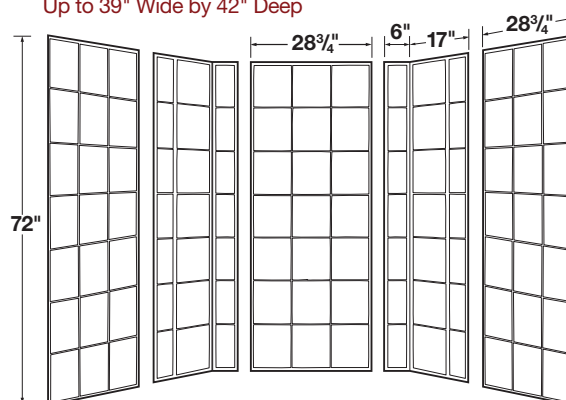

General: Furnish and install as shown on plans, fiberglass VARISTONE™ Shower/Bathtub Walls Model 572T as manufactured by E. L. Mustee & Sons, inc. Shall be semi-gloss, 5-piece wall system. Panels are molded using matched metal molds under extreme heat and pressure with a minimum thickness of 125 mils. Shall meet ANSI Specifications Z 124-2017 Colors: _____ (White, Bone)