

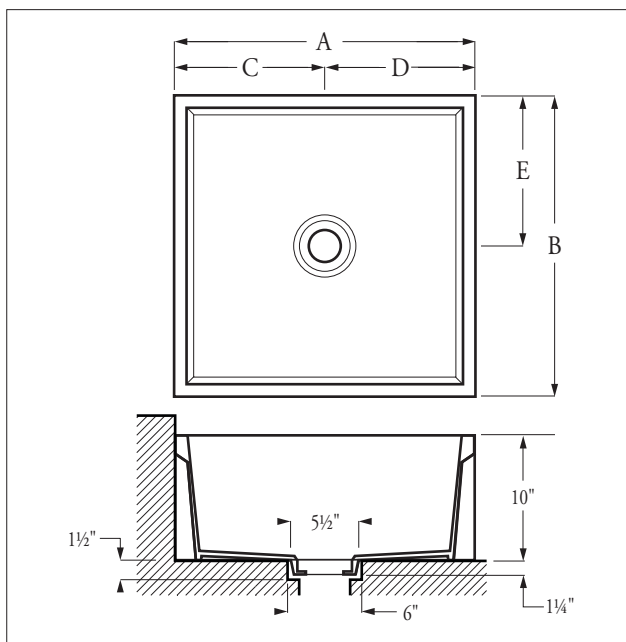

Molded one-piece construction for light weight and easy handling. Supplied with **Wedge-Lok™** seal, integral drain and chrome strainer.



Model	A	B	C	D	E	WT.
MSR-2424	24"	24"	12"	12"	12"	50
MSR-3624	36"	24"	18"	18"	12"	72

Standards:

I.A.P.M.O.	International Association of Plumbing and Mechanical Officials File No. 2646.
ANSI	American National Standards Institute - Specifications Z-124.6.
HUD/FHA	National Specifications UN-73.
CSA TEST	Warnock Hersey Listed: CAN / CSA - B45.0 - CAN / CSA - B45.5



Florestone Models MSR-2424/MSR-3624 Molded Mop Receptors

Architect's Specifications

Furnish and install molded Mop Receptor Model MSR-2424 / MSR-3624 (specify) as manufactured by Florestone Products Co. Molding will be done under heat and pressure using matched metal dies. The unit will be one piece with no seams. Shoulders will be no less than 1" wide and 9½" inside. Receptor will have ribbed underbody and integral drain providing for a no-caulked connection to a 2" or 3" ABS pipe (specify drain size). Drain grid will be 18-gauge stainless steel, flat type, #430.

Molded mop sinks are supplied with **Wedge-Lok®** seal for use on ABS pipe only.

 **FLORESTONE**
A Spec Above.™

FLORESTONE PRODUCTS CO., INC.

2851 Falcon Drive • Madera, CA 93637

T. 559.661.4171 • T. 800.446.8827

F. 559.661.2070 • florestone.com