

Pose 6632

Model number:	101458
---------------	--------

Dimensions: 66" x 32" x 24" Installation: \$name Material: \$name



Standard Features:

- Rectangular shape bathtub with choices of two deck heights (3/8 or 2 in.) Please specify when ordering
- Drop-in or undermount¹⁰ installation or with integrated flange (IF) for alcove installation
- Textured floor
- Ample deck space for faucet installation
- Skirt with or without access panel available

Product characteristics:

- \$name
- \$name
- \$name

Warranty:

25 Years

Standard colors:

\$name

\$name

\$name

Certifications

MAAX products adhere to one or more of the following certifications:

UL

ICC
ES
PMG

Recommended doors (Visit our website for a complete list of our options)

No	Description
<input type="checkbox"/> OPT 10053	Chromatherapy
<input type="checkbox"/> OPT 10095	Water heater assembly
<input type="checkbox"/> OPT 10106	Metal trim kit for whirlpool and combined systems
<input type="checkbox"/> OPT 10260	Two 6-in. grab bars
<input type="checkbox"/> OPT 20029	Metal trim kit for Air Push Control

Pose 6632

Model number:

101458

Dimensions: 66" x 32" x 24"

Installation: \$name

Material: \$name

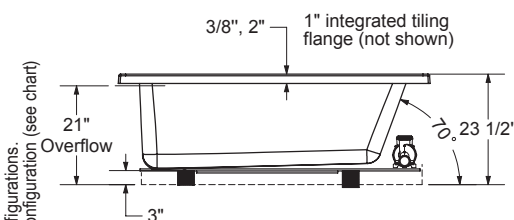
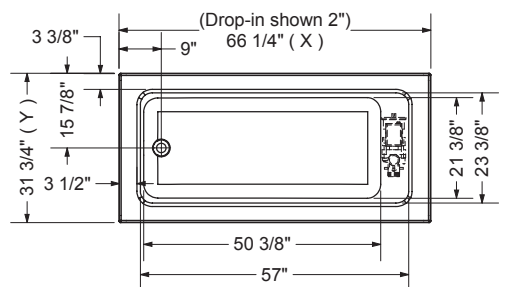

	DROP IN 2"	DROP IN 3/8"	ALCOVE / CORNER
X	66 1/4"	66"	65 3/4"
Y	31 3/4"	31 5/8"	31 5/8"

Technical drawing is universal for all 6632 configurations.

Wood support design may vary.
Integrated tiling flange: 1" height X 1/4" thickness (not shown)
Tiling flange position is determined by chosen configuration.



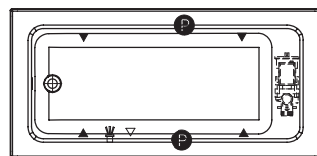

All dimensions are approximate.
Structure measurement must be verified against the unit to ensure proper fit.

WHIRLPOOL SYSTEM

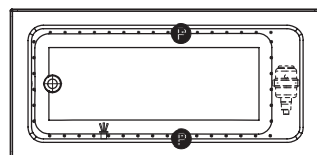

AIR SYSTEM



- () : Indicates optional grab bar positioning
- () : Indicates whirlpool jets positioning
- () : Indicates suction positioning
- () : Indicate airjets positioning
- () : Indicates chromatherapy light positioning

APRON (alcove version only)

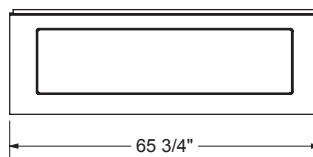

Project:

Contractor:

Representative:

Date:

Tel:

Notes: