

- Approvals & Certifications
- Wrot Copper
  - UNS C12200
  - Conforms to NSF/ANSI 61 Annex G
  - Conforms to ASME B16.22

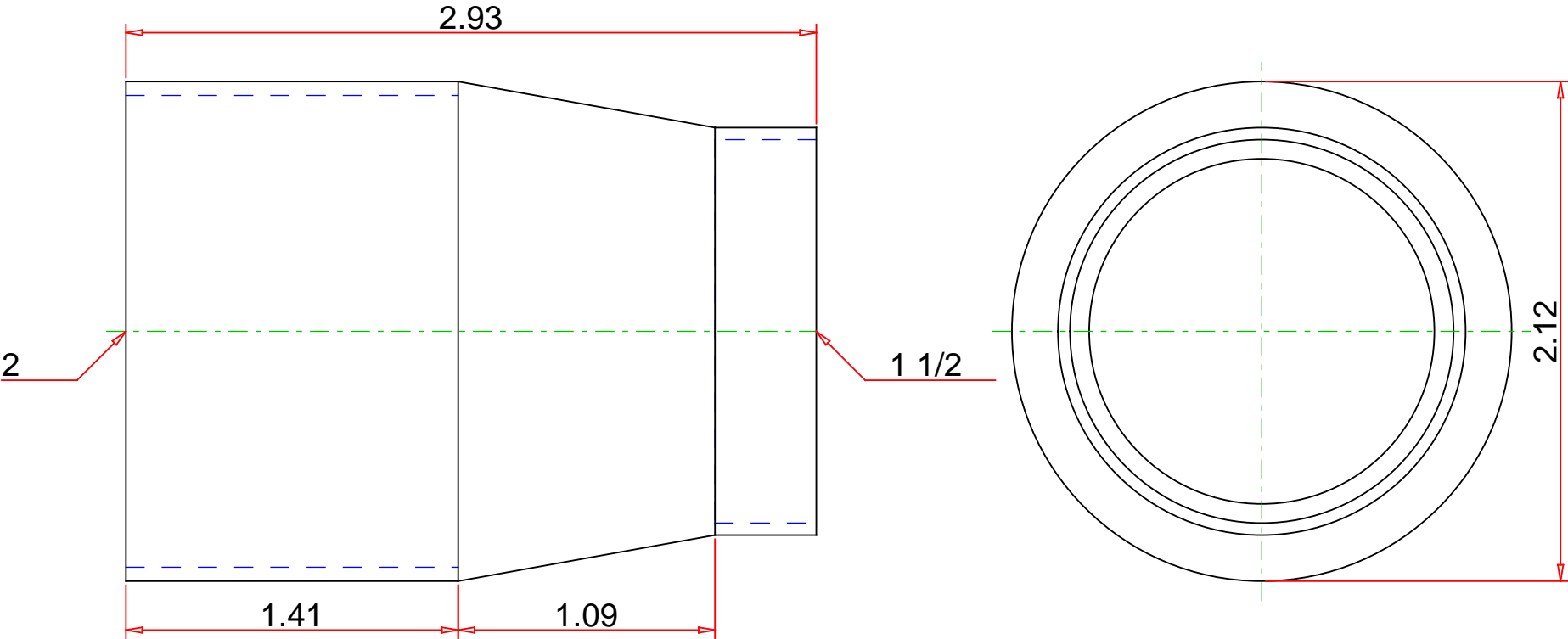

**Note : - Drawing not to Scale**

DISCLAIMER: DIMENSIONS ARE APPROXIMATE AND ARE SUBJECT TO CHANGE WITHOUT NOTICE. ALL ASME DIMS ARE MINIMUM UNLESS NOTED. LAY LENGTH DIMS ARE ± 0.06 ALL OTHER DIMS ARE NOMINAL. ALL DIMS ARE IN INCHES.

© 30-SEP-2022 Mueller Industries, Inc.

**Part No. :**

W 01358

**Description :**

Fitting Reducer, FTG x C, 2" x 1-1/2"



**Mueller Streamline Co.**

Address: 150 Schilling Blvd, Suite 201  
Collierville, TN 38017  
Phone: 901-751-7709  
Email: [marketing@muellerstreamline.com](mailto:marketing@muellerstreamline.com)  
Web: <https://www.muellerstreamline.com>