

ALPINE™

Residential

- Condensing
- High Efficiency
- Direct Vent
- Gas-Fired
- Water Boiler

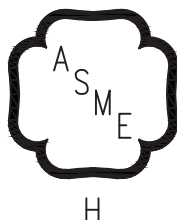

Models: 08 MBH through 285 MBH

As an ENERGY STAR® Partner, U.S. Boiler Company has determined that the ALPINE™ Series meets the ENERGY STAR® guidelines for energy efficiency established by the United States Environmental Protection Agency (EPA).



TO THE INSTALLER:

Affix these instructions adjacent to boiler.

TO THE CONSUMER:

Retain these instructions for future reference.



WARNING

Improper installation, adjustment, alteration, service or maintenance can cause property damage, injury, or loss of life. For assistance or additional information, consult a qualified installer, service agency or the gas supplier. This boiler requires a special venting system. Read these instructions carefully before installing.

XIII. Repair Parts

All Alpine™ Series Repair Parts may be obtained through your local U.S. Boiler Wholesale distributor. Should you require assistance in locating a U.S. Boiler distributor in your area, or have questions regarding the availability of U.S. Boiler products or repair parts, please contact U.S. Boiler Customer Service at (717) 481-8400 or Fax (717) 481-8408.

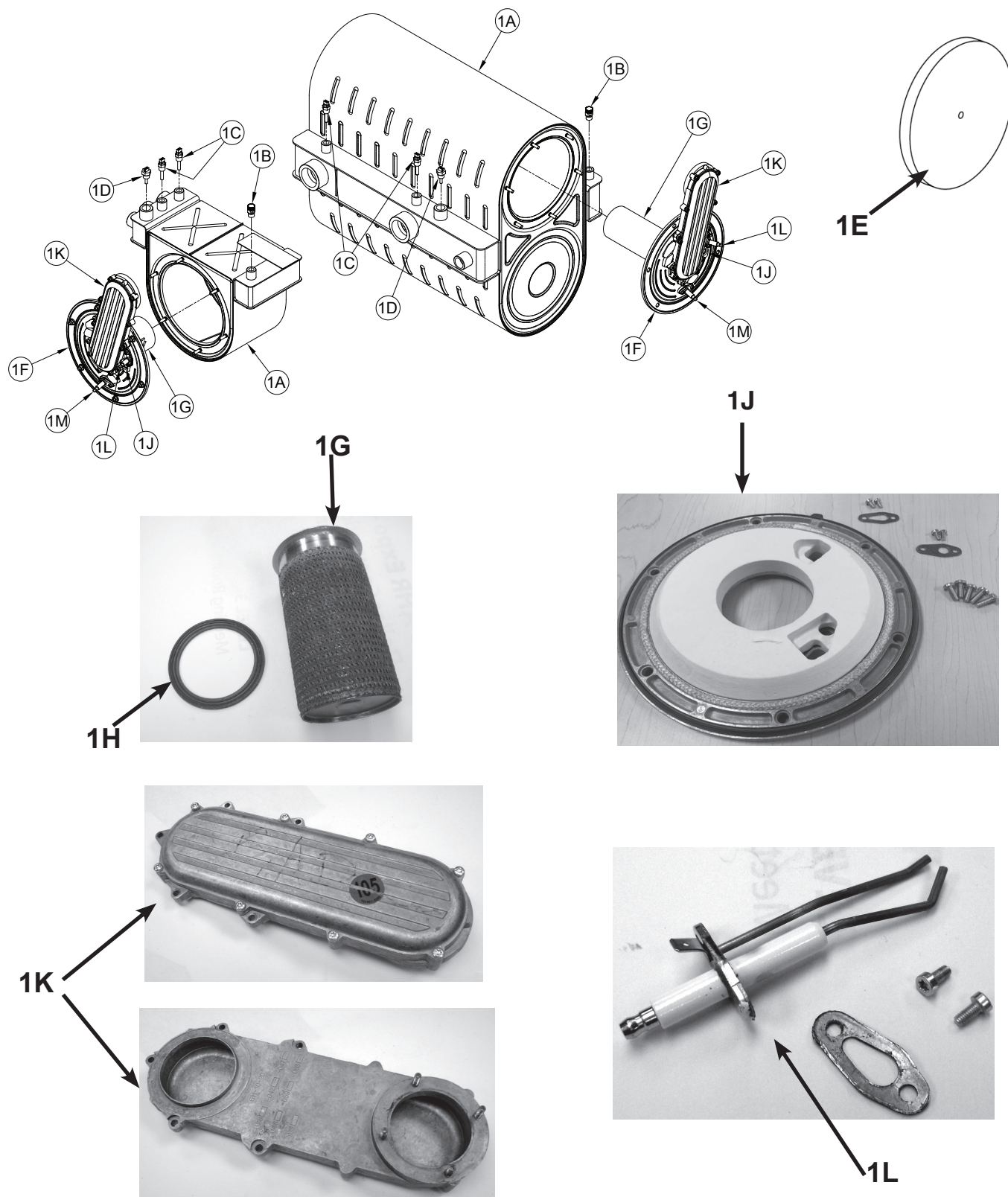

XIII. Repair Parts (continued)

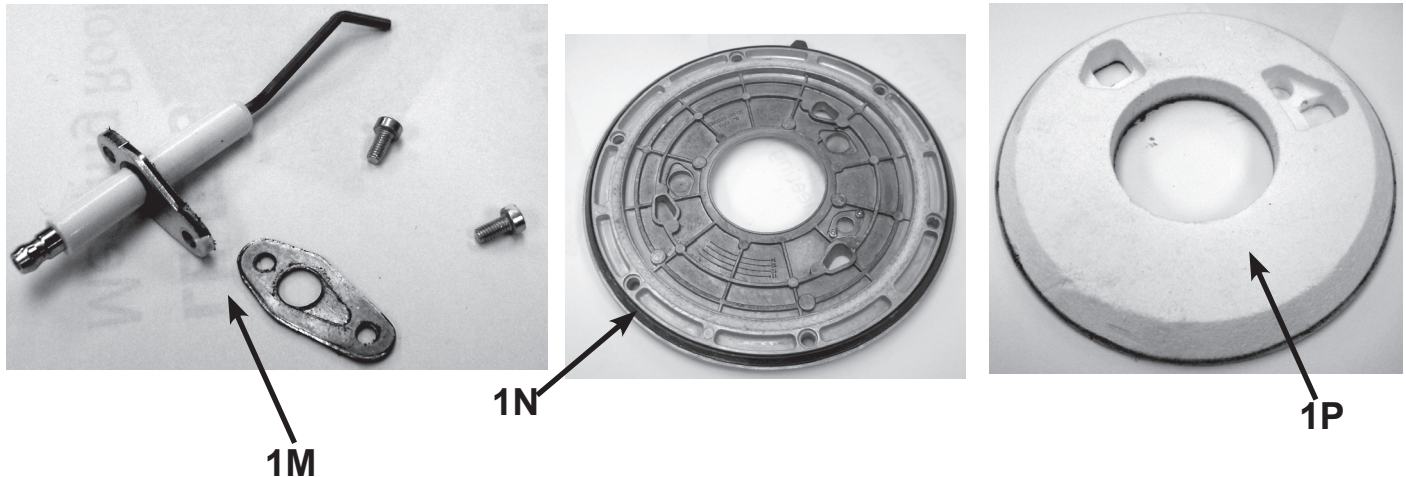

Key No.	Description	Part Number				
		ALP080B	ALP105B	ALP150B	ALP210B	ALP285B
Bare Heat Exchanger and Related Components (1B through 1E)						
1A	Replacement Heat Exchanger assembly (includes bare heat exchanger, supply and return water temperature sensors, air vent valve, high limit, header gaskets)	102513-01	102513-02	102513-03	102513-04	102513-05
1B	Air Vent Valve	101586-01				
1C	Supply/Return Water Temp Sensor- (2 per boiler)	101685-01				
1D	High Limit	107121-01				
1E	Replacement Rear Insulation Disc Kit	105651-01				
N/A	Replacement Rear Insulation Disc and Thermal Link Switch Kit (Not Shown, includes insulation disc, thermal link switch and instructions)	104998-01				
N/A	Thermal Link Switch (Backside of Duo Heat Exchanger) (Not Shown)	N/A				103321-01
N/A	Flue Exit Gasket Kit (Gasket is inside of Vent Termination of Heat Exchanger) (Not Shown, includes gasket and Molykot 111 grease)	104500-01				104501-01
Burner Components						
N/A	Replacement Burner Kit (Not Shown, includes burner head, burner head seal and hardware)	105188-01	105188-02	105188-03	105188-04	105188-05
1G	Burner Head	101731-01	101731-02	101731-03	101731-04	101731-05
1H	Burner Head Seal	102739-01				
1J	Replacement Burner Door Kit (Not Shown, includes partially assembled burner door, flame sensor & igniter gaskets, door insulation and thermostat. Does not include flame sensor and igniter)	105185-01				104992-01
1K	Gas/Air Intake Duct Assembly	101725-01			101725-02	
1L	Replacement Igniter Kit	103005-01				
1M	Replacement Flame Sensor Kit	103339-01				
1N	Burner Door Outer Seal	101730-01				
1P	Burner Door Insulation Kit (Warning: Contains RCF	105650-01				
N/A	Burner Door Thermostat with Manual Reset (Not Shown)	N/A				104569-01
N/A	Burner Door M6x1 Hex Flange Nut (Not Shown, 6 per boiler)	101724-01				
N/A	Replacement Gas/Air duct Kit (Not Shown, includes gas/air duct, duct gaskets and hardware)	105186-01			104994-01	