

1 System Data Sheet

ProPress Fitting Systems



Viega ProPress may only be pressed onto copper tube in accordance with ASTM B88 or B75. When pressing onto B88 copper tube, types K, L, and M may be used. Tempers O60 and O50, known as “soft copper”, are limited to nominal sizes ½" to 1¼". Temper H58, known as “hard copper”, may be used with nominal sizes ½" to 4".



When pressing onto B75 copper tube, additional considerations apply. See [Viega ProPress Copper Tube Compatibility Tech Data](#).

ProPress fittings are available in elbows, couplings, reducers, tees, reducing tees, threaded adapters, unions, caps, and flanges.

Components

- Alloy: Copper alloy - UNS C12200, Zero Lead silicon bronze alloy - C87710 (cast) or C87700 (machined)
- Peroxidically cured EPDM sealing element
- 420 stainless steel grip ring for 2½" to 4" fittings
- PBT separator ring for 2½" to 4" fittings

Operating Parameters

- Operating Pressure: 300 psi maximum
- Test Pressure: 600 psi maximum
- Operating Temperature: 0°F to 250°F

Listings and Certificates

- | | |
|-----------------|------------------------------------|
| ■ NSF/ANSI 61 | ■ ABS |
| ■ NSF/ANSI 372 | ■ CSA Low Lead Content |
| ■ IAPMO PS 117 | ■ ASME B16.51, B31.1, B31.3, B31.9 |
| ■ UL/ANSI 213 | ■ NFPA 13, 13D, 13R |
| ■ FM Class 1920 | |
| ■ ICC-ES IC1002 | |

Compliant With

- ASME B31
- ASTM B75
- ASTM B88
- IAPMO National Standard Plumbing Code (NSPC)
- IAPMO Uniform Mechanical Code (UMC)
- IAPMO Uniform Plumbing Code (UPC)
- ICC International Mechanical Code (IMC)
- ICC International Plumbing Code (IPC)
- ICC International Residential Code (IRC)
- NFPA 13, 13D, and 13R

Contact your local Viega representative for details on local approvals.

Approved Applications

- Hot and cold potable water
- Rainwater/gray water
- Fire sprinkler (175 psi maximum)
- Chilled water
- Hydronic heating (with glycol)
- Low pressure steam (15 psi maximum) with FKM sealing element swap
- Residential steam (5 psi maximum)
- Ethanol
- Compressed Air
- Non-medical gases
- Vacuum (29.2" Hg maximum @ 68°F)

ProPress fittings are approved for installations in both above and below ground applications. Per code, local inspector approval must be obtained prior to installation below ground.

Smart Connect® Technology

ProPress fittings are manufactured with Viega’s unique Smart Connect technology. A design of the fitting, Viega Smart Connect technology allows identification of an unpressed fitting during pressure testing.

Viega ProPress Ball Valve Zero Lead Brass P x P - Model 2971.1XL

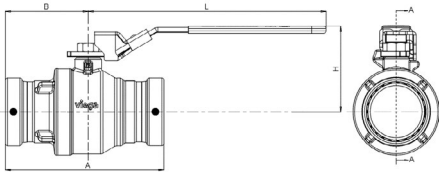

Part No.	Size (in)	A (in)	B (in)	H (in)	L (in)	Weight (lbs)
78300	2½	7.47	3.91	4.02	11.22	7.0
78305	3	8.15	4.17	4.37	11.22	9.7
78310	4	9.72	4.99	5.12	11.22	17.5

Viega ProPress Ball Valve Zero Lead Bronze P x P - Model 2971.3ZL

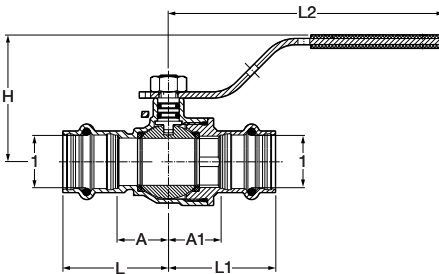

Part No.	Size 1 1	A (in)	A1 (in)	L (in)	L1 (in)	L2 (in)	H (in)
79923	½ x ½	0.75	0.75	1.57	1.57	4.57	1.97
79928	¾ x ¾	0.85	0.87	1.75	1.77	4.57	2.09
79933	1 x 1	1.02	1.06	1.93	1.96	5.75	2.46
79938	1¼ x 1¼	1.14	1.12	2.17	2.15	5.75	2.67
79943	1½ x 1½	1.46	1.25	2.87	2.67	6.12	3.02
79948	2 x 2	1.73	1.47	3.31	3.05	6.12	3.32

Viega ProPress Ball Valve Zero Lead Bronze P x FPT - Model 2971.4ZL

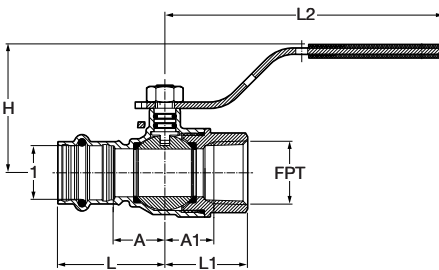

Part No.	Size 1 x FPT	A (in)	A1 (in)	L (in)	L1 (in)	L2 (in)	H (in)
79970	½ x ½	0.73	0.66	1.57	1.20	4.57	1.97
79975	¾ x ¾	0.85	0.79	1.75	1.35	4.57	2.09
79980	1 x 1	1.02	0.98	1.93	1.63	5.75	2.46

Viega ProPress Ball Valve Zero Lead Bronze P x Hose - Model 2971.6ZL

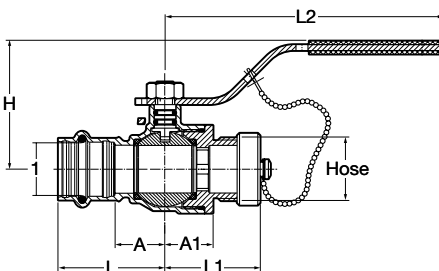

Part No.	Size 1 x Hose	A (in)	A1 (in)	L (in)	L1 (in)	L2 (in)	H (in)
79875	½ x ¾ GH	0.75	0.79	1.57	1.56	4.57	1.99
79876	¾ x ¾ GH	0.85	0.79	1.75	1.56	4.57	2.10