

Tech Data

Viega Diverting Valves



This document is subject to updates. For the most current Viega technical literature please visit www.viega.us.



Viega products are designed to be installed by licensed and trained plumbing and mechanical professionals who are familiar with Viega products and their installation. **Installation by non-professionals may void Viega LLC's warranty.**

Description

Three-way diverting valves can be used for temperature control in many heating and snowmelting applications.

Features

- Includes solder tailpieces (1¼" and 1½" models use same valve body with different tailpieces)
- Pre-installed high limit kit
- Compatible with most Viega actuators
 - Three Position - 18003
 - Proportional Actuator - 0-10v 18025
 - Non-electric Models - 16101, 16102, 16104, 16105, 16115

Specifications

Materials

- Bronze valve body
- Brass and corrosion-resistant steel internal components
- EPDM rubber seals

Actuator threads: M30 x 1.0

- Max working temperature: 242°F (120°C)
- Max working pressure: 145 psi (10 bar)

Max differential pressure

(tight shut-off on both end positions of valve discs)

- ¾" 10.9 psi (75 kPa)
- 1" 7.3 psi (50 kPa)
- 1¼" 2.9 psi (20 kPa)
- 1½" 2.9 psi (20 kPa)

Pressure Drop

Pressure drop values for Viega diverting valves may be determined from the chart at right below. 1¼" and 1½" models share the same valve body, so the pressure drop for these models is the same

Part No.	Size (in)	Type	L (in)	H (in)	H1 (in)	Weight (lbs)	Cv Rating	Flow (gpm)	Heat Capacity (BTU/H)	Pressure Drop (psi)	Pressure Drop (ft of head)
20001	¾"	Solder	3.15	3.94	1.85	2.2	5.3	5 6	50,000 60,000	0.9 1.3	2.0 2.9
20002	1"	Solder	3.54	4.06	1.97	3	7.6	7 9	70,000 90,000	0.8 1.4	2.0 3.2
20003	1¼"	Solder	4.53	4.65	2.52	6.1	11.1	10 12	100,000 120,000	0.8 1.4	1.9 2.7
20041	1½"	Solder	4.53	4.65	2.52	6.1	11.1	13 14	130,000 140,000	1.4 1.6	3.2 3.7

Note: Heat capacity is based on water at a ΔT of 20°F. The fluid used to calculate pressure drop across the valve is water @ 100°F

Dimensions

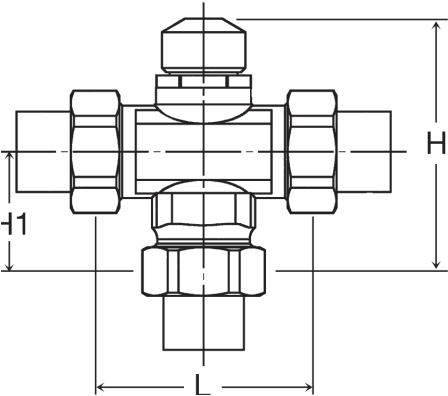

Part No.	Size (in)	L (in)	H (in)	H1 (in)
20001	¾	3.15	3.94	1.85
20002	1	3.54	4.06	1.97
20003	1¼	4.53	4.65	2.52
20041	1½	4.53	4.65	2.52

Soldered Tailpiece

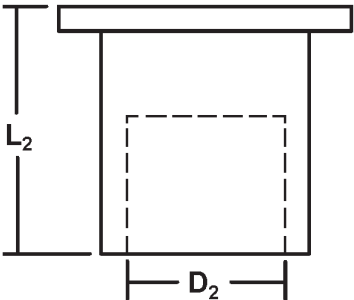

Size (in)	D2 (in)	L2 (in)
¾	0.875	0.91
1	1.125	1.18
1¼	1.375	1.57
1½	1.625	1.26

ProPress Tailpiece

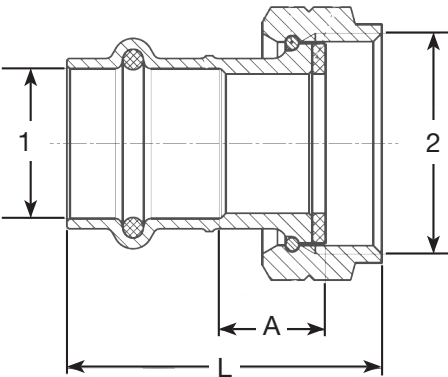

Diverting Valve Part No.	Tailpiece Part No.	Size	A (in)	L (in)
		1 2		
20001	79805	¾" x 1" BSP	0.63	1.87
20002	79815	1" x 1¼" BSP	0.72	2.04

Viega LLC
585 Interlocken Blvd.
Broomfield, CO 80021

Phone (800) 976-9819
www.viega.us

TD-HC 1119 Diverting Valves

