

SPECIFICATION AND INSTALLATION GUIDE

AGS1

Above Grade Support Kit for use with Grease
Interceptor Model GB-250

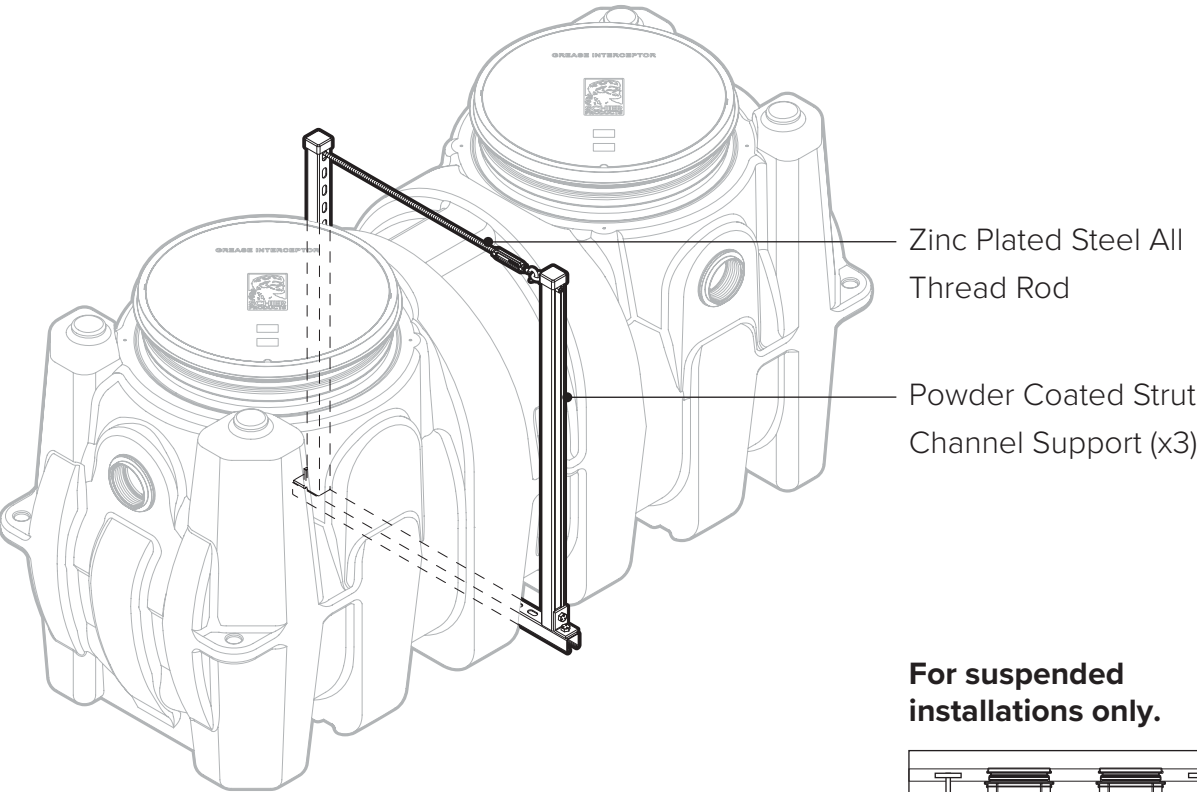

**For suspended
installations only.**

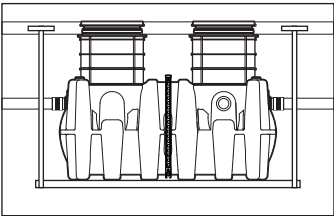

Contents

Specifications	1
Special Precautions	2
Getting to Know the AGS1	3
Installation	4

Notes

1. Unit weight: 20 lbs.

Engineer Specification Guide:

Above grade support kit for use with model GB-250 suspended installations. To consist of (3) powder coated steel strut channel supports, cast aluminum hook to eye turnbuckle and zinc plated steel fasteners and hardware.



SCHIER

MODEL NUMBER:
AGS1

PART #: 8020-003-01

DESCRIPTION: Above Grade Support Kit For Model GB-250 Suspended Installations

DATE: 01/01/2023

REV:

ECO:



SPECIAL PRECAUTIONS

For Schier Grease Interceptor Installations - Failure to follow this guidance voids your warranty

⚠ WARNING! DO NOT AIR TEST UNIT OR RISER SYSTEM!
Doing so may result in property damage, personal injury or death.

⚠ CAUTION! Do not install this unit in any manner except as described in these instructions.

Installation Instructions

Installation instructions and additional components are included with the interceptor. Read all instructions prior to installation. This support kit is intended to be installed by a licensed plumber in conformance with all local codes.

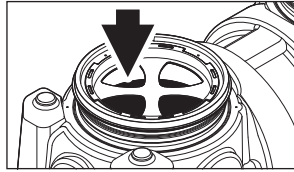

When Installing Interceptor Inside

If your dishwashing sink(s) discharges into a floor drain/sink (drain), you must regulate the flow into the drain to avoid an overflow of water onto the kitchen floor. This can be done by installing a valve or flow restriction cap on the sink piping that discharges into the drain. See drawing for guidance. For detailed

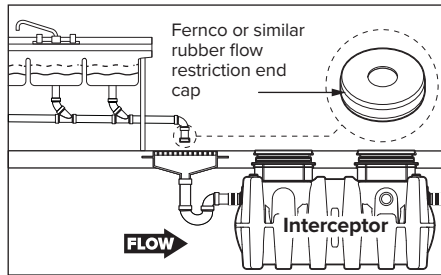

guidance on indirect connections, go to:
webtools.schierproducts.com/Technical_Data/Indirect_Connections.pdf

Suspended Installations

Design trapeze to support the wet weight of the unit. Do not partially support unit or suspend unit using metal U-channel to create a trapeze.

Suspended installations are typically used with a riser that penetrates the floor above. In these situations Above Grade Support Kit model AGS1 is required to maintain a proper seal of the risers on the neck of the tank.

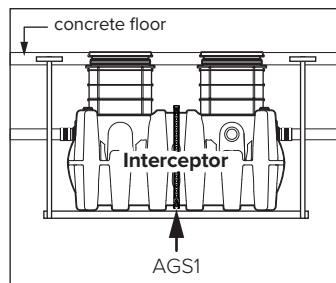

High Temperature Kitchen Water

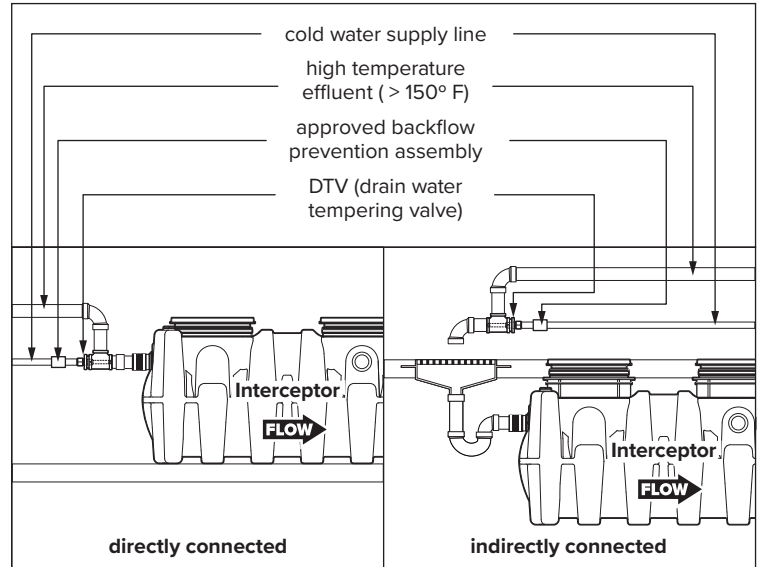

If water is entering the interceptor at excessive temperature (over 150° F), a drain water tempering valve (DTV) and approved backflow prevention assembly must be installed. Most state and local plumbing codes prohibit water above 150° F being discharged into the sanitary sewer. Water above 150° F will weaken or deform PVC Schedule 40 pipe, poly drainage fixtures like interceptors and erode the coating of cast iron (leading to eventual failure).

Support Inlet and Outlet Piping

For above grade installations ensure heavy inlet and outlet piping (such as cast iron or long runs) is properly supported or suspended during the entire installation process to prevent connection failure or damage to bulkhead fittings.

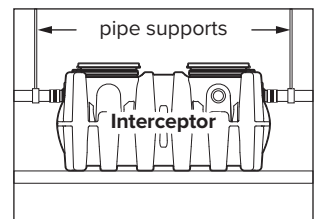

Fully Support Base of Unit

Install unit on solid, level surface in contact with the entire footprint of unit base

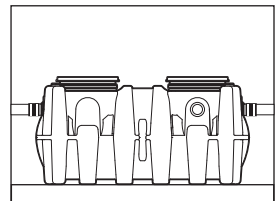

GETTING TO KNOW THE AGS1

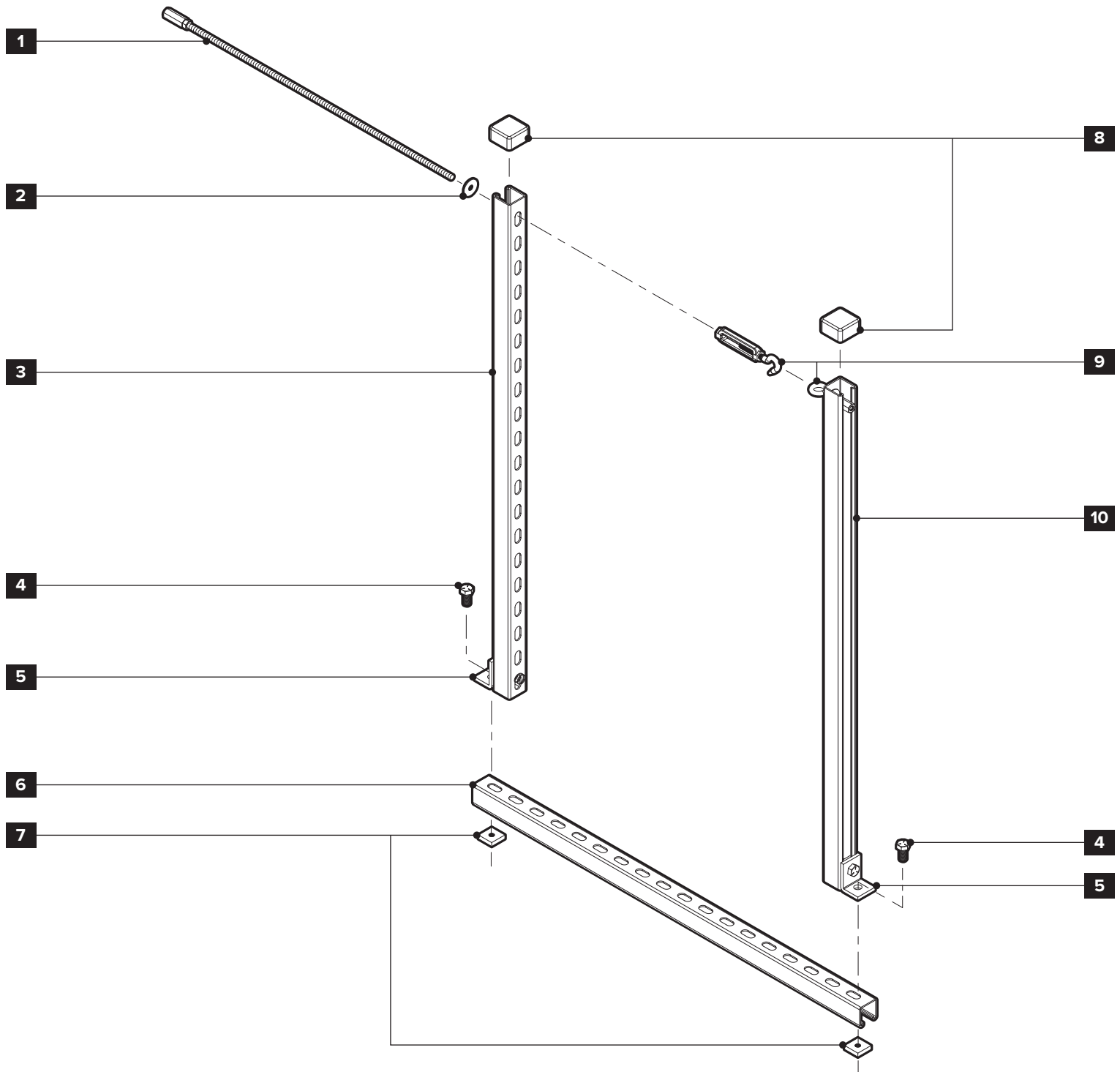

1. 3/8"-16 Zinc Plated Steel All Thread Rod
2. 3/8" Flat Washer
3. Strut Channel Left Side Support
4. 1/2"-13 x 1" Hex Bolt (x2)

5. Angle Brackets (pre-assembled to Strut Channel Side Supports using 1/2"-13 x 1" Hex Bolts and Strut Channel Spring Nuts) (x2)
6. Strut Channel Bottom Support
7. 1/2"-13 Unistrut Square Nut (x2)

8. Strut Channel Rubber Caps (x2)
9. 3/8"-16 Cast Aluminum Hook-to-Eye Turnbuckle (Eye removed and pre-assembled to Strut Channel Right Side Support)
10. Strut Channel Right Side Support

INSTALLATION

GENERAL ARRANGEMENT

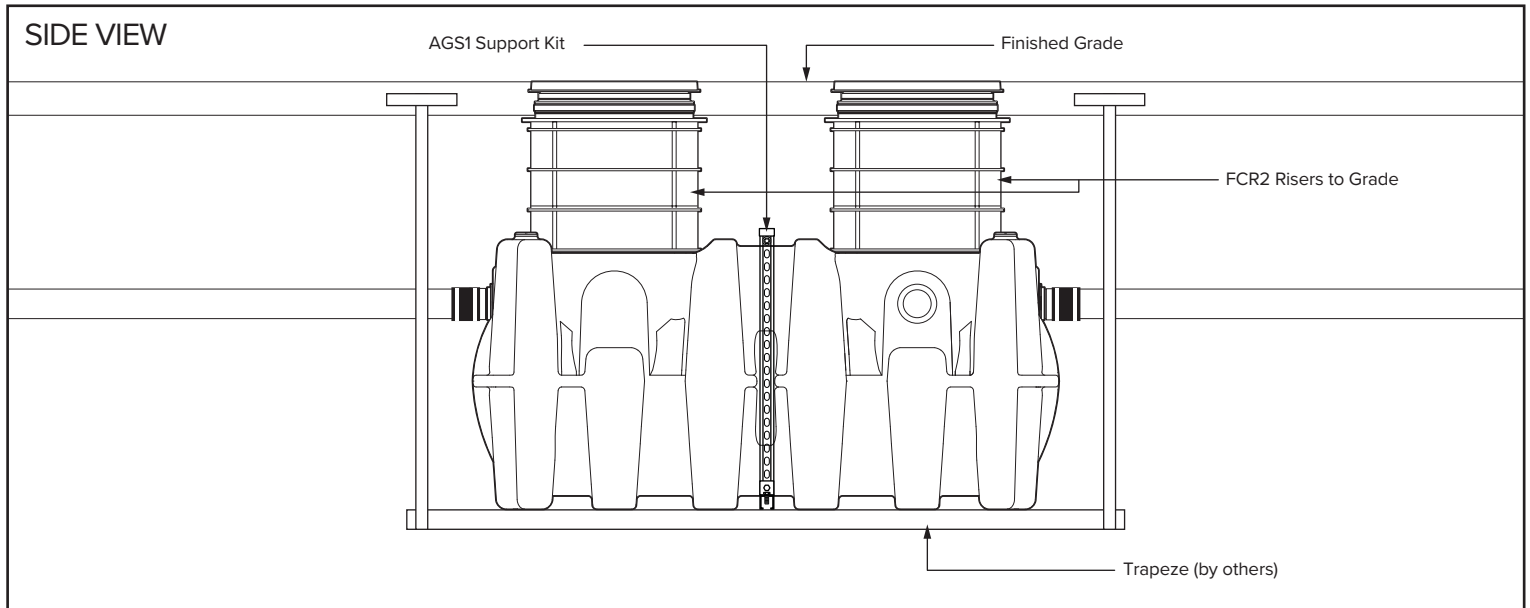

1. Slide the Strut Channel Bottom Support into position underneath the center of the interceptor as shown.
2. Attach the Strut Channel Side Supports as shown. Insert the 1/2" x 1" Hex Bolts through the Angle Brackets and Bottom Support into the Strut Channel Square Nuts and tighten securely.
3. Feed the All Thread Rod through the 3/8" Flat Washer, then through the top hole of the Left Side Support. Install the Turnbuckle by threading it onto the end of the All Thread Rod as shown. For now, the All Thread Rod and threaded hook should extend equally into the Turnbuckle (about 1/4").
4. Hook the All Thread Rod and Turnbuckle Assembly onto the eyebolt which was pre-installed onto the Right Side Support.
5. Rotate the Turnbuckle clockwise to pull the Side Supports snug up against the interceptor. Note that the parts are sized so that the turnbuckle stops rotating when the side supports are in the correct position.
6. Place the Strut Channel Rubber Caps onto the top of the Side Supports

