

For Residential and Commercial Applications

Job Name:

Engineer/Architect:

Job Location:

Wholesaler:

Submittal Date:

Contractor:

62-DT Series Compression x Compression Unions – Drill Through

Use: For use with potable and non-potable water, instrumentation, hydraulic, and pneumatic systems. Designed for use with aluminum, copper, and plastic tubing*. Not intended for use with steel tubing.

* Plastic tubing requires a plastic insert and sleeve (see 60PT & 63PT submittal forms for details)

Design Features:

- **Little to no tube preparation.** Compression fittings do not require flaring, soldering, or other types of tube preparation
- **Available in a broad range of sizes**
- 

Operating Specifications:

Temperature: -65° - 250° F at maximum operating pressures

Working Pressure: See chart below

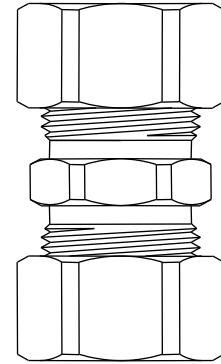

WORKING PRESSURE

PSI	Tube OD	Tube Wall (Inches)
300	1/4	0.030
200	3/8	0.032
200	1/2	0.032
150	5/8	0.035
75	7/8	0.035

MATERIAL SPECIFICATIONS

Body	Brass
Compression Sleeve	Brass
Compression Nut	Brass
Option	Plating

Part Listing:

- ☐ 62-4DT 1/4" OD tube x 1/4" OD tube, rough brass
- ☐ 62-6DT 3/8" OD tube x 3/8" OD tube, rough brass
- ☐ 62-6-1DT B 3/8" OD tube x 3/8" OD tube - body only, rough brass, bulk
- ☐ 62-8DT 1/2" OD tube x 1/2" OD tube, rough brass
- ☐ 62-8-1DT B 1/2" OD tube x 1/2" OD tube - body only, rough brass, bulk
- ☐ C14 C 5/8" OD tube x 3/8" OD tube, chrome plated
- ☐ C14 CBT 5/8" OD tube x 3/8" OD tube, chrome plated, plain tray, bulk

This specification and all information contained herein is the confidential and exclusive property of Brasscraft Manufacturing Company and shall not be disclosed to others without the written consent of Brasscraft Mfg. Co. This specification must be returned to Brasscraft Mfg. Co. if requested.

300.235 62DT Series Drill Through Union - Comp x Comp REV 9.19

BrassCraft®

©2019 Brasscraft Manufacturing Company

62-DT Series Compression x Compression Unions – Drill Through

Part Listing (con't):

<input type="checkbox"/>	C14 R	5/8" OD tube x 3/8" OD tube, rough brass
<input type="checkbox"/>	C14-1 CBT	5/8" OD tube x 3/8" OD tube - body only, chrome plated, plain tray, bulk
<input type="checkbox"/>	C14-1 RBT	5/8" OD tube x 3/8" OD tube - body only, rough brass, plain tray, bulk
<input type="checkbox"/>	C34 C	5/8" OD tube x 1/2" OD tube, chrome plated
<input type="checkbox"/>	C34 R	5/8" OD tube x 1/2" OD tube, rough brass
<input type="checkbox"/>	C34-1 CBT	5/8" OD tube x 1/2" OD tube - body only, chrome plated
<input type="checkbox"/>	C34-1 RBT	5/8" OD tube x 1/2" OD tube - body only, rough brass
<input type="checkbox"/>	62-10DT	5/8" OD tube x 5/8" OD tube, rough brass
<input type="checkbox"/>	62-10DT B	5/8" OD tube x 5/8" OD tube, rough brass, bulk
<input type="checkbox"/>	62-10-1DT B	5/8" OD tube x 5/8" OD tube - body only, rough brass, bulk
<input type="checkbox"/>	62-14DT	7/8" OD tube x 7/8" OD tube, rough brass
<input type="checkbox"/>	62-14-1DT B	7/8" OD tube x 7/8" OD tube - body only, rough brass, bulk

PART DIMENSIONS (Inches)				
Model	DIM. A	DIM. B	DIM. C	DIM. D
62-4DT	1.34	0.78	7/16	0.48
62-6DT	1.50	0.96	9/16	0.62
62-8DT	1.75	1.09	11/16	0.77
62-10DT	1.89	1.23	13/16	0.90
62-14DT	1.90	1.14	1-1/8	1.25
C14	1.75	1.12	13/16	0.90
C34	1.84	1.18	13/16	0.90

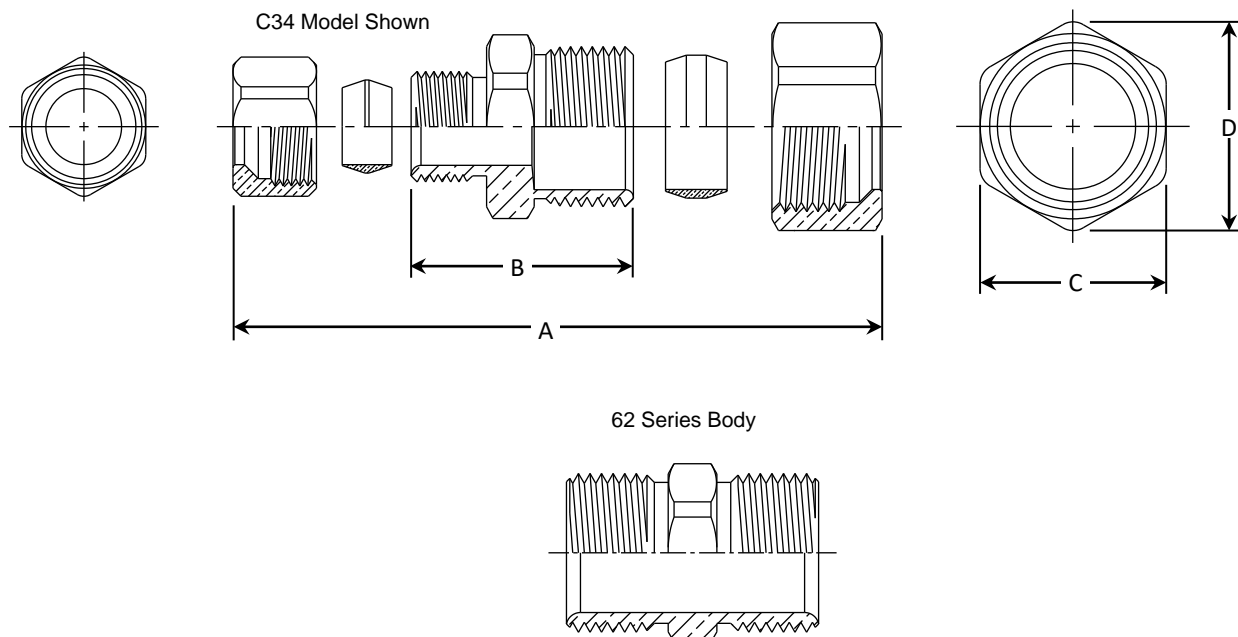

This specification and all information contained herein is the confidential and exclusive property of Brasscraft Manufacturing Company and shall not be disclosed to others without the written consent of Brasscraft Mfg. Co. This specification must be returned to Brasscraft Mfg. Co. if requested.

300.235 62DT Series Drill Through Union - Comp x Comp REV 9.19

BrassCraft®

©2019 Brasscraft Manufacturing Company