

401 Clevis Hanger – 4010250EG

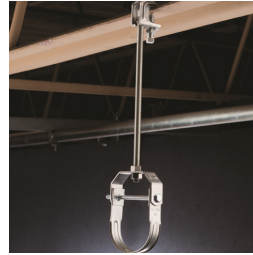

- Recommended for the suspension of stationary non-insulated pipe lines
- Flared edges help prevent sharp surfaces from coming into contact with the pipe (1/2" to 2" pipe sizes)
- Clevis bottom pivots to allow pipe to be fed from either direction
- Conforms with U.S. Federal Specification WW-H-171 (Type 1), Manufacturers Standardization Society (MSS) SP-58 (Type 1)

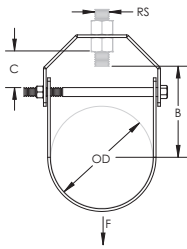

Part Number	4010250EG
Material	Steel
Finish	Electrogalvanized Pregalvanized
Pipe Size	2 1/2"
Outer Diameter (OD)	2 7/8"
Rod Size (RS)	1/2"
A	5 5/16"
B	3 1/16"
C	1"
Static Load (F)	1,130 lb
Certifications	cULus FM ITB
Standard Packaging Quantity	50 pc
UPC	78285636592
EAN-13	8711893038149

A shield is recommended for insulated pipe applications to effectively distribute the load.