

Rod Lock Preset Anchors

- Eliminate overhead drilling into building structure – Rod Lock Preset Anchors are cast in place
- Easy “push-to-install” design allows installers to simply push the threaded rod through the mounting hole, instantly holding it in position
- Works with slightly damaged threads and minor burrs on the threaded rod
- Prefabricated assemblies easily lift and lock into place, helping to save time and money
- Plastic flange acts as insert locator when the forms are removed
- Rod Lock Preset Anchors have a pending evaluation to AC446, Acceptance Criteria for Headed Cast-In Specialty Inserts in Concrete

Preset anchors for concrete that allow complex prefabricated threaded rod assemblies to be easily pushed into place.



ROD LOCK METAL DECKING PRESET ANCHOR

- Set in place through a drilled hole in the metal decking before the concrete is poured
- Can be used in lower and upper flute installations

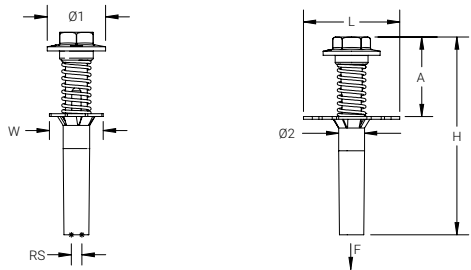

Material: Steel  
Finish: Electrogalvanized

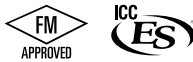

Part Number	Rod Size RS	Diameter 1 Ø1	Diameter 2 Ø2	Height H	Length L	Width W	A	Drill Bit Diameter	Static Load F
CRLM37EG	3/8"	1.65"	0.7"	5.6"	2.8"	1 1/2"	2.3"	3/4"	830 lb
CRLM50EG	1/2"	1.95"	0.8"	5.7"	2.8"	1 1/2"	2.4"	7/8"	830 lb

ROD LOCK PLYWOOD FORM PRESET ANCHOR

- Nails hold the anchor in place during the pour and easily break off with a strike of a hammer once the plywood forms are removed

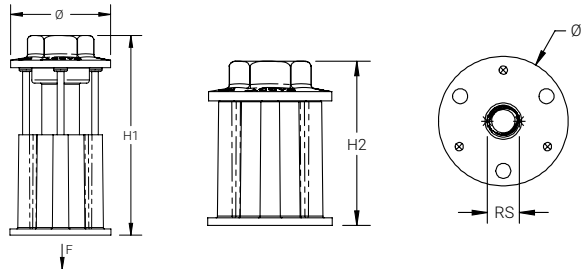

Material: Steel  
Finish: Electrogalvanized



Part Number	Rod Size RS	Diameter Ø	Height 1 H1	Height 2 H2	Static Load F
CRLW37EG	3/8"	1.65"	3.2"	2.4"	1,407 lb
CRLW50EG	1/2"	1.90"	3.3"	2.5"	1,618 lb

Rod Lock Coupler

- Joins two sections of threaded rod by an easy “push-to-install” mechanism
- Can be easily installed at the end of a threaded rod, or to any existing male thread
- Plastic protection cap prevents dirt or structural coatings from obstructing the “push-to-install” mechanism
- Prefabricated assemblies easily lift and lock into place, helping to save time and money
- Works with slightly damaged threads and minor burrs on the threaded rod

An ideal replacement for traditional threaded rod couplers in applications where traditional Rod Lock structural attachments are unsuitable due to the application of structural coatings that would obstruct the push-to-install mechanism.

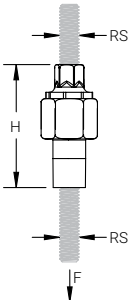

Material: Steel  
Finish: Electrogalvanized  
Static Load Safety Factor: 3.5:1

ROD LOCK METAL DECKING PRESET ANCHOR

Part Number	Rod Size RS	Height H	Wrench Size 1	Wrench Size 2	Static Load F
CRLC37EG	3/8"	2.4"	1/2"	15/16"	1,000 lb

Wrench Size 1 represents hex size used to tighten to threaded rod from structure. Wrench Size 2 represents Rod Lock hex nut size.

Rod Lock Coupler with Rod

- Easily installs into any traditional structural threaded rod attachment
- Allows simple installation of threaded rod assemblies by an easy “push-to-install” mechanism
- Plastic protection cap prevents dirt or structural coatings from obstructing the “push-to-install” mechanism
- Prefabricated assemblies easily lift and lock into place, helping to save time and money
- Works with slightly damaged threads and minor burrs on the threaded rod

A coupler attached to precut lengths of threaded rod, allowing for installation in to any traditional threaded rod attachment including beam clamps, preset concrete anchors, and post drill concrete anchors.

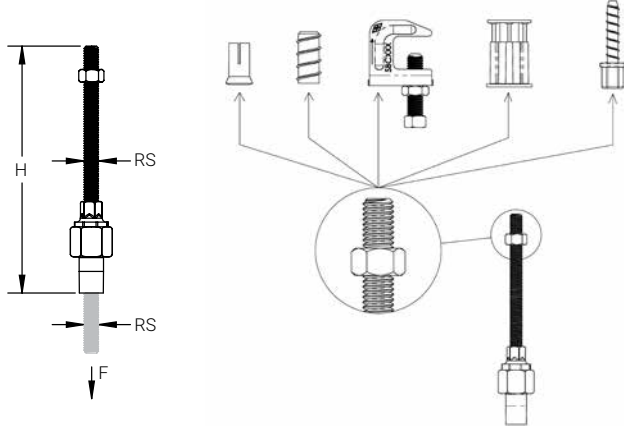

Material: Steel  
Finish: Electrogalvanized  
Static Load Safety Factor: 3.5:1

Part Number	Rod Size RS	Height H	Wrench Size 1	Wrench Size 2	Static Load F
CRLC37L1	3/8"	6.3"	9/16"	15/16"	1,000 lb

Wrench Size 1 represents hex nut size used to tighten to structural attachment. Wrench Size 2 represents Rod Lock hex nut size.