

fischer Universal plug UX GREEN. The nylon plug for all construction materials.

The tip of the plug expands and adjusts to different screw sizes.

The slanting connection bridges guarantee precise screw guidance.

The rim of the plug prevents it from falling deeper into the drill hole.

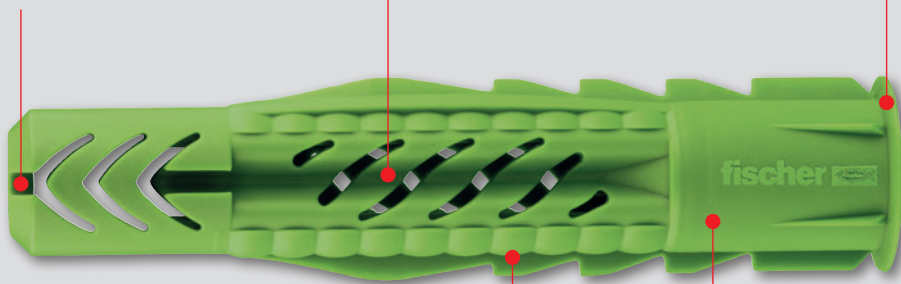

The serrated anti-rotation locks prevent rotation in the drill hole, even in "frayed" drill holes.

The integrated hammer-in stop prevents premature expansion e.g. push-through installation

Functioning.

- Because of its rim, the universal plug is best suited for pre-positioned installation.
- When the screw is screwed-in, the UX GREEN expands in solid building materials and knots within the cavity.
- It can be used with wood screws and chipboard screws as well as spacing screws.

Your advantages at a glance:

- With its universal functioning principle - knotting in cavities and expanding in solid building materials - the UX GREEN adapts to every sub-surface.
- Whether in concrete, aerated concrete, gypsum plasterboard, solid or vertically perforated brick, the UX GREEN always finds a secure hold.
- The rim prevents falling deeper into the drill hole when the screw is screwed in.
- The plug has a low, and thus comfortable screw-in torque and a high fixed torque. This way the plug really "pulls".
- The UX GREEN is available in diameters from 6 to 12 mm.

Installation

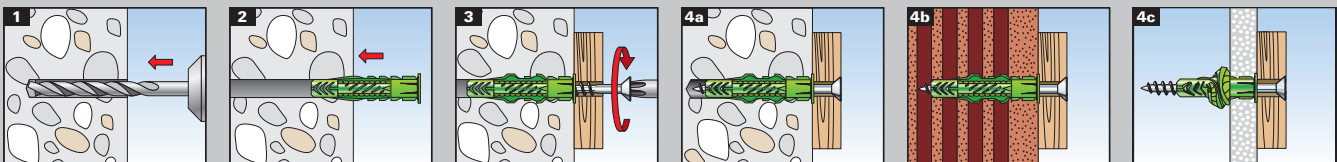

Applications.

Test mark



Recommendation

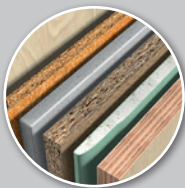
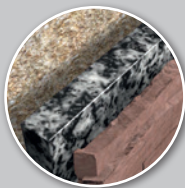
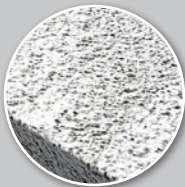

Suitable for:

- Concrete
- Gypsum plasterboard and gypsum fibreboards
- Vertically perforated brick
- Hollow lightweight concrete blocks
- Cavity floor slabs made of brick, concrete, etc.
- Perforated sand-lime brick
- Solid sand-lime brick
- Natural stone
- Aerated concrete
- Chipboard
- Solid panel made from gypsum
- Solid block made from lightweight concrete
- Solid brick

Typical anchoring solutions

Curtain rods



Shelves



- The universal plug UX GREEN can be used in a number of building materials.
- Typical applications are mounting pictures, lights, baseboards, lightweight wall cupboards, curtain rails, bathroom fittings, TV consoles and much more.

Outdoor lamps



Washbasins



Loads.

Universal plug UX GREEN

Highest recommended loads¹ of an individual anchor. Load values apply to the use of wood screws with the specified screw diameters.

Model			UX GREEN 6 x 35 R	UX GREEN 6 x 50 R	UX GREEN 8 x 50 R	UX GREEN 10 x 60 R	UX GREEN 12 x 70
Screw diameter	Ø	[mm]	5	5	6	8	10
Recommended load in the respective building material $F_{\text{empf}}^{2)}$							
Concrete	≥ C20/25	[kN]	0.40	0.60	0.60	1.00	1.50
Solid brick	≥ Mz 12	[kN]	0.20	0.30	0.30	0.50	0.70
Perforated sand-lime brick	≥ KSL 12	[kN]	0.40	0.40	0.50	0.60	0.80
Vertically perforated brick	≥ Hlz 12	[kN]	0.20	0.20	0.20	0.20	0.30
Aerated concrete	≥ PB4, PP4 (G4)	[kN]	0.20	0.20	0.30	0.40	0.60
Gypsum plasterboard	12.5 mm	[kN]	0.10	0.10	0.10	0.10	-
Gypsum plasterboard	25 mm	[kN]	0.15	0.15	0.15	0.15	-
Gypsum fibreboard	(Fermacell)	[kN]	0.20	0.20	0.20	0.25	-
Gypsum wall board	$\rho \geq 0,9 \text{ kg/dm}^3$	[kN]	-	-	0.15	0.35	0.45

¹⁾ Contains safety factor 7.

²⁾ Applies to tension load, shear load and diagonal pull under each angle.